

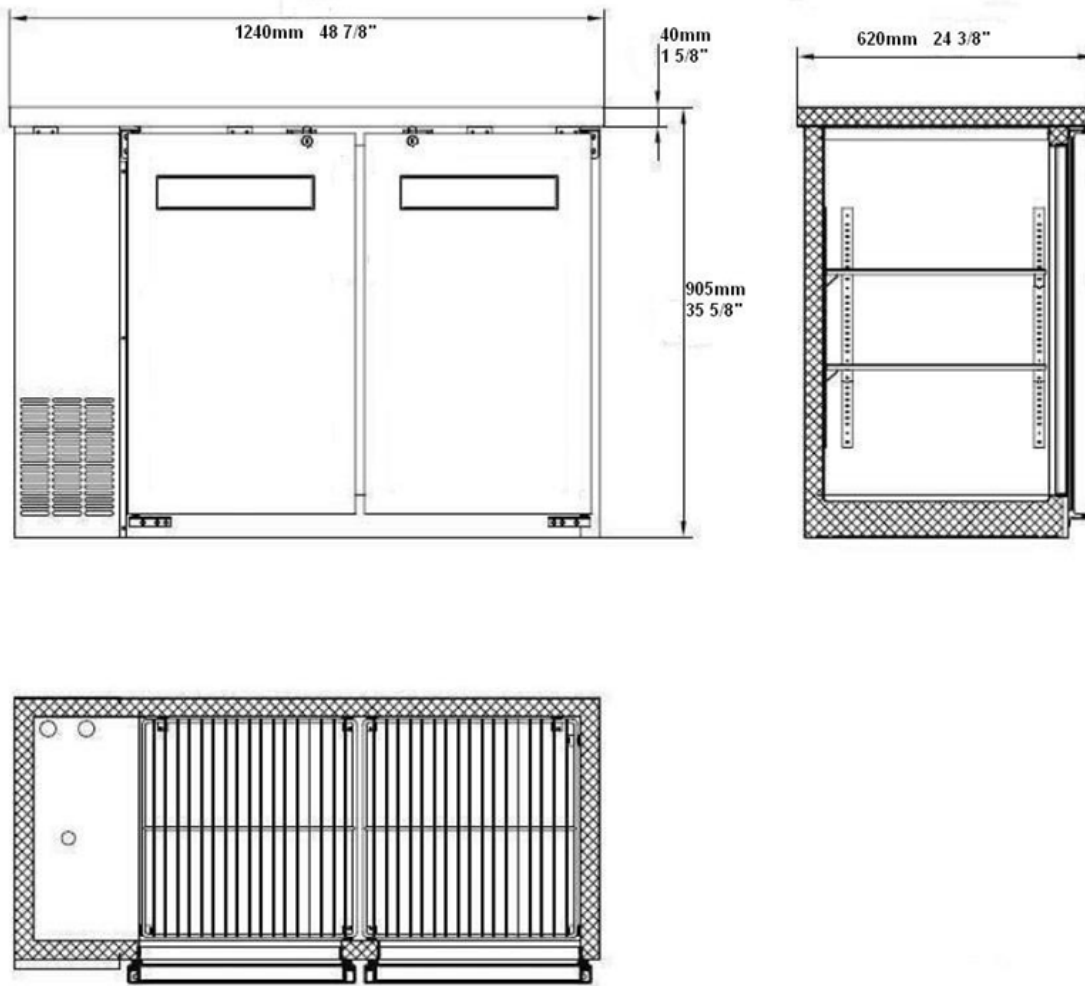



**CBBSDR2-48CC Specifications**

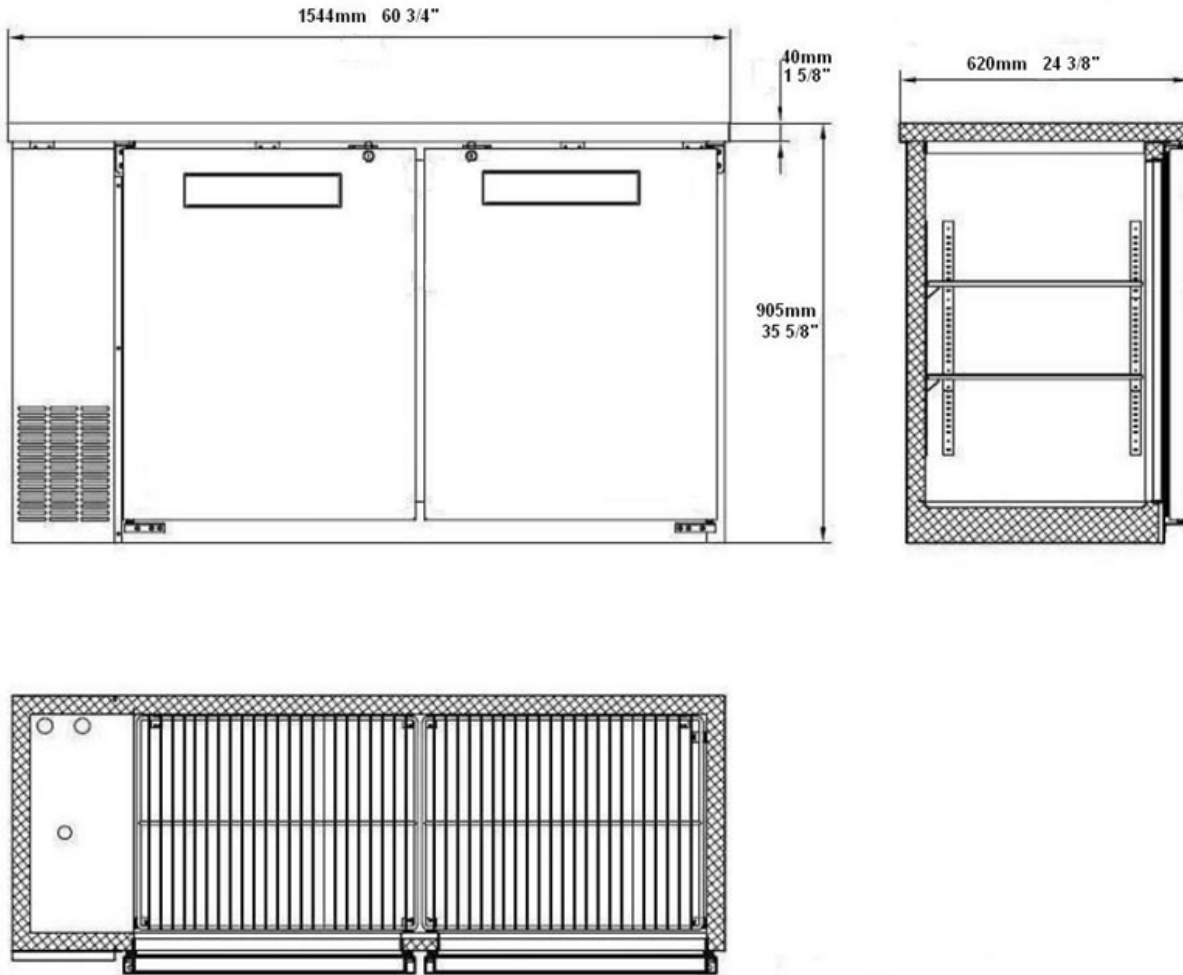

Model	Doors	Dimension (mm / inch)			HP	Voltage	Amps	Capacity (L / Cu Ft.)	Net Weight (KG / LBS)	NEMA Config.
		L	D	H						
CBBSDR2-48CC	2	1242.1	619.8	904.2	1/5	115/60/1	3	546	142.8	5-15P 
		48.9	24.4	35.6				19	315	

**CBBSDR2-60CC Specifications**



Model	Doors	Dimension (mm) (inch)			HP	Voltage	Amps	Capacity (L) (Cu Ft.)	Net Weight (KG) (LBS)	NEMA Config.
		L	D	H						
CBBSDR2-60CC	2	1546.9	619.8	904.2	1/5	115/60/1	2.88	447.4	172.3	5-15P 
		60.9	24.4	35.6				15.8	380	

**CBBSDR3-72CC Specifications**

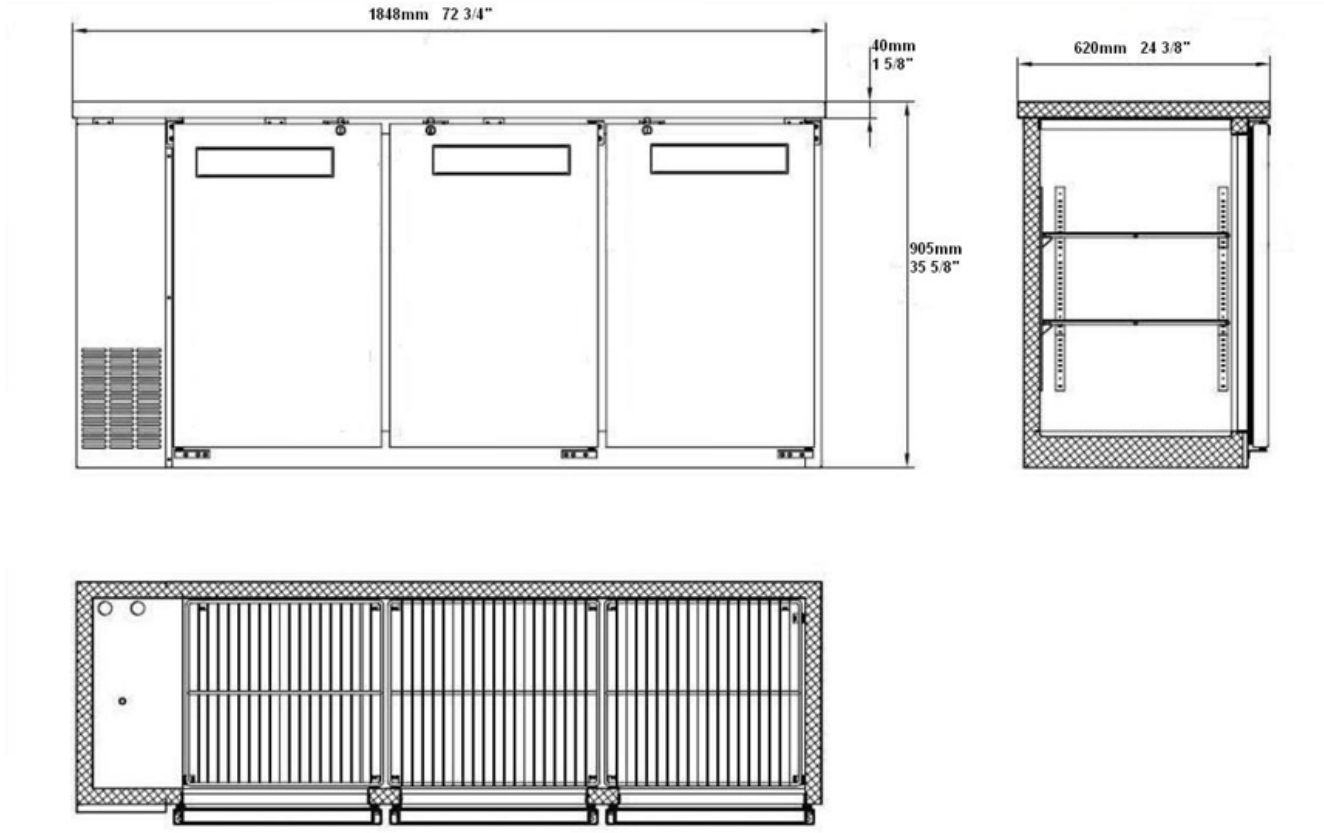

Model	Doors	Dimension (mm) (inch)			HP	Voltage	Amps	Capacity (L) (Cu Ft.)	Net Weight (KG) (LBS)	NEMA Config.
		L	D	H						
CBBSDR3-72CC	3	1851.7	619.8	904.2	1/2	115/60/1	3.96	555	186	5-15P 
		72.9	24.4	35.6				19.6	410	

**CBBSDR3-90CC**

**Specifications**

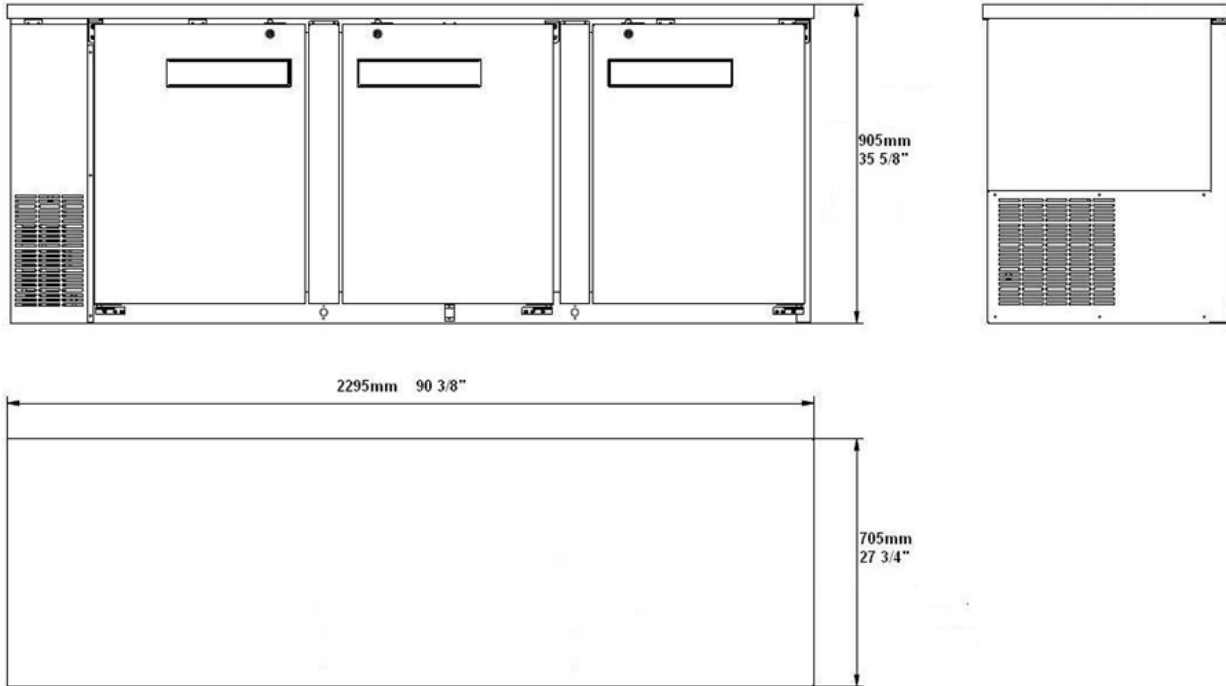

Model	Doors	Dimension (mm) (inch)			HP	Voltage	Amps	Capacity 1/2 Barrels	Net Weight (KG) (LBS)	NEMA Config.
		L	D	H						
CBBSDR3-90CC	3	2295	705	905	1/3+	115/60/1	3.84	4	190	5-15P ⚠
		90.4	27.75	35.6					418	