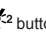

PROGRAM Note: Unit is supplied with 3 non adjustable programmes P1-P3 and one adjustable programme P4.

| | | |
|-------------------------------|---|---------------|
| Press MENU, cursor under PROG | Day/Day Group indicators flash | Adjust by +/- |
| Press OK | Program number flashes | Adjust by +/- |
| Press OK | Next Day/Day Group indicators flash, if appropriate or returns to Auto Mode | Adjust by +/- |
| Press OK | Program number flashes | Adjust by +/- |
| Press OK | Repeat procedure for all remaining Days if appropriate | |

PROGRAM 4 (selected during PROGRAM) - MODIFY Note: It is assumed Comfort 2 setpoint enabled.

| | | |
|--|--|--|
| Press OK | 1st period on Programme Profile flashing | Select Temp Setpoint for this period |
| Press +/- , , | Go to period in programme to be changed | Select Temp Setpoint for this period |
| Press  or  | Next period on programme profile flashes | Repeat procedure for remainder of 24hr profile |
| Press OK | Next Day/Day Group indicators flashes if necessary or returns to Auto Mode | |

Temporary Override –enables you to adjust current temperature set point until the next program step.

During the override the current set point temperature flashes

| | | |
|------------------------------|---------------------------------|--|
| Press +/- to adjust Temp Set | Temp Set flashing | |
| Press MENUx7 | To cancel & return to Auto mode | |

Timed Override - allows timed modification of the room temperature at any time. The default time may be set from 15 minutes to 12 hours using parameter PA:1

| | | |
|---|--|---------------|
| Press  | Time Count flashing | Adjust by +/- |
| Press OK | Temp Set flashing | Adjust by +/- |
| Press OK | Time period flashes on programme profile for day | |
| Press MENU | To cancel & return to Auto mode | |

What to do if ..?

The symbol  is displayed : change the batteries.



Technical Helpline: 01475 745131

SERVICE AND WARRANTY

Your product is not user serviceable. PLEASE DO NOT TRY TO DISMANTLE THE UNIT. This product is guaranteed by your supplier for 3 years from the Date of Manufacture. If it should become defective, please contact your installer or supplier for a replacement unit or visit www.sangamo.co.uk/returns.

CUSTOMER CARE POLICY

As part of Sangamo's continuous improvement program, the Company operates a Customer Care Policy. This means that we welcome your comments and complaints, as it can help us to improve our services to you, our customer.

Due to our policy of continuous product improvement and development, the specifications in this guide may be subject to change without prior notice.

Sangamo Limited, Industrial Estate, Port Glasgow, Renfrewshire PA14 5XG

Tel: 01475 745131 Fax: 01475 744567

Email: enquiries@sangamo.co.uk Web: www.sangamo.co.uk

SANGAMO

CHOICE RSTAT 6

INSTALLATION AND USER INSTRUCTIONS DIGITAL, DELUXE PROGRAMMABLE ROOM THERMOSTAT

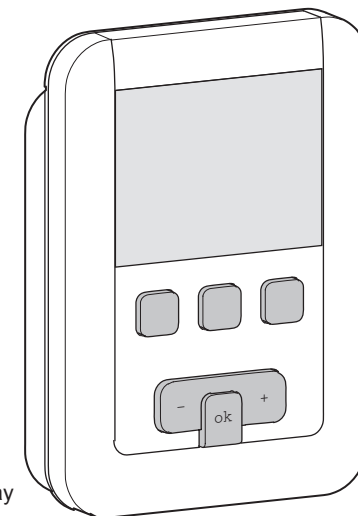

Features

- 24hr, 5/2 day or 7 day programmable
- 3 off preset & non adjustable programmes
- 1off free user adjustable programme
- Programmable in 30min steps
- 3 off temperature levels, Comfort, Comfort 2, Economy plus Frost Protection
- Battery powered (with low-power indicator)
- Automatic or Manual Mode selection
- Standby Mode with Frost Protection
- Holiday Mode with Frost Protection
- Temporary temperature override
- Timed temperature override
- Automatic Summer/Winter time change
- Optimisation and Anticipation functions
- Heating, Air Conditioning or both mode options
- Large clear backlit display showing programme profile for current day
- Temperature adjustment range 5 to 30°C



This programmable room thermostat has been designed to bring you comfort and energy economy.

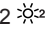

It allows you to program and regulate your heating system at 3 temperature levels:

- Comfort 
- Comfort 2 
- Economy 

plus

- Frost Protection 

It also enables you to program and regulate air-conditioning at 2 temperature levels:

- Comfort 
- Economy 

Each day is conveniently split into 48 time periods for you to programme according to your lifestyle.

A large backlit LCD provides a clear feedback for the user including the full programme profile for the current day.

Technical Characteristics

| | |
|-------------------------------|---|
| Powersupply: | 2 Alkaline batteries 1.5V (type AA) |
| Contact rating: | 5(3)A, 250Vac (Volt free changeover contacts) |
| Power reserve: | 10 min |
| Battery lifespan: | 4 years |
| Temperature adjustment range: | 5 to 30°C (All temperature levels) |
| Temperature display range: | 0 to 40°C |
| Storage temperature: | -25 to 70°C |
| Clock accuracy: | <1sec/day |
| Protection rating: | IP30 |
| Insulation class: | 11 |
| Flexible wire size: | 0.5-1.5mm ² |
| Rigid wire size: | 0.5-2.5mm ² |
| Pollution class: | 3 |
| Dimensions (LxHxD): | 97x130x30mm |
| Complies with: | EN60730-1, EN60730-2-1, EN60730-2-7, EN60730-2-9, EN60730-2-11, EN12098-2 & EN12098-5 |

Thermostat Description

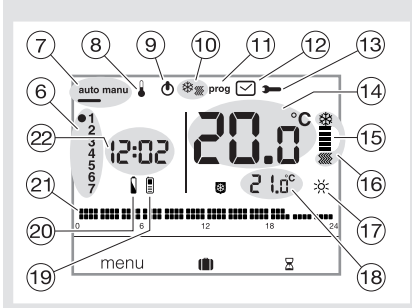
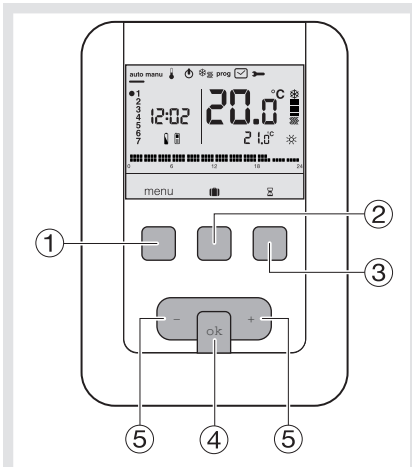

- 1) Key for menu access
- 2) Key to access holiday
- 3) Key to access the temporary override
- 4) Confirmation key OK
- 5) Adjustment keys + and -
- 6) Indicator for days of the week
- 7) Automatic mode/manual mode (thermostat without program)
- 8) Temperature set-points adjustment
- 9) Standby
- 10) Heating/Air-con selector
- 11) Programming/program selection
- 12) Time and date adjustment
- 13) Adjustment of settings
- 14) Ambient temperature
- 15) Heating or air conditioning indicator
- 16) Current mode (heating or air conditioning)
- 17) Current setting (☀, ☀², ☾, ☀²)
- 18) Temperature of current setting
- 19) Telephonic remote-control
- 20) Battery use indicator
- 21) Profile of today's program
- 22) Current time

Heating/Air Con reversibility

This function allows your installation to switch from Heating to Air Conditioning mode. (PA5 = HC only)

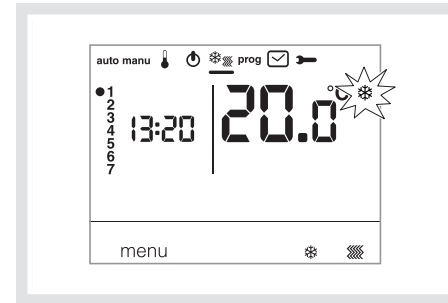

| | | |
|----------------------------|---------------------------------|---|
| Press MENU, Cursor under ☀ | ☀ flashes | Thermostat regulates the heating. |
| Press ☀ | ☀ ² flashes | To change from Heating mode to Air-conditioning mode. |
| Press MENU | To cancel & return to Auto mode | |

Adjusting the temperature set points

Heating (H) defaults : Comfort ☀ = 19°C , Comfort 2 ☀² = 20°C , Eco ☾ = 16°C

Air-con (C) defaults : Comfort ☀ = 24°C , Eco ☾ = 29°C

| | | |
|----------------------------|-------------------------|---------------|
| Press MENU, cursor under ☀ | Comfort 1 Temp flashing | Adjust by +/- |
| Press OK | Comfort 2 Temp flashing | Adjust by +/- |
| Press OK | Eco Temp flashing | Adjust by +/- |
| Press OK | Return to Auto mode | |

Programming

There are four program choices

P1,P2,P3 are pre-recorded and cannot be modified

P4 is free for a personalised program

Note P1o is only available when the optimisation parameter is active, set to Auto (PA:9)

P1 is activated 7 days per week by default.

If this fits the rhythm of your life then remain in automatic mode; if not, continue

Note P4A is only active when the anticipation parameter is active, set to 1hr,2hr or 3hr (PA:9)



P1= Comfort temperature from 06:00 to 23:00.
Eco temperature from 23:00 to 06:00.

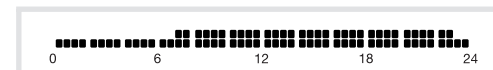

P1o= Optimisation (only with P1).
Comfort temperature from 07:00 to 23:00.
Eco temperature from 23:00 to 07:00.



P2= Comfort temperature from 06:00 to 08:30 and from 16:30 to 23:00.
Eco temperature from 08:30 to 16:30 and from 23:00 to 06:00.



P3= Comfort temperature from 06:00 to 08:30 from 11:30 to 13:30 and from 16:30 to 23:00.
Eco temperature from 08:30 to 11:30 and from 13:30 to 16:30 and from 23:00 to 06:00.

P4= a free program which allows you to create up to 5 Comfort temperature periods and 5 Eco temperature periods, for each of the days of the week.

| | | |
|-----------------|---------------------|-----------------------|
| ☾ | ☀ | ☀ ² |
| 30min. inEco | 30min. inComfort | 30min. inComfort 2 |

| | User Parameter Description | Options | Default | Notes |
|------|------------------------------------|-----------------------|---------|---|
| PA:1 | Default duration of timed override | 1,2,3,4,5 or 12 hours | 1hour | |
| PA:2 | Backlighting of display | Off/ON | ON | |
| PA:3 | Temperature Calibration | +/-3degC | 0degC | Adjust value displayed if you measure a different ambient to that the thermostat measures |
| PA:4 | 2nd Comfort Temperature level | 1 or 2 | 1 | Allows a 2nd comfort temperature level to be used. Only applicable to free program (P4) |

| | Installer Parameter Description | | | |
|-------|--|--------------------------|-----|--|
| PA:5 | Heating/Air Con Installation Mode | H,C or HC | H | H=Heating, C=Air Conditioning or HC=Reversible Heating/Air-Con. In HC mode care should be taken to switch the Heat Pump suitably for the chosen thermostat mode. |
| PA:6 | Degumming the pump | Off/ON | Off | Activate/De-activate automatic start-up of the pump at midnight every day to avoid jamming during the summer. |
| PA:7 | Inertia type of heating installation | SLo/FAs | FAs | SLo = slow inertia (eg; underfloor heating) FAs= fast inertia (eg; radiators) |
| PA:8 | Inertia of air-conditioning installation | SLo/FAs | FAs | SLo = slow inertia (eg; underfloor cooling) FAs = fast inertia (eg; convactor fans) |
| PA:9 | Optimisation and Anticipation | Off, Auto, 1hr, 2hr, 3hr | Off | Optimisation(Auto - P1o program only). Thermostat automatically estimates the time required to reach the Comfort temperature and adjusts the switch on time. A learning period of 10 days may be necessary to reach full optimisation. Anticipation (1hr,2hr,3hr – P4A program only). This function allows the Comfort \star or Comfort 2 $\star\star$ to be applied in advance. |
| PA:10 | Return to factory settings | YEs/nO | nO | Yes-Reset, No=No reset |
| | Software version information | | | Displays which version of the software is installed in the product |

Thermostat Installation

To ensure its correct operation the thermostat should be situated around 1.3m above the floor on an interior wall and away from direct sunlight, heat sources and drafts.

The thermostat is surface mounted to a wall using its back plate. Separate the thermostat from its back plate by pushing on the button located underneath. Mount the back plate into position with fixings provided. Open the terminal cover using a screwdriver and connect product according to wiring diagrams. Reclose the terminal cover. Insert batteries into thermostat and clip thermostat onto back plate.

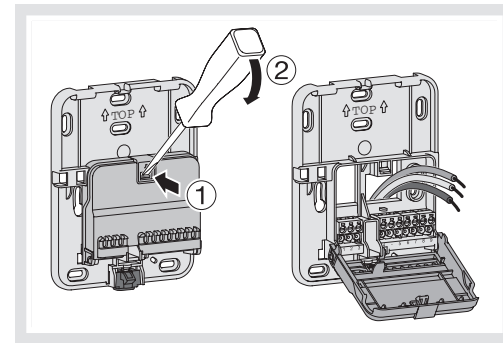
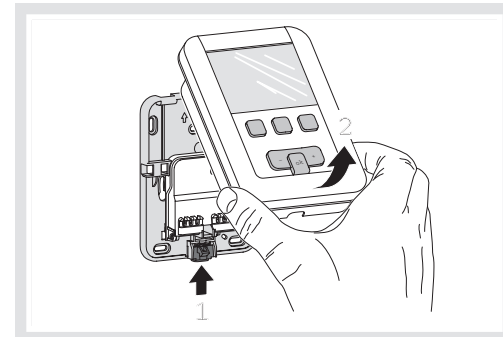
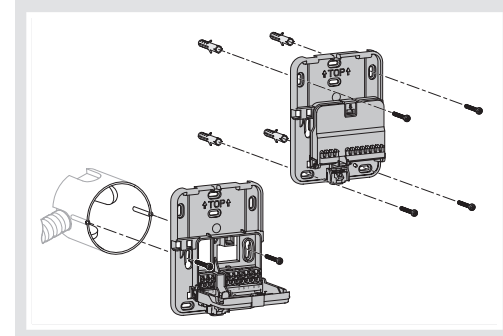

This product must be installed by a suitably competent person in line with the latest IEE regulations.

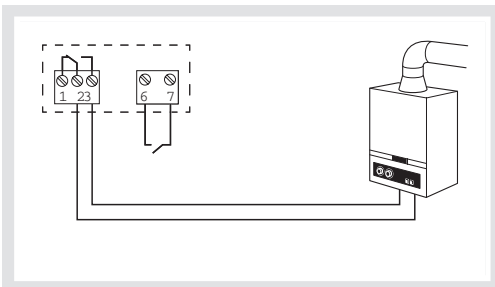

Connection of the thermostat to a thermostat input on the boiler.

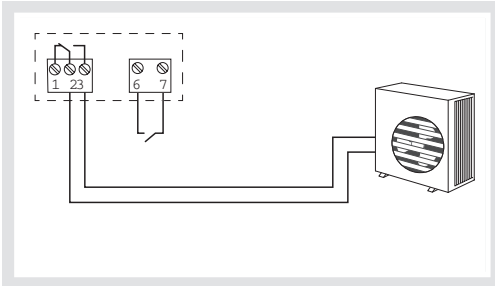

Connection of the thermostat to the thermostat input of a reversible or irreversible heat pump.

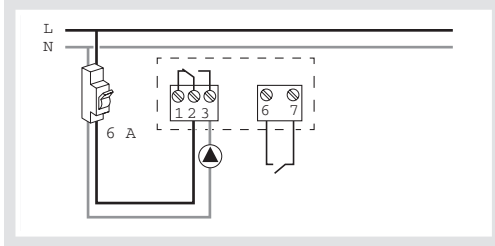

Connection of a heating or air conditioning circulator.

Initial Set Up & Set Clock

| | | |
|-------------------------------------|---------------------|----------------------|
| Press MENU, cursor under ☑ | Year flashing | Adjust by +/- |
| Press OK | Month flashing | Adjust by +/- |
| Press OK | Day flashing | Adjust by +/- |
| Press OK | Hour flashing | Adjust by +/- |
| Press OK | Minutes flashing | Adjust by +/- |
| Press OK (Summer/Winter timechange) | Auto flashing | Adjust to OFF by +/- |
| Press OK (Hour format) | 24H flashing | Adjust to 12H by +/- |
| Press OK | Return to Auto mode | |

Automatic Mode (auto) – operate according to the program selected or set.

| | | |
|-------------------|-----------------------------------|--|
| Cursor under AUTO | Program profile for day displayed | |
|-------------------|-----------------------------------|--|

Manual Mode (manu) – operate as a simple thermostat.

| | | |
|-------------------------------|--|------------------------|
| Press MENU, cursor under MANU | Programmed profile for day not displayed | Adjust Set Temp by +/- |
| Press MENU, cursor under AUTO | Return to Auto mode | |

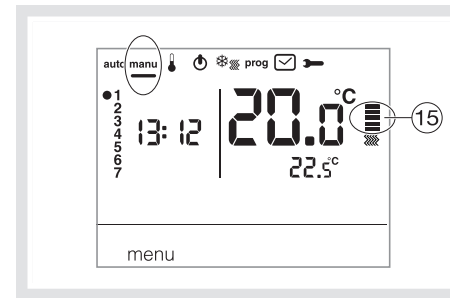

Standby Mode – unit remains powered, but inactive except for frost protection.

| | | |
|-------------------------------|---|-------------------|
| Press MENU, cursor under ⏻ | Programmed profile for day & Set Temp not displayed | Frost Mode Active |
| Press MENU, cursor under AUTO | Return to Auto mode | |

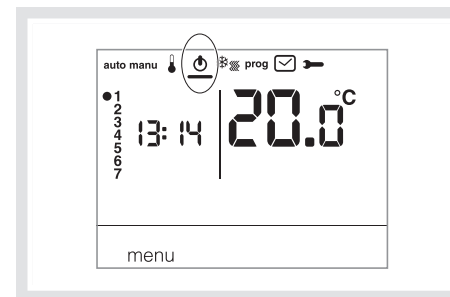

Holiday Mode - unit remains powered, but inactive except for frost protection. The frost protection temperature can be adjusted between 5degC & 30degC. A holiday period can be set from 1-99 days with the current day counting as 1.

| | | |
|------------|---------------------------------|---------------|
| Press 🔋 | Day count flashing | Adjust by +/- |
| Press OK | Frost Temp flashing | Adjust by +/- |
| Press OK | Holiday Mode active | |
| Press MENU | To cancel & return to Auto mode | |

Parameters

To access ALL of the parameters press menu to place the cursor under ➡ then give one long press (>5s) on OK .

To only access user parameters from (PA:1to PA:4), press menu to place the cursor under ➡ and confirm using the OK key.

Press + or – to change a parameter setting and OK to accept and move to next parameter.