

Powerbolt 250

KEYPAD ELECTRONIC LOCK
Installation and User Guide

ENGLISH

Kwikset Technical Support | 1-800-327-5625 | www.kwikset.com

Required tools

Batteries Ruler Screwdrivers

Additional Tools (depending on application)

Hammer Wood block

3D instructions available on

SCAN FOR BILT 3D INSTRUCTIONS

POWERED BY BILT INTELLIGENT INSTRUCTIONS™

Parts in the box

Latch	Interior Assembly	Exterior Assembly
Adapter Ring	For Latch / Strike	For Lock
	Strike	SmartKey Tool
Collar	53648	52367
Keys		

1 Prepare the door and check dimensions

If drilling a new door, use the supplied template and the complete door drilling instructions available at www.kwikset.com/doorprep.

<p>A Measure to confirm that the hole in the door is either 2-1/8 in (54 mm) or 1-1/2 in (38 mm).</p>	<p>B Measure to confirm that the backset is either 2-3/8 or 2-3/4 in (60 or 70 mm).</p>	<p>C Measure to confirm that the hole in the door edge is 1 in (25 mm).</p>	<p>D Measure to confirm that the door is between 1-3/8 and 1-3/4 in (35 mm and 44 mm) thick.</p>
--	--	--	---

Note: Additional door preparation may be required for doors with 1-1/2 in (38 mm) holes. Consult the deadbolt drilling instructions at www.kwikset.com/doorprep.

Note: Please contact customer service if door thickness exceeds 1-3/4 in for a thick door kit.

2 Install the latch and strike

For Latch / Strike Bag

53648 (4x) actual size

<p>A Hold the latch in front of the door hole, with the latch face flush against the door edge.</p> <p>Is the rectangular shaped hole centered in the door hole?</p> <p>YES Rectangular shaped hole No adjustment is required. Proceed to next step.</p> <p>NO Rectangular shaped hole Rotate latch face as shown to extend latch.</p>	<p>B Is the door edge chiseled?</p> <p>YES chiseled Install latch in door with supplied screws.</p> <p>NO not chiseled Use a flathead screwdriver to remove latch face. Once removed, grip the latch with one hand and with the other hand twist collar off. Install drive-in collar.</p> <p>Align tabs with holes in collar.</p> <p>Ensure collar snaps into place. Pull collar to test for tight fit.</p> <p>Install latch in door with wood block and hammer.</p> <p>Make sure slotted hole is at bottom of latch.</p> <p>53648 (2x) (For Latch/Strike Bag)</p>	<p>C Install strike on the door frame.</p> <p>⚠ Make sure the hole in the door frame is drilled a minimum of 1 in (25 mm) deep.</p> <p>53648 (2x) (For Latch/Strike Bag)</p> <p>door frame</p>	<p>D ⚠ IMPORTANT: Make sure the latch bolt is fully retracted (in the unlocked position).</p> <p>unlocked</p>
---	---	---	--

3 Install the exterior keypad

For Lock Bag

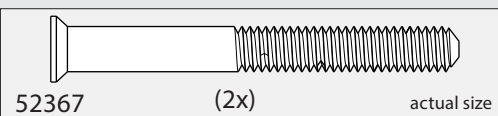

A What is the diameter of the hole in the door?

Diameter is 2-1/8 in (54 mm)

Adapter ring is required for installation.

or

Diameter is 1-1/2 in (38 mm)

Adapter ring is not needed for installation.

B Locate screws for step 3C and keep them within reach.

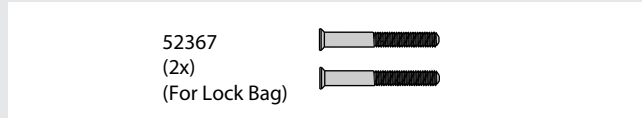

C Install exterior keypad and mounting plate.

a Rotate the flat blade to a horizontal position to match the latch orientation.

Make sure door is RETRACTED.

Cable goes underneath latch.

b Support exterior assembly during mounting plate installation.

Route cable through center hole, then push cable into bottom hole.

c TOP of the mounting plate should be visible. Keep parallel to edge of door.

Tighten screws evenly. DO NOT over tighten screws.

52367 (2x) (For Lock Bag)

Make sure the flat blade is centered in the mounting plate hole.

d Insert key and test latch. If latch does not extend or retract smoothly, adjust screws.

Remove key when finished and make sure the latch bolt is FULLY EXTENDED.

4 Install the interior assembly

For Lock Bag

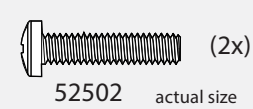

A Remove interior cover from interior assembly.

a Check to make sure the latch bolt is in the extended/locked position to install the interior assembly.

b Make sure turnpiece shaft is rotated as shown.

If the turnpiece is not pointing up, rotate the turnpiece until you hear a click.

c Remove the interior cover from the interior assembly.

d Do not install batteries until step 5.

B Secure the interior assembly onto the mounting plate.

a Connect the cable. Ensure a tight cable connection.

b Route cable around the side notch and bottom of the interior assembly.

c Insert the flat blade into the turnpiece shaft.

d Ensure you are using the correct screws. Using incorrect screws will damage the product.

52502 (2x)

5 Install the batteries in the interior assembly

A Install 4 AA batteries in interior assembly

Ensure your door is open while installing batteries. Ensure the interior cover is off to install batteries. Note: Batteries are not included

Ensure correct polarity. For best results, use new, non-rechargeable alkaline batteries only.

B Install interior cover for the interior assembly.

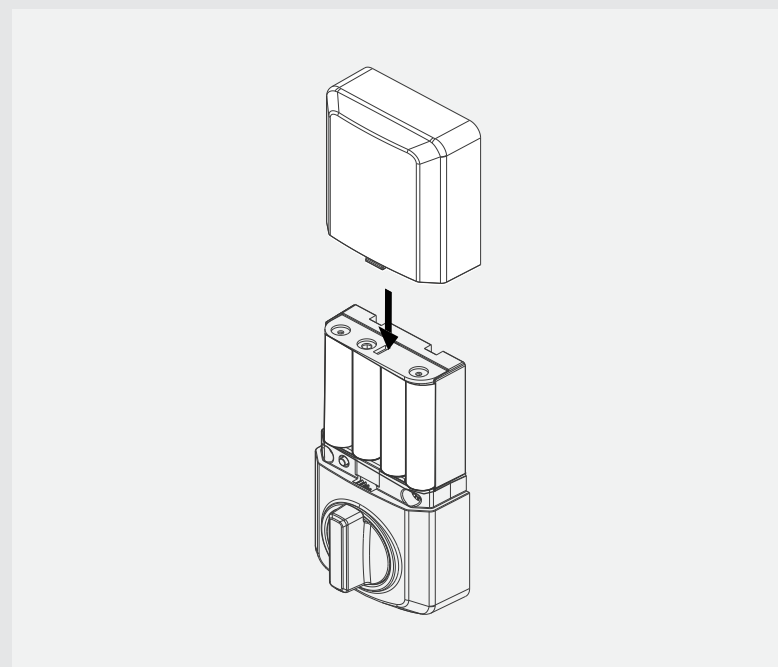

6 Add user codes (25 max)

A Make sure the interior cover is off. Press the Program button once.

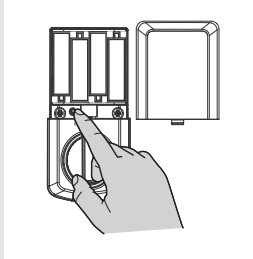

B Press number 1.

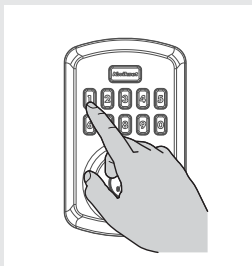

C Press Kwikset logo once.

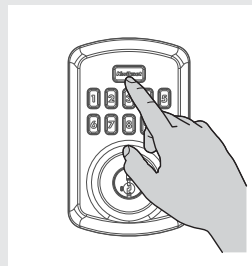

D Enter user code. A total of 25 user codes may be programmed. User codes should be 4 to 8 digits in length.

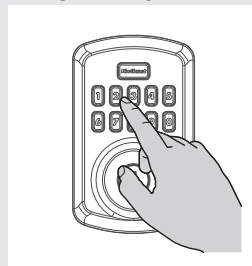

E Press Kwikset logo once.

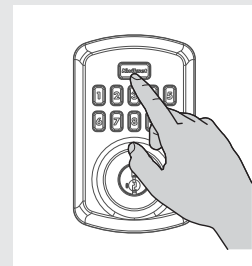

During programming, if no button is pressed within 5 seconds, the system will time out and you will need to restart the procedure

⚠ For security reasons, the first 4 digits of each User Code must be unique. For example, you are unable to program a user code 1-2-3-4-5 as well as user code 1-2-3-4-6.

Note: After the first User Code is created, the latch bolt will automatically retract and extend to learn the locking and unlocking direction of the door. The Kwikset logo will indicate success or failure. GREEN: Success RED: Unsuccessful

7 Test the lock (review normal operation)

⚠ Before you can lock and unlock the door, a User Code must be created. Refer to Step 6 for instructions how to create a User Code. Confirm that the code(s) added in previous step can unlock the door.

A To lock your door, press the Kwikset logo button. The lock will beep twice and the Kwikset logo button will flash amber as the deadbolt extends.

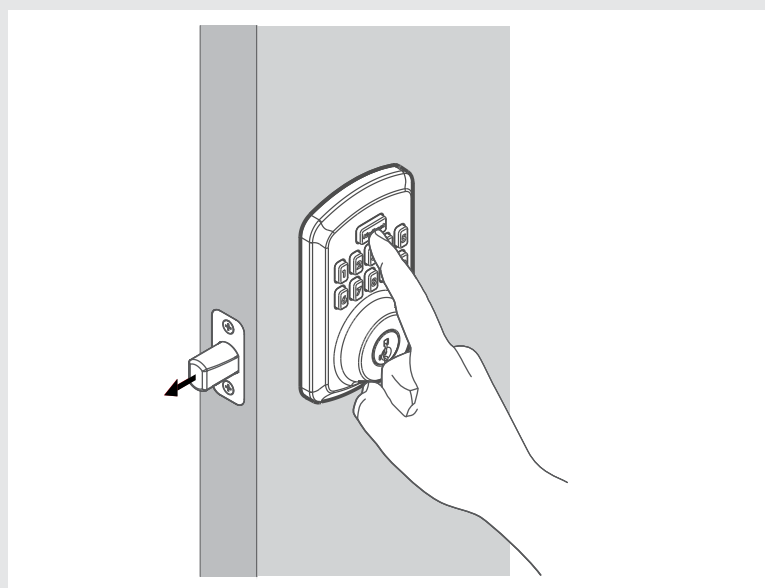

B To unlock your door, enter the user code. The lock will beep twice and the Kwikset logo button will flash green as the deadbolt retracts.

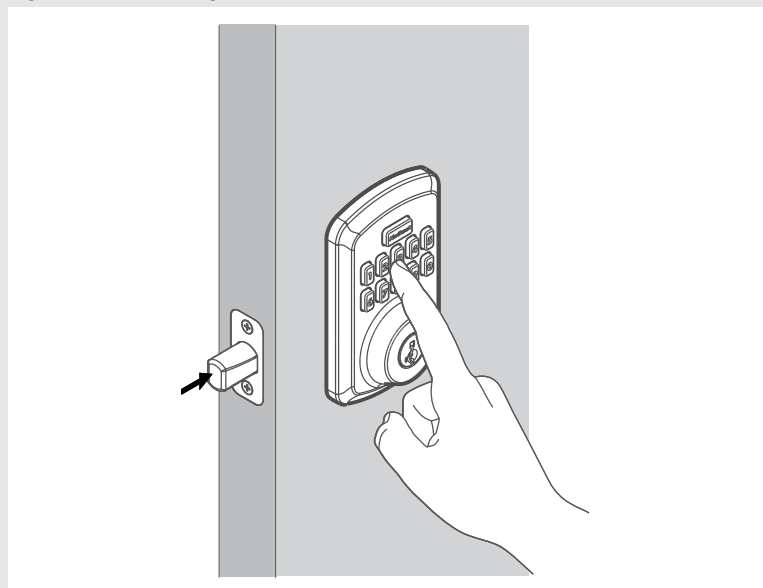

8 Adding a One-time User Code

1. Remove interior cover. Press programming button.

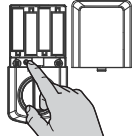

2. Press number 7.



3. Press the Kwikset logo button.



4. Enter the one time user code.



5. Press the Kwikset logo button.



Up to 5 One-time User Codes can be saved. One-time User Codes should be 4 to 8 digits in length. The One-Time User Code will be deleted automatically after it is used. The same One-Time User Code can be created again after it's used.

9 Delete a Single User Code

1. Remove interior cover. Press programming button.

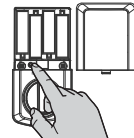

2. Press number 2.



3. Press the Kwikset logo button.



4. Enter the user code you want to delete.



5. Press the Kwikset logo button.



6. Enter the user code being deleted again.



7. Press the Kwikset logo button again.



If unsuccessful: Make sure you entered the same user code in steps 4 and 6.

⚠ Test code while the door is open. Test the User Code to make sure it no longer unlocks the door.

If a button is not pressed within 5 seconds, the system will time out, and you will need to restart the procedure.

10 Delete ALL User Codes

Note: Keypad locking function will be disabled when User Codes are deleted. The lock can only be operated manually by a key during this time.

1. Remove interior cover. Press programming button.

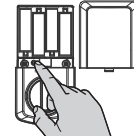

2. Press number 4.



3. Press the Kwikset logo button.



4. Press number 4.



5. Press the Kwikset logo button.



11 Enable/ Disable Audio

1. Remove interior cover. Press programming button.

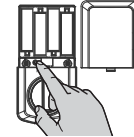

2. Press number 5.



3. Press the Kwikset logo button.



Note: LED status indicator will still function once audio is disabled. Repeat the programming steps to enable the audio.

