

King

PNEUMATIC/FLUID PARTS WASHER OPERATING MANUAL

**Model # 4007-0
UPC: 657807400702**



King Tools & Equipment
1255 Acacia St., Ontario CA 91761
Tel # 909.930.6588 • Fax # 909.930.6589
www.kingtoolscorp.com • E-mail: info@kingtoolscorp.com

READ ALL INSTRUCTIONS BEFORE OPERATING

SAVE THESE INSTRUCTIONS

Thank you for purchasing your King #4007-0 Pneumatic/Fluid Parts Washer. Before attempting to operate your new Parts Washer please read these instructions thoroughly. You will need these instructions for the safety warnings, precautions, assembly, operation, maintenance procedures, parts list and diagrams. Keep your invoice with these instructions. Write the invoice number on the inside of front cover. Keep the instructions and invoice in a safe, dry place for future reference.

WARNING: The warnings, cautions and instructions discussed in this instruction manual cannot cover all possible conditions or situations that could occur. It must be understood by the operator that common sense and caution are factors which cannot be built into this product, but must be supplied by the operator.

TABLE OF CONTENTS

Description	Page#
Warranty	1
Specifications	1
Safety Rules	1-2
Getting Started	2
Assembly	2
Operation	6
Maintenance	9
Troubleshooting	9
Parts List and Diagram	10

SPECIFICATIONS

Tub Size	28" x 19" x 7.5"
Tank Capacity	13 Gallon
Nozzle	6 CFM @100 PSI
Assembled Dims	30" x 20" x 41"
Packed Weight	106 lbs.

SAFETY RULES

1. Know your tool. Read this manual carefully. Learn the tool's applications and limitations, as well as potential hazards specific to it.
2. Keep work area clean and well lit. Cluttered or dark work areas invite accidents.
3. Keep children away. All children should be kept away from the work area. Never let a child handle a tool without strict adult supervision.
4. Do not operate this tool if under the influence of alcohol or drugs. Read warning labels on prescriptions to determine if your judgment or

reflexes are impaired while taking drugs. If there is any doubt, do not attempt to operate.

5. Use safety equipment. Eye protection should be worn at all times when operating this tool. Use ANSI approved safety glasses. Everyday eyeglasses are NOT safety glasses. Dust mask, non-skid safety shoes, hard hat, or hearing protection should be used in appropriate conditions.
6. Wear proper apparel. Loose clothing, gloves, neckties, rings, bracelets, or other jewelry may present a potential hazard when operating this tool. Keep all apparel clear of the tool.
7. Don't overreach. Keep proper footing and balance at all times when operating this tool.
8. Do not force tool. Use the correct tool for your application. The correct tool will do the job better and safer at the rate for which it was designed.
9. Check for damage. Check your tool regularly. If part of the tool is damaged it should be carefully inspected to make sure that it can perform its' intended function correctly. If in doubt, the part should be repaired. Refer all servicing to a qualified technician. Consult your dealer for advice.
10. Keep away from flammables. Do not attempt to operate this tool near flammable materials or combustibles. Failure to comply may cause serious injury or death.
11. Keep hands clear of moving parts.
12. Store idle tools out of the reach of children and untrained persons. Tools may be dangerous in the hands of untrained users.
13. Maintain tools with care. Keep tools clean and properly maintained.
14. Do not use flammable or corrosive cleaning products with this Part Washer.
15. Dispose of the used degreaser in accordance with current environmental regulations.

GETTING STARTED

Unpack your King Pneumatic/Fluid Parts Washer and check to make sure that it is not damaged and that all items are included.

Your Pneumatic/Fluid Parts Washer includes:

- Mobile Tank1
- Cleaning Tub1
- Handle1
- Tub/Handle Support Rod . . .2
- Tank Reservoir Connector . .1
- Pressure Regulator Assembly .1
- Air Nozzle1
- Cleaning Brush1

ASSEMBLY

Your Pneumatic/Fluid Parts Washer requires some assembly. All parts must be properly installed and tightened before use.

TECH TIP: To avoid scratching your Pneumatic/Fluid Parts Washer during assembly, use the shipping carton as a work mat.

Installing the Tank Reservoir Connector

1. Place the Mobile Tank upright on a flat, level surface.
2. Insert the long tube of the Tank Reservoir Connector into the mounting hole located at the very top of the Mobile Tank.

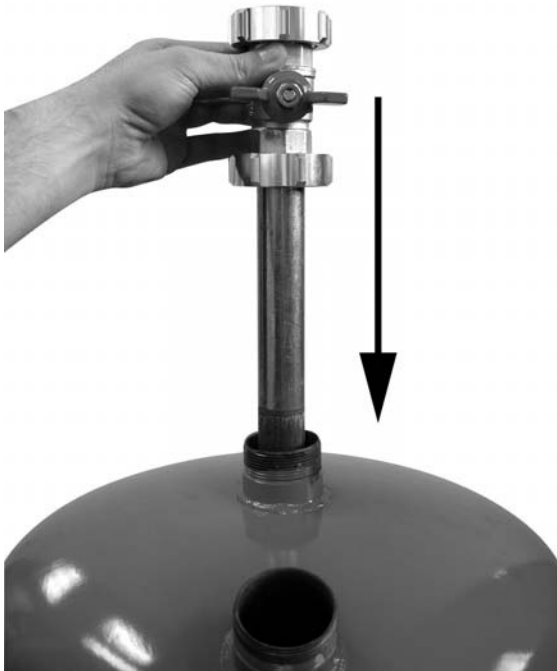

3. Align the lower coupler threads on the Tank Reservoir Connector with the threads on the Mobile Tank mounting hole.

4. Turn the Lower Coupler clockwise until it is firmly hand tightened in place on the Mobile Tank.



Installing the Pressure Regulator Assembly

1. Insert the long tube end of the Pressure Regulator Assembly into the mounting hole on the top of the Mobile Tank

Note: The mounting hole for the Regulator Assembly is located “off-center” in the top of the Mobile Tank.



2. Align the coupler threads on the Pressure Regulator Assembly with the threads on the Mobile Tank mounting hole.
3. Turn the Regulator Assembly Coupler clockwise until it is firmly hand tightened in place on the Mobile Tank.



Installing the Cleaning Tub

1. Insert the Tub/Handle Support Rods into the mounting brackets located on the side of the Mobile Tank. **Note:** The short end of the Supports should be installed into the Tank Mounting Brackets, as shown below.

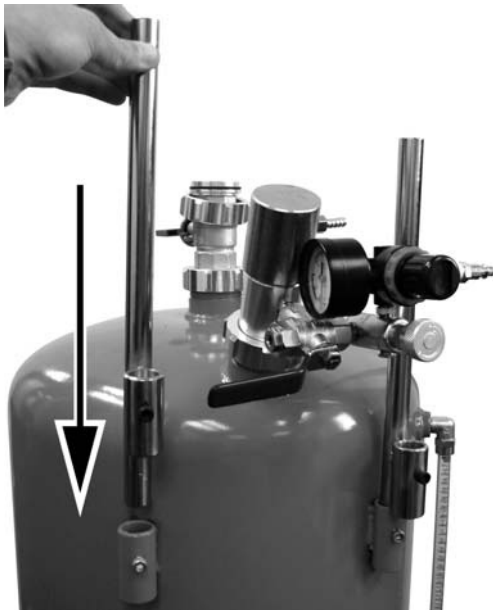

2. Do not tighten the bolts in the Tank Mounting Brackets yet.
3. With the help of a second person, align the Mounting Brackets on the bottom of the Cleaning Tub with the Support Rods which were installed in Step 1.
4. Lower the Cleaning Tub onto the Support Rods. Make sure that the ends of the Support Rods are fully inserted into the Mounting Brackets on the Cleaning Tub before letting go of the Tub.



5. Do not tighten the bolts in the Cleaning Tub Mounting Brackets yet.
6. Align the threads on the Tank Reservoir Connector Upper Coupler with the threads on the Cleaning Tub Drain Tube.
7. Turn the Upper Coupler counter-clockwise until it is firmly hand tightened in place on the Cleaning Tub.

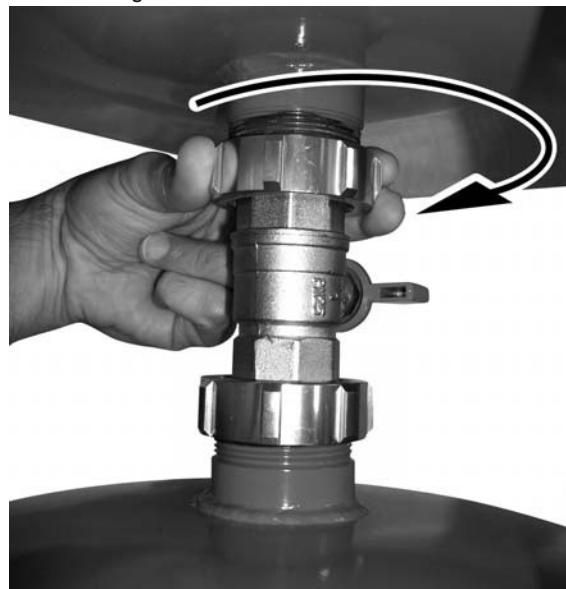

Installing the Handle

1. Insert the ends of the Handle into the Handle Mounting Brackets on the Tub/Handle Support Rods.



2. Now that the handle is in place, use an Allen Wrench to firmly tighten the Bolts in:
A) The Cleaning Tub Mounting Brackets



B) The Handle Mounting Brackets



C) The Tank Mounting Brackets



Installing the Cleaning Brush

1. Open the lid of the Cleaning Tub.
2. Mount the Cleaning Brush Handle to the Handle Retaining Clip in the lid of the Cleaning Tub.



3. Feed the end of the Cleaning Brush Tube through the hole located in the rear right corner of the Cleaning Tub.



4. Pull the length of the Cleaning Brush Tube through the hole in the Cleaning Tub.
5. Now that the length of hose has been pulled through the hole in the Cleaning Tub, align the open end of the tube with the barbed fitting located on the Regulator Assembly.



6. Place the end of the Cleaning Brush Tube onto the barbed fitting located on the Regulator Assembly.
7. Firmly push the Cleaning Brush Tube all the way onto the barbed fitting.



8. Once the hose is firmly in place on the barbed fitting, pull the slack of the hose back within the Cleaning Tub and secure the hose into the Hose Retaining Tabs located on the lid of the Tub.



OPERATION

Always wear protective clothing, gloves, and goggles when using your Parts Washer.

1. Sit it on a firm, flat, level surface in a well ventilated area and away from any open flames.
2. Fill only with a non-flammable water-based degreaser or cleaning agent, such as Simple Green.
3. Follow the degreaser manufacturer's instructions carefully.
4. Do not fill with flammable solvents such as kerosene, gasoline, etc.

Filling Your Parts Washer with Degreaser

⚠ WARNING ⚠

Clean off any accidental splashes of degreaser on skin immediately, following the degreaser manufacturer's instructions carefully. Seek medical attention if necessary.

1. Close the Tank Drain Valve, located at the bottom of the Tank, by rotating the handle until it is perpendicular to the Drain Spout.

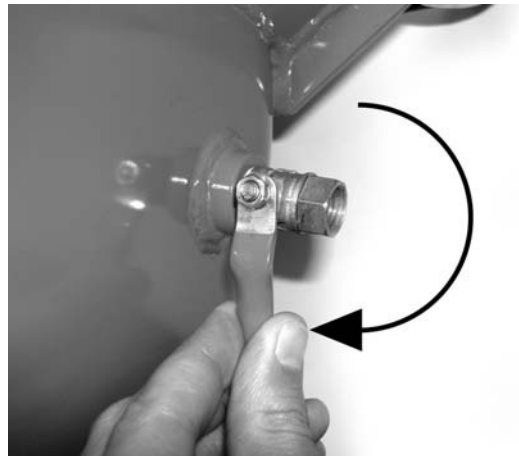

2. Rotate the Flow Control Lever clockwise - this will open the Flow Control Valve and release any pressure from the Tank.

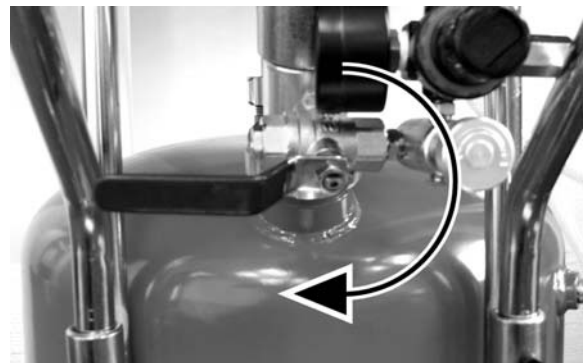

- Open the Tank Reservoir Connector Valve by rotating it counter-clockwise.
Note: The Tank Reservoir Connector Valve is OPEN when it is in a vertical position and CLOSED when it is in a horizontal position.



- Pour the liquid degreaser directly into the Cleaning Tub. Degreaser will flow through the Tank Reservoir Connector Valve and fill the Mobile Tank.
Tech Tip: As you are filling the cleaning tub with liquid degreaser, keep a close watch on the Mobile Tank Level Indicator. Do not fill the Tank beyond the maximum capacity STOP line. If you exceed the STOP line while filling the tank, drain the excess degreaser back into a suitable container by opening the Tank Drain Valve located at the bottom of the Mobile Tank.



Preparing to Connect an Air Compressor to Your Parts Washer

⚠ WARNING ⚠

Before connecting an air compressor to your Parts Washer make sure that the Pressure Regulator has been adjusted to the lowest possible setting, as described below. Failure to do so may result in damage or injury.

Before connecting your Pneumatic/Fluid Parts Washer to an air compressor it is very important that you complete the following steps:

- Set the Regulator pressure to the lowest possible setting by pulling the adjustment knob on the Parts Washer Regulator out (away from the Regulator body) and rotating it counter-clockwise.

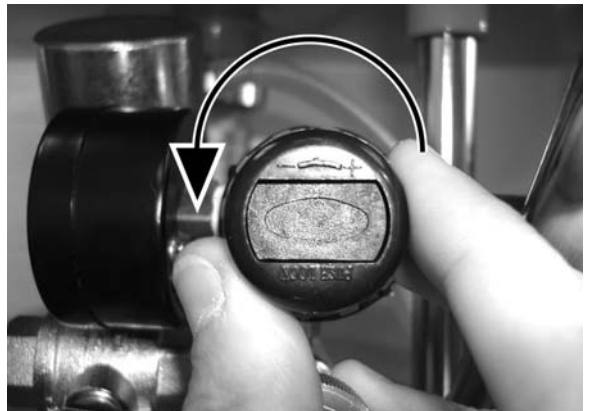

- Make sure your air compressor is set to deliver air pressure between 80 - 120 PSI. NEVER set your air compressor above 120 PSI when connected to the Pneumatic/Fluid Parts Washer. If your air compressor is not capable of delivering air pressure less than 120PSI you MUST install an inline regulator and adjust to 80-120 PSI before attaching your compressor to this Parts Washer.

Connecting an Air Compressor to Your Parts Washer

Once you have properly adjusted the Parts Washer Regulator and your Air Compressor Regulator, as described in the section above, you can attach your air compressor to your parts washer.

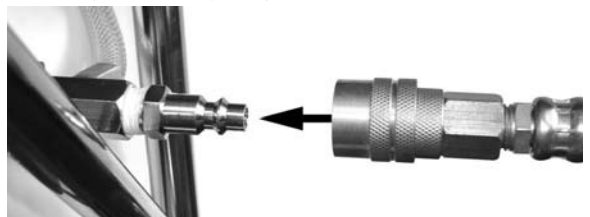

1. Your new Parts Washer includes a 1/4" male coupler. If your air hose does not already have a 1/4" quick disconnect chuck attached, you will need to attach one.
2. Pull back on Air Chuck outer sleeve to allow coupler to be fully inserted into Air Chuck.
3. Insert Coupler into Air Chuck.
4. Verify that air hose is securely connected to Air Chuck by pulling lightly on air hose.
5. With the air hose securely attached to the Parts Washer, turn on your air compressor (making sure the air compressor pressure regulator is set to deliver 80-120 PSI air pressure).

Using the Brush

1. Open the Parts Washer Tub Lid and place the parts to be cleaned on the washboard.
2. Close the Tank Reservoir Connector Valve by rotating it clockwise.
3. Rotate the Flow Control Lever counterclockwise - this will close the Flow Control Valve and allow the Tank to pressurize.

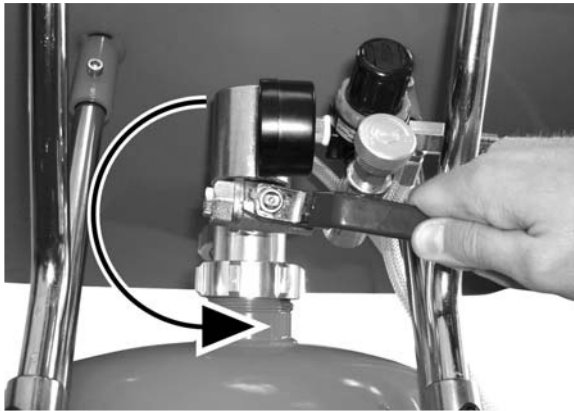

4. Rotate the Pressure Regulator Adjustment Knob clockwise, until the needle on the pressure gauge is in line with the arrow printed on the gauge (approximately 1/2 bar).



5. Once the pressure has been set, push the Regulator Adjustment Knob "IN" (towards the body of the Regulator) to lock it in place.
6. Turn the Flow Control Knob counter-clockwise until the liquid degreaser flows from the Brush. **Note:** If the Flow Control Knob is opened too far the excess air will blow out the discharge valve. If this happens, rotate the Flow Control Knob clockwise until liquid flows from the Brush, but air does not escape through the discharge valve.

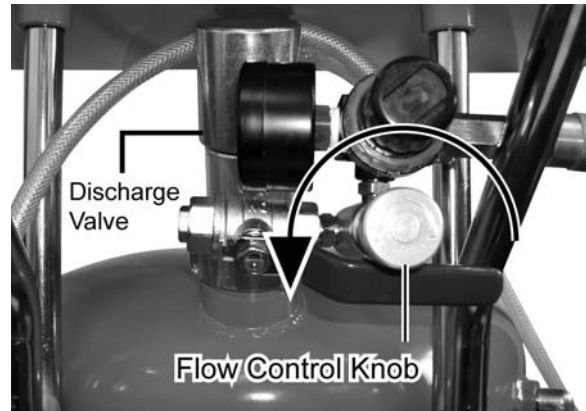

7. Now that liquid is properly flowing to the Brush, you can clean your parts as needed.
8. When you have finished cleaning your parts, rotate the Flow Control Lever to the middle position to turn off the flow of liquid to the Brush.

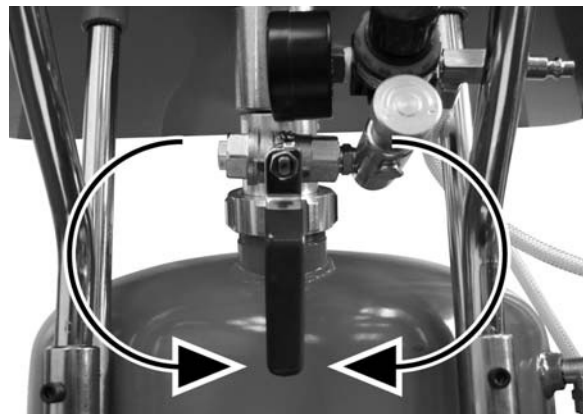

9. Set the Regulator pressure to the lowest possible setting by pulling the adjustment knob on the Parts Washer Regulator out (away from the Regulator body) and rotating it counter-clockwise.
10. Turn off the air compressor and disconnect the air hose from the Parts Washer.
11. Rotate the Flow Control Lever clockwise - this will open the Flow Control Valve and release any pressure from the Tank.

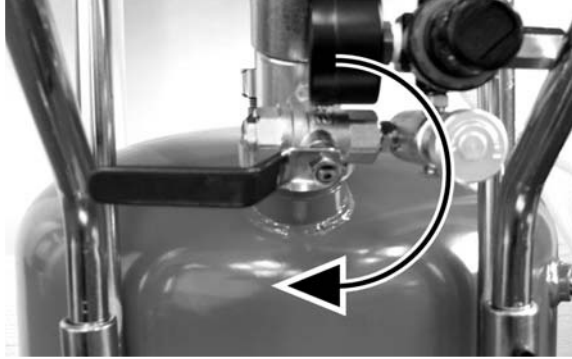

12. Open the Tank Reservoir Connector by rotating it counter-clockwise - this will allow the liquid degreaser to flow back into the tank.

Washing Pieces by Dipping

1. Attach an air source to your Parts Washer, as described in the "ATTACHING AN AIR COMPRESSOR TO YOUR PARTS WASHER" section.
2. Rotate the Flow Control Lever clockwise.
3. Open the Tank Reservoir Connector Valve by rotating it counter-clockwise - this will allow the liquid degreaser to flow from the Tank up into the Cleaning Tub.
4. Rotate the Pressure Regulator Adjustment Knob clockwise, until the needle on the pressure gauge is in line with the arrow printed on the gauge (approximately 1/2 bar).



5. Once the pressure has been set, push the Regulator Adjustment Knob "IN" (towards the body of the Regulator) to lock it in place.
6. Adjust the intensity of the degreaser movement with the Flow Control Knob - turning the knob counter-clockwise will INCREASE the flow rate; turning the knob clockwise will DECREASE the flow rate.
7. When you have finished cleaning your parts,

Rotate the Flow Control Lever to the middle position - this will stop the flow of degreaser completely.

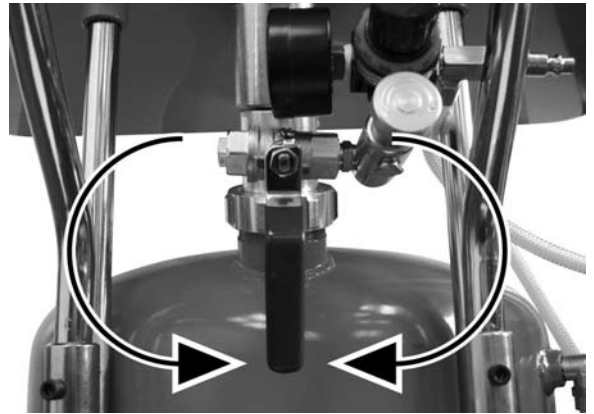

8. Set the Regulator pressure to the lowest possible setting by pulling the adjustment knob on the Parts Washer Regulator out (away from the Regulator body) and rotating it counter-clockwise.
9. Turn off the air compressor and disconnect the air hose from the Parts Washer.
10. Rotate the Flow Control Lever clockwise - this will open the Flow Control Valve and allow the Tank to de-pressurize.

Using the Air Gun

The Air Gun on your Pneumatic Parts Washer can be used for quick removal of loose particles of dirt or debris on the parts you are washing or for quick drying of cleaned parts.

The Air Gun can be used whenever your Parts Washer is attached to an external air supply. To operate the Air Gun, point the end of the Gun at the parts you wish to clean or dry and pull the trigger. When you have finished, release the trigger.

MAINTENANCE

1. Check the condition of the hoses before each use. Do not use a damaged hose. If hoses are cracked or damaged they must be replaced immediately.
2. Change degreaser as needed. Tank can be drained by removing the Drain Plug located on bottom of Tank.
Note: ALWAYS release all pressure from the Tank before attempting to drain the fluid from it.

For replacement parts and service, contact King Tools & Equipment at 1-800-950-5464

TROUBLESHOOTING

PROBLEM	PROBABLE CAUSE	REMEDY
Liquid fails to come out the brush	1. Insufficient liquid in the Tank 2. Wrong amount of air 3. Flow Control Lever in wrong position	1. Fill Tank to STOP line 2. Check air connection, pressure regulator, and flow regulator 3. Rotate Flow Control Lever clockwise to allow liquid to flow to the Brush.
Dirty liquid comes out of the brush	1. Degreaser is dirty	1. Drain the Tank and refill with clean degreaser

#4007-0 - PARTS LIST AND DIAGRAM

Part No.	Description	Qty.
#4007-0-001	NPT1/4" Connector	1
#4007-0-002	Pressure Regulator	1
#4007-0-003	Flow Control Valve Assembly	1
#4007-0-004	Flow Control Lever	1
#4007-0-005	Tank Drain Valve	1
#4007-0-006	Tank Drain Plug	1
#4007-0-007	Screen Plate (small)	1
#4007-0-008	Screen Plate (large)	1
#4007-0-0010	Tub/Handle Support Rod	2
#4007-0-0011	Screen Plate Handle	1
#4007-0-0012	Air Tube & Connector Assembly	1
#4007-0-0013	Cleaning Tub	1
#4007-0-0014	Lid	1
#4007-0-0016	Screen Cover	1
#4007-0-0017	Mobile Tank	1
#4007-0-0018	O-ring	1
#4007-0-0019	O-ring	3
#4007-0-0020	O-ring	1
#4007-0-0021	O-ring	1
#4007-0-0022	O-ring	1
#4007-0-0023	Elbow Connector	2
#4007-0-0025	Pressure Gauge	1
#4007-0-0026	Tank Drain Lever	1
#4007-0-0027	Air Gun	1
#4007-0-0028	Screen Cover Mount	1
#4007-0-0029	Handle	1
#4007-0-0030	Brush Tube	1
#4007-0-0031	Warning Label	1
#4007-0-0032	Brush	1

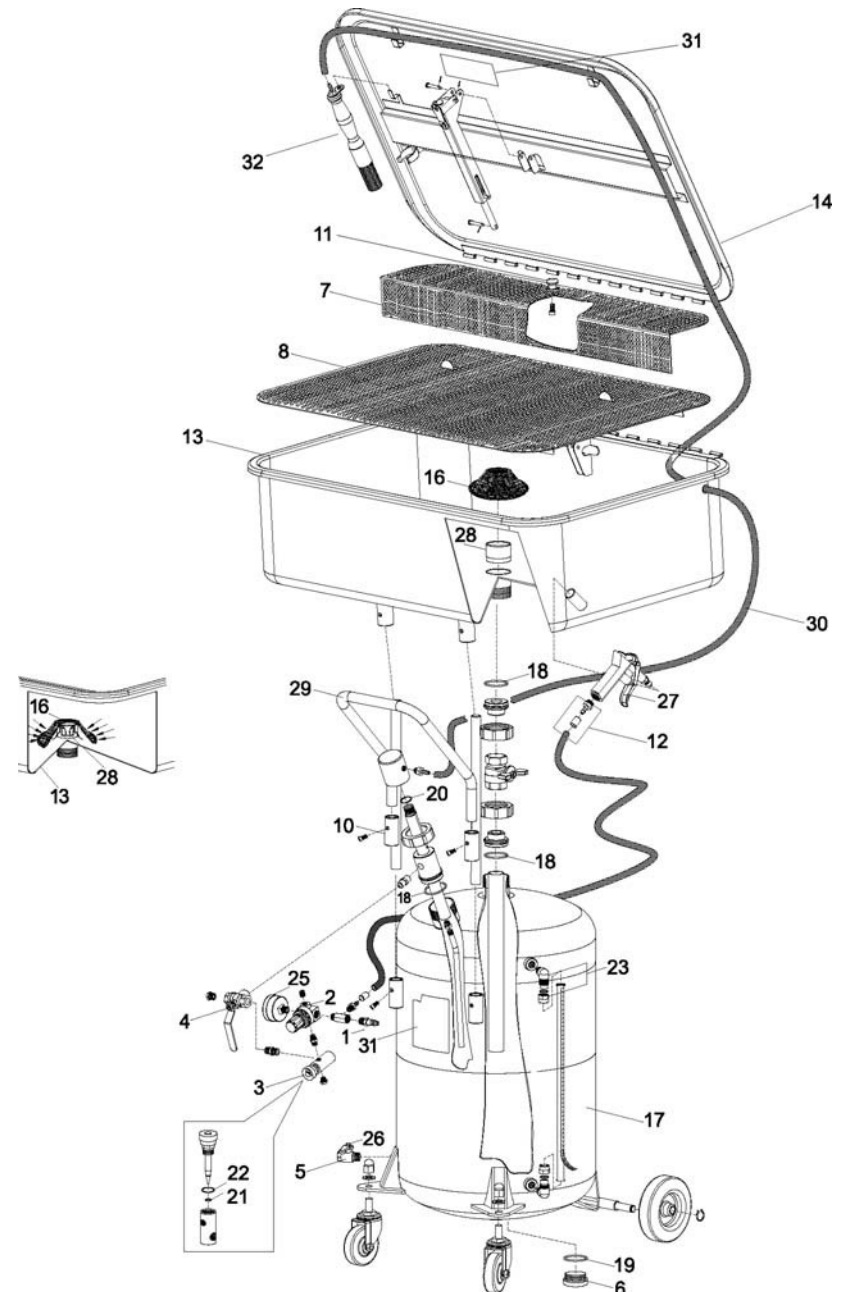

THIS PARTS LIST AND LINE
DRAWING ARE FOR
REFERENCE ONLY.