

WIRELESS WHEEL WEIGHER WIRELESS WHEEL WEIGHER WIRELESS WHEEL WEIGHER

INTERWEIGH
SYSTEMS
INC.



1-800-268-3269

WWW.INTERWEIGH.CA



- WIRELESS WHEEL WEIGHERS
- STRONG
- PORTABLE
- WATER PROOF
- AXLE WEIGHT VERIFICATION
- ELIMINATE OVERLOADING FINES



INTERWEIGH
SYSTEMS
INC.

[Http://www.interweigh.ca/](http://www.interweigh.ca/)

Toll free number 1-800-268-3269



WIRELESS VERSION

M6 STATIC WEIGHING & IN-MOTION WEIGHING

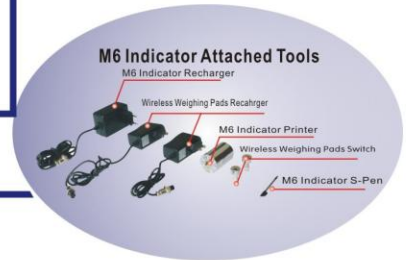

Model	M6
Details	For both Static Weighing & In-Motion Weighing
	High-definition Touch Screen
	With high speed thermal Printer
	Standby working 40 hours battery with auto switch off function
	Unlimited Records stored.
	Running on Windows CE 6.0 system with good compatibility
	Available Program upgrade.
	2 Channels system as default
	4 / 6 / 8 channels system are optional
	RS232, USB 2.0 as default (on Wireless edition USB 2.0 & WIFI as default). Blue tooth & USB 3.0 are optional.
	30 meters working distance for wireless version.
	Each Wheel Weight
	Each Axle Weight
	Total truck weight
	Excel, text or Database file output
	Multiple Languages Supported (Default: English and Chinese. Other languages are optional if required. If require other language, please send the translation to us.)
	4 Cores ARM CPU, 2GB Memory with 4GB Hard Disk (Higher level is optional)
Starting LOGO is customized	
SMS message, iOS application, Android application are optional	
7" screen as default, 10", 13" screen are optional.	

- 1 Tool Box**
Mouse, print paper, etc can be stored in.
- 2 Main board**
Running on Windows CE 6.0 system with good compatibility. 4 Cores ARM CPU, 2GB Memory with 4GB Hard Disk.
- 3 Display**
The XK3101-M6 indicator comes high-definition Touch Screen. 7" screen as default
- 4 Indicator Shell**
Indicator shell adapts with military grade material, compression resistance, damp-proof by sealing.
- 5 Printer**
XK3101-M6 indicator is built-in a high speed thermal printer, printer receipts with 100mm/sec and 202DPI resolutions.
- 6 Interface**
Hook up to a PC or a remote display through the RS232, USB2.0 serial interface port.
- 7 Connections**
It can connect up to 16 weighing pads.
- 8 Interface connector**
Interface connectors use Germany Phoenix (electrical interface is silver plated, the electrical



Toll free number 1-800-268-3269



Low Profile Design including Ramps

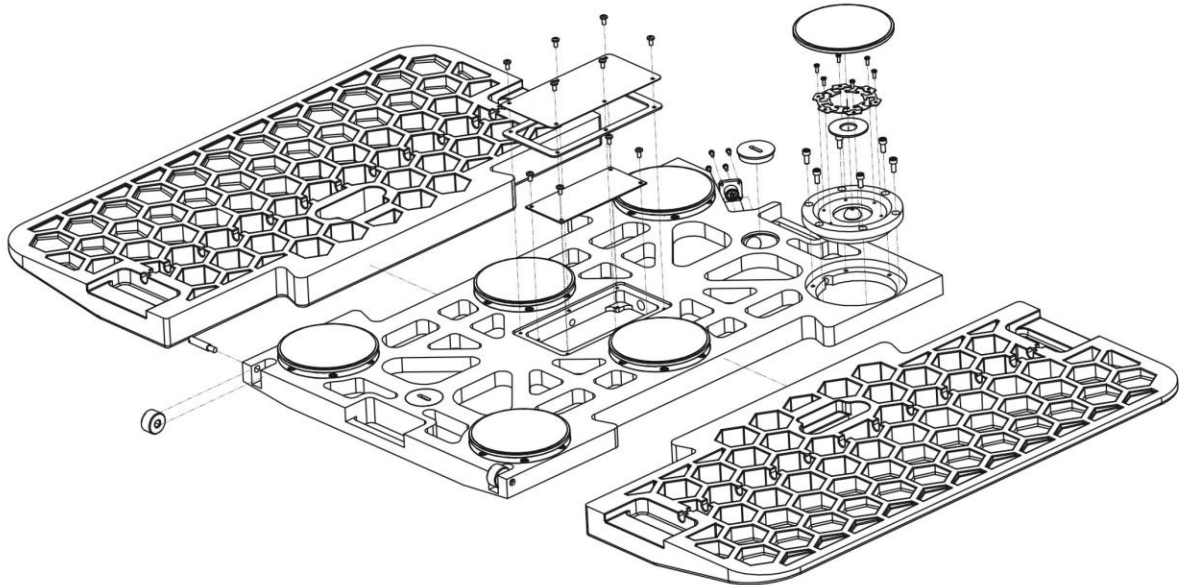
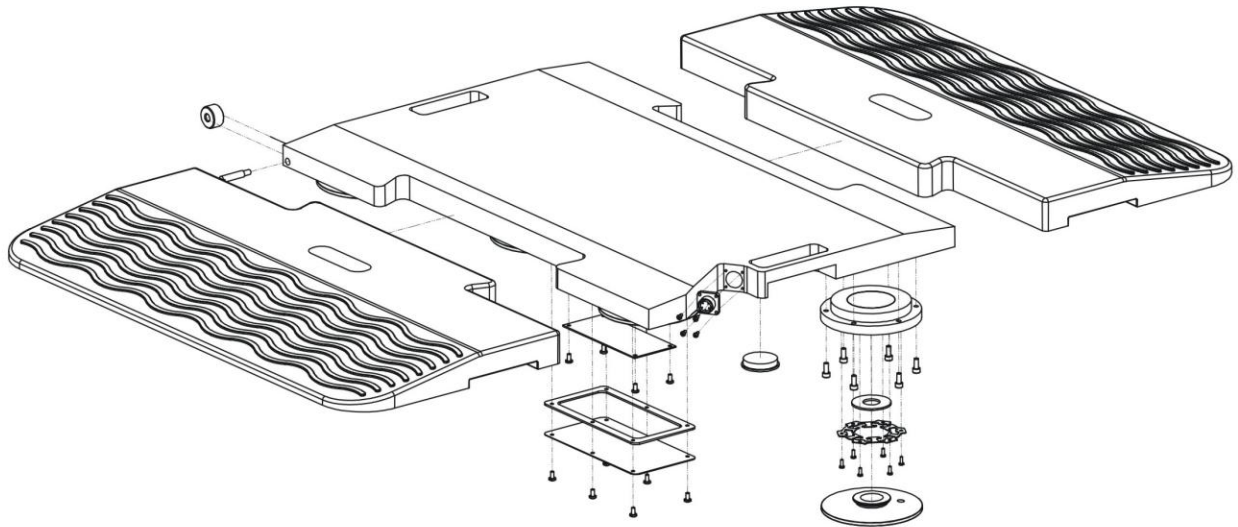

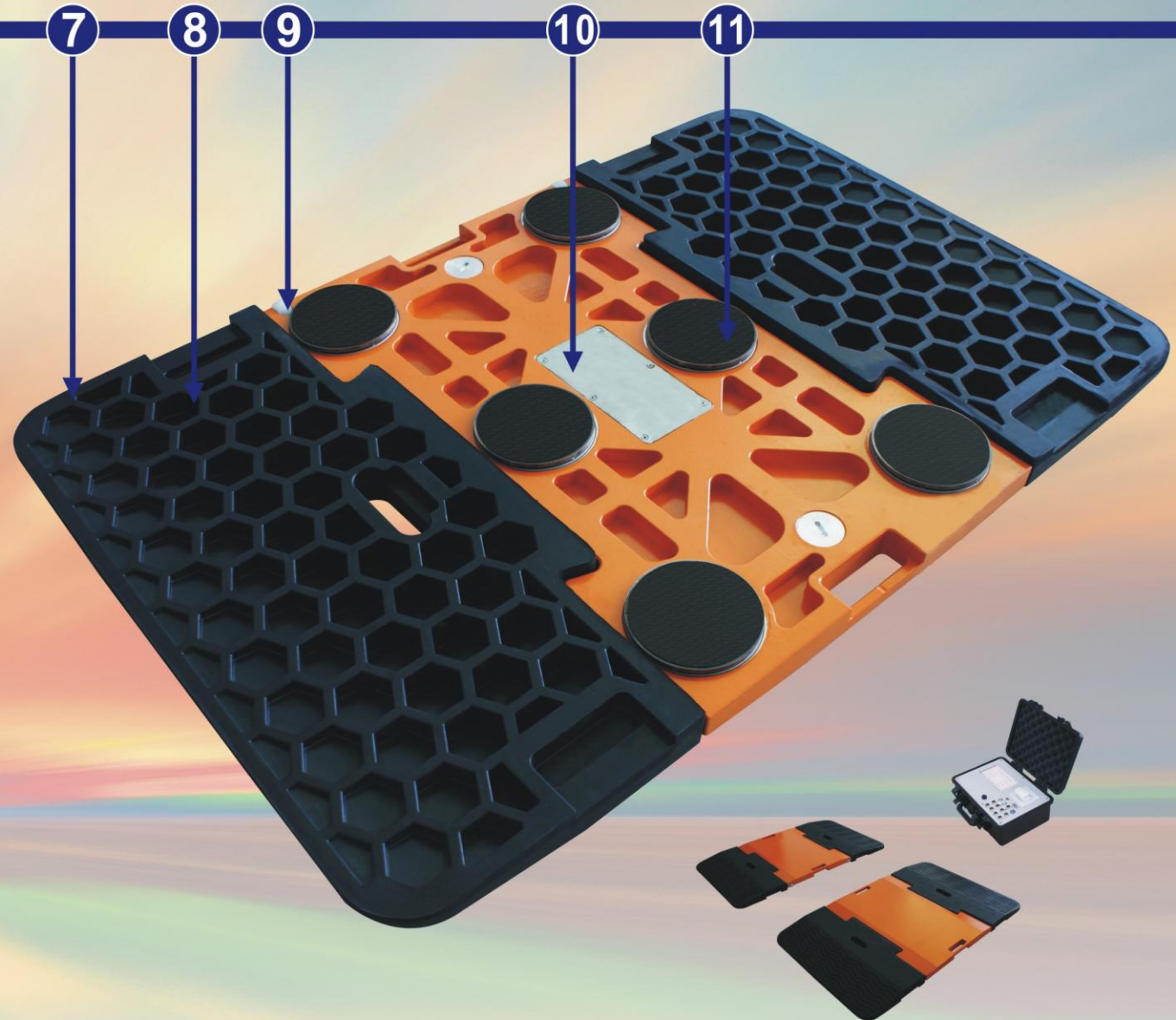

7
High-quality natural rubber or PU rubber precision mold produce, Strong and Durable.



8
Unique honeycomb shape and high strength design, Light, Strong.



9
The platform is with wheels, and easy to move.



10
The water-proof designed Junction box can ensure reliable in the damp environment.



11
The scales are equipped with a high accuracy load cell for reliability and accuracy.

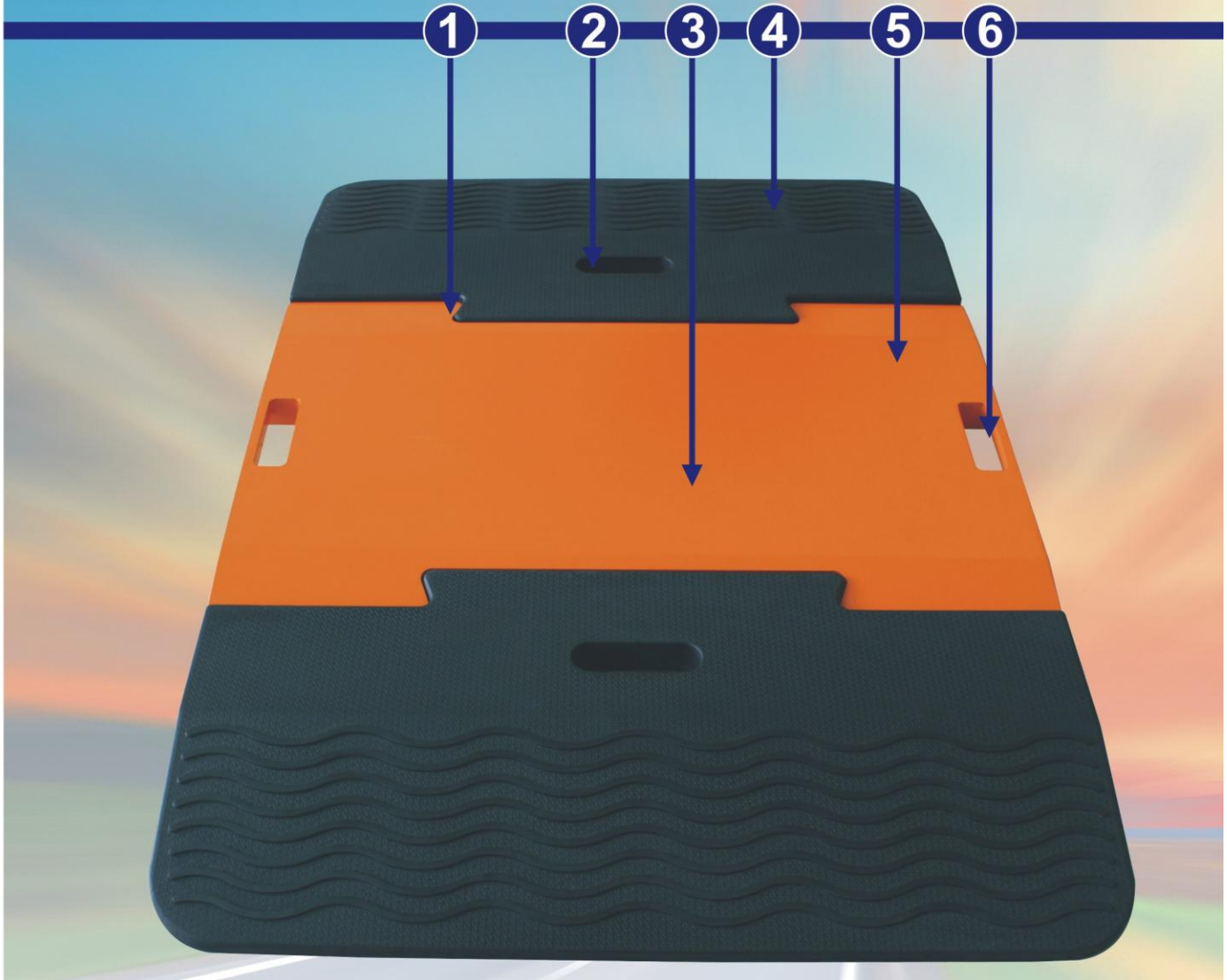

1
The ramps and weighing platform equipped with V type connection -convenient to use.



2
The ramps with handle hole structure, convenient to carry.



3
The platform equipped with high strength aircraft grade aluminum. CNC precision machining processes integrated forming synthesis Strong, Durable, Light.



4
The ramps surface with double antiskid texture design.



5
The weighing platform surface is coated by military grade power Wear-proof and Antiskid and Durable



6
The platform is convenient to carry with handle.



Model	Each Pad Dimension (mm)	Each Ramp Dimension (mm)	Max Axle Capability (1 Pads) (t)	Details	
PAW-C	800x450x35	800x350	1t/1kg 5t/5kg 10t/10kg 15t/15kg	Load cell: 6 Load cell. In-Motion Speed: ≤8km/h.	
Advantage:	<ol style="list-style-type: none"> 1. High density aluminum alloy raw material, light to carry. 2. Water proof. It can be used in raining or snowing environment. 3. Seal protection for normal working environment such as Standard Concrete Road, Flat Construction Site, High Way check, etc. 4. Load cell based on OIML Standard Static accuracy. 5. Wide weighing pads even can carry one axle with 4 wheels. 6. Load cell over load protection with 120% overload protection. 7. Built-in Cable protector to avoid error when cable is broken. 8. Built-in anti-electromagnetic interference to make sure weighing result would not be influenced. 9. Built-in auto compensation system to compensate weighing error on double joint axle or triple joint axle. 10. 1 years warranty . 				
Please Note:	The dimension of pads, weighing capability and cable length are all customizable in case of necessary.				
Optional:	Extra shipping case(plastic).				
Detailed Specifications					
Weighing Capability	Wheel Weight ≤ 15t		Temperature Compensation Range	-10~+50℃	
	Axle Weight ≤30t		Sensitive Influence by Temperature	0.1%/10℃	
Sensitive	1±0.2 MV/V	Nonlinearity	≤0.10%	Zero Temperature Influence	0.1%/10℃
				Excitation Voltage	20V (DC)
Repeat ability	≤0.01%FS	Zero Output	4~10%	Insulation Resistance	≥5000 MΩ(100VDC)
				Working Temperature	-40~+80℃

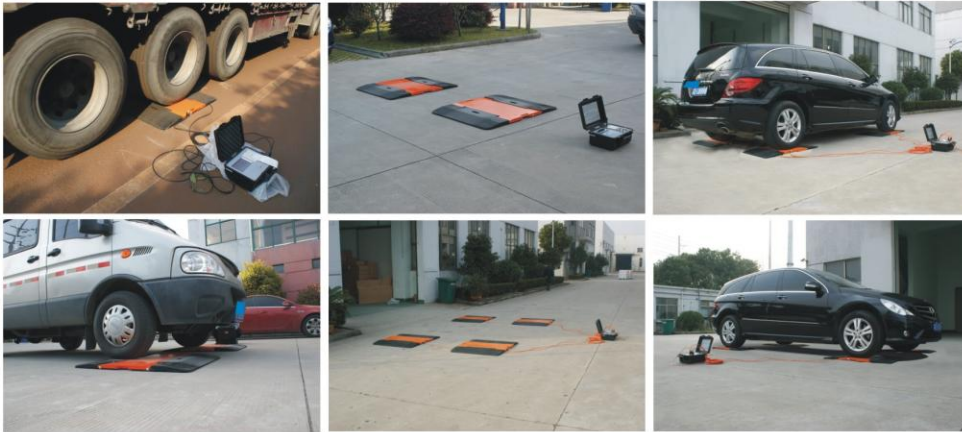

Unit: mm

