



Assembly Instructions Sheet #SML2216

Tools Required: Flathead screwdriver, Phillips screwdriver, pliers, wire cutters, wire strippers, electrical tape, safety glasses.
Light Source: G9 Base Clear G9 Bulbs 40W Maximum (supplied).
Estimated Assembly Time: 20-30 minutes.
Preparation: Identify and inspect all parts before beginning installation. Check package contents and diagrams below to be sure all parts are present. If any parts are missing or damaged, do not attempt to assemble, install, or operate the fixture. Contact customer service for replacement parts.

Warnings and Cautions

Turn off electricity at circuit breaker or main fuse box before installation. Consult a licensed electrician if in doubt.
 These instructions are provided for your safety. It is very important you read them completely before installing the fixture. We strongly recommend that a licensed professional electrician perform the installation.
 Disconnect fixture from power source before replacing bulbs. Make sure bulbs are given sufficient time to cool before removal.
 Do not touch the bulb with bare hands use a cloth or glove.

Package Contents

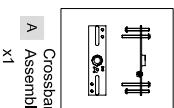

A Crossbar Assembly x1

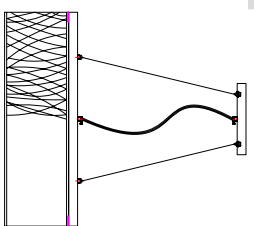

B Fixture Body x1



C Allen Wrench x1



D 68PCS Crystals



Figure 1

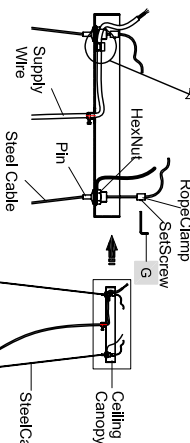
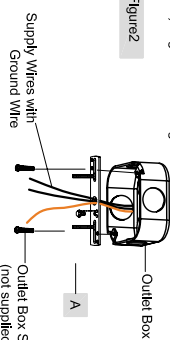

Figure 2

STEP 2-Install Inner Backplate

A. Pass the supply wires with ground wire through inner backplate (A). Attach Inner Backplate (A) to Outlet Box with the head of Green Ground Screw facing you. Secure it with Outlet Box Screws (not included). Tighten until snug.



STEP 3-Make Wire Connections

A. Use standard wire connectors (not included) to make all wire connections. Twist connectors until wires are tightly joined together. Wrap each connection with approved electrical tape and carefully stuff all the connected wires into the Outlet Box.

B. If the electrical wire is going to be cut shorter than provided, strip back the clear wire covering the 3 fixture wires as far as you need to. This will expose each fixture wire individually. Strip each end of 3 fixture wires.

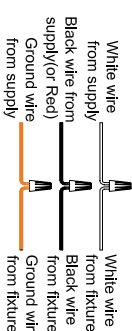

STEP 4-Install Fixture Body

A. Carefully tuck all wires into the outlet box and position the ceiling canopy (D) over the outlet box. Align the holes in the Ceiling Canopy (D) with the mounting screws, then attach the Ceiling Canopy (D) using the previously removed mounting balls. Hand tighten until snug.

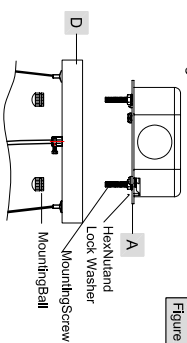

Figure 4

STEP 5-Install Bulbs

A. Insert bulbs (B) into sockets and push snugly into place.

B. Attach Crystal Strings (D) to shade (C) locations.

IMPORTANT:
Do not touch the bulb with bare hands use a cloth or glove.

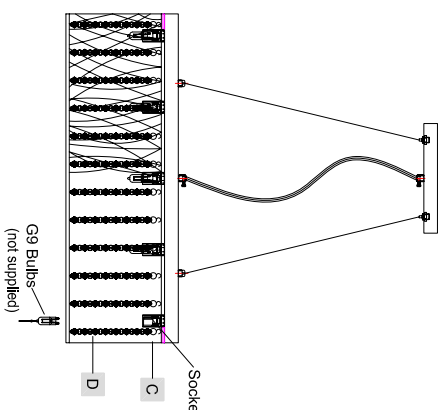

SML2216

OVERALL HEIGHT, 47"

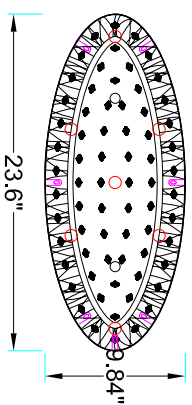
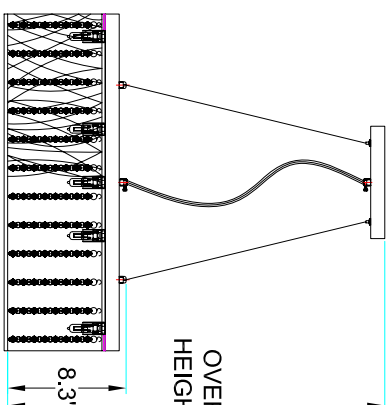

NOTE: ALL DIMENSIONS ARE ROUNDED UP TO THE NEAREST 1/4"