

**6Ft x 9Ft**  
**Gable Porch Shed**

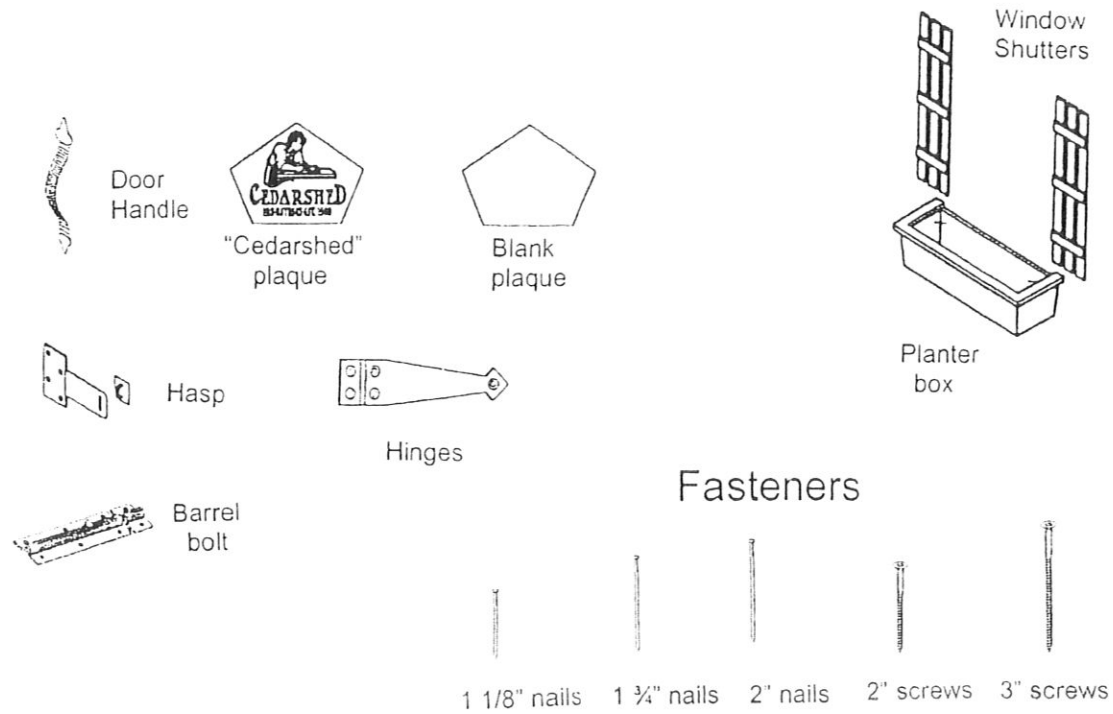

# ACCESSORIES AND HARDWARE



## 6 ft x 9 ft PORCH STYLE SHED

PART #	DESCRIPTION	DIMENSIONS (where app.)	# OF PCS
<b>ACCESSORIES</b>			
P-H-PLAQL	Peak CS plaque	peak CS plaque	1
P-H-PLAQLN	Peak Plaque	Peak Plaque	1
PART #	DESCRIPTION	DIMENSIONS (where app.)	# OF PCS
<b>FASTENERS</b>			
P-H-NL1.125	1 1/8" nails	1 1/8" nails	25
P-H-NL1.75	1 3/4" nails	1 3/4" nails	275
P-H-NL2	2" nails	2" nails	50
P-H-SC2	2" screws	2" screw	175
P-H-SC3	3" screws	3" screw	300

Instruction manual, questionnaire and driver bit

PART #	DESCRIPTION	DIMENSIONS (where app.)	# OF PCS
<b>SLIDING DOOR DOOR PARTS AND HARDWARE</b>			
C-DR-007	sliding door	sliding door	1
P-KK32I	door guide	3/4 x 3/4 x 32 5/8	1
P-1273C	door stop	1 x 2 x 73 1/4	1
P-1340B	hasp trim	1 x 3 x 40 1/8	1
P-1364	track fascia	1 x 3F x 64	1
P-2264	door trim with track attached	2 x 2 x 64	1
P-H-TRAC64	door track	64"	1
P-H-WHEE	sliding track wheels	sliding track wheels	2
P-H-DHAND	door handle	door handle	1
P-H-HASP	hasp	hasp	1

PART #	DESCRIPTION	DIMENSIONS (where app.)	# OF PCS
<b>DUTCH DOOR DOOR PARTS AND HARDWARE</b>			
C-DR-013	Dutch door	Dutch door	1
P-1172G	door stop	1 x 1 x 72 1/2	2
P-1130G	door stop	1 x 1 x 30 1/2	1
P-H-DHAND	door handle	door handle	1
P-H-THINGE4	t-hinges	4 inch	4
P-H-HASP	hasp	hasp	1
P-H-BBLT	barrel bolt	barrel bolt	1

CD69 layout

GD69 layout

WALL PANEL PLACEMENT

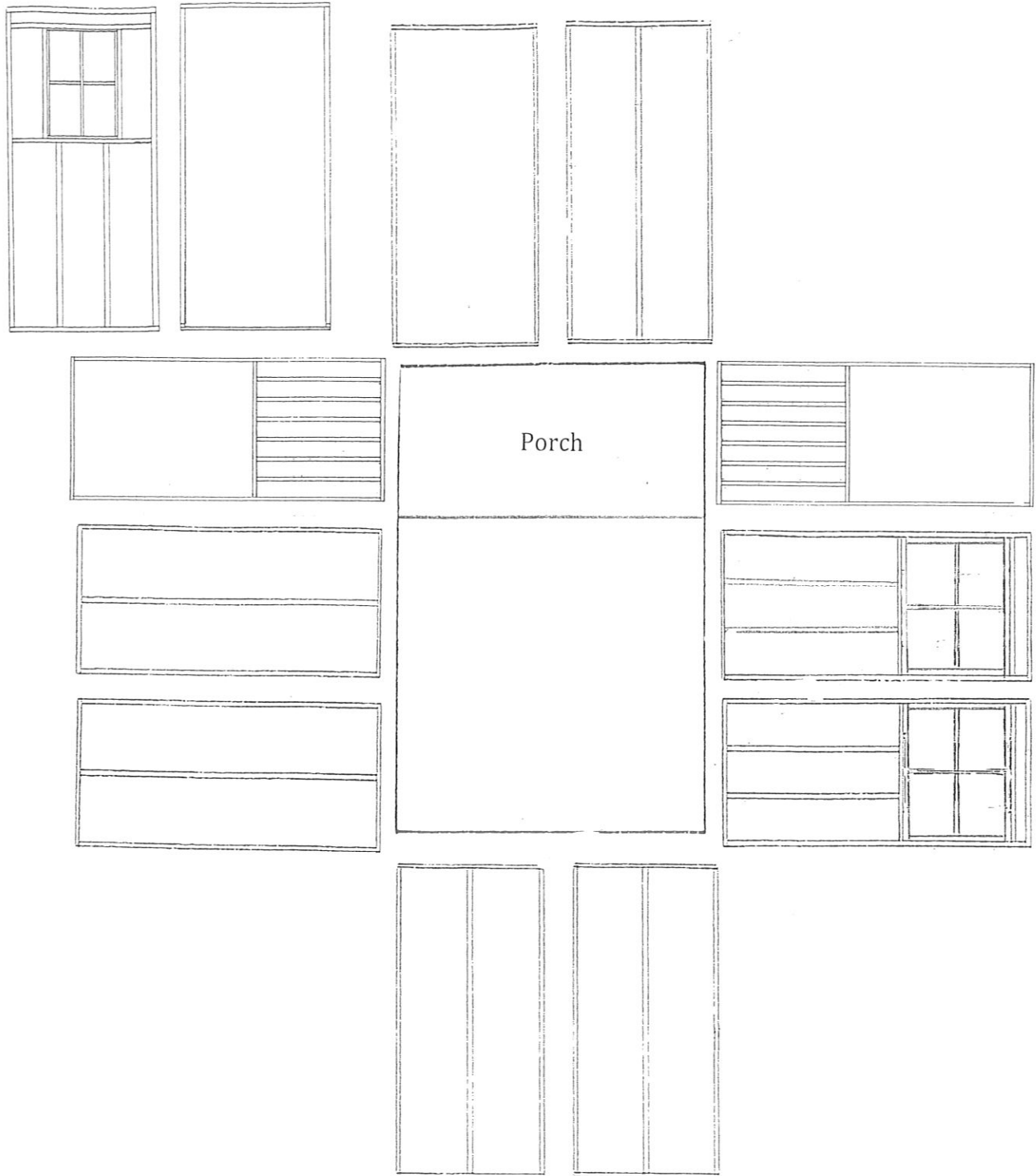

PART #	DESCRIPTION	DIMENSIONS (where app.)	# OF PCS	CODE
<b>WALL PARTS</b>				
P-2334G (GD69)	header	2 x 3 x 34 1/2	5	
P-2334G (CD69)	header	2 x 3 x 34 1/2	4	
C-BW-002 (GD69)	wall panel	blank wall 34 1/2" wide	5	
C-BW-002 (CD69)	wall panel	blank wall 34 1/2" wide	4	
C-DF-003	door frame	door frame	1	
C-WW-006 (GD69)	window wall	awning windows	2	
C-WW-011 (CD69)	window wall	awning windows	3	
C-PR-004	porch walls	porch walls	2	

## TOP PLATE DETAILS

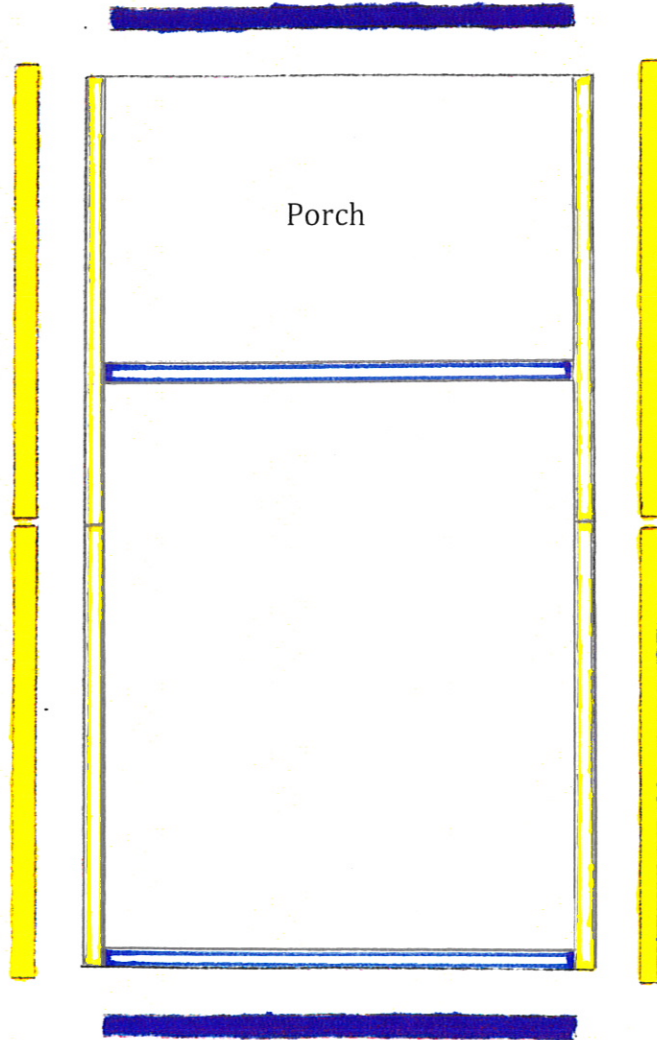

PART #	DESCRIPTION	DIMENSIONS (where app.)	# OF PCS	CODE
<b>TOP PLATES</b>				
P-2354C	top plate	2 x 3 x 54 1/4	4	
P-2364	top plate	2 x 3 x 64	2	
P-2354C	top plate locations	2 x 3 x 54 1/4	4	
P-2364	top plate locations	2 x 3 x 64	2	

# ROOF PANEL & PARTS

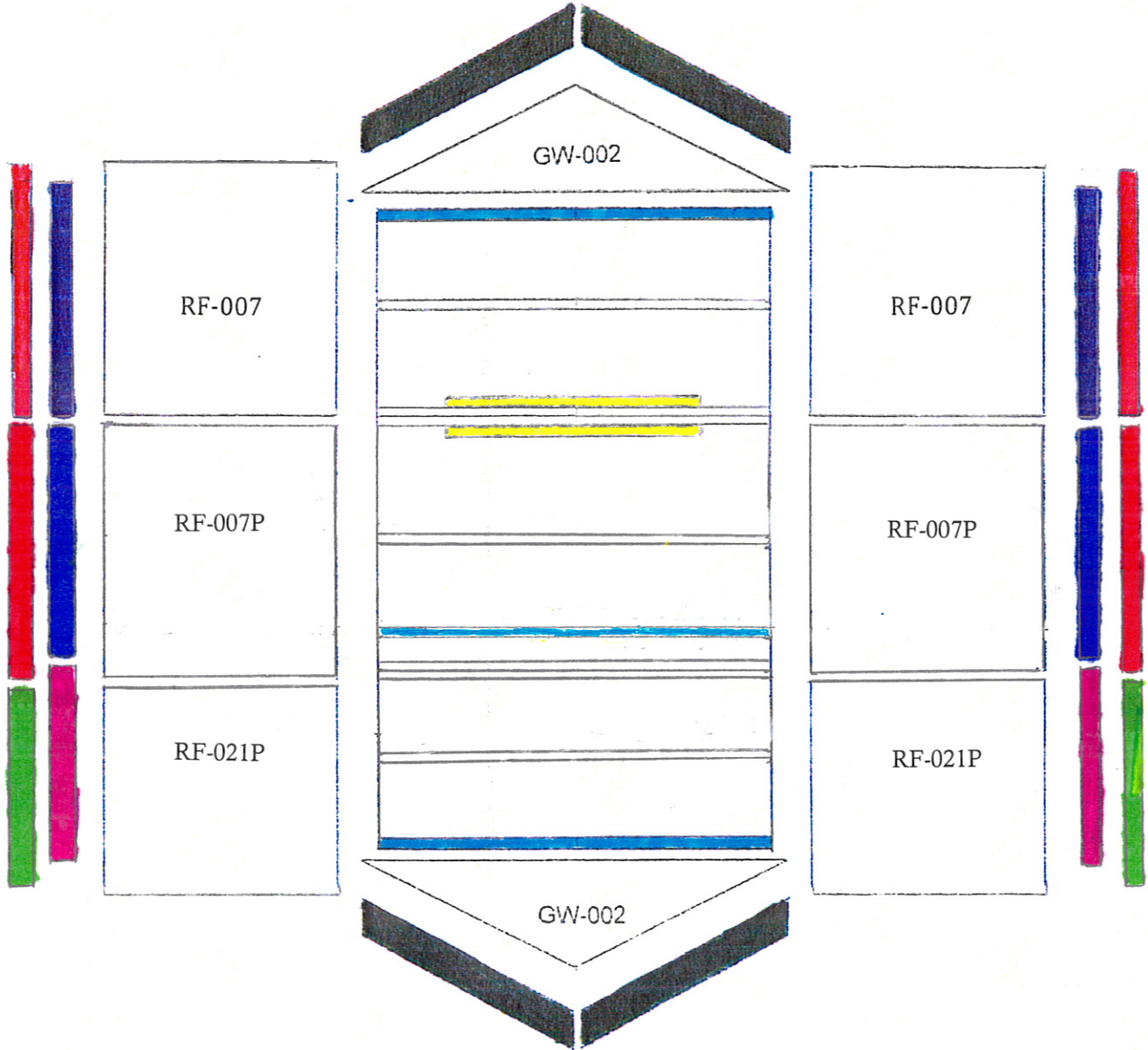

PART #	DESCRIPTION	DIMENSIONS (where app.)	# OF PCS	CODE
P-2342Yb	gusset	2 x 3 x 42	2	
P-RF-007	wood roof panel	42 x 42 3/4	2	RF-007
P-RF-007P	wood roof panel	42 x 42	2	RF-007P
P-RF-021P	wood roof panel	42 x 35 1/4	2	RF-021P
C-GW-002	gable wall	gable walls	3	GW-002
P-B-G437	soffit	1/2 x 4 x 37	4	
P-B-G434G	soffit	1/2 x 4 x 34 1/2	2	
P-1434G	fascia	1 x 4 x 34 1/2	2	
P-1442	fascia	1 x 4 x 42	4	
P-1446Ya	gable fascia	1 x 4 x 46	4	
P-H-RFLT12	roofing felt	1 ft x 5 ft	5 sq ft	not shown
P-H-MFLASS	roof flashing	3" x 12"	16	not shown
P-H-RCAP24	ridge caps	24"	16	not shown
GABLE LOCATIONS				

## PORCH WALL TRIM DETAIL

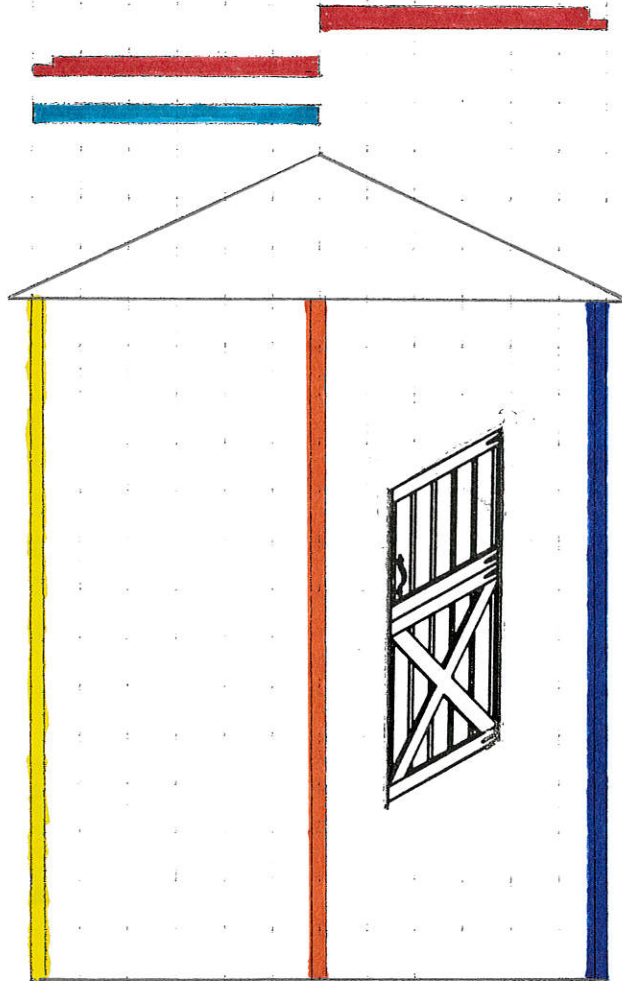

PART #	DESCRIPTION	DIMENSIONS (where app.)	# OF PCS	CODE
<b>DOOR WALL TRIM PARTS</b>				
P-1273C	trim	1 x 2 x 73 1/4	1	
P-13C73C	trim	1 x 3 1/4 x 73 1/4	1	
P-12C73C	trim	1 x 2 1/4 x 73 1/4	1	
P-B-G1K33	skirting	1/2 x 1 3/4 x 33	1	
P1335C	top trim (notched end)	1 x 3F x 35 1/4	2	

\*\*\*Note: The diagram shows the door placed the right side of the porch. The vertical trim boards would be reversed if the door is placed on the left side of the porch.\*\*\*

## TRIM DETAIL

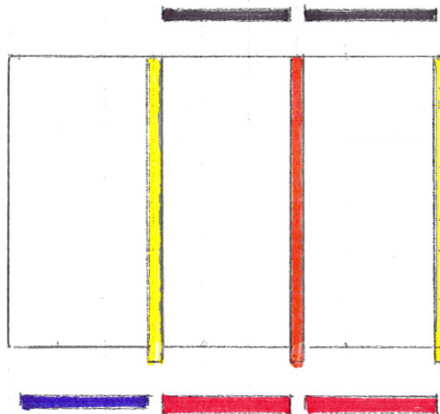
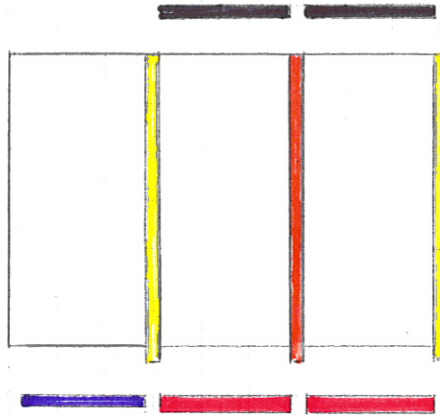
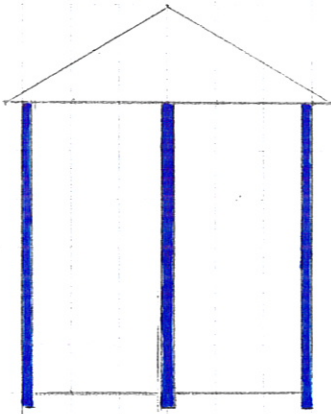
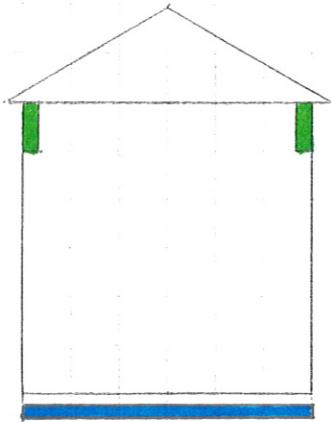

PART #	DESCRIPTION	DIMENSIONS (where app.)	# OF PCS	CODE
<b>TRIM PARTS</b>				
P-1279C	trim	1 x 2 x 79 1/4	2	
P-1280G	trim	1 x 2 x 80 1/2	3	
P-13C79C	trim	1 x 3 1/4 x 79 1/4	4	
P-B-G433	skirting	1/2 x 4 x 33	4	
P-B-G633	skirting	1/2 x 6 x 33	8	
P-14B34G	porch skirting	1 x 4 1/8 x 34 1/2	2	
P-14B70G	porch skirting	1 x 4 1/8 x 70 1/2	1	
1312XF	porch trim	1 x 3 x 12	2	