

2022+ Toyota Tundra

3.4L i-Force

CC0020



IMPORTANT! WARRANTY AND INSTALLATION INSTRUCTIONS

Please Forward All Information to Consumer

Be sure to review the enclosed instructions prior to beginning the installation process. If you have any questions about the enclosed parts or instructions, or if you encounter a problem during installation:

CALL TECHNICAL SUPPORT: 440.891.0999 or 800.486.0999

**TO ACTIVATE YOUR WARRANTY GO TO:
[CORSAPERFORMANCE.COM/WARRANTY](https://corsaperformance.com/warranty)**

COLOR INSTRUCTIONS ARE AVAILABLE BY PART NUMBER ON: [CORSAPERFORMANCE.COM](https://corsaperformance.com)



NEVER work on a hot engine bay.
Allow time for the vehicle to cool.

INSTALL DIFFICULTY 

Not Intended for Hybrid iForce Max

RECOMMENDED TOOLS & SUPPLIES

- 10mm Socket
- Screw Driver
- 2.5mm Hex Wrench
- 1/4" Socket or Driver
- 1/4" Drive Ratchet
- 11/16" Wrench
- Cutting Pliers
- Long Needle Nose Pliers
- Flexible Locking Pliers

Please take time to read and understand these installation instructions.

CORSA recommends that the installation of this system be performed by a qualified service center or professional installer who has the necessary equipment, tools, and experienced personnel. However, if you decide to perform this installation yourself, the use of an additional person may be required.

WARNING: This kit is not recommended to be installed on the hybrid iForce Max variant of the 3.4L Tundra due to the proximity of the high voltage wires of the hybrid system.

WARNING: Never work on a hot engine bay. Allow time for the vehicle to cool.

This warranty does not extend to damaged or defect in the finish of a product or to any product, that in the opinion of CORSA Performance, has been misused, damaged by accident or negligence, altered or modified in any way, faulty installation or installed contrary to CORSA installation instructions, or repaired by an unauthorized service facility.

Full warranty available on www.corsaperformance.com

Please confirm that all parts are present according to the bill of materials before beginning the installation.

If something is missing call Tech Support at 440.891.0999 or Toll Free: 1.800.486.0999

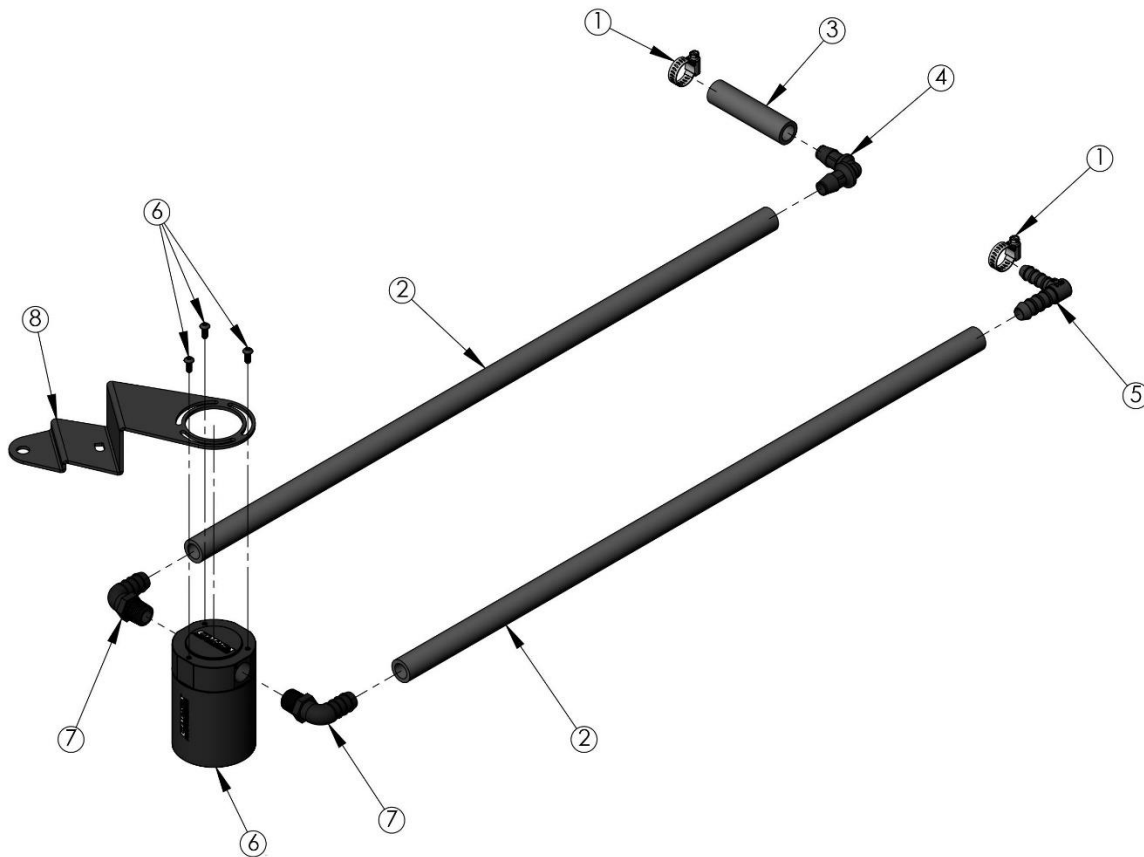

HARDWARE KIT

1. SAE #6 Hose Clamp	2	4. 1/2" Barb Fitting	1	7. 1/2" Barbed to 3/8" NPT Fitting	2
2. 1/2" Hose x 24" Long	2	5. 12mm to 10mm Barb Fitting	1	8. Mounting Bracket:	1
3. 1/2" Hose x 3" Long	1	6. Corsa Catch Can Assembly	1		

REMOVAL INSTRUCTIONS

FACTORY PCV LINE

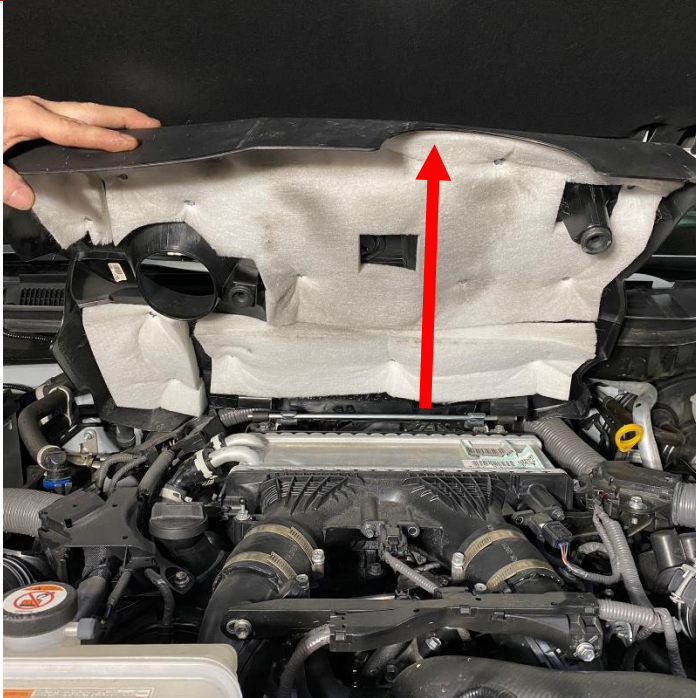

1. Remove the engine cover by pulling up from the front of the cover, then pulling out towards the front of the vehicle.

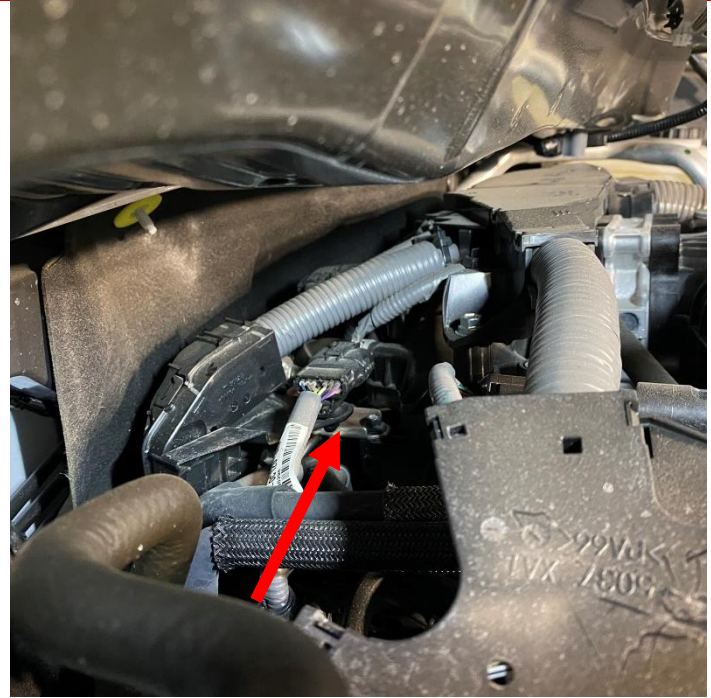

2. Looking at the rear of the engine, from the passenger side, locate the above pictured wiring harness connector. Remove the connector from the bracket, by squeezing the two tabs using a flat head screwdriver from underneath the bracket.

NOTE: Disconnecting the wiring harness will provide additional clearance for the following steps.

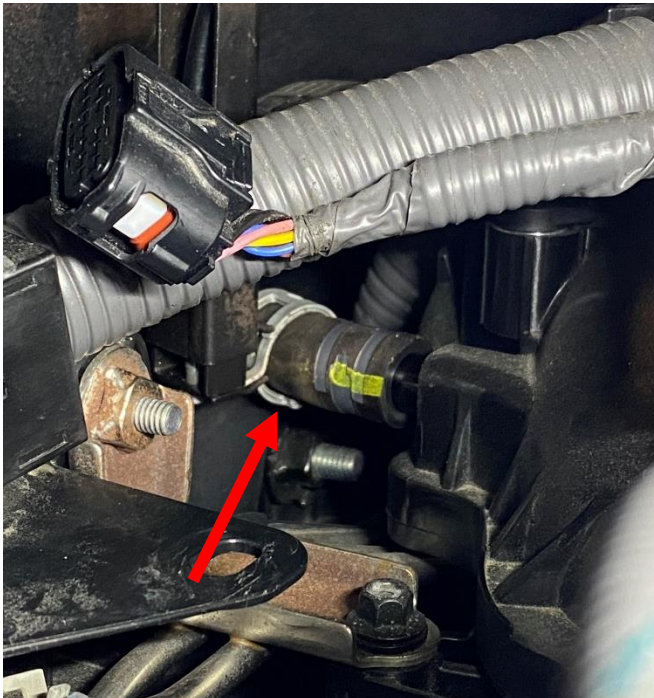

- 3.** Locate where the PCV hose connects to the intake manifold at the rear of the engine. Loosen the constant tension clamp by squeezing the two tabs together and slide it down the hose. Carefully remove the rubber PCV hose from the fitting and then remove the constant tension clamp.

NOTE: There is very limited space to access the hose and clamp. Flexible clamp pliers or a long needle nose pliers will make this slightly easier.

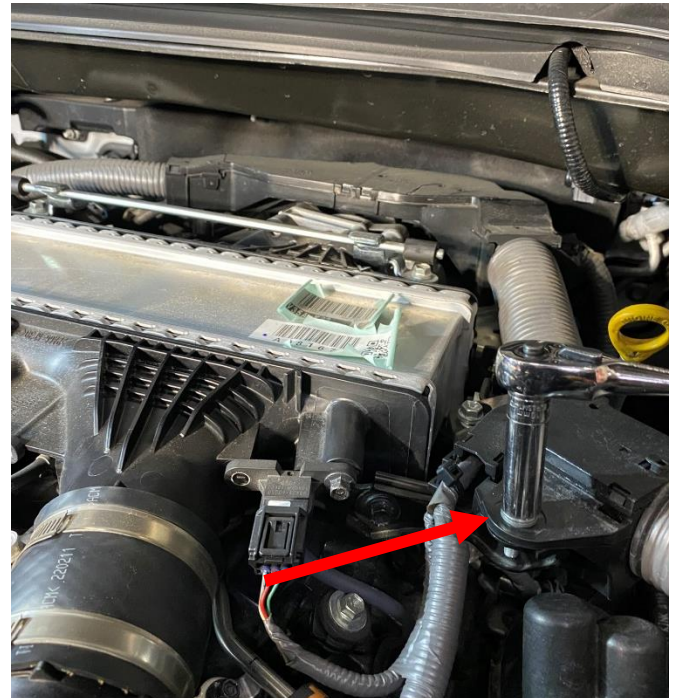

- 4.** Using a ratchet and 10mm socket, remove the single bolt securing the main wiring harness just off to the driver side of the engine. Place the bolt in a safe location as it will be used during the installation of the catch can system.

This concludes removal instructions.

INSTALLATION INSTRUCTIONS

CORSA CATCH CAN SYSTEM



1. Install both 90 degree barb to 3/8" NPT fittings to the catch can using an 11/16" wrench. The barbed end of the fitting should be facing away from the vertical Corsa logo on the catch can body. **IMPORTANT:** Corsa highly recommends using thread sealant or PTFE tape on threaded fittings to prevent any leaks.

2. Using a 2.5mm hex key, remove the 3 screws from the top of the catch-can assembly. Align the bracket so that it is approximately at the 8 o'clock position relative to the etch Corsa logo atop the catch can and secure using the 3 screws and 2.5mm hex. Do not fully tighten the bolts at this time.

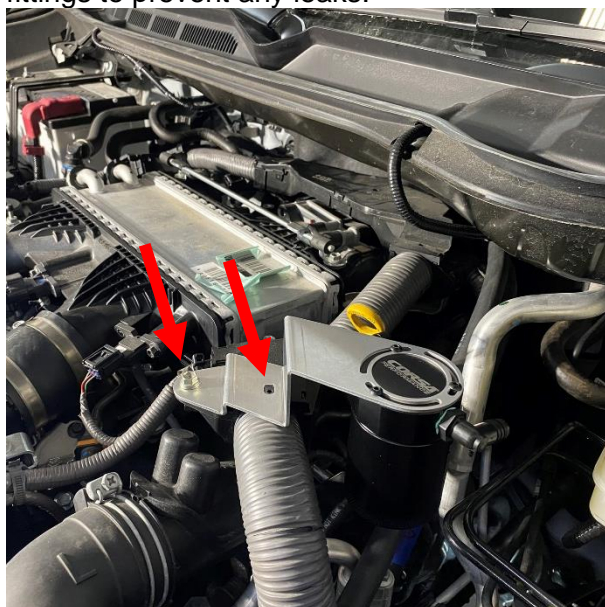

3. Align the mounting bracket hole with the threaded hole and plastic tab on the engine wiring harness. Using the bolt removed during step 4 of the removal portion of these instructions, secure the bracket using a 10mm socket and ratchet.

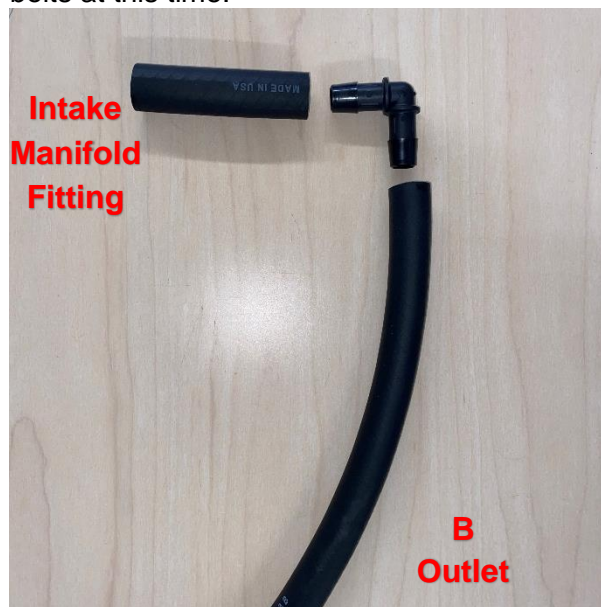

4. Locate the supplied 1/2" 90 degree barbed fitting, one of the two 24" long x 1/2" hoses and the smaller 3" long x 1/2" hose. Connect the two hoses using the fitting, ensuring the hoses are fully seated.



- 5.** Slide the supplied #6 SAE hose clamp over the smaller 3" long hose. Next, slide the 3" long hose over the PCV fitting on the vehicle intake manifold, ensuring the hose is fully seated on the fitting. Position and secure the SAE #6 hose clamp over the hose and fitting using a 1/4 socket.

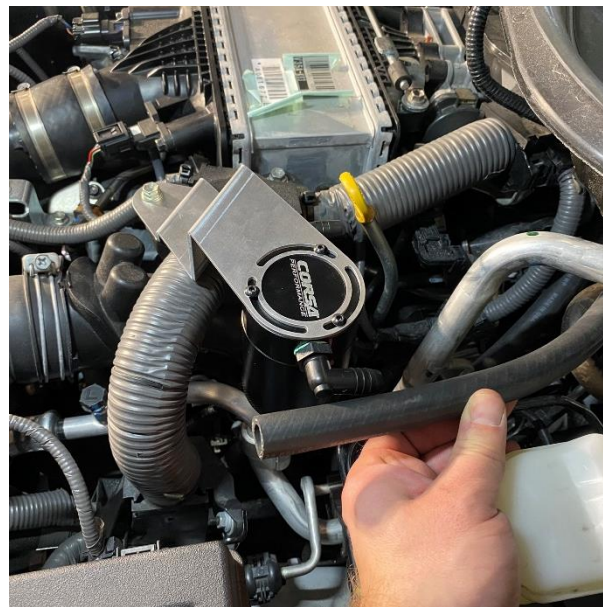

- 6.** Route the open end of the 24" long x 1/2" hose along the firewall and to the B outlet fitting of the catch can assembly. Trim away any excess length from the hose and insert it onto the fitting until the hose is fully seated.

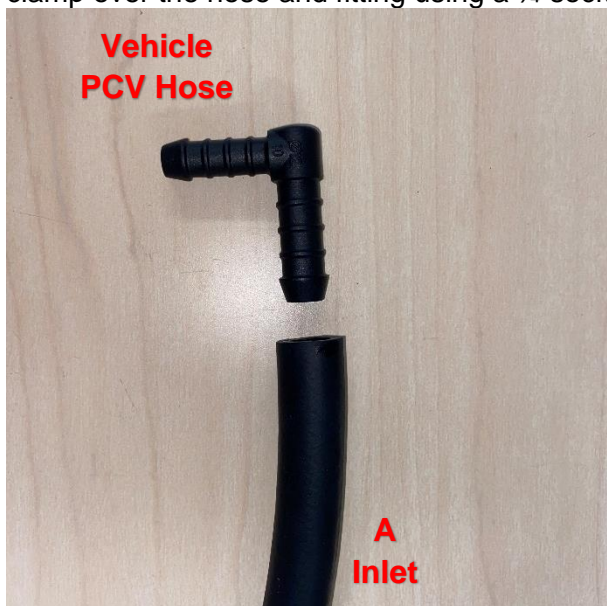

- 7.** Locate the supplied 12mm to 10mm 90 degree barbed fitting, one of the two 24" long x 1/2" hoses and the stock constant tension clamp removed from step 3 of the removal portion of these instructions. Slide the constant tension clamp over one end of the 1/2" hose approximately 2" down. Insert the 12mm barb into the 1/2" hose until it is fully seated and secure with the clamp.



- 8.** Slide the supplied SAE #6 hose clamp over the rubber PCV line located at the rear of the engine. Insert the 10mm barb portion into the vehicles PCV hose and secure using the SAE #6 clamp and 1/4" socket.

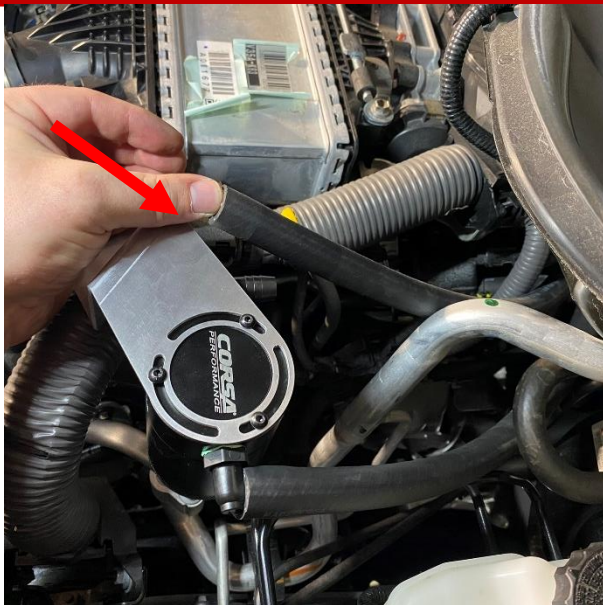

- 9.** Route the open end of the 24" long x 1/2" hose along the firewall to the A inlet fitting of the catch can assembly. Trim away any excess length from the hose and insert it into the A inlet fitting until the hose is fully seated.

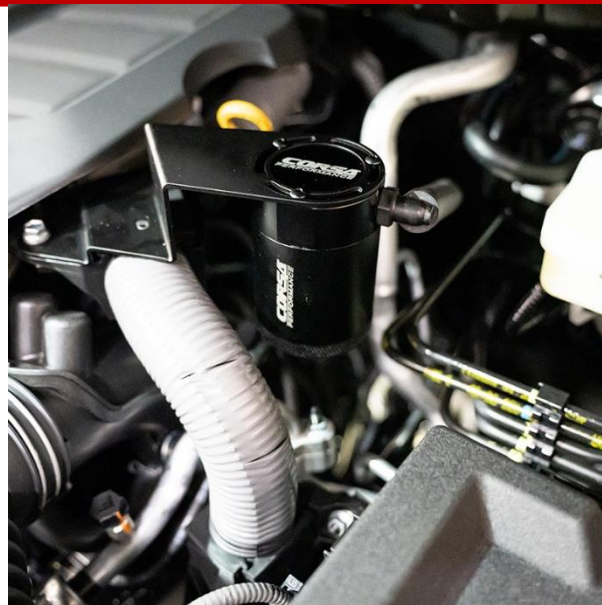

- 10.** Adjust the rotation of the catch can assembly per the hose routing and fully tighten the 3 screws securing the catch can to the mounting bracket using a 2.5mm hex key.

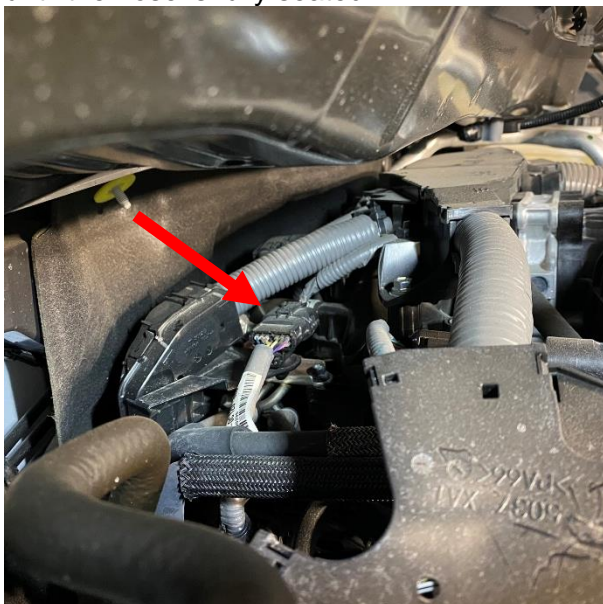

- 11.** At this time, adjust the hose routing as necessary. If the wiring harness from step 2 of the removal portion of these instructions was disconnected, reconnect the wiring harness and secure it to the bracket.

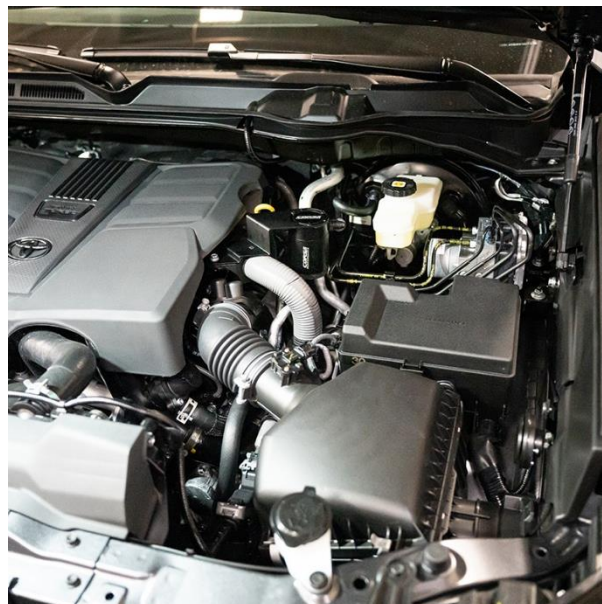

- 12.** Reinstall the engine cover by first aligning and inserting the rear pivot points, then lower the front of the cover until the tabs click into place.

This concludes installation instructions.

*Check that this catch can complies with your Federal, State and Local laws.
We recommend saving your stock constant tension hose clamp.*

BEFORE ROAD TESTING

- 1.** Start engine, leaving the transmission in park and securing the parking brake.
 - 2.** Make sure to look and listen for any unusual noises or air leaks. Repair problems if needed.
 - 3.** Once completed it will be necessary to check periodically, after a few heat cycles, for realignment and tightening of all connections.
-

EMPTYING CATCH CAN: Twist off the bottom of the catch can and dispose of collected oil. It is recommended to check and empty the catch can with every oil change.