

2021+ Ford Bronco

2.3L

Part #: CC0018

CORSA
PERFORMANCE



IMPORTANT! WARRANTY AND INSTALLATION INSTRUCTIONS

Please Forward All Information to Consumer

Be sure to review the enclosed instructions prior to beginning the installation process. If you have any questions about the enclosed parts or instructions, or if you encounter a problem during installation:

CALL TECHNICAL SUPPORT: 440.891.0999 or 800.486.0999

**TO ACTIVATE YOUR WARRANTY GO TO:
CORSAPERFORMANCE.COM/WARRANTY**

COLOR INSTRUCTIONS ARE AVAILABLE BY PART NUMBER ON: CORSAPERFORMANCE.COM



NEVER work on a hot engine bay.
Allow time for the vehicle to cool.

INSTALL DIFFICULTY 

RECOMMENDED TOOLS & SUPPLIES

- 10mm Socket Ratchet or Wrench
- 11/16" Wrench
- 2.5mm Hex Wrench
- Cutting Pliers

Please take time to read and understand these installation instructions.

CORSA recommends that the installation of this system be performed by a qualified service center or professional installer who has the necessary equipment, tools, and experienced personnel. However, if you decide to perform this installation yourself, the use of an additional person may be required.

WARNING: Never work on a hot engine bay. Allow time for the vehicle to cool.

This warranty does not extend to damaged or defect in the finish of a product or to any product, that in the opinion of CORSA Performance, has been misused, damaged by accident or negligence, altered or modified in any way, faulty installation or installed contrary to CORSA installation instructions, or repaired by an unauthorized service facility.

Full warranty available on www.corsaperformance.com

Please confirm that all parts are present according to the bill of materials before beginning the installation.

If something is missing call Tech Support at 440.891.0999 or Toll Free: 1.800.486.0999

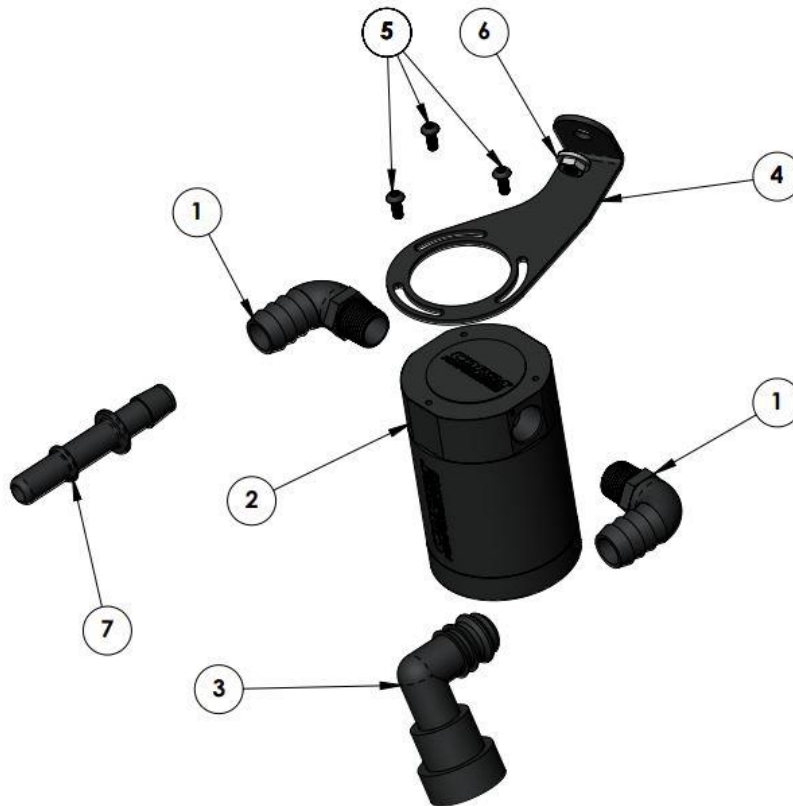

HARDWARE KIT

1. 1/2" NPT Barbed Elbow Fitting	2	4. Bracket	1	7. 1/2" Barbed Fitting	1
2. Catch Can Body	1	5. 4mm Hex Screws	3	NOT PICTURED:	
3. 1/2" Quick Disconnect Fitting Elbow	1	6. M6 Flange Nut	1	8. 1/2" Hose A	9"
				8. 1/2" Hose B	9"

REMOVAL INSTRUCTIONS

FACTORY PCV LINE

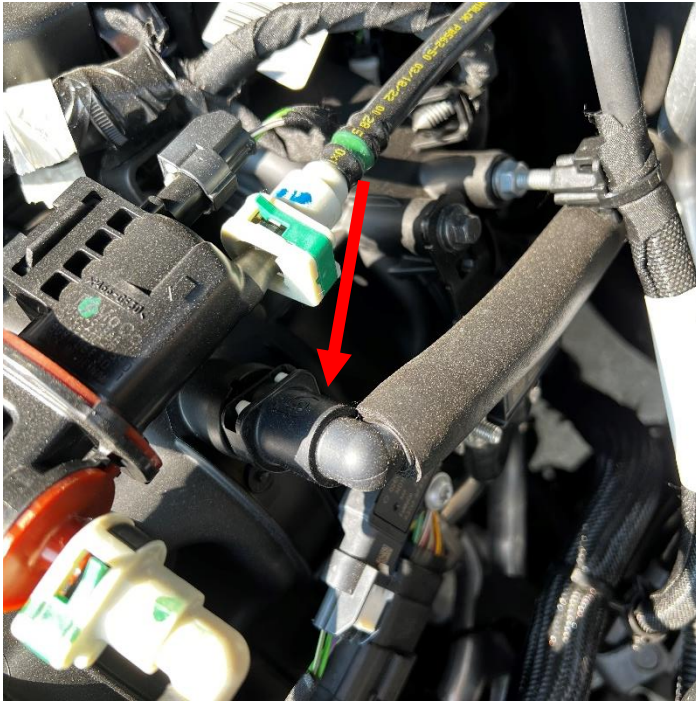

1. Remove the stock PCV line located on the drivers side of the engine by pressing on the grey tab.



2. Located on the driver's side of the firewall, cut the zip tie securing the wiring harness to the plastic cap, then remove the plastic cap from the firewall stud.

This concludes removal instructions.

INSTALLATION INSTRUCTIONS

CORSA CATCH CAN SYSTEM

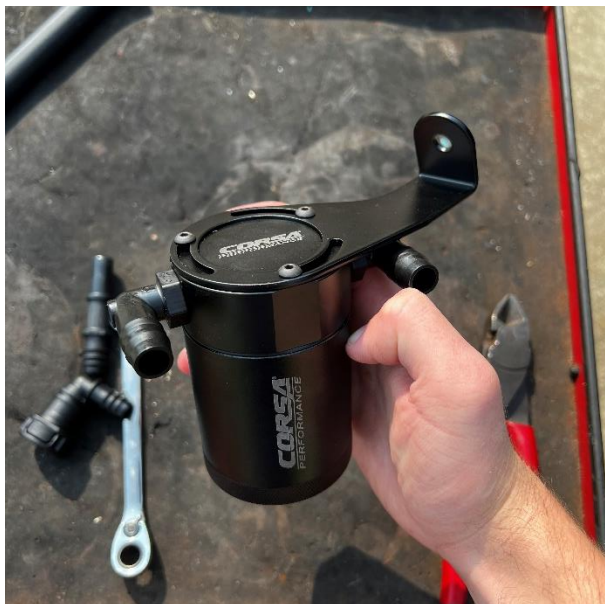

1. Install barbed fittings and bracket to the catch can using an 11/16" wrench and 2.5mm Hex wrench. **IMPORTANT:** Corsair recommends using thread sealant or PTFE tape on barbed fittings and bottom drain plug to prevent any leaks.



2. Use the provided nut and a 10mm socket ratchet or wrench to secure the catch can in place on the firewall stud.

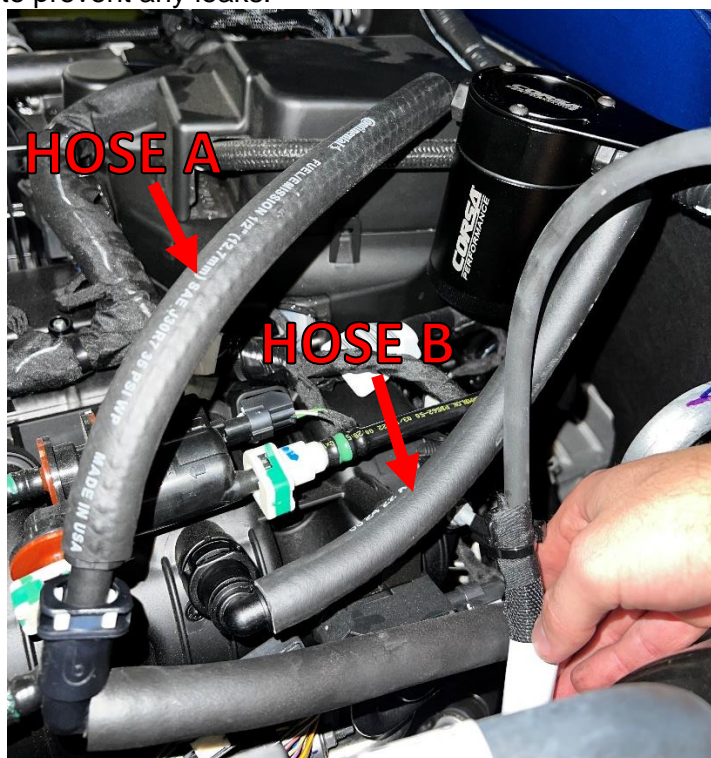

3. Install male barbed fitting to Hose A. Install female quick disconnect fitting to Hose B. Attach hose A to the "A" end of the catch can and route the hose to connect it to the stock PCV fitting. Connect Hose B to the "B" side of the catch can and route the line to connect it to fitting on the intake manifold. Make sure fittings are fully secured and the hose is pushed all the way over the ends of the fittings.

This concludes installation instructions.

*Check that this catch can complies with your Federal, State and Local laws.
We recommend saving your stock PCV line.*

BEFORE ROAD TESTING

- 1.** Start engine, leaving the transmission in park and securing the parking brake.
 - 2.** Make sure to look and listen for any unusual noises or air leaks. Repair problems if needed.
 - 3.** Once completed it will be necessary to check periodically, after a few heat cycles, for realignment and tightening of all connections.
-

EMPTYING CATCH CAN: Twist off the bottom of the catch can and dispose of collected oil. It is recommended to check and empty the catch can with every oil change.