

15-17 FORD MUSTANG GT

CORSA[®]
PERFORMANCE



IMPORTANT! WARRANTY AND INSTALLATION INSTRUCTIONS

Please Forward All Information to Consumer

Be sure to review the enclosed instructions prior to beginning the installation process. If you have any questions about the enclosed parts or instructions, or if you encounter a problem during installation:

CALL TECHNICAL SUPPORT: 440.891.0999 or 800.486.0999

**TO ACTIVATE YOUR WARRANTY GO TO:
CORSAPERFORMANCE.COM/WARRANTY**

COLOR INSTRUCTIONS ARE AVAILABLE BY PART NUMBER ON: CORSAPERFORMANCE.COM



NEVER work on a hot exhaust system.
Allow time for the vehicle to cool.

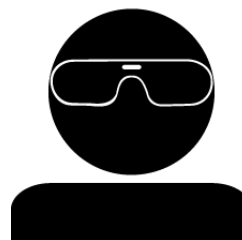

**Always wear eye protection
when working under a vehicle.**

INSTALL DIFFICULTY

RECOMMENDED TOOLS & SUPPLIES

- 3/8" Drive Ratchet
- 3/8" Drive Torque Wrench
- 3/8" Drive 13mm Socket
- 3/8" Drive 15mm Deep Socket
- Saw or Chain-Style Pipe Cutter
- File or Sanding Device for De-Burring
- Tape Measure & Marker
- Soap and Water Solution
- Torque Wrench
- Penetrating Lubricant Spray

Please take time to read and understand these installation instructions.

CORSA recommends that the installation of this system be performed by a qualified service center or professional installer who has the necessary equipment, tools, and experienced personnel. However, if you decide to perform this installation yourself, the use of an additional person may be required.

WARNING: Never work on a hot exhaust system. Allow time for the vehicle to cool. Always wear eye protection when working under a vehicle.

CORSA Performance makes no representation or warranty, expressed or implied that its downpipe or header products and or components there-in comply with federal, state or local emission levels, noise levels, or safety standards or that any of their parts conform with the racing vehicles exemption, unless otherwise noted. The purchaser assumes all responsibility for such use and compliance.

This warranty does not extend to damaged or defect in the finish of a product or to any product, that in the opinion of CORSA Performance, has been misused, damaged by accident or negligence, altered or modified in any way, faulty installation or installed contrary to CORSA installation instructions, or repaired by an unauthorized service facility.

Full warranty available on www.corsaperformance.com

Please confirm that all parts are present according to the bill of materials before beginning the installation.

If something is missing call Tech Support at 440.891.0999 or Toll Free: 1.800.486.0999

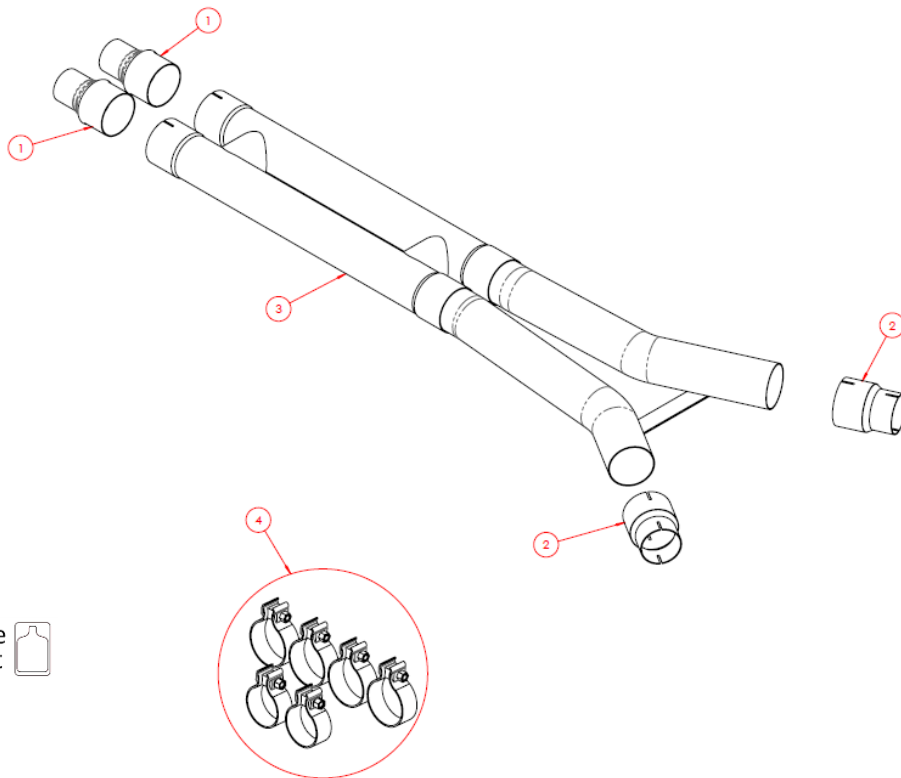

BILL OF MATERIALS

1.	X-Pipe /H-Pipe Inlet to Stock Adapter (2) (20MU4076)	2.	X-Pipe /H-Pipe Outlet to Stock Adapter (2) (20MU4083)
3.	Double H-Pipe Assembly (20MU4208)	4.	Hardware Kit (18VP7000)

CAUTION: Never work on a hot exhaust system. Allow the vehicle to cool for at least an hour and a half. Always wear eye protection when working under a vehicle. It is recommended to use cotton gloves in order to protect stainless steel surface of the header from permanent grease and oil stains.

REMOVAL INSTRUCTIONS

FACTORY EXHAUST



1. Starting on the driver side, measure 22½" away from the flange on the stock resonator, following the outside profile of the exhaust pipe.



2. The tape measure should follow the bend profile of the pipe.



3. On the passenger side, measure 23" away from the flange on the stock resonator following the outside profile of the exhaust pipe. Again, the tape measure should follow the bend profile of the pipe.



4. Using a chain cutter or similar device, cut both the driver and passenger side exhaust pipes at the marked locations. Place an adjustable stand or similar device under the stock tunnel section of the exhaust for support. Once the axle pipes are cut, there are no additional stock hangers supporting the tunnel section.

Continued on Next Page ...

REMOVAL INSTRUCTIONS

FACTORY EXHAUST



- 5.** Using a 3/8" drive ratchet and 13mm socket, remove the **bolt** holding down the driver side hanger grommet assembly. **Save bolt for reinstallation** (Install Step 9).



- 6.** Once the bolt is removed, push up slightly on the exhaust and slide the hanger grommet assembly rearward to free it from the rear suspension sub-frame. Rotate the hanger grommet assembly a minimum of 90° so that it will not interfere with the rear suspension sub-frame.

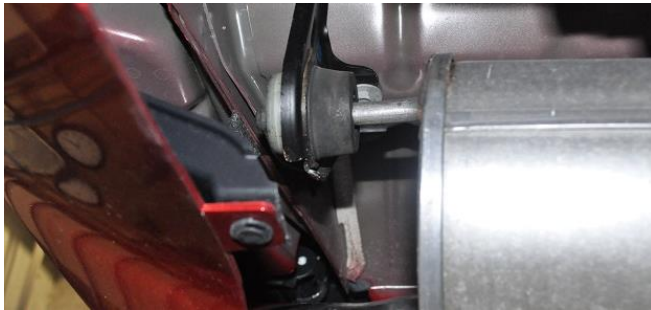

- 7.** Lower the cut end of the driver side muffler assembly just enough to create clearance between the pipe and any suspension components. Slide the whole muffler assembly forward to remove the rear muffler hanger from the hanger grommet. The driver muffler assembly will not be free from the vehicle.

NOTE: The use of a soap and water solution may aid in the removal of the hanger grommets.

Repeat Removal Steps 5-7 for the passenger side.



- 8.** Using a 3/8" drive ratchet and 15mm deep socket, loosen the two sleeve clamps at the cat-back connection point. Both nuts must be loosened in order for the clamp to fully disengage.

IMPORTANT: Carefully and thoroughly de-burr the stock driver and passenger muffler inlet pipes from any burrs and sharp edges. This is important as any burrs will prevent the x-pipe outlet to stock adapters from sliding over the stock exhaust pipes.



- 9.** Slide the stock tunnel muffler assembly rearward to free it from the two sleeve clamps and remove it from the vehicle.

This concludes the removal of the factory exhaust.

WARNING! DO NOT SKIP THIS STEP!

Apply the anti-seize lubricant (*supplied*) to the threads **ONLY** of all the clamps and flange bolts. Failure to follow this procedure can cause nuts to seize on clamps and potentially destroy threads.

After applying anti-seize lubricant, be sure to **thoroughly** clean your hands, as lubricant will tarnish stainless steel.

All clamps should be tightened using a properly calibrated Torque Wrench. Using an air impact gun will damage the clamp and reduce its ability to effectively seal the joint. It may also cause the joint to separate, thereby causing damage to your exhaust system and to your vehicle.

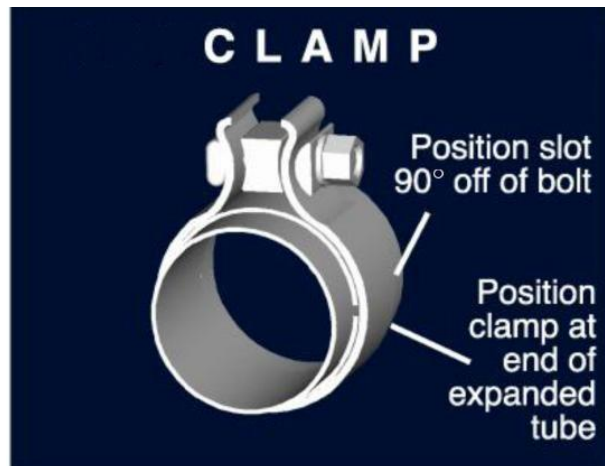

NOTE: Align all clamps so that the center of the clamp bolt is 90 degrees from the notch in the pipe.

INSTALLATION INSTRUCTIONS

CORSA EXHAUST



1. Locate the two inlet adapters. Slide the adapters into the factory sleeve clamps, and tighten using the ratchet and 15mm deep socket, until the adapters are snug in the clamps.



2. Install two 3" clamps on the driver and passenger inlets of the double H-Pipe so that the bolts are vertical with the nut towards the ground and the bolts towards the outside of the vehicle.

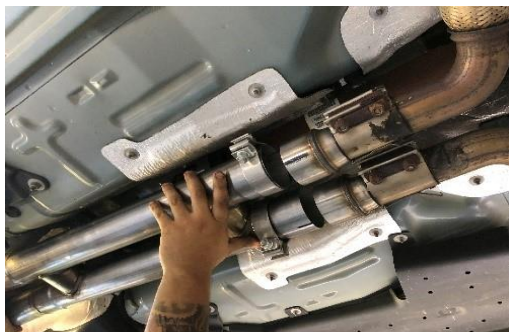

3. Slide the H-Pipe inlets over the adapter outlets.



4. Position the double H-Pipe so the cross brace located at the rear of the H-Pipe is facing down and parallel with the ground, and the outlets are centered around the differential. Tighten the clamps using a ratchet and 15mm deep socket, until the H-Pipe is snug on the adapters. Place a jack stand or similar device under the H-Pipe for support.

Continued on Next Page ...

INSTALLATION INSTRUCTIONS

CORSA EXHAUST

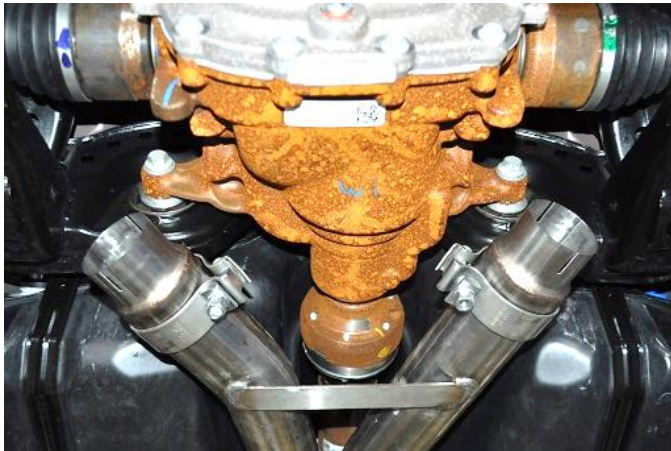

- 5.** Locate the two outlet adapters, and two 3" clamps. Install the clamps on the adapter so that the bolts are vertical with the nuts towards the ground and both bolts are towards the inside of the vehicle when the adapters are installed over the double H-Pipe outlets. Tighten the clamps using a ratchet and 15mm deep socket, until the adapters are snug on the pipes.



- 6.** Locate two 2 1/2" clamps. Install the clamps on the adapter outlet pipes so that the bolts are vertical with the nuts towards the ground and the bolts towards the outside of the vehicle. **WARNING:** Do NOT tighten the clamps at this step, as the stock axle pipes will then not be able to fit inside the adapters.

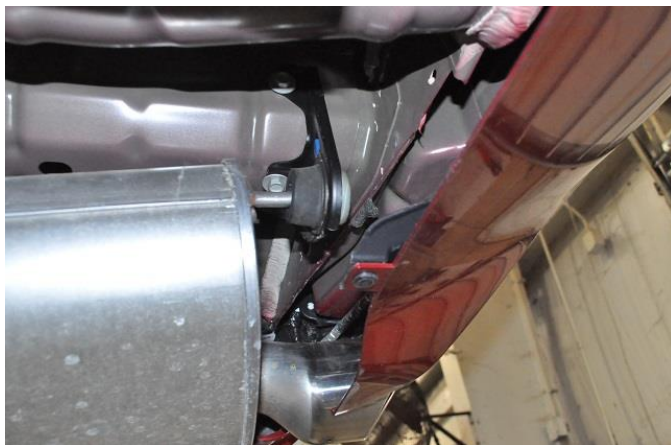

- 7.** Locate the stock driver side muffler assembly. Slide the rear hanger into the rear hanger grommet located on the vehicle above and just inside of the passenger side tip cut out.



- 8.** Slide the muffler inlet pipe into the driver side adapter outlet. **NOTE:** The use of a soap and water solution may aid in the installation of hanger grommets

Continued on Next Page ...

INSTALLATION INSTRUCTIONS

CORSA EXHAUST



- 9.** Locate the 13mm bolt removed during **Step 5** of the stock exhaust removal process. Install the front passenger hanger grommet assembly onto the rear suspension sub-frame, and tighten it down with the 13mm bolt, 3/8" ratchet, and 13mm socket.
- 10.** Tighten the clamp connecting the passenger muffler inlet pipe to the outlet adapter using the ratchet and 15mm deep socket, until muffler assembly is snug on the adapter.



- 11.** Repeat **Install Steps 7-9** on the passenger side of the vehicle. Once the exhaust system is secure, it is safe to remove the jack stand from beneath the double H-Pipe.
- 12.** Adjust the system accordingly, including the adapter overlap on the stock exhaust, the rear muffler depth and rotation. Verify the exhaust tips are centered in the bumper valence. Check clearances between the system components and chassis. At this time, tighten all clamps to 45ft-lbs using the torque wrench and 15mm socket.



NOTE: During cold weather start-ups, you may experience an exhaust sound that is deeper and louder in tone than usual. This is temporary and will diminish to normal levels once your engine has reached its normal operating temperature.

NOTE: Immediately following the installation of your exhaust system, you may experience a trace of smoke after initial start-up. DO NOT be alarmed. The smoke is caused by the burning of a small amount of forming oil residue used in the manufacturing process.

NOTE: It is strongly suggested that all clamps be checked and tightened after road testing the vehicle once the system has cooled.