



IMPORTANT WARRANTY & INSTALLATION
INSTRUCTIONS ATTACHED

*Please Forward All Attached Information to Consumer
Warranty Not Valid Unless Returned to CORSA Performance*

We ask that you take a few moments to complete our warranty registration form:

TO ACTIVATE YOUR LIMITED LIFETIME WARRANTY GO TO:
CORSAPERFORMANCE.COM/WARRANTY



**For Full-Color Installation Instructions, Please Visit:
CORSAPERFORMANCE.COM and Search by Part Number**

Please be sure to review the enclosed instructions prior to beginning the installation process. If you have any questions about the enclosed parts, instructions or encounter a problem during installation:
CALL CORSA PERFORMANCE TECHNICAL ASSISTANCE AT 800.486.0999

Please take time to read and understand these installation instructions.

CORSA recommends that the installation of this system be performed by a qualified service center or professional muffler installer who has the necessary equipment, tools and experienced personnel. However, if you decide to perform this install, the use of a hoist and an additional person will be required.

CAUTION: Never work on a hot exhaust system. Allow time for the vehicle to cool. Always wear eye protection when working under a vehicle.

Recommended Tools:

- Safety Glasses
- Soap & water solution
- 13mm socket and ratchet
- Torque wrench
- 15mm socket
- Long Extension
- Grommet pullers

Please confirm that all parts are present according to the bill of materials before beginning the installation.

If something is missing call Tech Support at 1- 800-486-0999

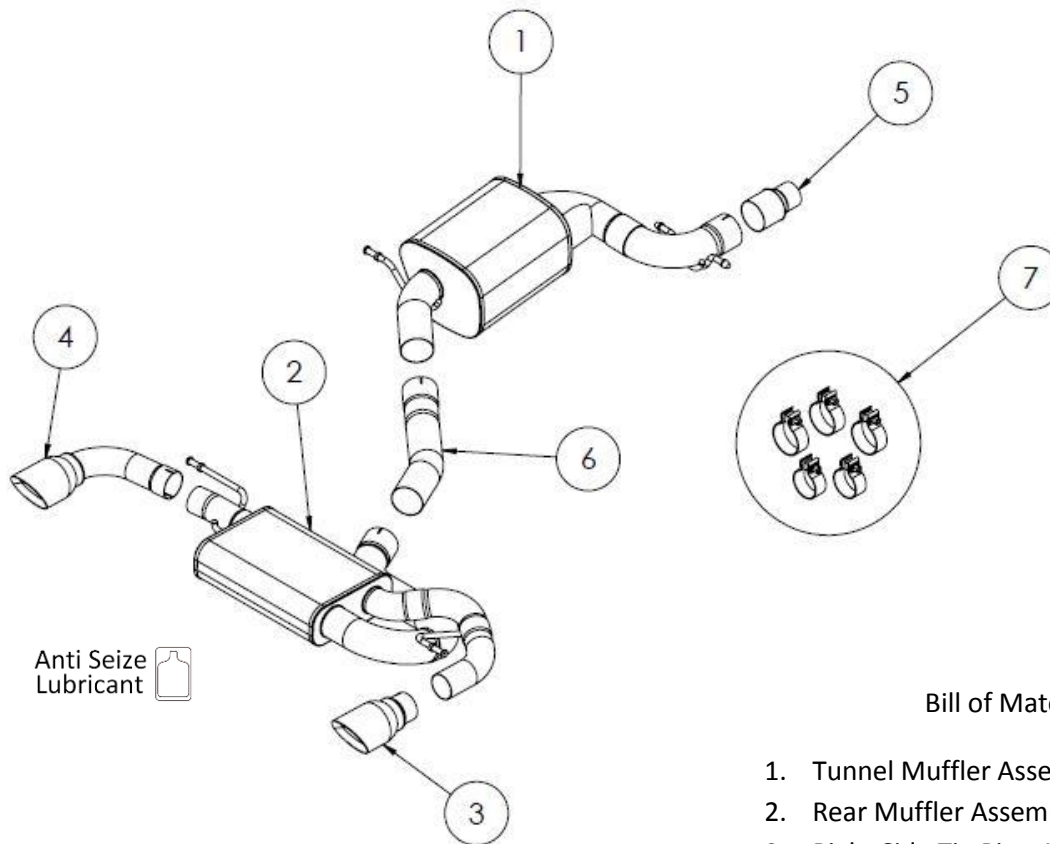

Bill of Materials

1. Tunnel Muffler Assembly
2. Rear Muffler Assembly
3. Right Side Tip Pipe Assembly
4. Left Side Tip Pipe Assembly
5. 3.0" Cat-Back Adapter
6. Axle Pipe
7. Hardware Kit
Anti-Seize Packet

Factory Exhaust System Removal:

1. Using a 13mm socket and ratchet, loosen both nuts on the factory cat-back to downpipe clamp. **(See Fig. A)**
2. Using grommet pullers or similar device, remove the grommets from the two front hangers near the front of the cat-back section. **(See Fig. B)**

NOTE: The use of a soapy water solution may aid in the removal and later installation of the hangers in the rubber isolators.

3. Using grommet pullers or a similar device, remove the hanger from the grommet at the rear of the factory tunnel muffler. **(See Fig. C)**
4. Using a 13mm socket and a long extension, unbolt the right side rear muffler hanger mount from the vehicle by removing the two retaining bolts. **(See Fig. D)**
5. Using grommet pullers or a similar device, remove the left side hanger from the last grommet supporting the factory rear muffler. **(See Fig. E)** Carefully slide the factory rear section back from the clamping location to free it from the vehicle.
6. With the factory rear section on the ground, remove the right side rear muffler hanger from the rubber isolator on the hanger mount using a grommet puller or a similar device. **(See Fig. F)** Reinstall the rear muffler hanger mount and the retaining bolts at this time.
7. **(Optional)** If this system will be mounted to a factory downpipe, remove the rear tunnel brace by taking out the four retaining nuts using a 13mm socket and ratchet. **(See Fig. G)** The factory downpipe will most likely droop without the rear tunnel brace installed. This completes the removal process.

REMOVAL PICTURES ON NEXT PAGE 

Factory Exhaust Removal Pictures



Fig. A

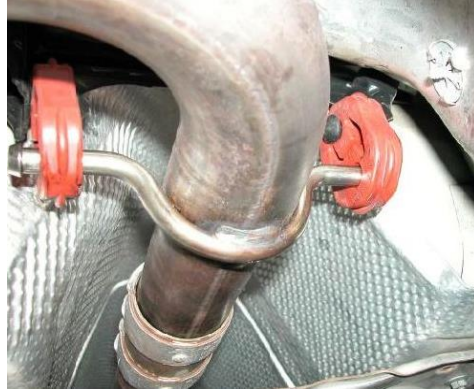

Fig. B



Fig. C



Fig. D



Fig. E



Fig. F



Fig. G

Installation of CORSA Exhaust System:

NOTE: Apply the anti-seize lubricant (*supplied*) to the threads **ONLY** of all the clamps and flange bolts. Failure to follow this procedure can cause nuts to seize on clamps and potentially destroy threads. After applying anti-seize lubricant, be sure to thoroughly clean your hands, as lubricant will tarnish stainless steel. All clamps should be tightened using a properly calibrated Torque Wrench. Using an air impact gun will damage the clamp and reduce its ability to effectively seal the joint. It may also cause the joint to separate, thereby causing damage to your exhaust system and to your vehicle.

NOTE: Align all clamps so that the center of the clamp bolt is 90 degrees from the notch in the pipe. (See Fig. CLAMP)

1. Remove all exhaust system components from the shipping carton, including the three 3" clamps, the two 2.5" clamps and the 3" Cat-Back adapter, which allows this system to be connected to the factory downpipe (if necessary).

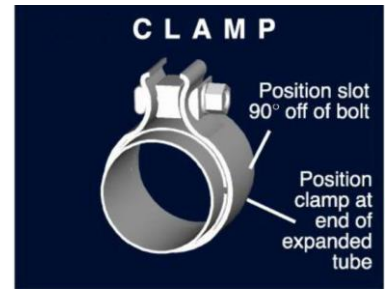

If connecting to the factory downpipe: trim the rear of the factory downpipe to create space to fit in the 3" cat-back adapter. Reuse the factory downpipe to cat-back clamp to connect the small end of the adapter to the trimmed factory downpipe, and tighten the clamp nuts with a 13mm socket and ratchet. Torque the clamp nuts to factory specs. Next, reinstall the factory rear tunnel brace using the four retaining nuts and tighten using a 13mm socket and ratchet. Torque nuts to 18ft-lbs (24N-m). (See Fig. B) The CORSA tunnel muffler assembly will mount to the larger end of the 3" cat-back adapter, and is secured with one of the 3" clamps included with this system (See step 2).

If connecting to an aftermarket 3" downpipe: Do not use the 3" cat-back adapter. Your CORSA system will mount directly to 3" diameter pipe. Note that additional fabrication may be necessary to adjust that length or position of any 3" downpipe (other than the CORSA downpipe) being used to properly mount to this CORSA cat-back system.

2. Locate the CORSA tunnel muffler assembly, and a 3" clamp. Properly align the clamp on the tunnel muffler inlet, and slide it over the end of the 3" downpipe (or 3" cat-back adapter – see above note). Insert the hangers into the corresponding rubber grommets, starting with the two front hangers, and then moving to the hanger just behind the tunnel muffler. (See Fig. C & D) A soapy water solution will aid in the installation process of the hangers. Snugly tighten the 3" clamp to retain the tunnel muffler section. (See Fig. E)
3. Locate the CORSA axle pipe and a 3" clamp. Next, properly align the clamp on the axle pipe inlet, and slide it over the end of the tunnel muffler assembly. (See Fig. F) Make sure that the axle pipe is positioned so that the outlet of the axle pipe is running parallel to the ground and then loosely tighten the 3" clamp just enough to retain the axle pipe section. (See Fig. G)

CONTINUED ON NEXT PAGE 

4. Locate the CORSA rear muffler assembly, and the last 3" clamp. Properly align the clamp on the rear muffler inlet. Slide the inlet of the rear muffler over the outlet of the axle pipe (**See Fig. H**). Then insert the driver side muffler hanger into the factory driver side grommet (**See Fig. I**). Next, insert the passenger side muffler hanger into the factory passenger side grommet (**See Fig. J**). Loosely snug the 3" clamp just enough to retain the rear muffler in place at this time.
5. Locate the CORSA driver side tip assembly and a 2.5" clamp. Slide the clamp over the expanded end of the tip assembly (**See Fig. K**). Then slide the expanded end of the tip assembly onto the driver side outlet of the rear muffler. Align the driver side tip so that it is centered in the cutout in the rear valance (**See Fig L**). Loosely tighten the clamp at this time.
6. Locate the CORSA passenger side tip assembly and a 2.5" clamp. Slide the clamp over the inlet end of the tip assembly (**See Fig M**). Then slide the tip assembly onto the passenger side outlet of the rear muffler. Align the passenger side tip so that it is centered in the cutout in the rear valance (**See Fig N**). Loosely tighten the clamp at this time (**See Fig O**).
7. If necessary, adjust the position and rotation of the rear muffler assembly, along with the position and rotation of the driver side tip assembly in order to align both tips to each other. (If the driver side tip is pointing down more than the passenger side, then rotate the muffler clamp downward and the driver side tip upward or vice versa if opposite adjustment is needed). Also, adjust depth engagement at these joints or tip center-to-center adjustment (**See Fig P**).
8. Visually inspect the exhaust system position, tip alignment, clamp orientation and exhaust pipe clearance.
9. When the exhaust system is in the desired location, tighten the nuts on the clamps. Torque nuts to 45 ft-lbs (61 N-m)
10. It is **STRONGLY SUGGESTED** that all clamps be checked and re-tightened (if necessary) to the recommended torque after initial road testing of the vehicle, as thermal cycling has occurred on the system. Please wait until system has fully cooled to perform this step.

NOTE: During cold weather start-ups, you may experience an exhaust sound that is deeper and louder in tone than usual. This is temporary and will diminish to normal levels once your engine has reached its normal operating temperature.

NOTE: Immediately following the installation of your exhaust system, you may experience a trace of smoke after initial start-up. DO NOT be alarmed. The smoke is caused by the burning of a small amount of forming oil residue used in the manufacturing process.

INSTALLATION PICTURES ON NEXT PAGE 

CORSA Exhaust Installation Pictures



Fig. B



Fig. C

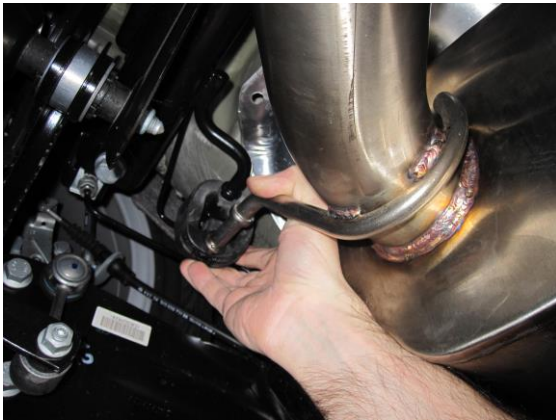

Fig. D

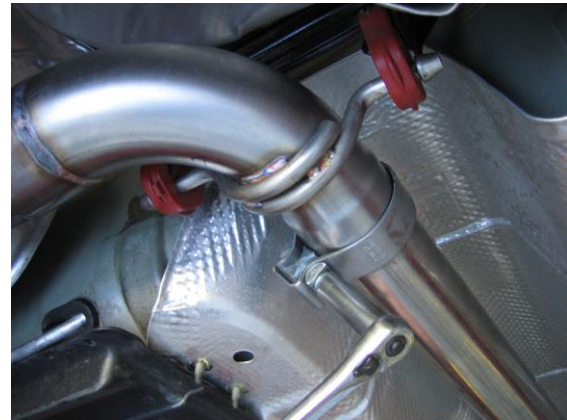

Fig. E



Fig. F



Fig. G

CONTINUED ON NEXT PAGE 

CORSA Exhaust Installation Pictures:



Fig. H



Fig. I



Fig. J



Fig. K



Fig. L



Fig. M

CONTINUED ON NEXT PAGE 

CORSA Exhaust Installation Pictures:



Fig. N



Fig. O



Fig. P