



IMPORTANT WARRANTY & INSTALLATION INSTRUCTIONS ATTACHED

*Please Forward All Attached Information to Consumer
Warranty Not Valid Unless Returned to CORSA Exhaust*

We ask that you take a few moments to complete our warranty registration form:

TO ACTIVATE YOUR LIMITED LIFETIME WARRANTY GO TO:

CORSAPERFORMANCE.COM/WARRANTY



For Full-Color Installation Instructions, Please Visit:

CORSAPERFORMANCE.COM and Search by Part Number

Please be sure to review the enclosed instructions prior to beginning the installation process.
If you have any questions about the enclosed parts, instructions or encounter a problem during
Installation: **CALL CORSA PERFORMANCE TECHNICAL ASSISTANCE AT
800.486.0999**

NOTE: If you are installing a V6 Challenger dual rear exhaust (Part # 14443), you will need to purchase a dual rear fascia from your local dealer (Part # 68039501AB).

Please take time to read and understand these installation instructions.

We recommend that the installation of this system be performed by a qualified service center or professional muffler installer who has the necessary equipment, tools and experienced personnel. However, if you decide to perform this install, the use of a hoist and an additional person will be required.

CAUTION: Never work on a hot exhaust system. Allow time for the vehicle to cool. Always wear eye protection when working under a vehicle.

Please confirm that all parts are present before beginning the factory exhaust system removal and CORSA exhaust system installation.

Bill of Materials:

• **Driver Side Rear Muffler**

- Charger (17CH2099)
- 300 (17CH2119)
- Challenger (17CH2115)

• **Passenger Side Rear Muffler**

- Charger (17CH2092)
- 300 (17CH2118)
- Challenger (17CH2114)

• **Rear Y-pipe** (17CH4149)

• **Axle Pipe** (17CH4154)

• **Y-pipe w/ Tunnel Muffler**

- Charger/Magnum/300 (17CH4123)
- Challenger (17CH4165)

• **Hardware Kit** (17CH7048)

Recommended Tools:

- Safety Glasses
- 13mm Wrench
- 13mm Socket
- 15mm Wrench
- 15mm Socket
- Grommet Pullers
- 3/8" Ratchet
- 12" Ratchet Extension
- Torque Wrench
- Soap & Water Solution

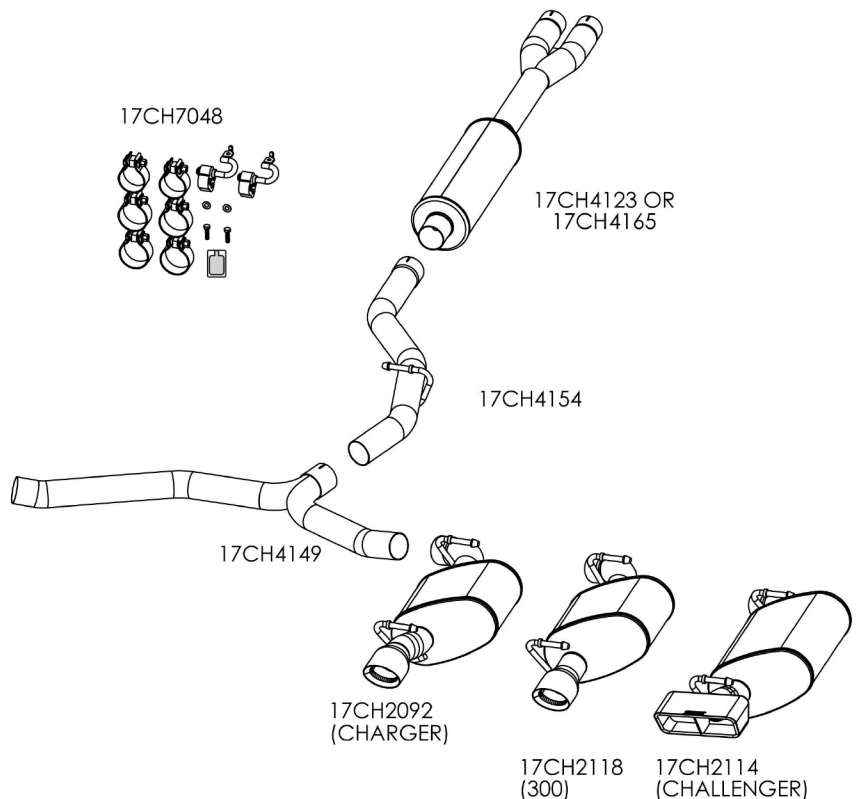
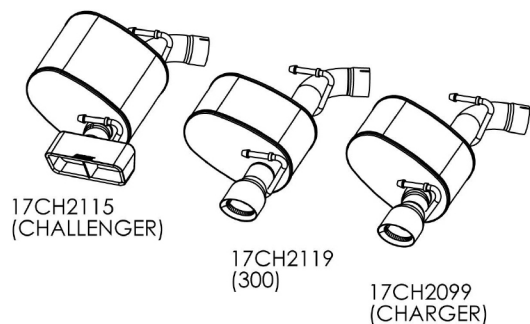

Factory Exhaust System Removal:

NOTE: The use of a soapy water solution may aid in the removal and later installation of the hangers in the rubber isolators.

1. Loosen the tunnel brace bolts below the crossover pipe using a 13mm socket. Remove the tunnel brace from the chassis. **(See Fig. A)**
2. Remove the grounding clip from the passenger side rear muffler. **(See Fig. B)**
3. Remove the passenger side factory hangers from the chassis using a 13mm socket and 12" extension attached to a 3/8" ratchet. **(See Fig's C)**
4. Remove the grommets and chassis hangers from the stock muffler and replace to the original factory position. Torque the bolts to 18 ft-lbs. **(See Fig's D, E&F)**
5. Using a 15mm Socket loosen the clamps at the front of the stock exhaust system. **(See Fig. G)**
6. Remove the passenger side axle pipe hanger from the rubber grommet. Carefully remove the remaining stock exhaust system from the vehicle. **(See Fig. H)**



FIG. A



FIG. B



FIG. C

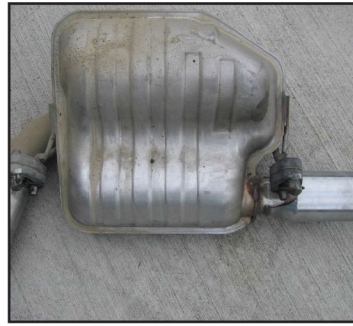

FIG. D



FIG. E

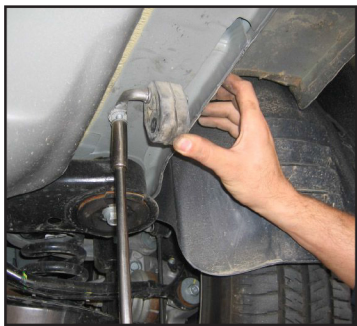

FIG. F

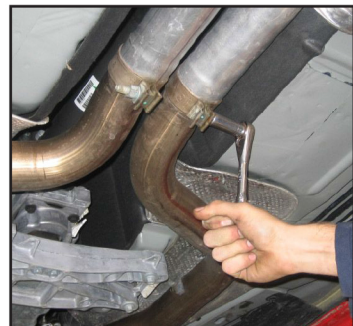

FIG. G



FIG. H

CORSA Exhaust System Installation:

INSTALLATION NOTE: Be sure to apply the provided anti-seize lubricant to all bolts, fasteners and clamps. A pouch is included with the hardware kit. Apply the supplied anti-seize lubricant to the threads **ONLY** of all TORCA band clamps. Failure to follow this procedure can cause the nuts to seize on clamps and potentially damage threads. **WARNING:** Be sure to thoroughly clean hands after use. Anti-seize lubricant will tarnish stainless steel parts.

All clamps should be tightened using a properly calibrated Torque Wrench. Using an air impact gun will damage the clamp and reduce its ability to effectively seal the joint. It may also cause the joint to separate thereby causing damage to your exhaust system and your vehicle.

1. Locate the CORSA Y-pipe w/ tunnel muffler assembly. Place two 2.25" Torca clamps over the inlet side. Slide the pipes over the stock pipes until it completely bottoms out. **(See Fig's A&B)** The bracket on the pipes should face down.
2. Locate the axle pipe **(See Fig's C&D)** and place a supplied 2.5" Torca clamp over the inlet side of the pipe. Then slide the pipe onto the end of the tunnel muffler and insert the hanger into the factory rubber grommet. **(See Fig's E&F)** Pre-tighten the Torca clamp at this time. Leave clamp loose enough for adjustment later.
3. **FOR DUAL SYSTEMS ONLY**, locate the rear Y-pipe and place supplied 2.5" Torca clamp over the inlet side of the pipe. Slide the inlet end of rear Y-pipe over the axle pipe. Pre-tighten the Torca clamp at this time. Leave clamp loose enough for adjustment later.



FIG. A



FIG. B



FIG. C

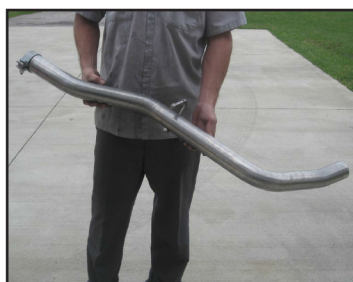

FIG. D

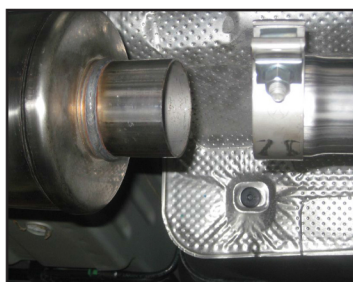

FIG. E



FIG. F

4. Locate the passenger side rear muffler and insert a supplied 2.5" clamp over the inlet side of the muffler. Slide muffler onto rear Y-pipe, then slide hangers into rubber grommets. **(See Fig's G&H)** (Soapy water in the grommet holes will aid in the installation of the muffler.) Insert the grounding clip on the muffler hanger. **(See Fig. I)** Pre-tighten the clamp at this time. Leave clamp loose enough for adjustment later.



FIG. G



FIG. H

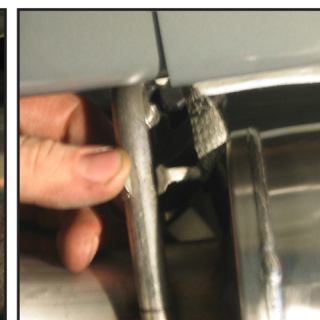

FIG. I

5. repeat step 4 to install the driver side rear muffler.
6. **(EXCLUDES CHALLENGER)**
Replace the factory tunnel brace to its original location. **Torque the nuts to 18 ft-lbs.** Using a shop stand (**see Fig. J**) or a spacer block, create 1/2" clearance between the Y-pipe and the factory tunnel brace. The 1/2" gap will be maintained between the pipe and tunnel brace when tightening the clamps in step 7.
7. At this time start from the front of the exhaust system and **tighten all Torca clamps to 45 ft-lbs.** Remove the spacer or stand from the previous step.



FIG. J

NOTE: During cold weather start-ups, you may experience an exhaust sound that is deeper and louder in tone than usual. This is temporary and will diminish to normal levels once your engine has reached its normal operating temperature.

NOTE: Immediately following the installation of your CORSA exhaust system, you may experience a trace of smoke after initial start-up. DO NOT be alarmed. The smoke is caused by the burning of a small amount of forming oil residue used in the manufacturing process.

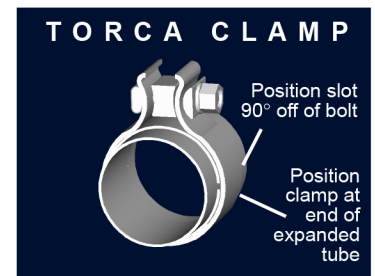

For technical assistance, call (800)486-0999.