



IMPORTANT WARRANTY & INSTALLATION INSTRUCTIONS ATTACHED

*Please Forward All Attached Information to Consumer
Warranty Not Valid Unless Returned to CORSA Exhaust*

We ask that you take a few moments to complete our warranty registration form:

TO ACTIVATE YOUR LIMITED LIFETIME WARRANTY GO TO:

CORSAPERFORMANCE.COM/WARRANTY



For Full-Color Installation Instructions, Please Visit:

CORSAPERFORMANCE.COM and Search by Part Number

Please be sure to review the enclosed instructions prior to beginning the installation process. If you have any questions about the enclosed parts, instructions or encounter a problem during Installation: **CALL CORSA PERFORMANCE TECHNICAL ASSISTANCE AT 800.486.0999**

CHRYSLER 300C
DODGE MAGNUM
DODGE CHARGER

Recommended Tools:

- Safety Glasses
- 13mm Wrench
- 13mm Socket
- 15mm Wrench
- 15mm Socket
- Grommet Pullers
- 3/8" Ratchet
- 12" Ratchet Extension
- Torque Wrench

Please be sure to review the attached instructions prior to beginning the installation process. If you have any questions about the enclosed parts, instructions or encounter a problem during installation, **Call CORSA Performance Technical Assistance at 800.486.0999**. Do not attempt to make any modifications to parts as this will void your warranty.

CAUTION: Prior to installation, be sure your vehicle is parked on a level surface, and the exhaust system is cool. For safety purposes and ease of installation, we urge you to take your vehicle to a qualified service center or muffler installer that employs the use of a lift.

Please confirm that all parts are present before beginning the factory exhaust system removal and CORSA exhaust system installation.

Bill of Materials:

- Driver Side Rear Muffler Assembly (SPORT 17CH2059) or (XTREME 17CH2108)
- Passenger Side Rear Muffler Assembly (17CH2060) or (XTREME 17CH2109)
- Driver Side Axle Pipe (17CH4074)
- Passenger Side Axle Pipe (17CH4075)
- Driver Side Tunnel Muffler (17CH2046)
- Passenger Side Tunnel Muffler (17CH2046)
- X-Pipe Assembly (17CH4018)
- (8) 2.5" Clamps
- (1) Anti-Seize Lube Pouch

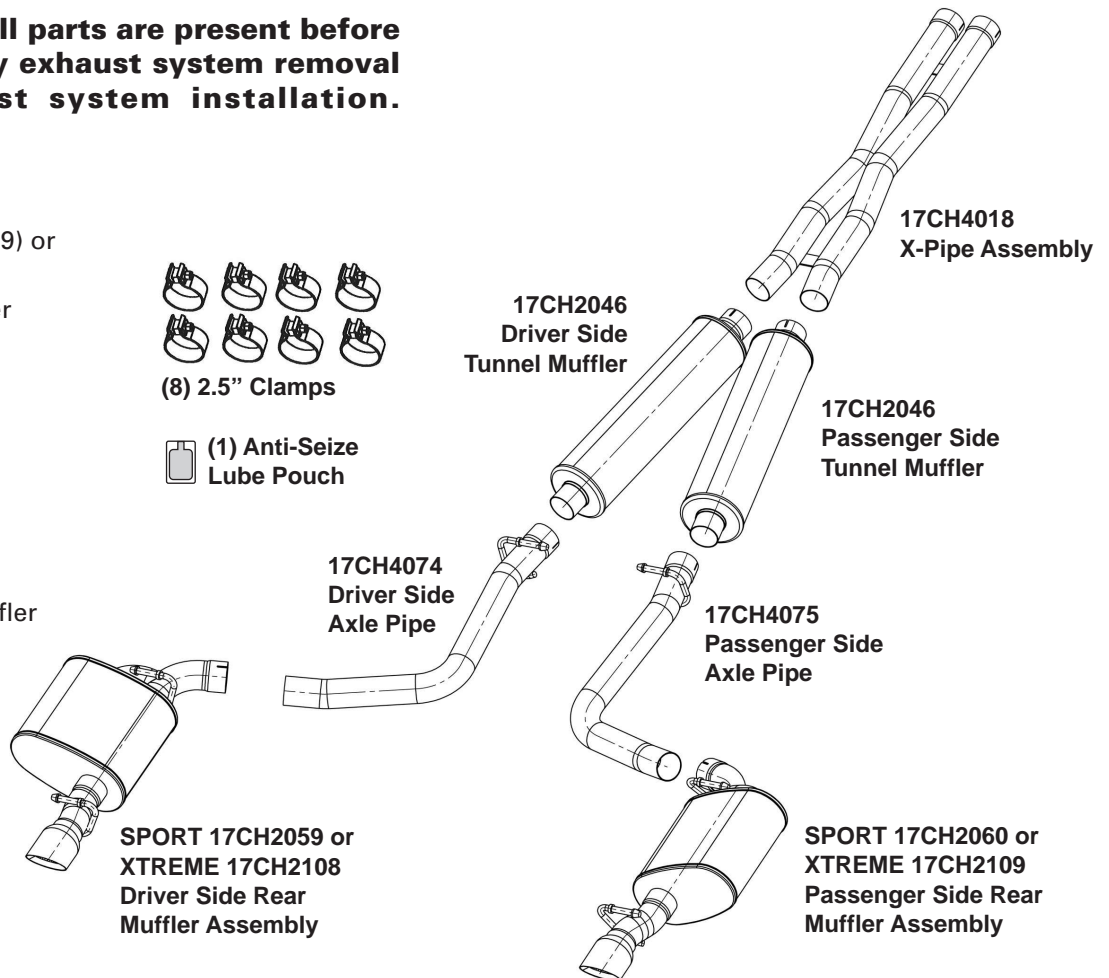

Factory Exhaust System Removal:

NOTE: Penetrating spray lubricant will assist with removal.

1. Loosen the nuts and bolts at the flange connection on the driver side of the tunnel muffler using a 13mm wrench or socket. **(See Fig. A)**
2. Remove the driver side factory hangers from the chassis using a 13mm socket and 12" extension attached to a 3/8" ratchet. **(See Fig's B&C)**
3. Remove the driver side axle pipe hanger from the grommet shown in **Fig. D** using grommet pullers or a similar device. Carefully remove the rear driver side section of the stock exhaust from the vehicle.
4. Remove the grommets and chassis hangers from the stock muffler and replace to the original factory position. Torque the bolts to 18 ft-lbs. **(See Fig's E, F&G)**
5. Loosen the tunnel brace bolts below the crossover pipe using a 13mm socket. Remove the tunnel brace from the chassis. **(See Fig. H)**
6. Remove the grounding clip from the passenger side rear muffler. **(See Fig. I)**
7. Repeat step 2 to remove the Passenger Side factory chassis hangers.
8. Using a 15mm Socket loosen the clamps at the front of the stock exhaust system. **(See Fig. J)**

**For technical assistance,
call (800)486-0999.**

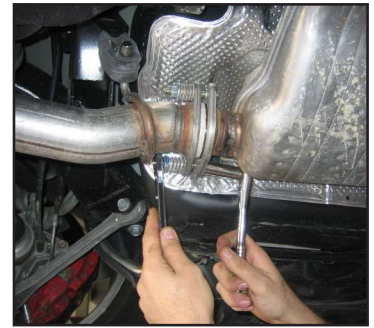

FIG. A

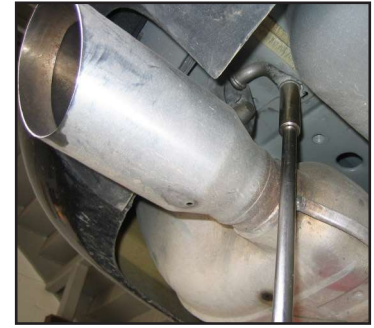

FIG. B



FIG. C



FIG. D



FIG. E



FIG. F



FIG. G

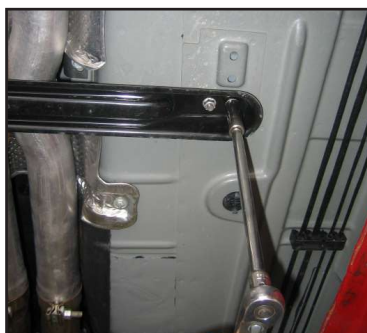

FIG. H



FIG. I



FIG. J

9. Remove the passenger side axle pipe hanger from the rubber grommet shown in **Fig. K**. Carefully remove the remaining stock exhaust system from the vehicle. (**See Fig. L**)
10. Repeat step 4 for the passenger side. **Fig's M&N** show the passenger side chassis hangers and grommets replaced to the original factory position. **Torque the bolts to 18 ft-lbs.** The removal of the factory system is complete.



FIG. K



FIG. L



FIG. M



FIG. N

CORSA Exhaust System Installation:

INSTALLATION NOTE: Be sure to apply the provided anti-seize lubricant to all bolts, fasteners and clamps. A pouch is included with the hardware kit. Apply the supplied anti-seize lubricant to the threads **ONLY** of all TORCA band clamps. Failure to follow this procedure can cause the nuts to seize on clamps and potentially damage threads. **WARNING:** Be sure to thoroughly clean hands after use. Anti-seize lubricant will tarnish stainless steel parts.

All clamps should be tightened using a properly calibrated Torque Wrench. Using an air impact gun will damage the clamp and reduce its ability to effectively seal the joint. It may also cause the joint to separate thereby causing damage to your exhaust system and your vehicle.

1. Locate the CORSA crossover pipe assembly. Place two of the supplied 2.5" Torca clamps over the inlet side of the crossover pipe. The inlet side is expanded and notched. Slide the crossover-pipe over the stock pipes until it completely bottoms out. (**See Fig's O&P**) The brackets on the crossover pipe can be on top or bottom. The alignment of the exhaust system will be the same regardless of the bracket position.
2. Locate the CORSA Tunnel muffler. Place a 2.5" Torca clamp over the inlet side of the muffler. Slide the tunnel muffler over the passenger side leg of the x-pipe. (**See Fig's Q&R**) (**See Drain Hole NOTE to Right**) ▶
3. Locate the passenger side axle pipe and place a supplied 2.5" Torca clamp over the inlet side of the pipe. Then slide the pipe onto the end of the tunnel muffler and insert the hanger into the factory rubber grommet. (**See Fig's S&T**) Pre-tighten the Torca clamp at this time. Leave clamp loose enough for adjustment later.



FIG. O



FIG. P

NOTE: IMPORTANT: Make sure that small drain holes in rear of each tunnel muffler face down when installed.



FIG. Q



FIG. R



FIG. S



FIG. T

4. Locate the Passenger Side Rear muffler and insert a supplied 2.5" clamp over the inlet side of the muffler. Slide muffler onto axle-pipe; then slide hangers into rubber grommets. **(See Fig's U&V)** (Soapy water in the grommet holes will aid in the installation of the muffler.) Insert the grounding clip on the muffler hanger. **(See Fig. W)** Pre-tighten the clamp at this time. Leave clamp loose enough for adjustment later.
5. Repeat steps 2 through 4 to install the driver side tunnel muffler, axle pipe, and rear muffler. There should be a 1/4" to 1/2" gap between the two end-caps at the inlet side of the tunnel mufflers. **(See Fig. X)**
6. Replace the factory tunnel brace to its original location. **Torque the nuts to 18 ft-lbs.** Using a shop stand **(see Fig's Y)** or a spacer block, create 1/2" clearance between the crossover pipe and the factory tunnel brace. The 1/2" gap will be maintained between the pipe and tunnel brace when tightening the clamps in step 7.
7. At this time start from the front of the exhaust system and **tighten all Torca clamps to 45 ft-lbs.** Remove the spacer or stand from the previous step.



FIG. U



FIG. V



FIG. W



FIG. X

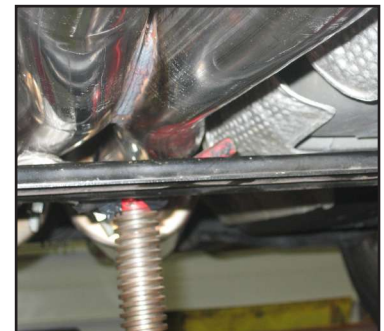
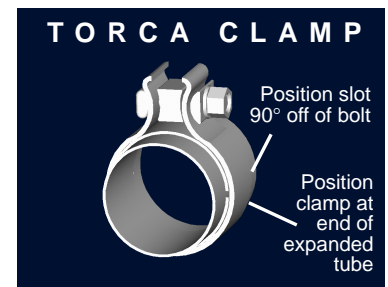

FIG. Y

NOTE: During cold weather start-ups, you may experience an exhaust sound that is deeper and louder in tone than usual. This is temporary and will diminish to normal levels once your engine has reached its normal operating temperature.

NOTE: Immediately following the installation of your CORSA exhaust system, you may experience a trace of smoke after initial start-up. DO NOT be alarmed. The smoke is caused by the burning of a small amount of forming oil residue used in the manufacturing process.



For technical assistance, call (800)486-0999.