

**21+ FORD**  
**BRONCO 2.7L**

**CORSA**  
**PERFORMANCE**



## **IMPORTANT! WARRANTY AND INSTALLATION INSTRUCTIONS**

*Please Forward All Information to Consumer*

Be sure to review the enclosed instructions prior to beginning the installation process. If you have any questions about the enclosed parts or instructions, or if you encounter a problem during installation:

**CALL TECHNICAL SUPPORT: 440.891.0999 or 800.486.0999**

**TO ACTIVATE YOUR WARRANTY GO TO:  
[CORSAPERFORMANCE.COM/WARRANTY](http://CORSAPERFORMANCE.COM/WARRANTY)**

**COLOR INSTRUCTIONS ARE AVAILABLE BY PART NUMBER ON: [CORSAPERFORMANCE.COM](http://CORSAPERFORMANCE.COM)**



**NEVER work on a hot engine bay.**  
Allow time for the vehicle to cool.

**INSTALL DIFFICULTY**



### **RECOMMENDED TOOLS & SUPPLIES**

- 1/4" Drive Ratchet
- 7mm Socket
- 8mm Socket
- 10mm Socket
- 10mm Wrench
- Trim Removal Tool or Similar
- Phillips Screwdriver

**Please take time to read and understand these installation instructions.**

CORSA recommends that the installation of this system be performed by a qualified service center or professional installer who has the necessary equipment, tools, and experienced personnel. However, if you decide to perform this installation yourself, the use of an additional person may be required.

**WARNING:** Never work on a hot engine bay. Allow time for the vehicle to cool.

Check that this air intake complies with your Federal, State, and Local laws. We recommend saving your stock system.

This warranty does not extend to damaged or defect in the finish of a product or to any product, that in the opinion of CORSA Performance, has been misused, damaged by accident or negligence, altered or modified in any way, faulty installation or installed contrary to CORSA installation instructions, or repaired by an unauthorized service facility.

Full warranty available on [www.corsaperformance.com](http://www.corsaperformance.com)

**Please confirm that all parts are present according to the bill of materials before beginning the installation.**

If something is missing call Tech Support at 440.891.099 or Toll Free: 1.800.486.0999

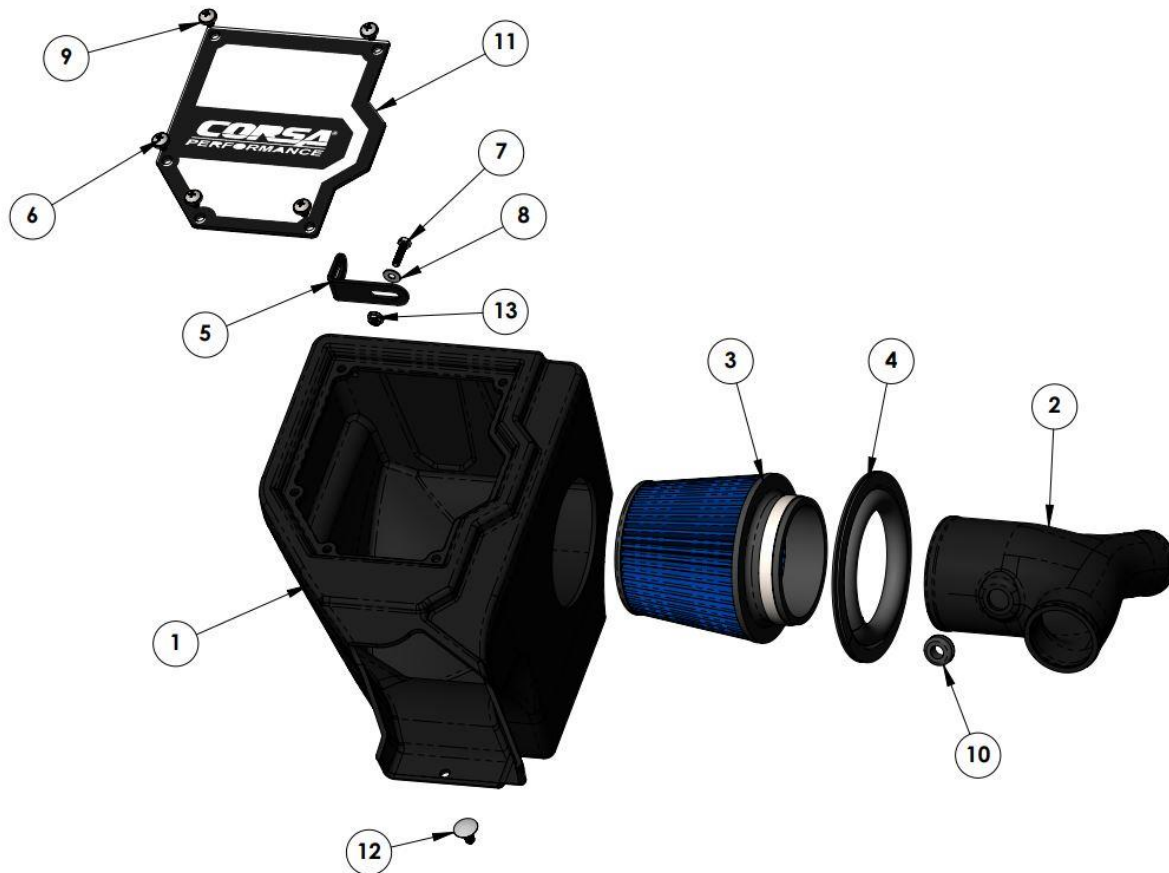

**PREASSEMBLED MATERIALS**

1. 412236 - Closed Air Box	1	2. 441326 - Air Duct	1	3. 5143 (shown) or 61509 - Air Filter	1
----------------------------	---	----------------------	---	---------------------------------------	---

**HARDWARE KIT**

4. 56001 – Bulb Seal Trim	14.5"	5. 652235 – Bracket	1	6. 5900 – Lid Screw	5
7. 59012212 – M6x1 Bolt	1	8. 59020104 - Washer	1	9. 59025122 – Rubber Washer	5
10. 59045101 – Rubber Grommet	1	11. 652192 – CORSA Lid	1	12. 652236 – Christmas Tree Clip	1
13. 652217 – M6x1 Flange Nut	1	14. (NOT PICTURED) 51914P/51920P Pre-Filter	1		



**REMOVAL INSTRUCTIONS**

FACTORY INTAKE

*Locate the vehicle's battery and disconnect the negative battery cable.  
This may reset the computer and clear old air flow data to help prevent CEL errors.*



- 1.** Disconnect the electrical connection on the air temperature sensor by pressing on the tab and pulling.



- 2.** Use a 10mm socket and ratchet to remove the bolt located behind the stock air box. Save bolt for installation step 8.

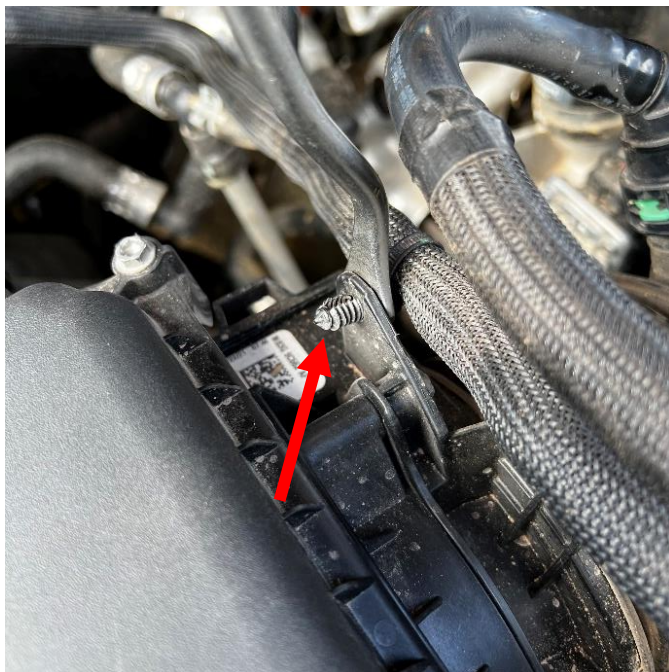

- 3.** Use a trim removal tool or similar to unclip the Christmas tree clip on the right of the airbox.



- 4.** Use a trim removal tool or similar to remove the clip at the front of the air scoop.

Continued on Next Page ...



**REMOVAL INSTRUCTIONS**

**FACTORY INTAKE**

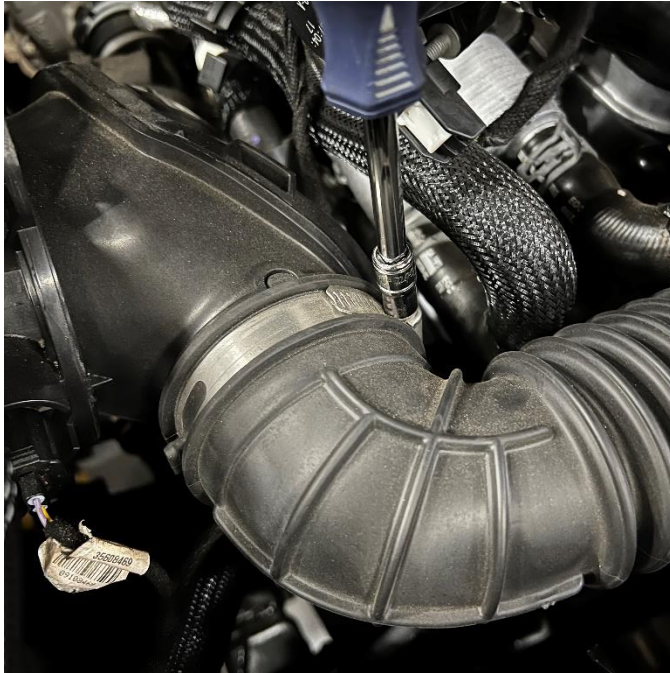

- 5.** Loosen the larger clamp securing the air duct to stock turbo inlet pipe and pull the duct off the inlet pipe.



- 6.** Loosen the smaller clamp securing the air duct to stock turbo inlet pipe and pull the duct off the inlet pipe.



- 7.** Carefully remove the stock air intake by pulling up and out.



- 8.** Carefully remove the temperature sensor from the stock air intake by rotating counterclockwise and pulling out. Save temperature sensor for installation step 3 and 4.

This concludes the removal of the factory intake.



**INSTALLATION INSTRUCTIONS**

**CORSA INTAKE**



**1.** Install filter bulb seal trim onto the CORSA air box.



**2.** Install the rubber grommet into the CORSA air duct.



**3.** Remove the O-ring from the temperature sensor.



**4.** Install the temperature sensor to the air duct by fitting it through the rubber grommet. Make sure the sensor is oriented as shown.

Continued on Next Page ...



**INSTALLATION INSTRUCTIONS**

**CORSA INTAKE**



**5.** Install the bracket to the drilled hole on the back of the CORSA air box using the supplied bolt, nut, and washer. Use a 10mm socket ratchet and wrench to tighten.



**6.** Fit the air duct through the trim and into the air box.

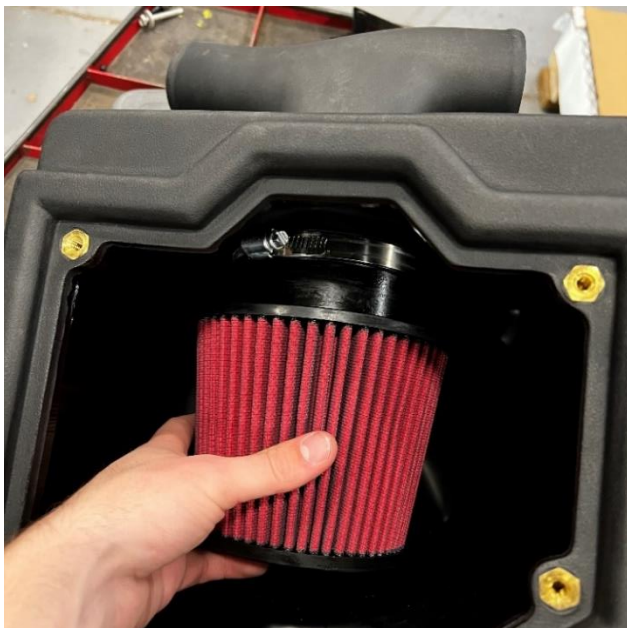

**7.** Install the air filter (Dry Filter Shown) and air filter clamp directly over the end of the air duct inside the air box. Use an 8mm socket and ratchet to tighten filter clamp to the air duct. Fit pre filter over top of filter if desired.

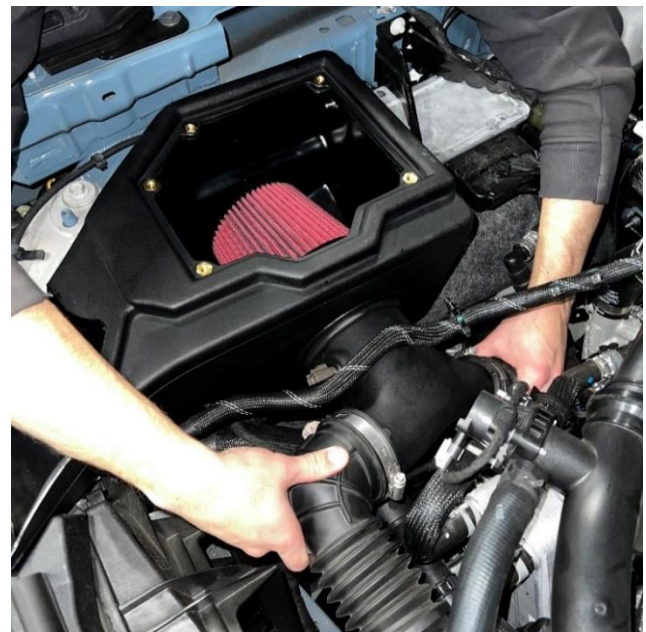

**8.** Install the CORSA air intake into the vehicle by pressing the air box into the stock rubber grommets beneath the intake while attaching the air duct to the stock turbo pipes.

Continued on Next Page . . .



**INSTALLATION INSTRUCTIONS**

CORSA INTAKE

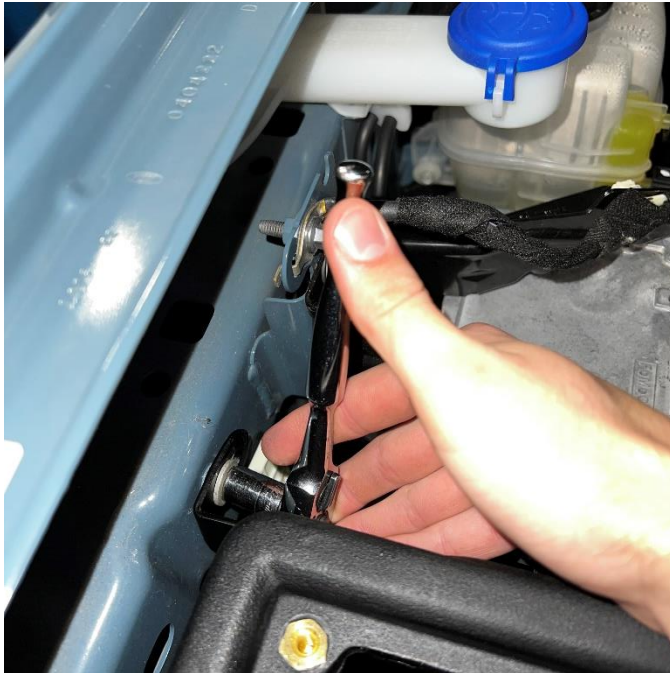

**9.** Align the supplied bracket to the threaded hole in the frame and use a 10mm socket and the stock bolt from removal step 2 to secure the CORSA airbox to the vehicle.



**10.** Tighten the larger stock clamp to the large CORSA duct inlet.

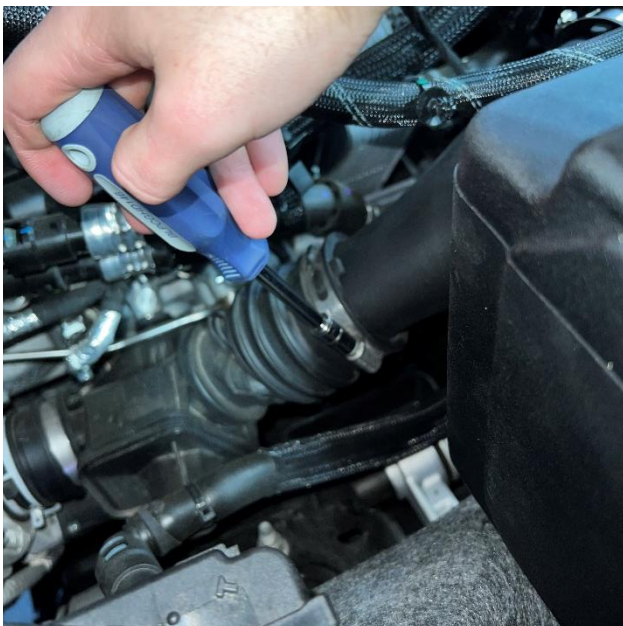

**11.** Tighten the smaller stock clamp to the small CORSA duct inlet.

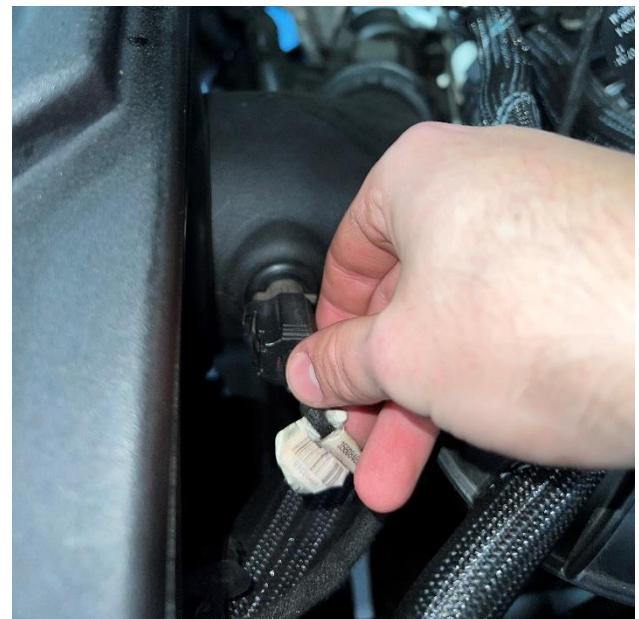

**12.** Re-attach electrical connection to the temperature sensor by pressing until it clicks into place.

Continued on Next Page . . .





- 13.** Use the supplied Christmas Tree clip to secure the scoop portion of the CORSA airbox to the stock air intake tray.



- 14.** Place the CORSA lid on top of the airbox and tighten to the air box using the lid screws and a Phillips screwdriver.

This concludes the installation of your CORSA air intake system.

*Check that this air intake complies with your Federal, State and Local laws.  
We recommend saving your stock system.*

### BEFORE ROAD TESTING

- 1.** Start engine, leaving the transmission in park and securing the parking brake.
- 2.** Make sure to look and listen for any unusual noises or air leaks. Repair problems if needed.
- 3.** Once completed it will be necessary to check periodically, after a few heat cycles, for realignment and tightening of all connections.

### Max Flow 5 CARE AND CLEANING

Check the Max Flow 5 cotton reusable filter periodically and remove any excessive dirt build-up by tapping the filter on the ground and brushing off the loosened dirt. Clean the filter by using a two-stage cleaning kit to thoroughly clean and re-oil the filter. Re-oil every 10,000 miles without cleaning to improve filtering in sand and dirt. Clean only when dirt is very excessive or 50,000 miles.

**Reference for Replacement Filters:** Max Flow 5 Filter Part #5143, DryTech 3D Filter Part #5143D, or PowerCore<sup>®</sup> Filter 61509.