



PLEASE NOTE:

All acrylic parts have protective film applied on both sides.

Some pieces appear with slightly translucent film, this will need to be removed before assembly.

Ensure all engraved lines face outwards.

INSTRUCTIONS FOR: LE LEGO® F1® Collectible Race Cars (71049) Wall Mount Stand

LDS661.X.11

Parts list:

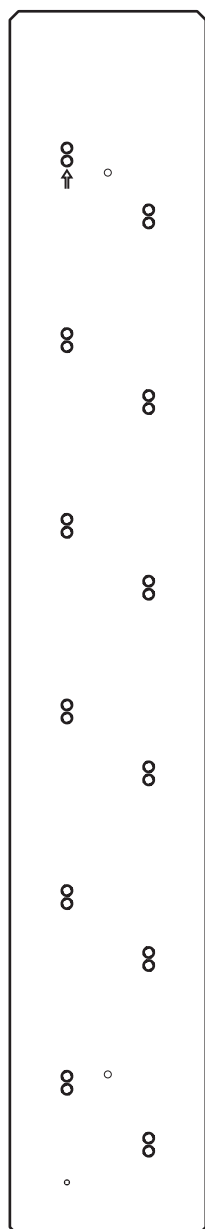

1 - PRT1



2 - PRT2 (Only applicable for LDS661.1.10)



3 - CPT2 (1x pack)

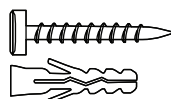

4 - CPT5 (1x pack)

INSTRUCTIONS FOR: LE LEGO® F1® Collectible Race Cars (71049) Wall Mount Stand

LDS661.X.11

1

A

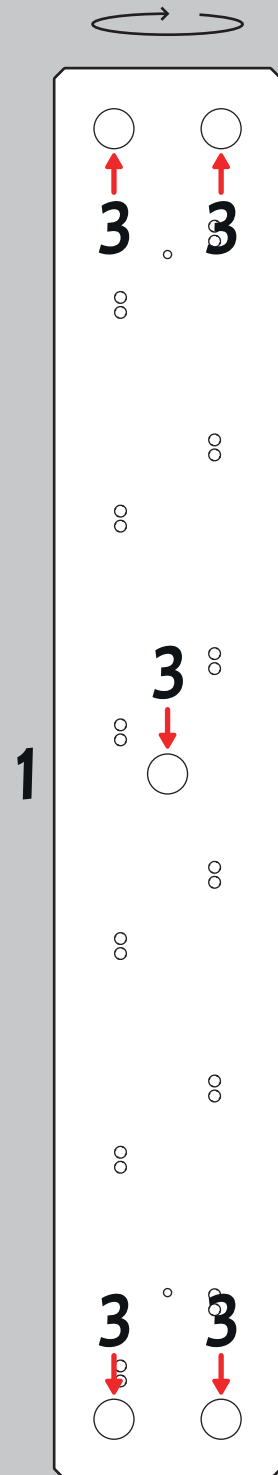

Apply felt pads to the back of part 1.

B

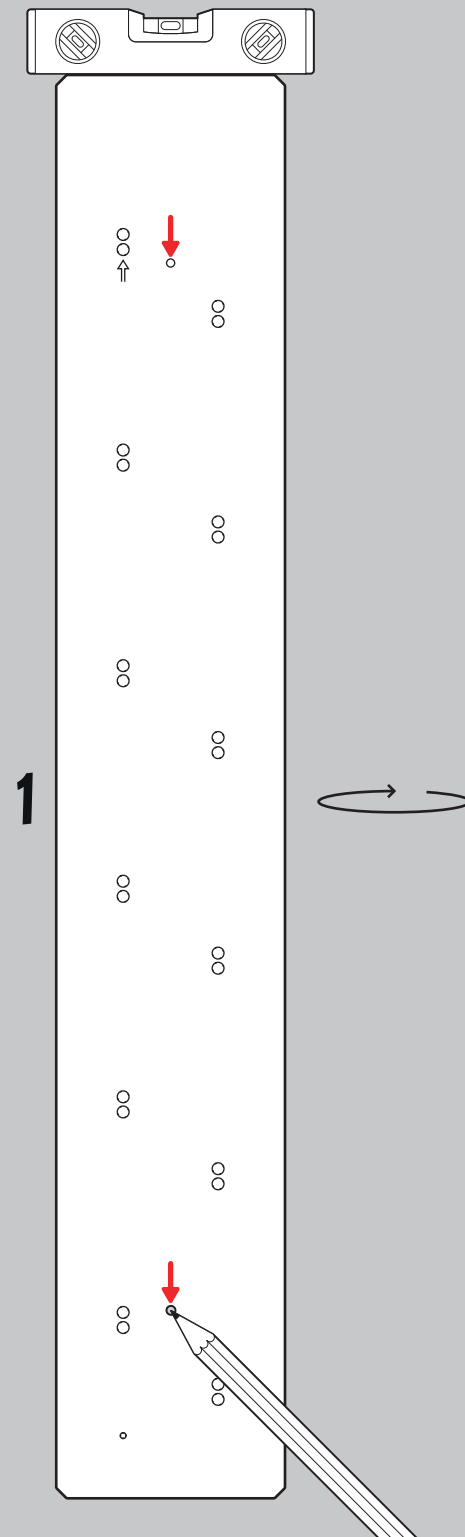

Using part 1, pencil and spirit level (not included) mark on the walls where you would like the display to go.

C

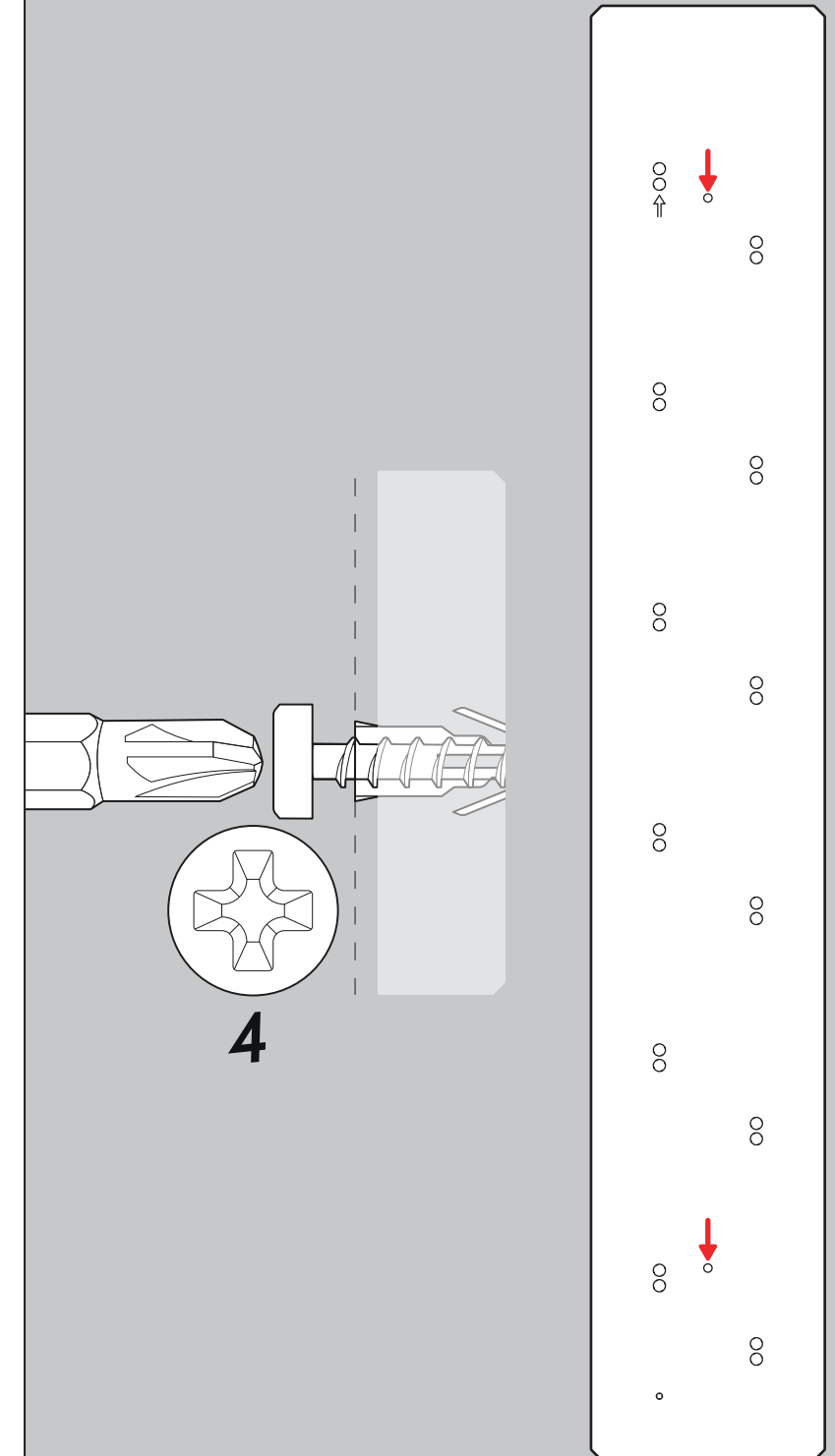

Screw part 1 into the wall using markings created in step B.

INSTRUCTIONS FOR: LE LEGO® F1® Collectible Race Cars (71049) Wall Mount Stand

LDS661.X.11

2

D

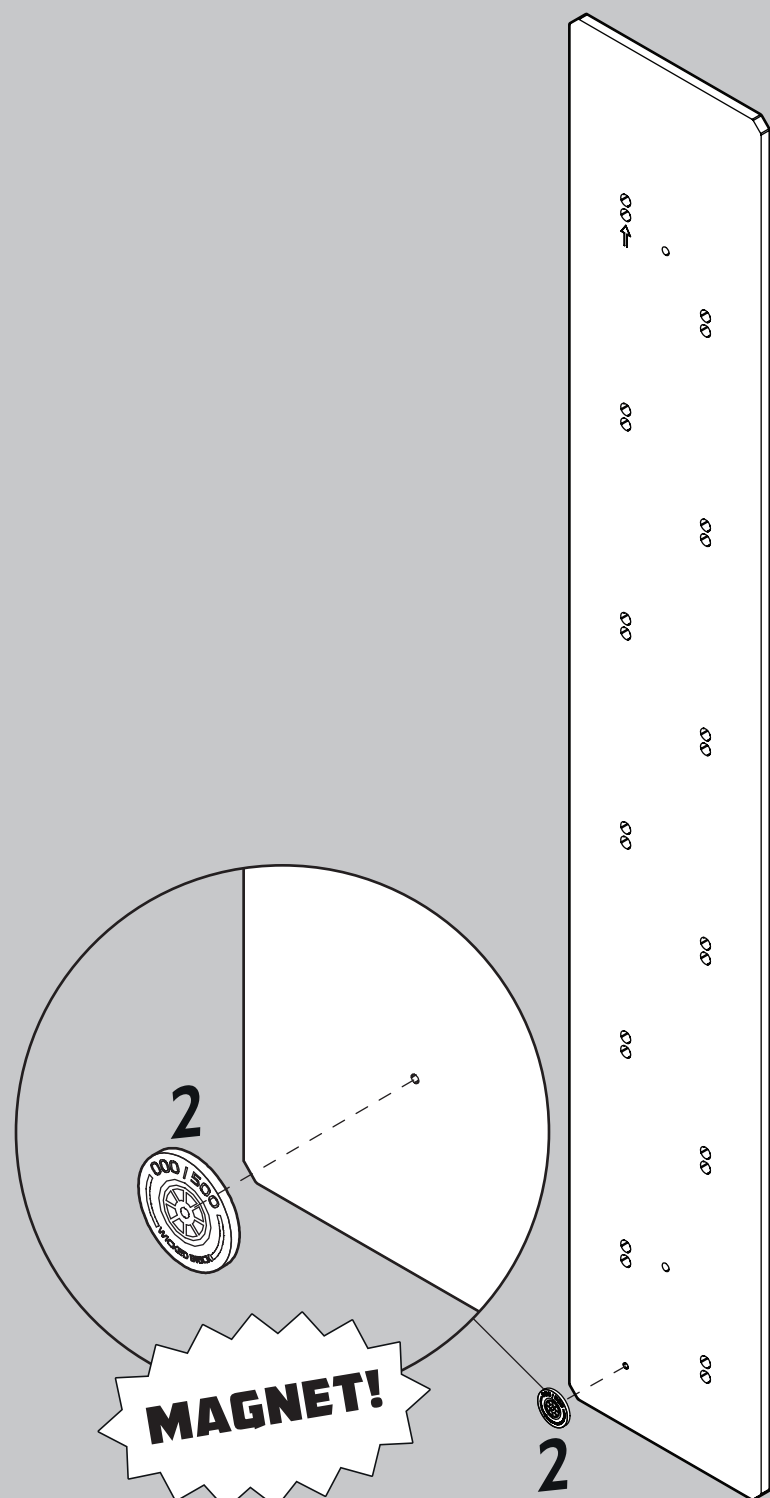

Complete this step if applicable.

E

1

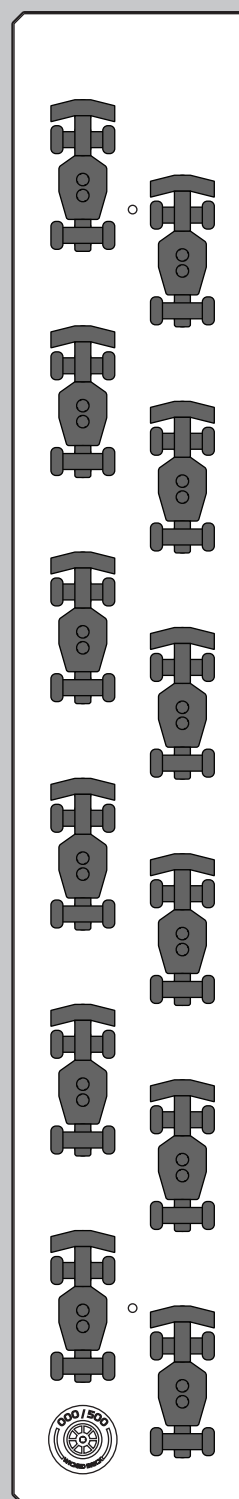

Vertical.
Attach LEGO sets onto part 1 via studs.

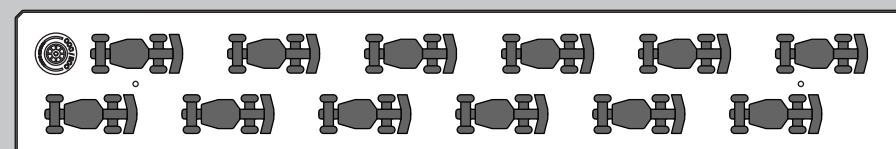

Horizontal

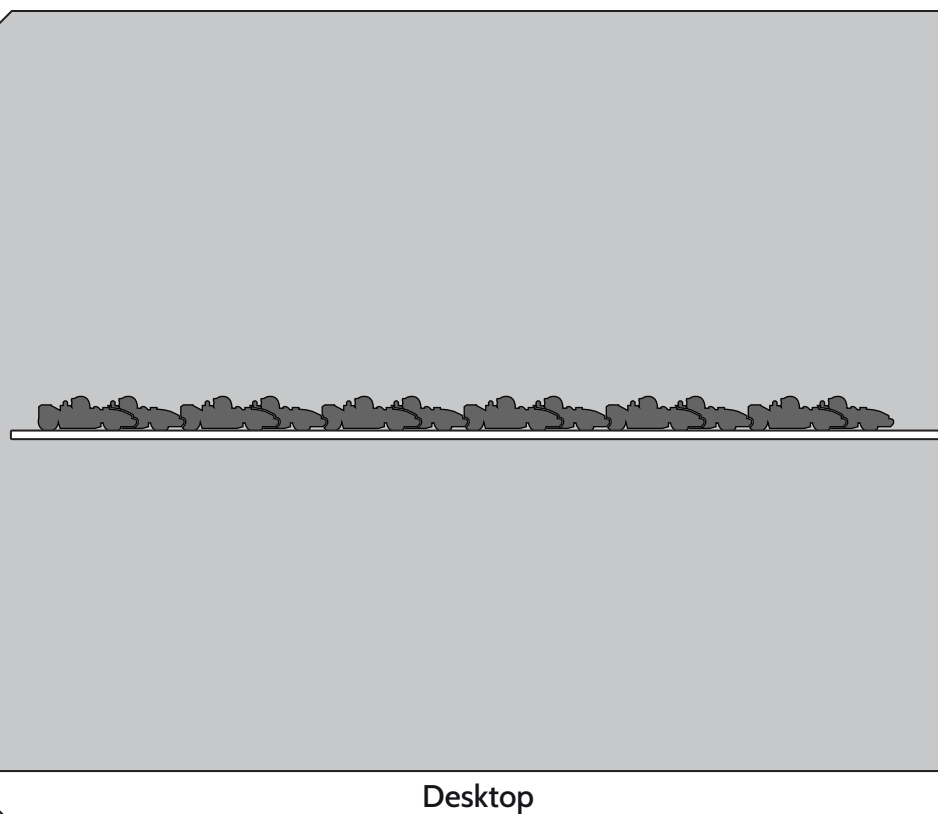

Desktop