



# Scaffold & Shoring

## *Product Engineering Data*

Canadian Equipment Outfitters  
3399 9th Line, Barrie, ON L9S3Z5  
1-866-436-3471  
[www.ceocanadadirect.com](http://www.ceocanadadirect.com)

CEO Scaffolding manufactured by TOPS Scaffold & Shoring Supply Ltd.

## Standard Loading Chart

All figures are based on the physical testing which are conducted in compliance with CSA S269.2 and ANSI/SSFI SC100-5/

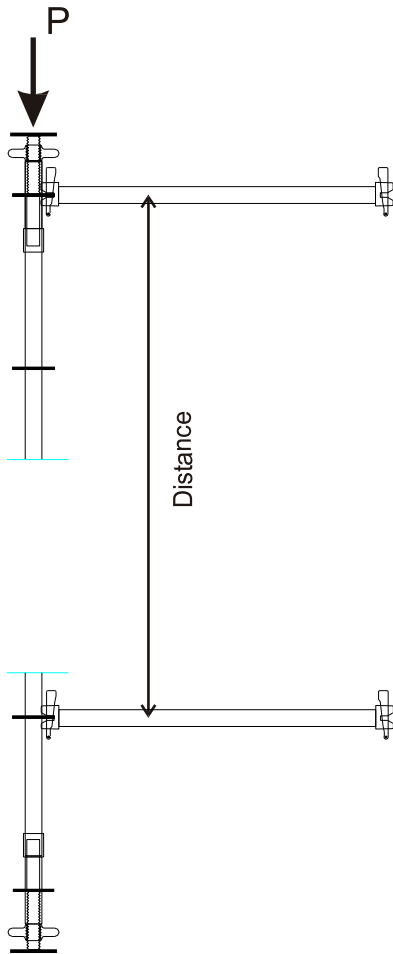

**Distance "Y" is the vertical distance on the Standard between ledger levels, where at least two ledgers are connected at right angles, providing support to the standard against movement in both directions.**

**All the allowable working loads indicated on this load chart have a factor of safety of 4:1 against failure.**

Distance		Capacity	
mm	ft in	KN	lb
3000 mm	9' 10"	11.0	2,500
2000 mm	6' 6"	22.0	5,000
1500 mm	4' 11"	33.4	7,500
1000 mm	3' 3"	40.0	9,000

4:1 Safety Factor

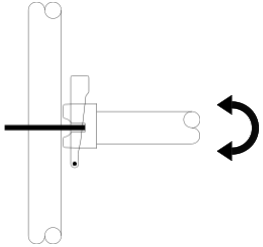
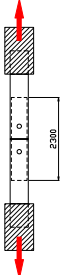
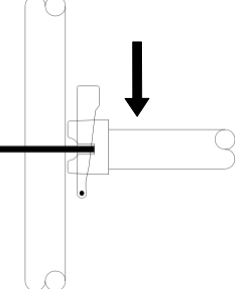
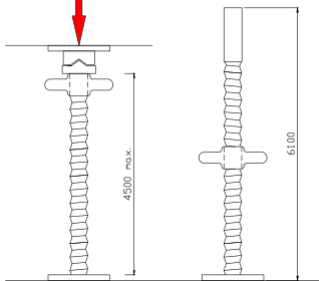
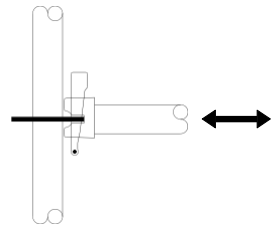
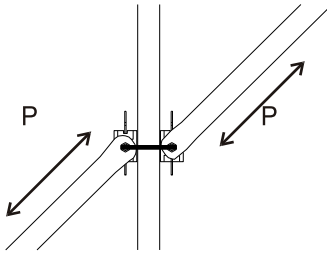
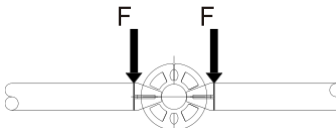
	<p><b>Description</b>  <b>Bending Moment Test</b> --            Rotation load applied to Ledger, secured to Rosette with Wedge            6145 lb - in</p>		<p><b>Description</b>  <b>Coupling Pin Test</b> -- Axial Tensile Force applied to standards, secured to coupling pin with high tensile bolts.            1,200 lb-in</p>
	<p><b>Description</b>  <b>Vertical Shear Test</b> --            Vertical Shear Force applied to ledger head, secured to rosette with wedges 7,610 lb on two ledgers 3,805 lb on one ledger</p>		<p><b>Description</b>  <b>Screw Jack Test</b> -- Axial compressive load applied to screw jack. 12,500 lb</p>
	<p><b>Description</b>  <b>Ledger Tensile Test</b> --            Horizontal load applied to ledger, secured to rosette with wedge. 2,879 lb</p>		<p><b>Description</b>  <b>Tension &amp; Compression</b> --            Diagonal force onto a set of 2 diagonal braces keeping the vertical standard in place            2,500 lb</p>
	<p><b>Description</b>  <b>Horizontal Shear Test</b> --            Horizontal shear force applied to ledger heads, secured to rosette with wedges. 3,571 lb for each ledger</p>	<p><b>For any other loading configuration please contact CEO</b></p> <p><b>Safety factor 4:1</b></p>	

## Ledger Loading Data

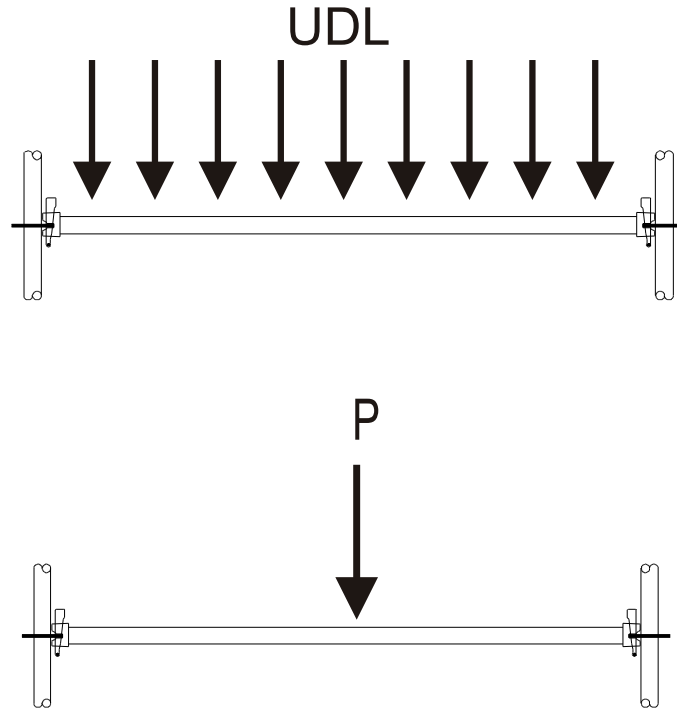

Distance		UDL		Point Load	
mm	ft in	KN/m	lb/ft	KN	lb
650 mm	2' 2"	23.4	1,785	7.8	1,760
1,150 mm	3' 10"	7.2	544	4.3	978
1,572 mm	5' 2"	4.0	305	3.2	726
2,130 mm	PT 7' 0"	2.1	166	2.4	536
3,050 mm	10' 0"	1.06	81	1.7	375

4:1 Safety Factor

\*PT: Physical Test

\*CV: Calculated Value

**Other sizes available  
upon request.**

## Modular Double Lattice Girder

Safety Factor 4:1

PART NUMBER	LENGTH		ALLOWABLE UNIFORM LOAD		SETUP	NO. OF LOADS	EQUAL SPACING		ALLOWABLE LOAD (P)	
	M	FT	KN/M	LB/FT			M	FT	KN	LB
1	4.27	14	4.6	315	1	1	2.13	7	9.8	2200
2	5.18	17	3.8	259	2	1	2.59	8.5	9.8	2200
3	6.40	21	3.1	210	3	2	2.13	7	7.3	1650
4	7.32	24	2.6	180	4	2	3.66	12	9.6	1525
5	8.53	28	2.3	158	5	3	2.13	7	4.9	1100

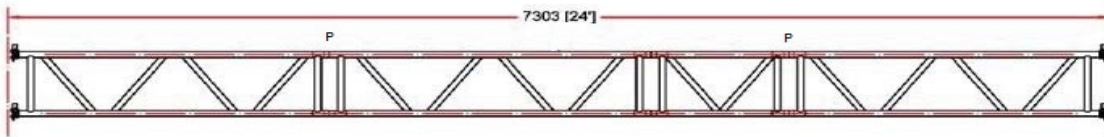
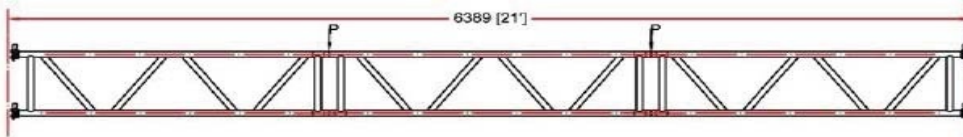
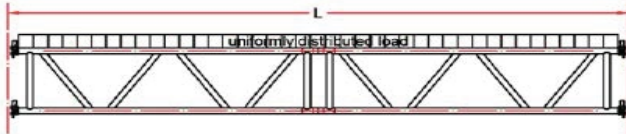

## Double Ledger Loading

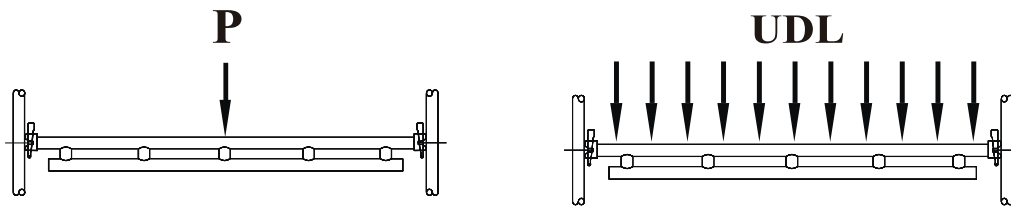

Distance		UDL		Point Load	
mm	ft in	KN/M	lb/ft	KN	lb
3,050 mm	10' 0"	5.1	350	6.5	1,460
2,130 mm	7' 0"	10.2	700	8.9	2,000
1,572 mm	5' 2"	13	900	12.4	2,800
1,150 mm	3' 10"	14.7	1,000	15.5	3,500

4:1 Safety Factor

### Side Bracket Loading Chart

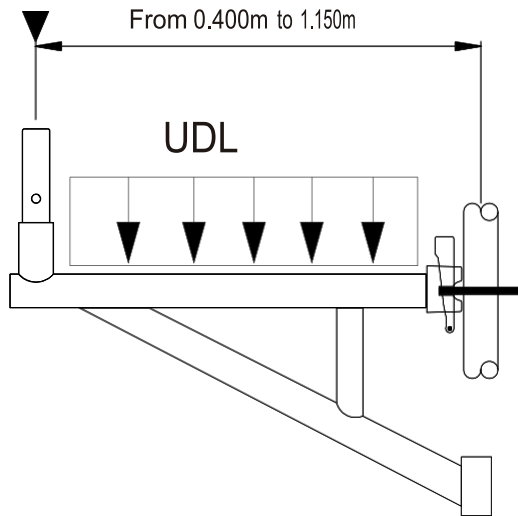

UDL  
4.9 (kn) 1000 lb

4:1 Safety factor

### Aluminum Plydeck Loading

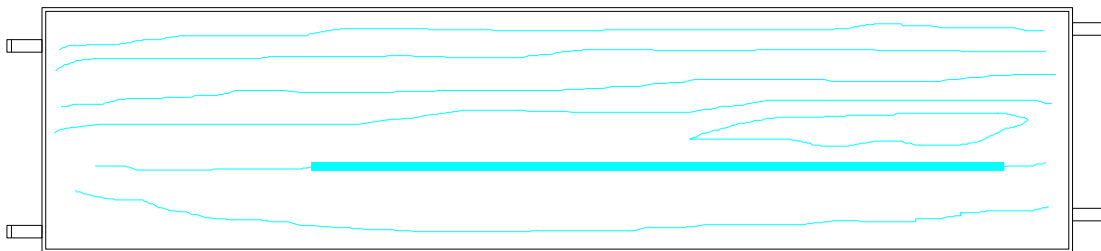

**Description**

Any Length  
up to 3.0 m (10ft)

**Load**

UDL  
489 Kg/m<sup>2</sup>  
100 psf

UDL

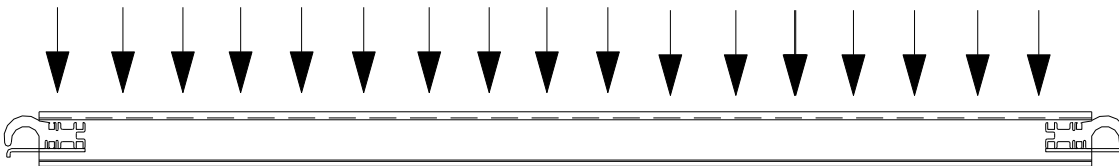

### Typ. Diagonal Bracing

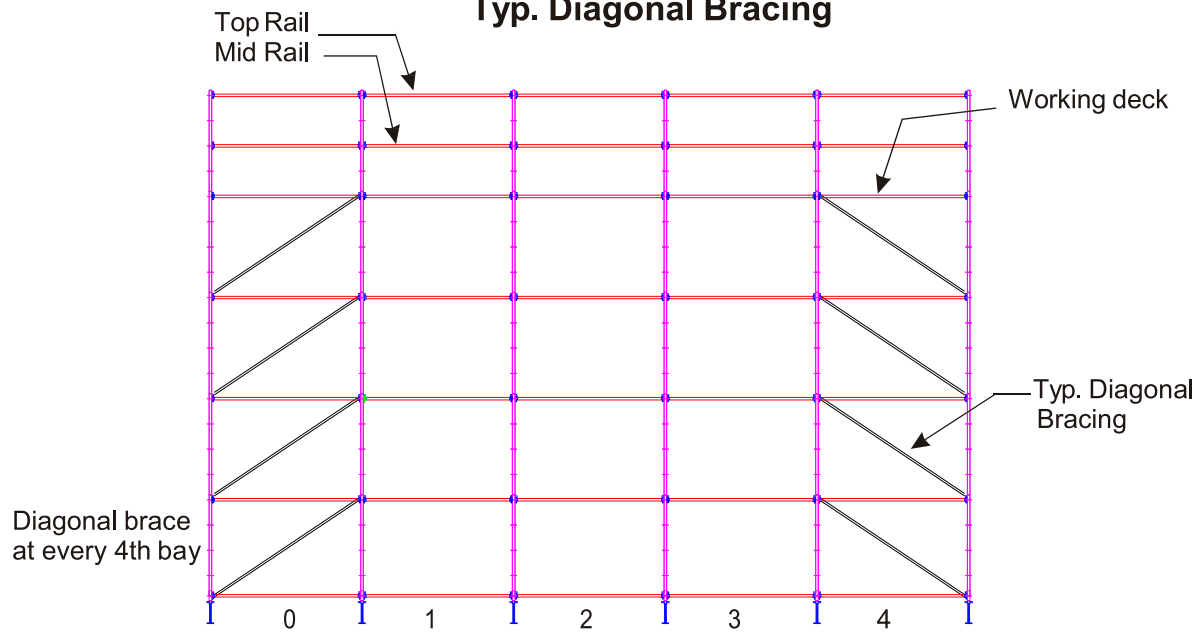

### Alternative diagonal Bracing

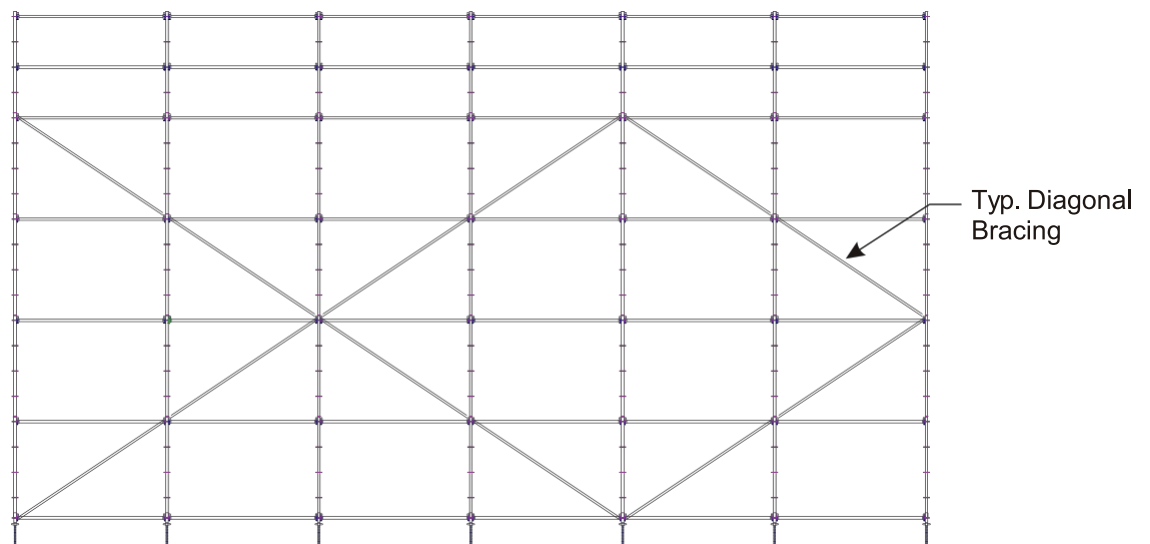

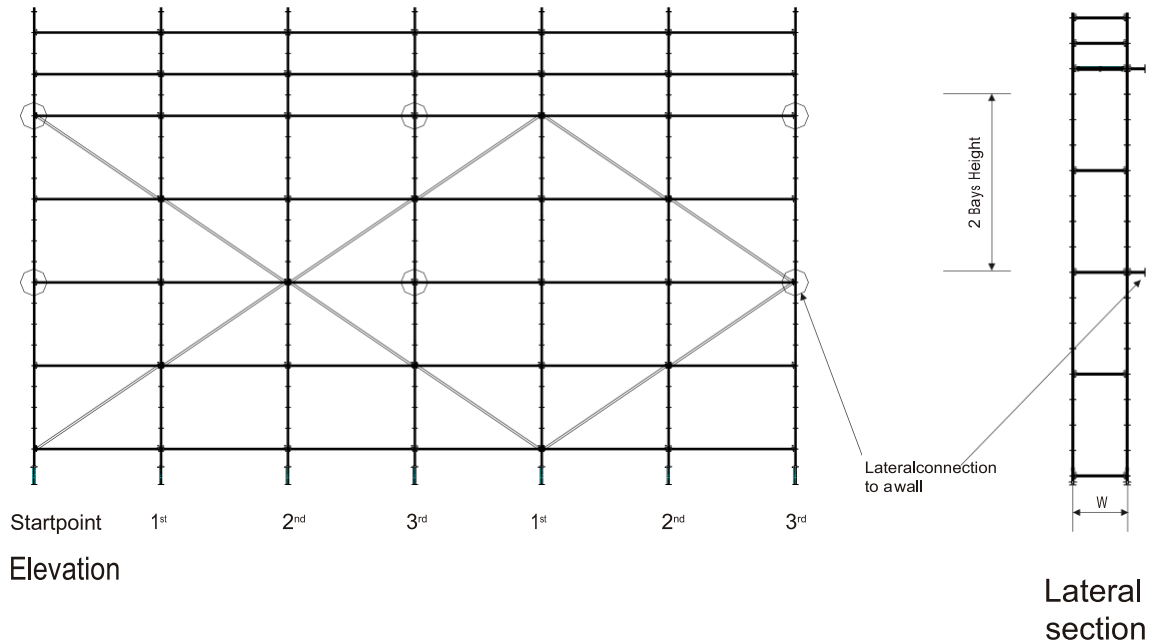

### Pipe Mechanical Properties

Outside diameter	48.6 mm	1.9 in
Wall thickness	3.2 mm	0.125 in
Min Yield stress:	35.2 Kg/mm <sup>2</sup>	50 Kpsi
Min Tensile strength	47.9 Kg/mm <sup>2</sup>	68 Kpsi
Elongation	30 %	
Cross section area	451 mm <sup>2</sup>	0.699 sqi
Section module	4.77 e 3mm <sup>3</sup>	0.291 in <sup>3</sup>
Inertia moment	1.15 e 3mm <sup>4</sup>	0.277 in <sup>4</sup>





**Canadian  
Equipment  
Outfitters**

# Scaffold & Shoring



Canadian Equipment Outfitters  
3399 9th Line, Barrie, ON L9S3Z5  
1-866-436-3471  
[www.ceocanadadirect.com](http://www.ceocanadadirect.com)

CEO Scaffolding manufactured by TOPS Scaffold & Shoring Supply Ltd.