

Hand pallet truck with weighing system model HU W-20 S SILVERLINE

Capacity 2000kg

For transportation and weighing of palletised goods and box pallets.

Features

- Ergonomic safety control handle for one-hand operation of lifting, driving and lowering.
- Ergonomic rubber control handle for safe handling.
- Measuring range from 0 up to 2000kg in 1kg steps.
- Easy to read LCD display.
- Accuracy +/- 0.1 % of the end value.
- The readings start at 1.0kg.
- The weighing system is calibrated at the factory.
- The system is designed for simple weighing jobs, such as batching or filling processes.
- Low maintenance hydraulic pump with hard chromium plated piston and pressure relief valve.
- Frame and forks in robust steel construction, adjustable connecting rods, especially hardened axles and the high quality powder coating ensure a long life expectancy.
- Steering angle of 105 degree to each side for easy handling in confined spaces.



Scope of delivery

- 4x1.5 V batteries

Technical data model HU W-20 S

Model	HU W 20 S
Art.-No.	040016431
Capacity, kg	2000
Load center c, mm	600
Weight, kg	129
Tyre type ¹	PUR/PUR
Steering rollers D, mm	180x50
Load rollers D1, mm	74x70
Number of wheels/load rollers	2/4
Stroke h2, mm	110
Lifting height h3, mm	195
Height of control handle h14, mm	1210
Fork height lowered h13, mm	85
Overall length L1, mm	1580
Fork height s, mm	50
Fork width e, mm	180
Fork length l, mm	1150
Outside dimension of forks b1, mm	570
Inside dimension of forks b3, mm	210
Ground clearance m1, mm	35
Turning circle radius, mm	1330
Ambient temperature	-10°C up to +40°C

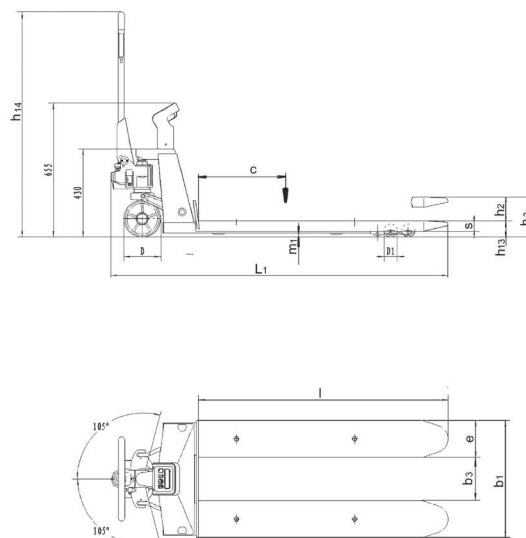

¹PUR... Polyurethane