

'GET PEGGY WALL' (FLATPACK)

Spec Sheet

Last Updated: May 18, 2023

For further information regarding any of our rental products please refer to the product listing on the website - www.timbermillrentals.com

Important Notes!

Please note, all items are handcrafted and will always have some kind of slight variation and you will need to allow for tolerance if getting any signage or similar created off these dimensions.

Please read our general signage document for information on applying signage to our bars.

Timbermill holds no responsibility for anything created based off these dimensions.

All drawings and products are copyright to Timbermill PTY LTD.

FRONT VIEW

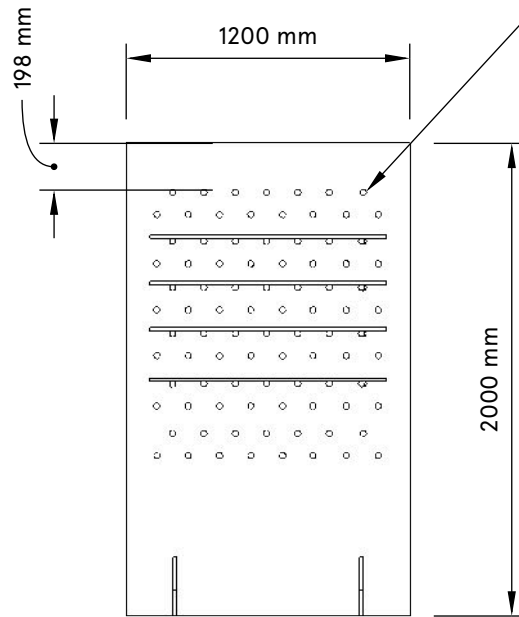

All holes are cut to suit a 25.4mm dowel piece. NB: They will always be tight when installing.

We are able to provide an illustrator & PDF file of peg layout for if you need to create signage for this item.

Item comes with 4 shelves & a bag of 10 pegs as standard for you to use as required.

No more than 5kg of Weight hung/displayed On these boards without further engineering.

TOP VIEW

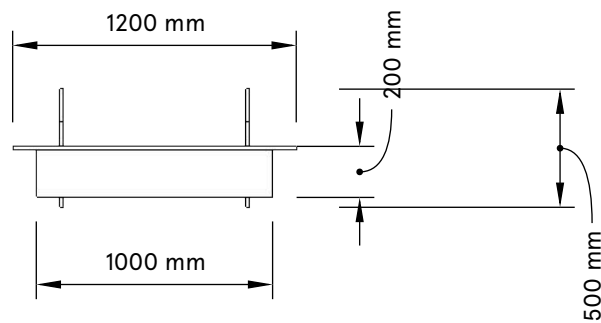

SIDE VIEW

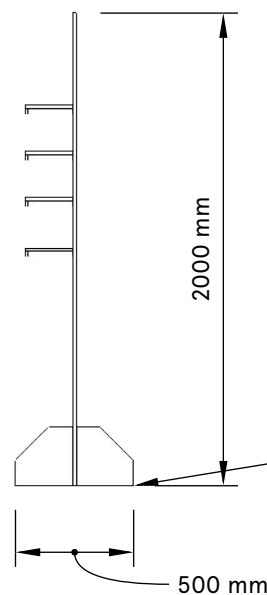

Requires very simple Assembly on site. You slot 2 feet into board, And then install your shelves and pegs as required.