



TRONK FRANKLIN SHELF INSTALLATION INSTRUCTIONS

Required tools:

Screw driver
Hand drill
Hammer
5/16" Drill Bit

Provided Hardware:

4 - 3/4" screws
2 - L-brackets
2 - Drywall mounts
2 - Long screws for drywall mounts

- 1) Decide if you would like the shelf to fit an inside corner or an outside corner.
- 2) Use the pre-drilled mounting holes and attach the L-bracket using the screws provided. These are located on the bottom of the middle shelf.

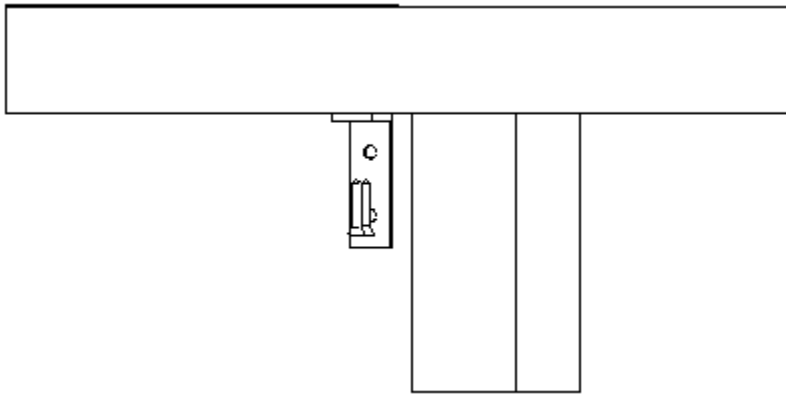

- 3) Hold the shelf in position approximately 2" higher than where you actually want the shelf to be located. (There may be a small gap between the shelf and the wall. This is ok and will not affect the stability of the shelf.)

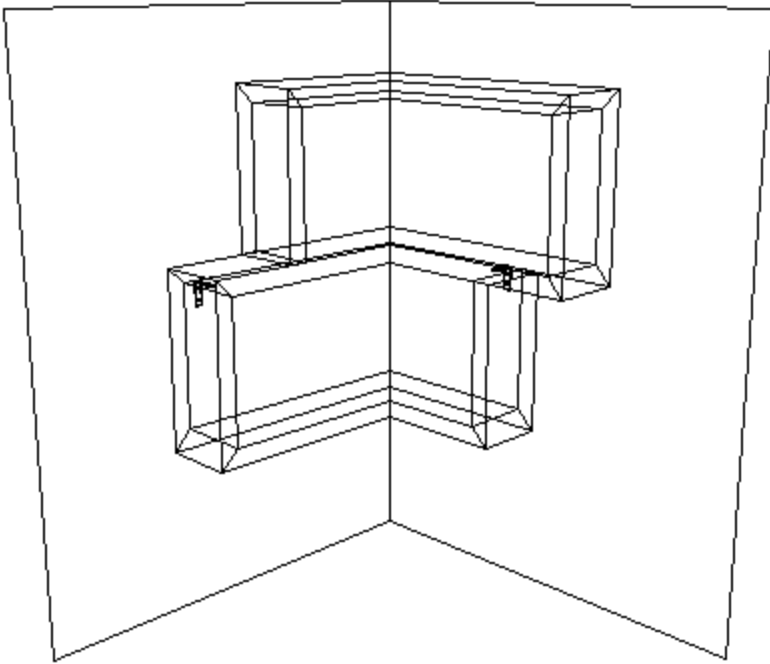

- 4) Use a pencil and make a mark on the wall in the center of the lower hole of the L-bracket.

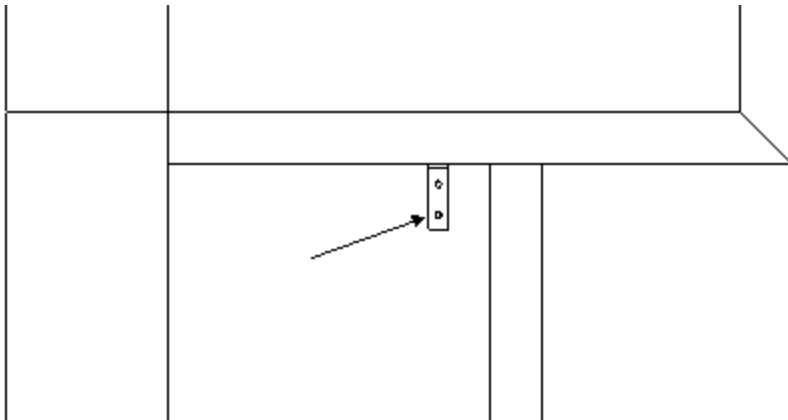

- 5) Remove shelf and drill a hole using the 5/16" drill bit.
- 6) Remove L-bracket from the shelf.
- 7) Insert the drywall mount and hammer it flush against the wall.

8) Screw L-Bracket onto the wall.

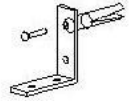
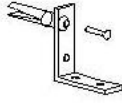

9) Place the shelf back into position and attach the shelf using screws provided.

