



Instruction Manual

MEDUSA BATTERY OPERATED SWEEPER



MODEL: VMEDUSA

- Please read this Instruction Manual carefully before operation and follow all guidelines before using this vacuum cleaner.
- Please keep this Manual for future reference.

Please read carefully the instruction manual and safety information before using.

Any use extending beyond the indicated usages is not considered proper use. The manufacturer is not liable for any losses resulting from improper use; the user alone bears the risk for this.

This machine can pick up particles with a diameter of up to 2 cm.

Sturdy, powerful and easy to use, it is also fitted with accessories making it truly efficient for rapid deep cleaning.

This machine is perfect for various uses, for example in hotels, schools, hospital, factories, shops and living quarters.

SAFETY



WARNING! Risk of injury!

- This machine is not to be used by people (children included) with reduced physical, sensorial or mental capacities or without any experience and knowledge, unless they received instructions relative to the use of the apparatus and are supervised by a person responsible for their safety.
- Children should be supervised so that they don't play with the apparatus.
- The packaging components could constitute potential dangers (for example plastic bags): They must be kept away from children's reach and from other people not conscious of their actions.
- Keep animals away from the apparatus.
- Any use different from those indicated in this manual could constitute a danger, therefore, it must be avoided.
- The appliance contains rotary brush roller; please never touch them with the fingers or any other tool when the appliance is in operation!
- Remove the batteries before starting any maintenance or repairs to the machine!
- The machine must be assembled correctly. It must be verified that the sweeper roller and the sides weepers are correctly attached and the battery is charged and locked.
- This machine is not certified to work with hazardous dust.
- Do not use this machine for burning, glowing, explosive, toxic or noxious substances.
- The apparatus is not suitable for areas protected against electrostatic discharges.
- Use only the brushes supplied with the apparatus or those specified in the instruction manual. Using other brushes could jeopardize safety.
- Don't leave the apparatus unattended while is in function.
- Do not use this machine for liquids.



WARNING! Danger of electric shock!

- Do not submerge the apparatus in water or use water jets to clean it.



Tips for the rechargeable battery and charger

- You may recharge the battery using only the original charger provided with the appliance.
- Check machine, charger, mains cable and battery pack for damages before every use.
- Do not use damaged devices and get the damaged parts repaired only by experts.
- Do not use the charger and battery pack if dirty or wet.
- The mains voltage must match the voltage mentioned on the type plate of the charger.
- Ensure that no metal pieces reach the contacts of the charger and battery pack, else there will be a short circuit.
- Do not charge the primary cells of the batteries; risk of explosion.
- Do not dispose of battery packs by throwing them into fire or into household garbage.
- Avoid contact with liquids oozing out of defective battery packs. Rinse thoroughly if you accidentally come in contact with the fluid. Also consult a doctor if the fluid comes in contact with your eyes.



WARNING! Risk of injury!

- Specialized personnel must always carry out maintenance and repairs; any damaged part must be substituted with original spare parts.
- It is forbidden to carry out changes to the apparatus. Tampering could cause fires and damages even lethal to the user and the forfeiture of the guarantee.
- The manufacturer declines any responsibility for damages caused to people or things due to non-compliance with these instructions or if the apparatus is unreasonably used.

INSTRUCTIONS :

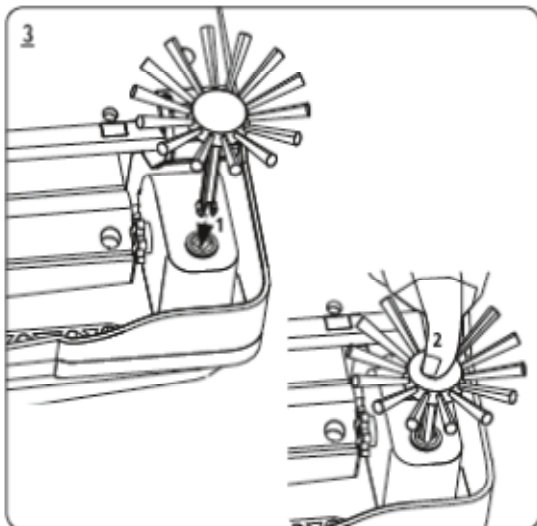
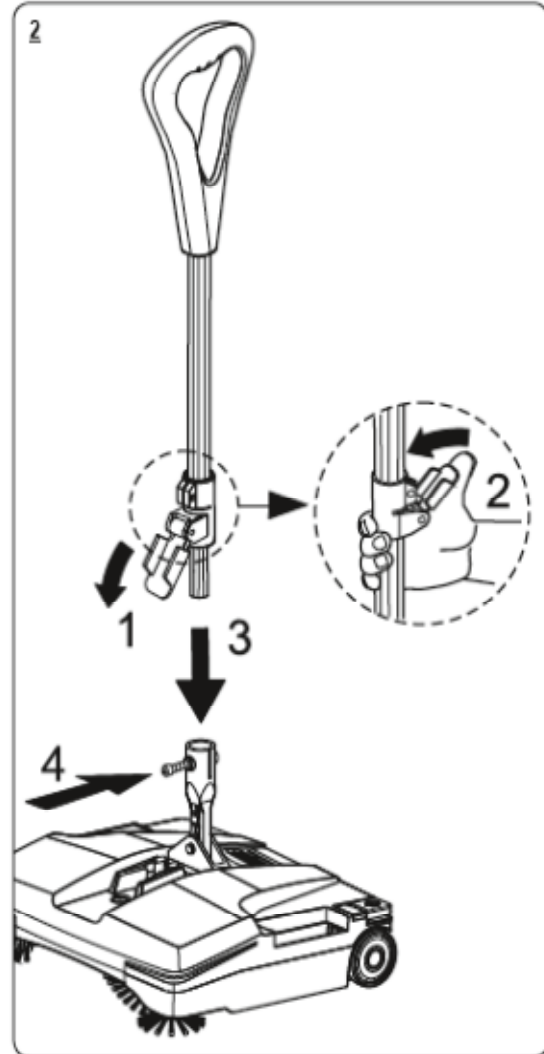
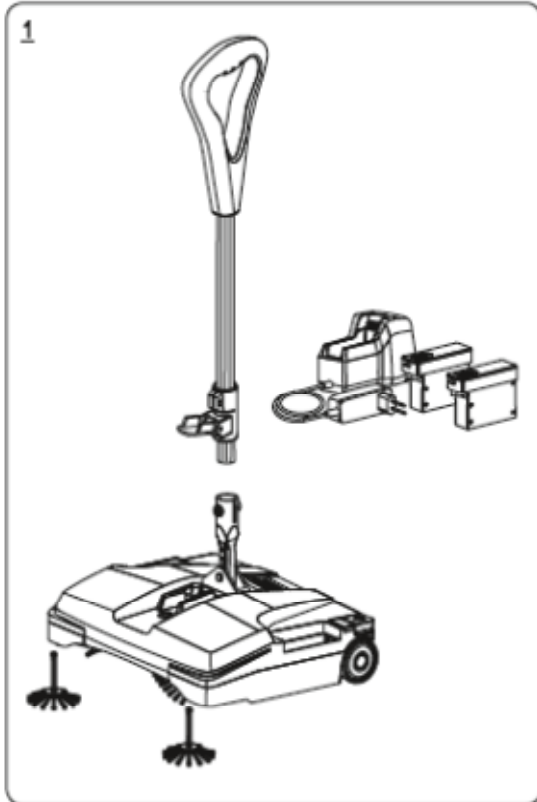

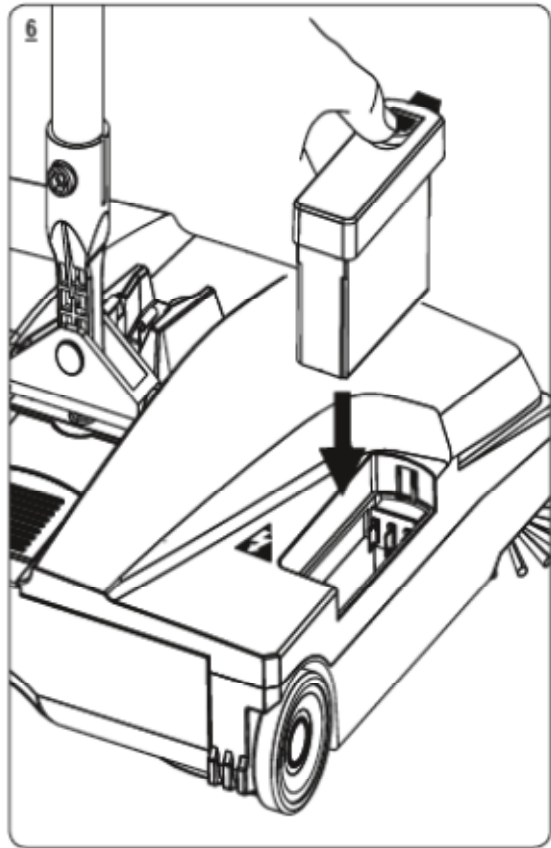
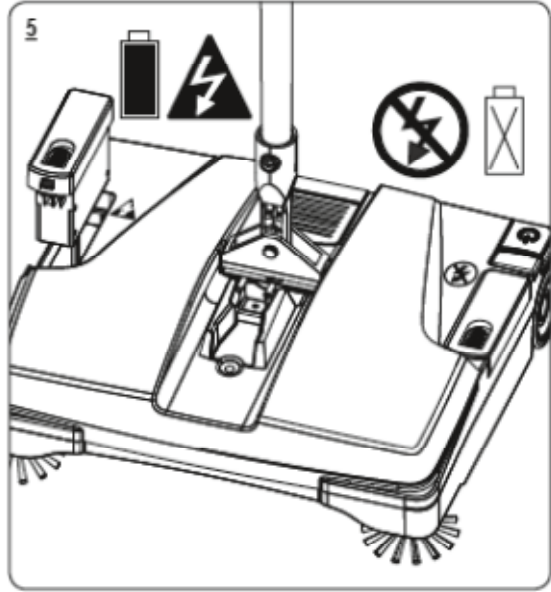
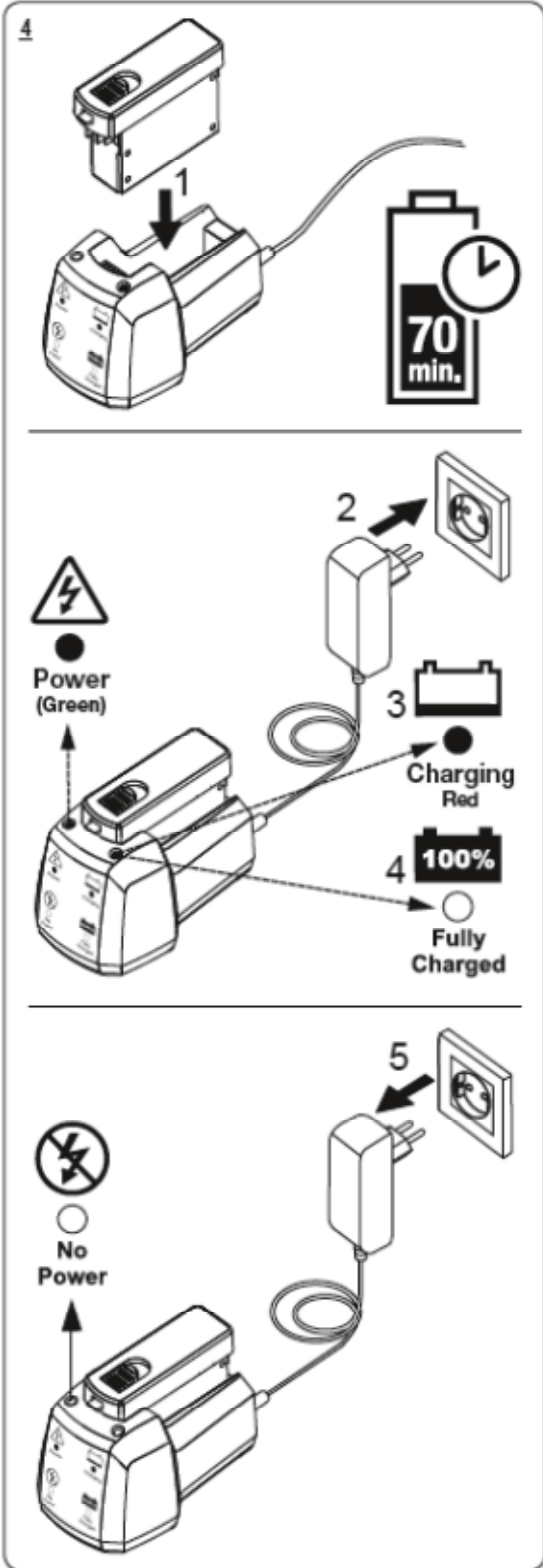

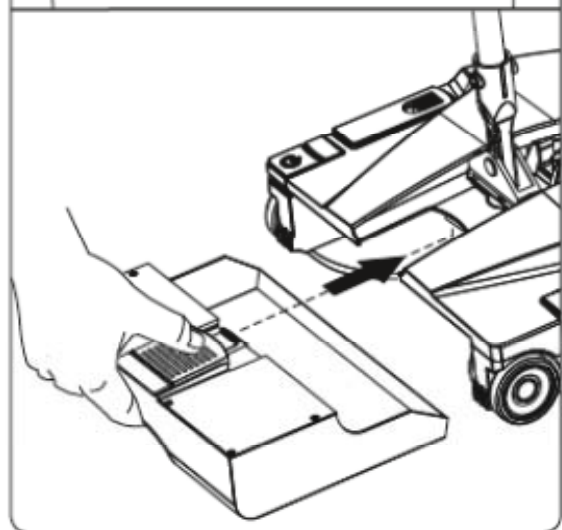
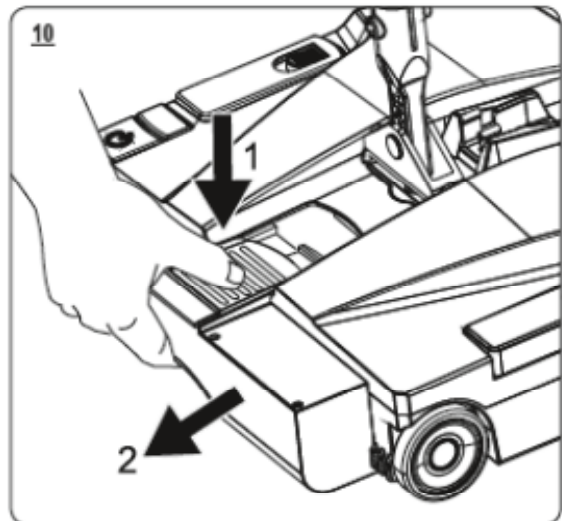
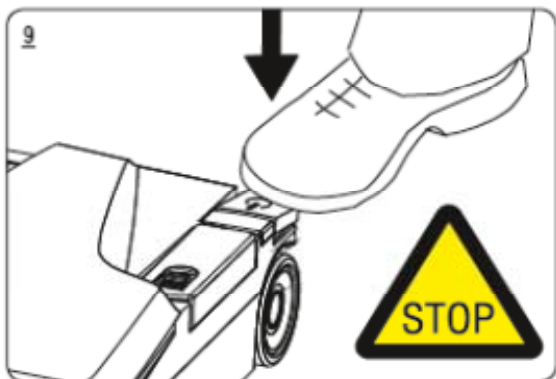
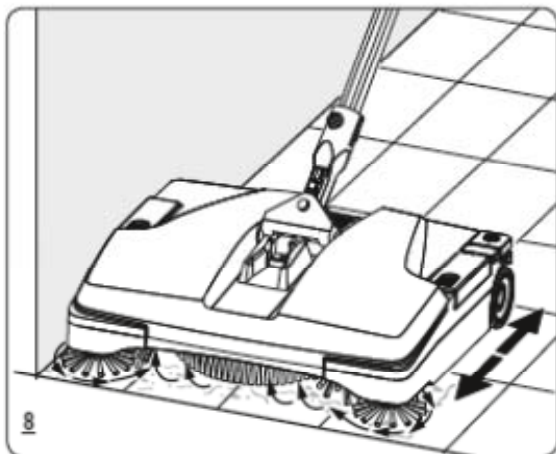

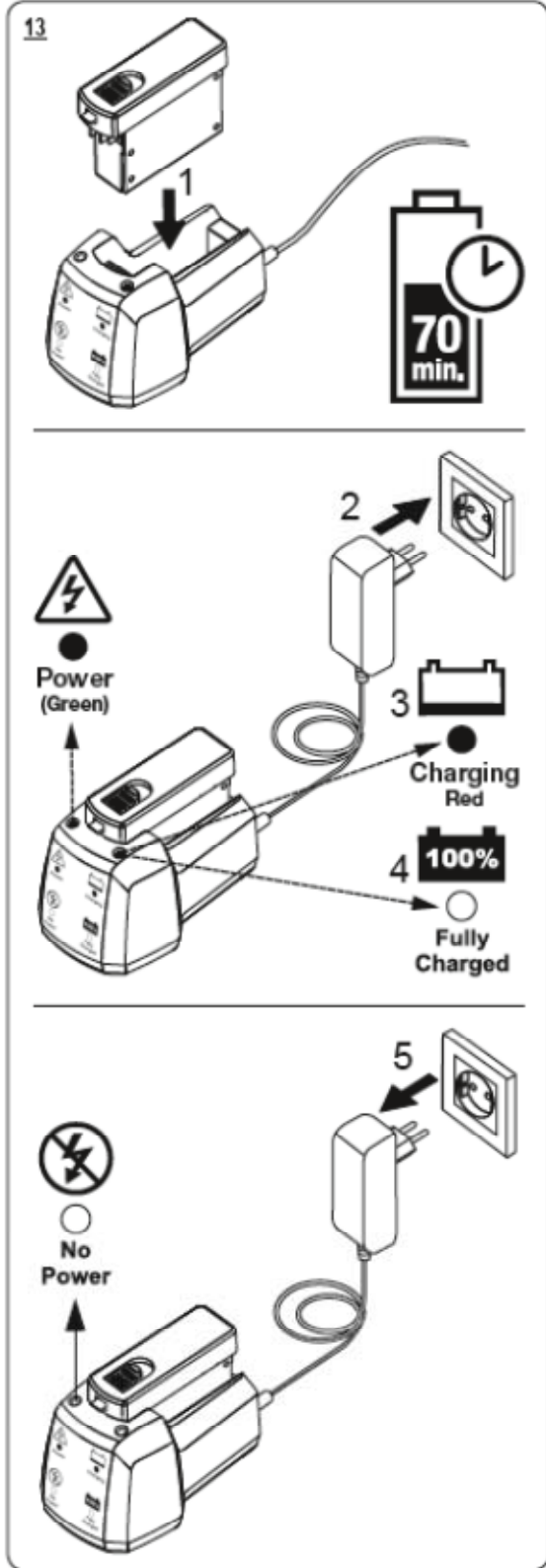
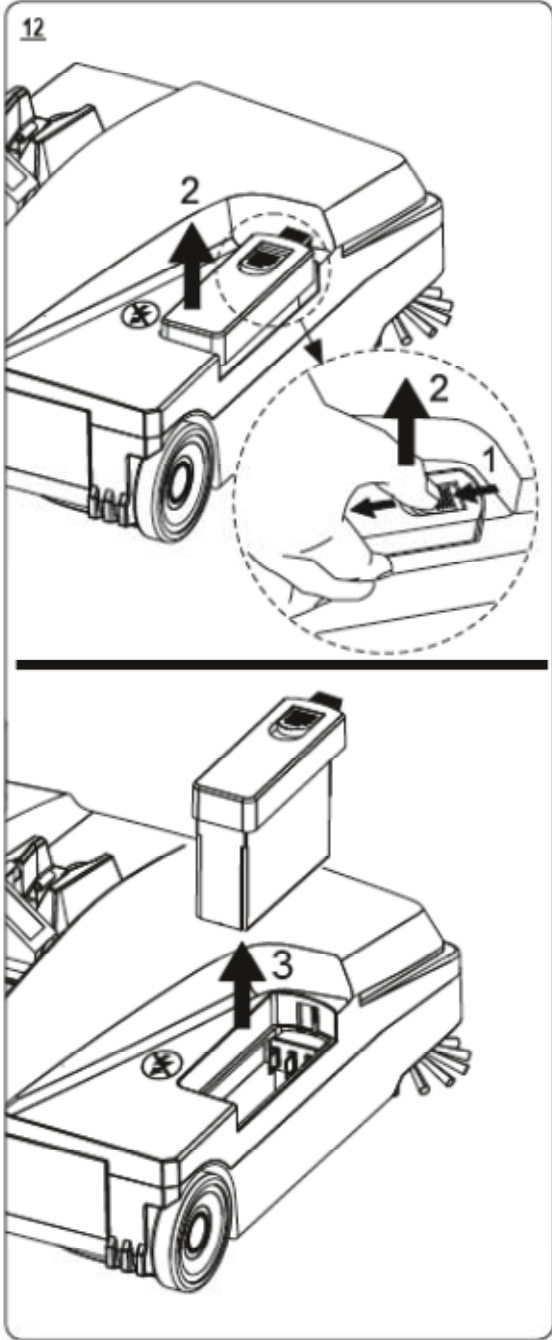

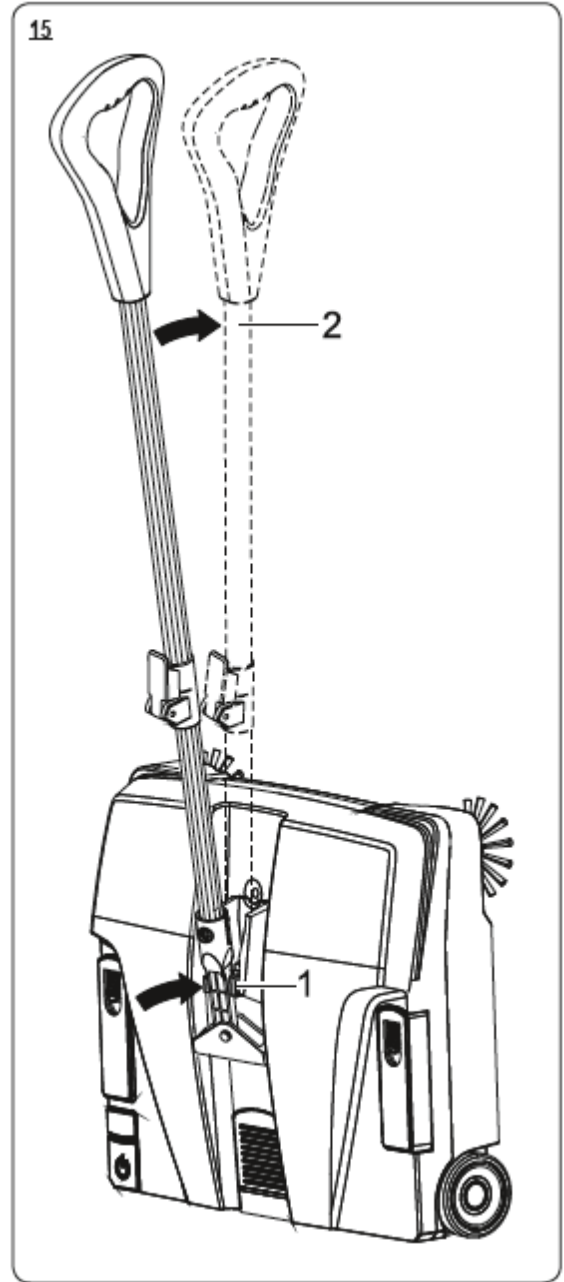
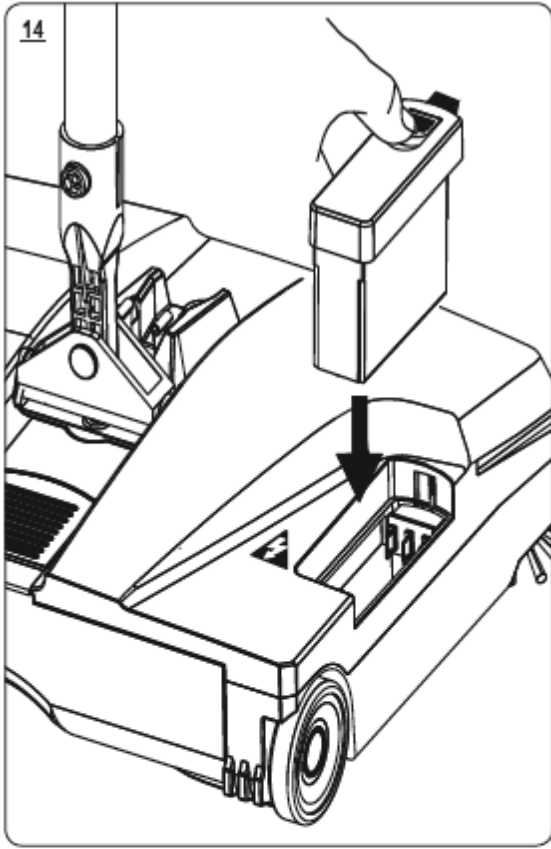

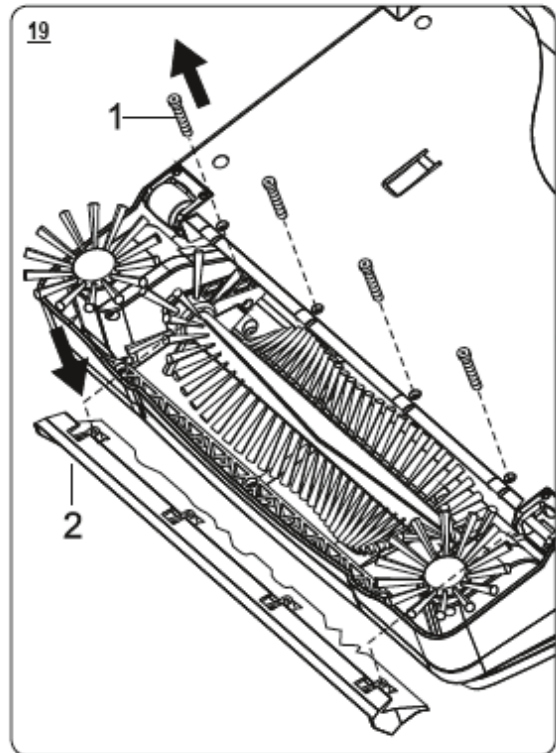
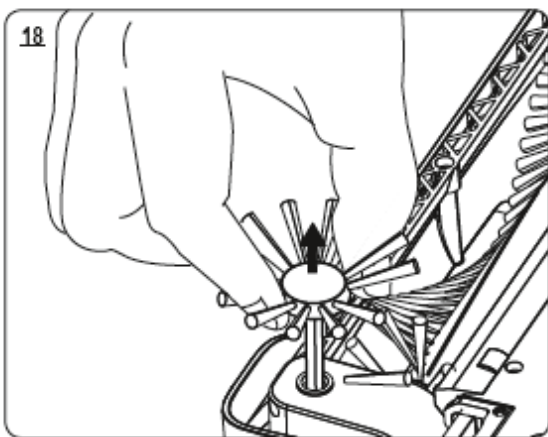
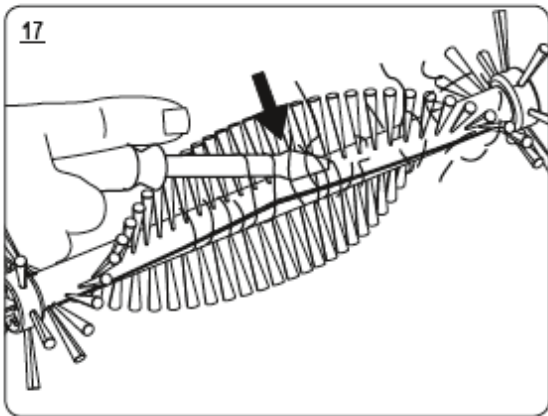
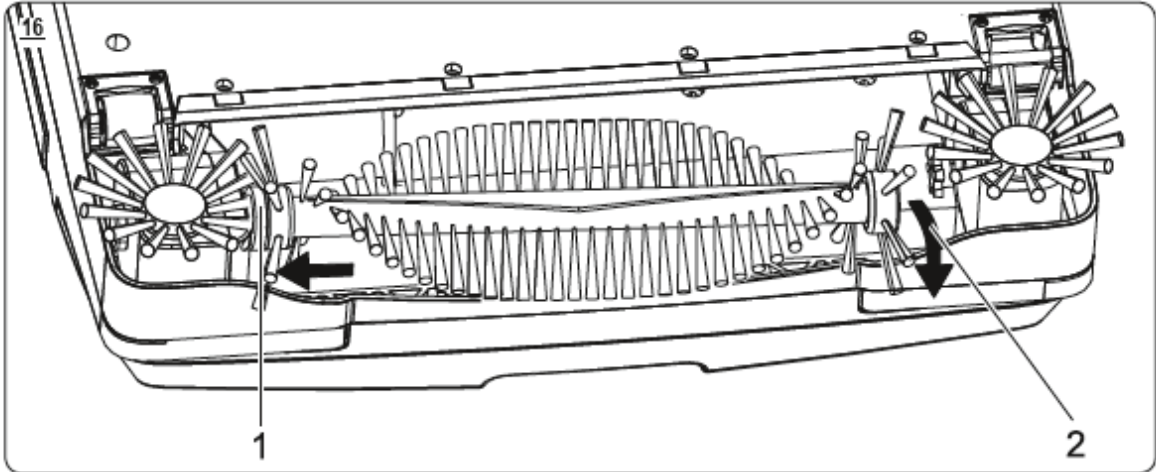

Technical Specifications:

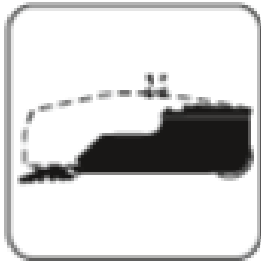

2 Liter



2,8 kg

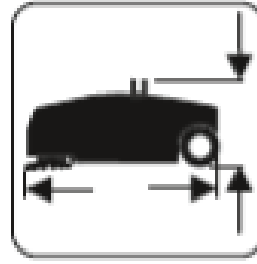

300 x 360
x 110 mm



63 dB (A)

Type:	Rechargeable Battery
Max. operating time when battery is fully charged	45 min
Battery	10.8 V / 1.5 Ah
Rated power	27 W
Mains voltage of the charger	100-240 V 50/60 HZ

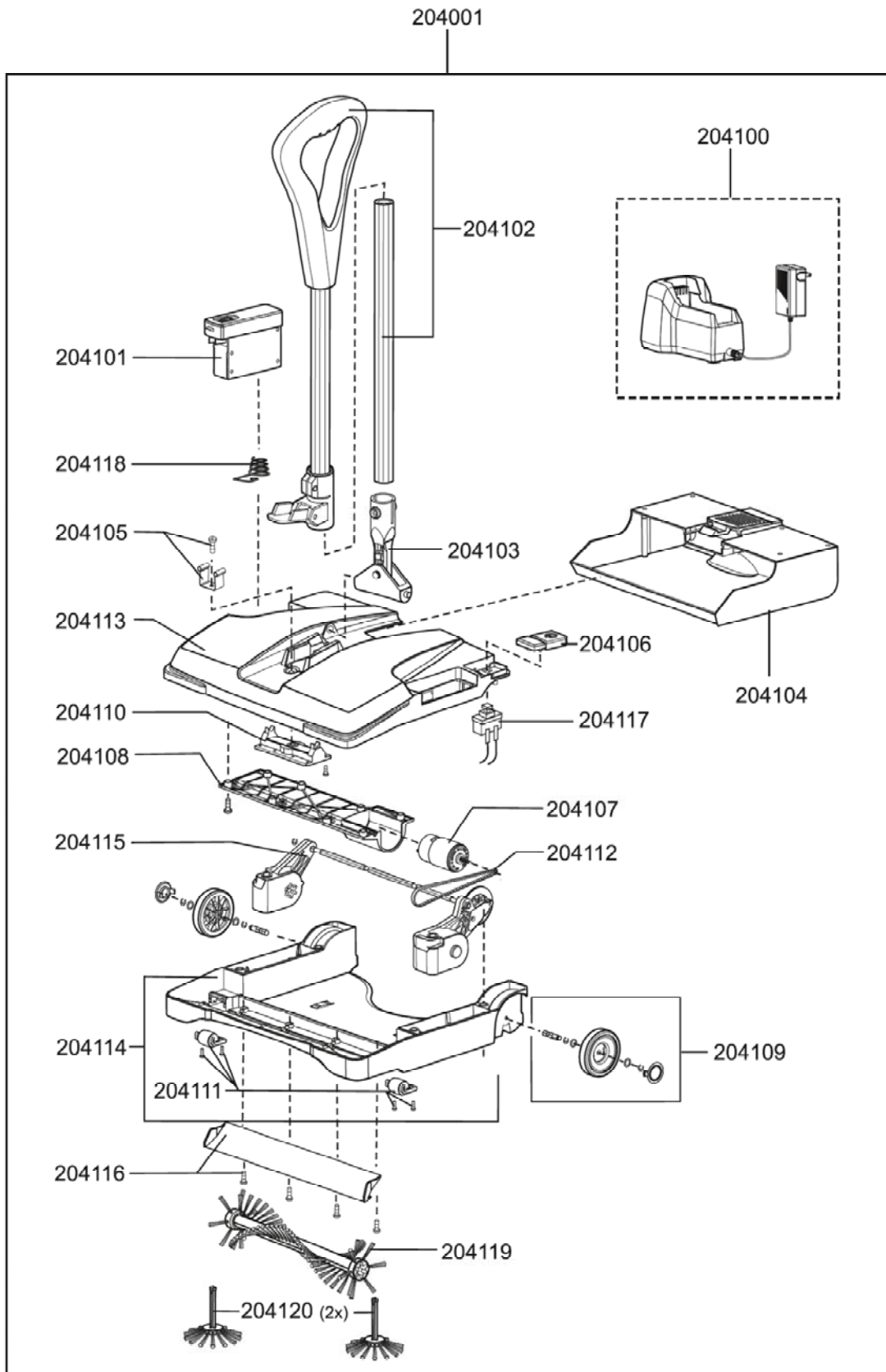



Cleanstar Pty Ltd

ABN: 51 121 002 104 ACN: 121 002 104

59 Radford Road, Reservoir VICTORIA 3073

Phone: (03) 9460 5655 Fax: (03) 9460 5666

Email: sales@cleanstar.com.au Web: www.cleanstar.com.au

CONDITIONS OF WARRANTY

This document outlines the terms and conditions of warranty for your Cleanstar product. This is an important document that should be kept with your proof of purchase documents in a safe place for future reference should you require service for your product.

Thank you for purchasing your new Cleanstar product. We are confident this product will give you trouble-free use and excellent service, provided the operator uses and maintains the product in accordance with the Instruction Manual. Please read the Instruction Manual carefully before using the product for correct operation and maintenance procedures, and store it in a safe place for future reference.

1. This is a parts and labour warranty against faulty or defective parts, materials or workmanship in manufacturing, when the product is used and operated in accordance with the Instruction Manual.
2. This product carries a 12 month (1 year) warranty period that commences from the original date of purchase by the first user/purchaser, and is not transferable.
3. This warranty only applies to products purchased and used in Australia.
4. At all times during the warranty period, Cleanstar shall, at its sole discretion, determine whether repair, replacement or refund will apply if the product has a valid warranty claim applicable to it.
5. The repair or replacement of the product under this warranty does not extend the original period of warranty.
6. Please note that this warranty will be voided in the following cases (which are not exhaustive) and the warranty does not apply to the cost of replacing any parts of the product resulting from:
 - Accidental damage;
 - Normal wear and tear;
 - Neglect, misuse or physical abuse by the operator, including failure to properly maintain or service;
 - Any alterations, modifications or tampering with the product without the prior written consent of Cleanstar;
 - Incomplete or improper installation;
 - Incorrect, improper or inappropriate operation;
 - Insect or vermin infestation;
 - Power surges, electrical storm damage or incorrect power supply/voltage;
 - Excessive use or use for which this product has not been designed;
 - Sweeping up water, liquids, toner, powders, glass, hazardous, flammable or corrosive materials, plaster dust, concrete dust and other similar building or construction materials;
 - Failure to comply with the operating instructions contained in the Manual supplied with the product;
 - If the product is rented;
 - If the product is used outside of Australia;
 - If the product was serviced or repaired by anyone other than Cleanstar, or one of Cleanstar's Authorised Service Agents (ASA). Cleanstar is unable to accept any responsibility under this warranty for any repair work not carried out by an ASA or from the use of non-genuine parts.
7. This warranty does not cover service calls, travelling time or consumable parts such as belts, dust bags, filters, hose or hose parts, rods and wands, floor tools and accessories, motor brushes and other like consumable items, unless defective in manufacture. In order to prolong the life of accessories and consumables, regular care and maintenance is recommended.

8. Please retain your original proof of purchase which will be required before you can make a claim under this warranty. If proof of purchase cannot be provided at the time of a warranty claim or service, any work carried out on the cleaner is chargeable.
9. Any transportation and delivery costs involved in the repair of defective parts shall be borne by the claimant. In all instances, unless the product is transported by Cleanstar or a Cleanstar authorised representative, the product is transported at the owner's cost and risk while in transit to and from Cleanstar or its ASA.

Our goods come with guarantees that cannot be excluded under the Australian Consumer Law. You are entitled to a replacement or refund for a major failure and for compensation for any other reasonably foreseeable loss or damage. You are also entitled to have the goods repaired or replaced if the goods fail to be of acceptable quality and the failure does not amount to a major failure. The benefits conferred by this warranty are in addition to other rights and remedies under law in respect of the product to which this warranty relates.

TO INQUIRE ABOUT MAKING A CLAIM UNDER THIS WARRANTY, PLEASE FOLLOW THESE STEPS:

- a) carefully check the Instruction Manual and the terms of this warranty;
- b) have the name and model number of the appliance available;
- c) have the proof of purchase available (ie. invoice, receipt, etc) showing where the appliance was purchased from and date of purchase;
- d) call Cleanstar on **(03) 9460 5655** to speak to one of our customer service staff.