

BION®



AIR PURIFIER
A100

INSTRUCTION Manual

CONTENT

Introduction	2
Product Diagram	3
3-In-1 Filter	4
Operation	5
Tuya Smart App	7
Cleaning	9
Maintenance	9
Troubleshooting	10
Specification	10

INTRODUCTION

BION Air Purifier A100



Filters at least 99.95% of particles as small as 0.1 micron¹ with H13 HEPA² + Activated Carbon filter.



Compatible with Tuya Smart, Smart Life, Google Home and Amazon Alexa.

¹ Particles with diameters that fall within the efficacy of the filter include: viruses, bacteria, tobacco smoke, insecticides, paint pigments, dust mites, moulds, pollen, dust, allergens, etc.

² Testing based on EN 1822-1:2019 (EN ISO 29463-3:2018) test standard.

Packing List

Description	Quantity
Air Purifier	1
Filter	1
Instruction Manual	1

Safety Measures

To reduce the risk of personal injuries or property damage, please ensure each user carefully reads the warnings before using the product.

- Do not apply any paint, insecticide, alcohol or chemical spray on the surface of the air purifier.
- If there is an accumulation of chemicals in the air purifier, it will be released when the air purifier is physically opened. Air the room if this happens.
- The air purifier should not be used in a flammable, explosive or corrosive gas environment.
- When the air purifier is running, do not insert any object into the air inlet or outlet to avoid injury or damage to the air purifier.
- Do not sit or place articles on the air purifier.
- Do not use the air purifier in the bathroom or places where there is water.

- Do not alter, take apart or repair the air purifier without authorization.
- The air purifier is not allowed to be placed on soft or uneven surfaces to prevent potential damages caused by vibration during usage.
- If the power cord or plug is damaged, do not use the air purifier. It may cause an electrical shock or fire.
- Do not touch the main unit, power cord or power plug with wet hands.
- When moving or maintaining the air purifier, please ensure that it is not operating, and the power plug is unplugged from the power socket.
- If there is an odor from the air purifier, switch it off and contact the manufacturer or authorized representative in your region.
- Small objects can easily enter the air inlet and outlet and affect the operation of air purifier. Do not allow children to put them into the air purifier.
- If the power cord is damaged, it must be replaced by the manufacturer or an authorized representative in your region.
- When unused for a prolonged period of time, unplug the power plug from the power socket and place the air purifier in a place away from the reach of children.
- Do not use a power supply other than what is specified.
- Do not arbitrarily process, bend, pull, twist, tie the power cord or position it close to hot objects.
- Do not apply heavy load on or pinch the power cord.
- When the power cord or power plug is broken, or when the power plug is loosened, do not use the air purifier.
- Do not expose the power plug to water.
- Please do not replace the power cord without authorization.

PRODUCT DIAGRAM

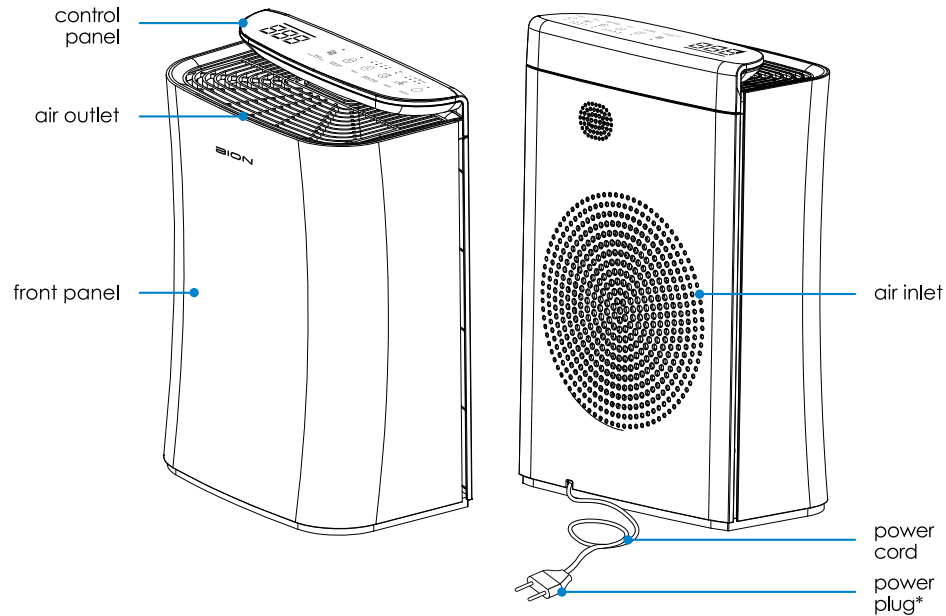

front

back

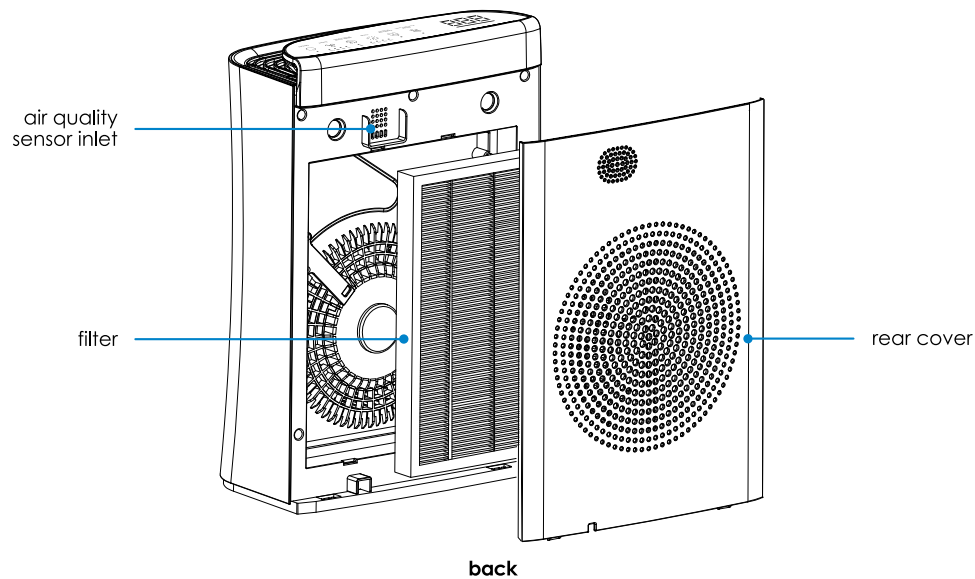

back

* May vary depending on country of purchase.

3-IN-1 FILTER

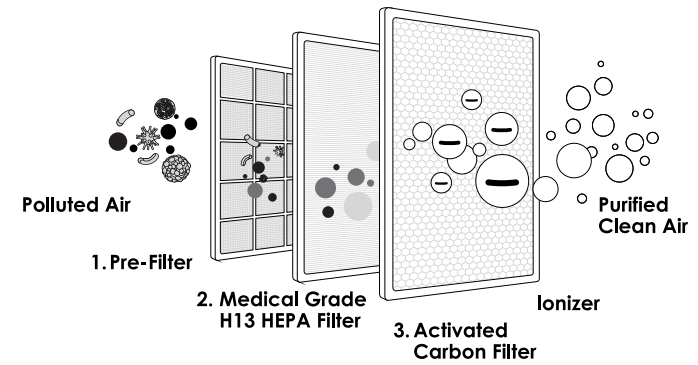

1. Pre-Filter

- Designed to capture the larger particles to avoid choking the air purifier and to increase the life span of the filter.
- Captures dust, hair, fibers, pet fur, lint, etc.

2. Medical Grade H13 HEPA Filter

- Filters at least 99.95% of particles as small as 0.1 micron¹ with H13 HEPA²

¹ Particles with diameters that fall within the efficacy of the filter include: viruses, bacteria, tobacco smoke, paint pigments, dust mites, moulds, pollen, dust, allergens, etc.

² Testing based on EN 1822-1:2019 (EN ISO 29463-3:2018) test standard.

3. Activated Carbon Filter

- Absorbs and neutralizes odor, smoke, fumes via the porous surfaces of the powdered activated carbon.
- Filters common household chemical, formaldehyde, volatile organic compounds (VOCs), etc.

Anion Purification

Airborne pollutants become charged when they come into contact with negative ions (anions) generated by the built-in Ionizer. These charged pollutants are removed from the air as they become attracted to surfaces.

Clean Air Delivery Rate

Clean Air Delivery Rate (CADR) measures how well your air purifier removes air pollutants in the room. BION Air Purifier A100 has a CADR value³ of 208m³/h. This means that 208 cubic metres of air is being filtered every hour.

³ Testing based on GB/T 18801-2015 test standard

Air Change Rate & Coverage Area

Air Change Rate (ACH) is the number of times the air in a room will be filtered by the air purifier within the duration of an hour. The general recommendation of ACH for effective purification of an enclosed space is at least 4 times.

Based on a CADR of 208m³/h and ACH of 4times/h, the recommended effective coverage area of BION Air Purifier A100 is up to 21m² (assuming a standard ceiling height of 2.5m).

PM2.5

PM2.5 are fine inhalable particulate matters, with diameters smaller than 2.5 micrometers. They include dust, dirt, soot, pollen, etc. The air purifier PM2.5 indicator is a measure of air quality that shows the concentration of PM2.5 particles in a given space. The higher PM2.5 reading, the worse the air quality. Please refer to local Environmental Agencies for recommended air quality guidelines.

OPERATION

Getting Started

1. Open the rear cover of the air purifier and remove the PE bag packaging from the new filter. Reinsert the filter and close the rear cover.

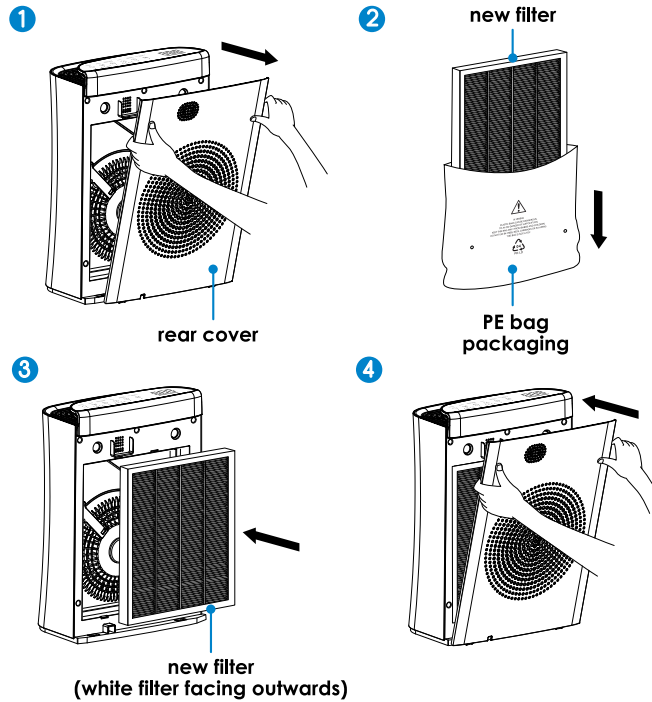

- ⚠ Please keep the PE bag away from children. ⚠ Use only original A100 filters to ensure proper functioning and performance of the air purifier.

2. Plug-in the power plug into a power socket.
3. Press the Power button.

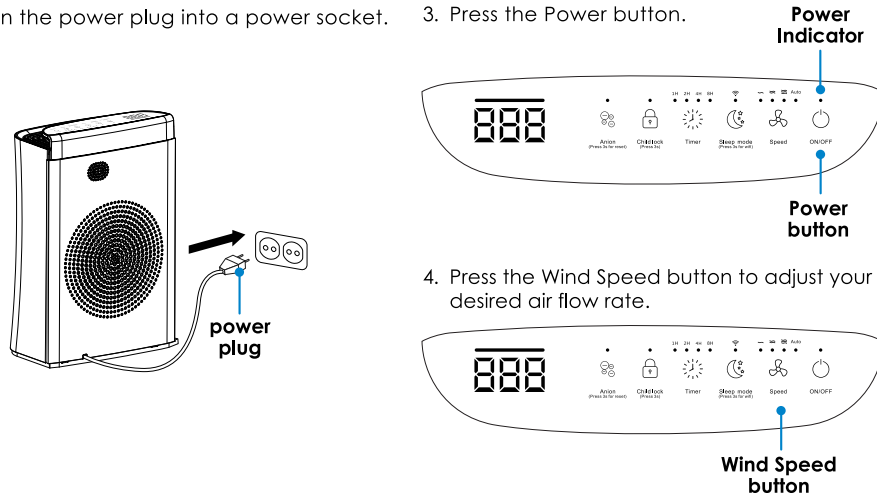

4. Press the Wind Speed button to adjust your desired air flow rate.

Operating the Air Purifier

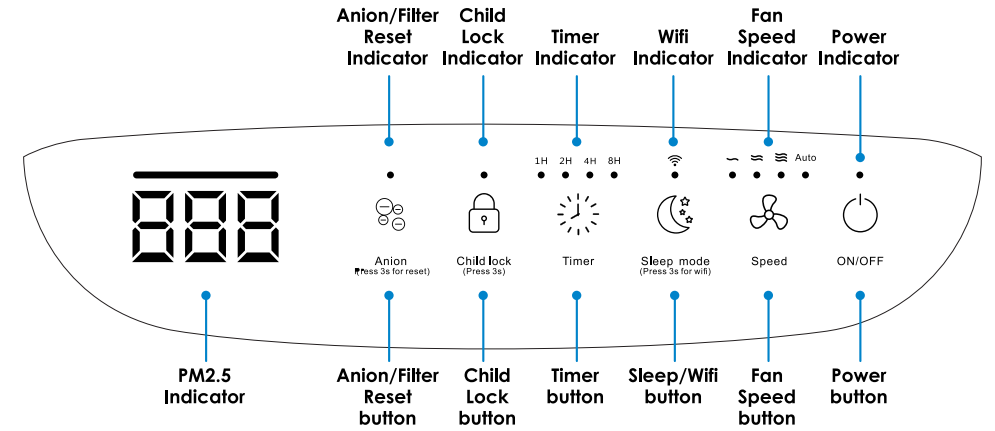

Power

Press the Power button to switch on the air purifier. It will take 60 seconds for the sensor to warm up before the PM2.5 reading will be shown. Press the Power button again to switch off the air purifier. Fan speed is set to Auto by default whenever the air purifier is switched on.

Fan Speed

Press the Fan Speed button to control the fan speed with the following options: Low, Medium, High and Auto mode.

Fan speed controls the rate at which air is being filtered. The higher the fan speed, the higher the CADR.

Auto mode will automatically select the most suitable wind speed according to the PM2.5 Reading Indicator.

Sleep/Wifi

Press the Sleep button to activate Sleep mode. Sleep mode will turn off all indicator lights, and change the fan speed to low. Press any button to exit Sleep mode.

Sleep mode indicator will light up briefly for 10s before turning off. If the Sleep button is held for 5s, the air purifier will enter WIFI pairing mode. Please refer to "Connecting the App" for more information about WIFI pairing.

Timer

Press the timer button to start a timer for the operation duration of the air purifier. Repeat pressing this button to cycle through the timer settings: 1 hour, 2 hours, 4 hours or 8 hours. Once the timer is up, the air purifier will turn off.

Child Lock

Press the Child Lock button for 3 seconds to activate Child Lock mode. Once it is activated, a "beep" sound will be played by the air purifier, and the Child Lock indicator will light up. In the Child Lock mode, all other buttons will be unclickable. To exit the Child Lock mode, hold the Child Lock button for 3 seconds. During Child Lock mode, pressing any button will result in child lock indicator blinking for 3s.

Anion/Reset

Press the Anion button to activate the Anion Purification (refer to page 4). Once activated, a "beep" sound will be played by the air purifier, and the Anion indicator will light up. Press again to deactivate the function. Anion Purification will not be switched on in Night mode or in Low fan speed, and only do so in Medium and High fan speed.

The filter has a recommended operating life span of 1500 hours. When it expires, the Anion indicator will function as a Reset indicator. "Beep" sound will be played 30 times and the Reset indicator will start flashing. The Reset indicator serves as a reminder to replace the filter and will not switch off until the indicator has been reset. Please note when the Reset indicator is lit, the Anion button will remain functional but will not affect the indicator. Once the filter has been replaced, reset the indicator by holding the Anion/Reset button for 3 seconds.

PM2.5 Sensor

The air purifier measures PM2.5 in real time and displays the reading in PM2.5 indicator. The PM2.5 colour indicator will change colour according to the PM2.5 reading.

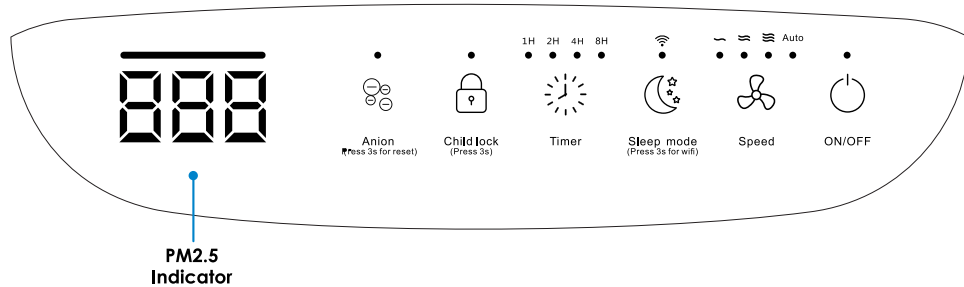

PM2.5 Indicator Colour	PM2.5 Range
Blue (Normal)	0 - 75 $\mu\text{g}/\text{m}^3$
Green (Elevated)	76 - 150 $\mu\text{g}/\text{m}^3$
Red (High)	151 - 999 $\mu\text{g}/\text{m}^3$

TUYA SMART APP

Connecting to the App

App Pairing

- 

Download and install "Tuya Smart" app on your smart phone.

Android iOS
- Login or register your account. Remember to tick "I Agree to Privacy Policy, User Agreement, and Children's Privacy Statement".
- Grant the app permissions whenever required.
- On the home screen, click "+" at the top right corner, followed by "Add Device".
- Read and scroll through pairing instructions.
- Switch on the phone's Wi-Fi and Bluetooth functions, if applicable.
- The app will start searching for nearby devices.

- Go to the BION Air Purifier A100 and hold the Sleep button for 3 seconds. The Wi-Fi indicator light will start flashing.

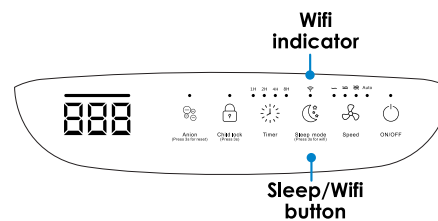

- In the app, select BION Air Purifier A100 by clicking "Add".
- Select BION Air Purifier A100 again by clicking "+".
- Input Wi-Fi SSID (if applicable) and password. Click "Next" and the device will start pairing.
- Once successful, click "Done".

Permissions

Home data (optional, for Apple users) – to connect all registered IoT devices to the Tuya account.

Notification (optional) – to receive device alarms and system notification messages.

Bluetooth (required) – to search and add and configure the network operation of Bluetooth devices.

Location (required) – to get your home's city location, automate scenes, search for nearby devices and display Wi-Fi names.

App Interface

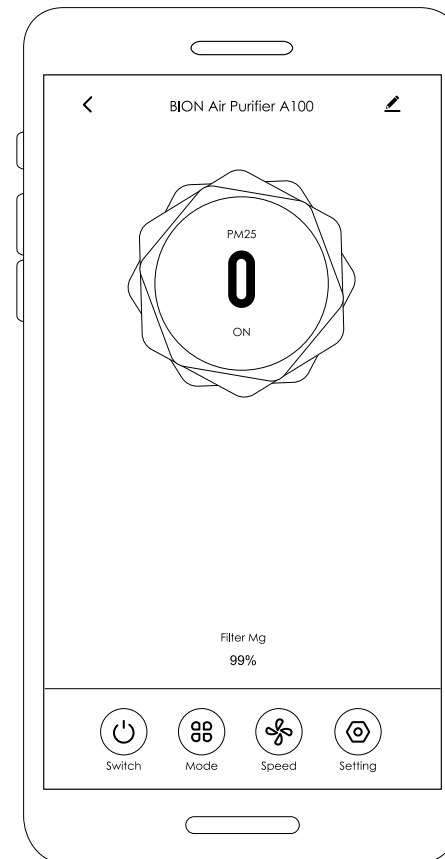

Using the App

Switch Button

Press the Power button to switch on the air purifier. It will take 60 seconds for the sensor to warm up before the PM2.5 reading will be shown. Press the Power button again to switch off the air purifier.

Mode Button

The air purifier has 3 modes of operation:

- Manual – wind speed can be manually adjusted.
- Auto – wind speed is automatically adjusted according to the air quality (PM2.5).
- Sleep – wind speed is adjusted to low and all indicator lights are switched off.

Speed Button

Controls windspeed with the following options: Auto, Low, Middle and High mode. Auto mode will select the most suitable wind speed, and automatically adjusts the wind speed according to the air quality (PM2.5).

Setting Button

Contains settings for the following functions:

- Child Lock – Once the Child Lock is activated, a prompt sound will be played by the air purifier, and the Child Lock indicator light will be switched on. In the Child Lock mode, all other buttons will be unclickable. Press again to deactivate the function.
- Anion/Reset Button – Press the button to activate the Anion function. Once activated, a prompt sound will be played by the air purifier, and the indicator light will be switched on. Press again to deactivate the function.
- Timer Button – Press this button to start a timer for the operation duration of the air purifier. Repeat pressing this button to cycle through the timer settings: 1 hour, 2 hours, 4 hours or 8 hours.

Linking with Google Home/Alexa

- Click on the pen icon at the top right corner of the app.
- Click on "Alexa" or "Google" and follow the instructions to setup the connection.

CLEANING

Turn off the air purifier and unplug the power plug from the power socket before commencing any cleaning work. Clean the exterior of the front panel and rear cover with a soft and dry cloth. Do not use alcohol, gasoline, benzene or any other chemical solvents to clean the air purifier.

Use a damp swab to clean the air inlet of the air quality sensor. Then remove any moisture with a dry swab. For optimal sensor performance, it is recommended that the air inlet is cleaned every 2 months.

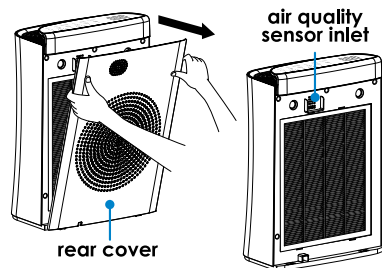

MAINTENANCE

Turn off the air purifier and unplug the power plug from the power socket before commencing any maintenance work.

Air Filter Replacement

1. The rear cover is attached to the main unit with a magnet. Open the rear cover by pulling the top of the cover in the direction away from the main unit.

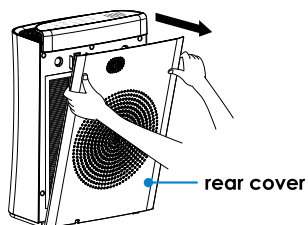

4. Insert the new filter into the main unit and reinstall the rear cover.

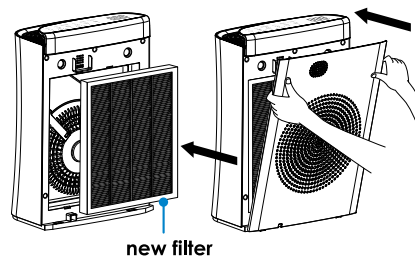

2. Remove the old filter from the main unit.

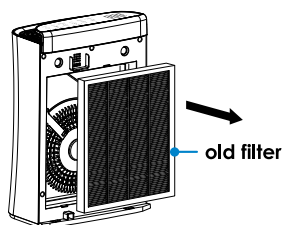

5. Plug the power plug into the power socket to start the air purifier.

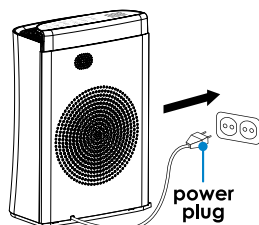

3. Remove the new filter from the PE bag packaging.

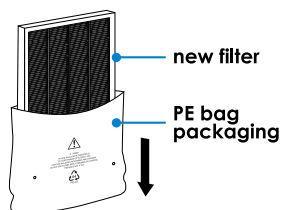

6. Hold the Anion/Reset button for 3 seconds to reset the filter counter. The filter indicator light will go off and the filter is successfully replaced.

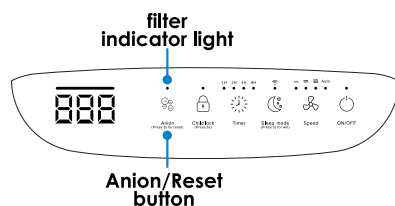

TROUBLESHOOTING

Problem	Cause	Solution
The air purifier does not power up	The power plug is not securely inserted into the power socket	Unplug the power plug and re-plug into the power socket
	Power plug or wire is damaged	Contact the manufacturer or an authorized representative
The fan does not power up	The machine is not turned on	Plug the power plug into the power socket and turn on the machine again
	Motor damaged	Contact the manufacturer or an authorized representative
	Foreign object caused the motor to jam	
	Machine control circuit damaged	
Poor purification performance	The air inlet or outlet is obstructed	The flow rate of A100 has been tested with 50cm of clearance from all directions. Ensure the device is placed at a location with minimal obstructions to maximize purification performance.
	Filter is overused (exceeded 1500 hours of usage)	Replace with a new filter
	Air inlet or outlet is choked	Check and clean the air inlet and outlet
	PE bag of the new filter is not removed	Remove the PE bag packaging from the new filter before inserting into the main unit
	The room is larger than what is recommended for this air purifier	Change the location of the air purifier that meets its usage recommendation

SPECIFICATION

Material of External Case	ABS
Size	284 x 173 x 439mm
Net Weight	3.4kg
Gross Weight	5.5kg
CADR	208m ³ /h
Recommended Coverage Area*	Up to 21m ²
Maximum Noise	53dB
Power Supply	AC 220-240V, 50Hz
Rated Power	20W
Service Temperature / Humidity	0 to 40°C / 20 to 90% No Dew
Storage Temperature / Humidity	-10 to 60°C / 20 to 90% No Dew
Wireless Connectivity	Wi-Fi IEEE 802.11 b/g/n 2.4GHz Bluetooth 4.2 Low Energy

* Based on 4 cycles of air changes per hour and 2.5m ceiling height.

Warranty Terms & Conditions

(www.bionmedicalgroup.com/warranty)

- Product is entitled to **1 year** off-site warranty coverage against manufacturing defects from the date of purchase, **with the original invoice/receipt as proof of purchase.**
- This warranty **does not** cover damages or defects arising from accident, misuse, mishandling, improper installation, any manner of tampering, usage of wrong electrical supply/voltage, corrosion/ fungus, rusting or stains, any unauthorized repair or modification to the product, act of god, fire, civil unrest and consequential damages.
- This warranty **does not** cover normal wear and tear, including, but not limited to, choking of air filter.
- This warranty shall be null and void in the event that the serial number on the product has been altered or removed.

Dealer Stamp:
(If applicable)

Date (DD/MM/YYYY):

Other Information

Product of:

BION ADVANCE PTE. LTD.

35 Pioneer Road North #02-03

Singapore 628475

Tel: +65 6250 0562

Email: info@bionmedicalgroup.com

Website: www.bionmedicalgroup.com

