

Installation Instructions:

TO MOUNT YOUR SPARK POWER SUPPLY, YOU'LL NEED:

- Spark power supply unit
- 1 of the 2 included mounting brackets
- 2 included mounting screws
- Included Hex wrench
- Any model Pedaltrain pedal board (not included)

1.



Place Spark under your Pedaltrain, in the power supply mounting channel.

2.



The thinner bracket is compatible with Nano+ and Metro Series models



The wider bracket is compatible with Classic series, Novo series, Terra 42, and vintage Pedaltrain models

Choose the bracket that best fits your Pedaltrain's rail spacing.

3.

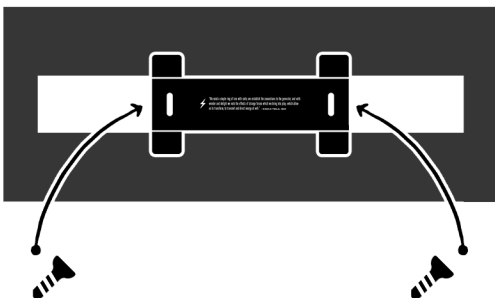

Place mounting screws through the holes in the bracket, into the threaded holes on the bottom side of Spark. Finger tighten.

4.

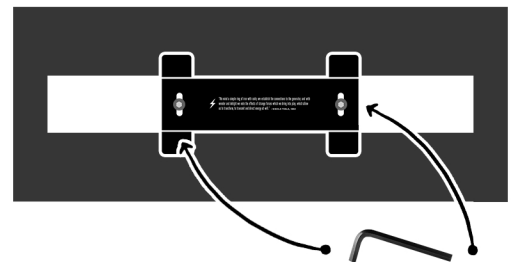

Use the hex wrench to tighten the mounting screws.

Attach your DC power cables and enjoy!

For more information and technical specifications visit pedaltrain.com/spark.