

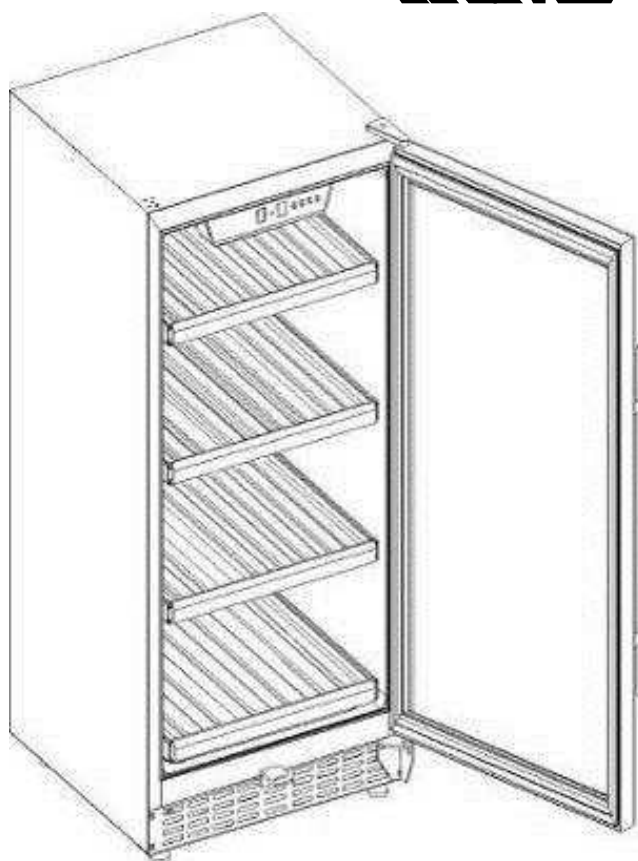

## **WINE COOLER**



### **Model**

E150WSCS1

E360WSCS1

E430WSCS1

EURO APPLIANCES BY EUROSTYLE GROUP

## Warning

**The information in this document is subject to modification without any prior notice.**

Euro Appliances offers no guarantee for our wine cooler if it is being used for any purpose other than that for which it was specially designed. Euro Appliances cannot be held responsible for any error in this manual. Euro Appliances is not responsible or liable for any spoilage or damage to wines or any other contents incidental or consequential to possible defects of the wine cooler. Warranty applies to the wine cooler only and not to the contents of the wine cooler.

This appliance is not intended for use by persons (including children) with reduced physical, sensory or mental capabilities, or lack of experience and knowledge, unless they have been given supervision or instruction concerning use of the appliance by a person responsible for their safety.

Children should be supervised to ensure they do not play with the appliance.

Allow 24 hours before switching on the wine cooler. During this time we recommend that you leave the door open to clear any residual odours.

**Before loading & plugging in the wine cooler, we recommend the location you should have selected for your wine cooler should:**

- Be unencumbered and well ventilated;
  - Be well away from any heat source and direct sunlight;
  - Not be too damp (laundry, pantry, bathroom, garage and basement etc.);
  - Have a flat floor and place on a dry level surface;
  - Have a standard and reliable electricity supply(standard socket to country standards, linked to the ground),it is not recommended to use a multi-socket or extension lead;
  - Have a surge protector fitted to the electrical outlet
  - Away from microwave. Certain microwave ovens do not have wave interference shield.
- When place within 1 meter vicinity of the wine cooler, they may affect the operation of the wine cooler.

The wine cooler should be placed where the ambient temperature is between 5 °C to 43 °C. If the ambient temperature is above or below this range, the performance of the unit may be affected. Placing your unit in extreme cold or hot conditions may cause interior temperatures to fluctuate; the idea range of temperature may not be reached. (See Climate Class at the end of this manual).

## **\*Grounding Instructions**

The wine cooler must be grounded in case of an electrical short circuit. Grounding reduces the risk of electrical shock. The wine cooler is equipped with a power cord having a grounding wire and plug. The wine cooler plug must be plugged into properly installed and grounded electrical outlet. In locations where there is frequent lightening, it is advisable to use surge protectors.

Improper use of the grounding plug can result in the risk of electric shock. Consult a qualified electrician or service person if the grounding instructions are not completely understood. If the supplied power cord is damaged, it must be replaced by a qualified person in order to avoid electrical hazard.

**\*Installing your wine cooler**

Unpack and remove all of the protection and adhesive strips from the packaging around and inside the wine cooler. **Important: Before connecting the unit to a power source, please let it stand upright for approximately 24 hours. This will reduce the possibility of a malfunction in the cooling system from handling during transportation.**

The wine cooler must be positioned that the plug is accessible. Release the power cord and move your wine cooler to its finally location. The wine cooler should be installed in a suitable place where the compressor will not be subject to physical contact.

Note: For freestanding installation, it requires 30mm gap between both sides for the wine cooler as well as the rear, which allows the proper air circulation to cool the compressor and condenser. Even for built-in installation, it requires 10mm space on each side and at the top. The air vent at the front must never to covered or blocked in any way.

**\*Leveling your wine cooler**

Wine cooler must be leveled before loading your wines. Your wine cooler is equipped with 4 adjustable feet to facilitate easy leveling. Euro Appliances recommends that you tighten the back feet to the maximum and adjust the front feet to create a level.

**\*Products & Specifications**

1) E150WSCS1

Type	Dual Temperature Zone
Item Number	E150WSCS 1
Bottle Capacity	44-46 Bottles
Dimension (W*D*H)	595*600*875mm
Weight	51KG
Refrigerant	R600a/30g
Cooling System	Compressor Cooling
Ambient Temp	60-90 °F
Temperature Range	Upper: 5-12 °C/ Lower: 12-22 °C
Rated Voltage	220 -240V
Rated Frequency	50HZ
Input Power	80W

2) E360WSCS1

Type	Dual Temperature Zone
Item Number	E360WSCS1
Bottle Capacity	128-142 Bottles
Dimension (W*D*H)	595*680*1615mm
Weight	91KG
Refrigerant	R600a/50g
Cooling System	Compressor Cooling
Ambient Temp	60-90 °F
Temperature Range	Upper: 5-12 °C/ Lower: 12-22 °C
Rated Voltage	220-240V
Rated Frequency	50HZ
Input Power	130W

3) E430WSCS1

Type	Dual Temperature Zone
Item Number	E430WSCS1
Bottle Capacity	157-165 Bottles
Dimension (W*D*H)	595*680*1795mm
Weight	105KG
Refrigerant	R600a/52g
Cooling System	Compressor Cooling
Ambient Temp	60-90 °F
Temperature Range	Upper: 5-12 °C/ Lower: 12-22 °C
Rated Voltage	220-240V
Rated Frequency	50HZ
Input Power	150W

### **\*Operating your wine cooler**

1) Turning on your wine cooler. Plug in and switch on the wine cooler by pressing on the power button for a few seconds. When you use the wine cooler for the first time (or restart the wine cooler after having it power off for a long time), there will be a few degrees variance between the temperature you have selected and the one indicated on the LED readout. This is normal and it is due to the length of the activation time. Once the wine cooler is running for a few hours everything will stabilize.

**Important: If the unit is unplugged, power is lost or turned off, wait 3 or 5 minutes before restarting the unit. The wine cooler might not start if you attempt to restart before this time delay.**

2) Operating noises. To reach the desired temperature settings, Euro wine coolers, like all wine coolers operating with compressors and fans, may produce the following types of noises. These noises are normal and occur as follows:

- Gurgling sound, caused by the refrigerant flowing through the appliance's coils;
- Cracking/popping sounds, resulting from the contraction and expansion of the refrigerant gas to produce cold;
- Fan operating sound, to circulate the air within the wine cooler.

3) Loading your wine cooler. You might load your wine bottles in single or double rows while taking note of the followings: If you do not have enough bottles to fill your wine cooler, it is better to distribute the load throughout the wine cooler as 6 bottle arrangement so as to avoid "all on top" or "all below" type loads.

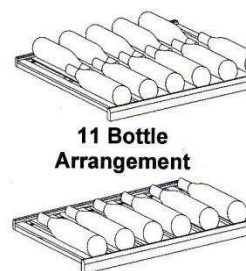

**11 Bottle  
Arrangement**

**6 Bottle Arrangement**

-Do remove or relocate wooden shelves in the model E150WSCS to accommodate large type of bottles or increase the capacity of the cabinet by stacking the bottles up when necessary.

- Keep small gaps between the wall and the bottles to allow air circulation.
- Do not over load your wine cooler to facilitate air circulation.
- Do not stack more than 1.5 rows of standard 750ML bottles per shelves to facilitate air circulation
- Avoid obstructing the internal fan (located inside on the back panel of the wine cooler)
- Do not try to slide the shelves outwards beyond the fixed position to prevent the bottles from falling.
- Do not pull out more than one loaded shelf at a time as this may cause the wine cooler to tilt forward.
- Do not cover the wooden shelves with alloy foil or other materials, as it will obstruct air circulation
- Do not move your wine cooler while it is loaded with wines. The might distort the main cabinet.

### **\*Temperature Setting**

Notes: depending on the loading and settings chosen, it takes 24hours for the wine cooler to see the temperature stabilizing. During this time LED seems to move erratically in particular dual-zone wine coolers. It is normal process. This process occurs whenever the setting is modified and/or whenever a

large amount of bottles are added to the wine cooler.

**Important: The LCD displays by default the actual internal air temperature. It's important to understand that there is a difference between the air temperature inside the wine cooler and the actual temperature of the wine" You will need to wait approximately 12 hours before noticing the effects of temperature adjustment due to the critical mass within a full wine cooler. Once the thermostat is set it is strongly advised not to toy with it or adjust frequently. The thermostat will maintain the temperature inside the wine cooler within a  $\pm 2.5^{\circ}\text{C}$  range, the actual temperature of the wine will only fluctuate  $0.5^{\circ}\text{C}$  to  $1^{\circ}\text{C}$ .**

1) Factory preset Temperature Chart:

The upper compartment:  $5^{\circ}\text{C}$

The lower compartment:  $12^{\circ}\text{C}$

2) Control panel of wine cooler:



#### © Display Windows

- **RUN** light: Indicator light of compressor working. While the compressor operating, the red light is on. While it stops operating, the red light is off.
- **UPPER CHAMBER**: Display of the actual temperature of the upper chamber. The range is  $0^{\circ}\text{C}\sim 37^{\circ}\text{C}$  or  $32^{\circ}\text{F}\sim 99^{\circ}\text{F}$ .
- **LOWER CHAMBER**: Display of the actual temperature of the lower chamber; The range is  $0^{\circ}\text{C}\sim 37^{\circ}\text{C}$  or  $32^{\circ}\text{F}\sim 99^{\circ}\text{F}$ .
- **$^{\circ}\text{C}/^{\circ}\text{F}$  light**: When the  $^{\circ}\text{C}$  light is on, it indicates Celsius temperature; When the  $^{\circ}\text{F}$  light is on, it indicates Fahrenheit temperature.

#### © Button Operation

- **SET Button of the upper chamber**: Temperature setting button; Once you press the button, the temperature increase  $1^{\circ}\text{C}$  or  $1^{\circ}\text{F}$ . Setting range is between  $5^{\circ}\text{C}\sim 12^{\circ}\text{C}$  or  $41^{\circ}\text{F}\sim 54^{\circ}\text{F}$ .
- **SET Button of the lower chamber**: Temperature setting button; Once you press the button, the temperature increase  $1^{\circ}\text{C}$  or  $1^{\circ}\text{F}$ . Setting range is between  $12^{\circ}\text{C}\sim 22^{\circ}\text{C}$  or  $54^{\circ}\text{F}\sim 72^{\circ}\text{F}$ .
- **LIGHT Button**: Cabinet light control button; Note: Once the light is turned on, it will automatically off after 10 minutes all out of protecting the wines inside.
- **$^{\circ}\text{C}/^{\circ}\text{F}$  Button**: Celsius and Fahrenheit conversion button;
- **ON/OFF button**: Power on and off button; Press the button, it starts; press it again, it stops.

**Note: This series of wine coolers has its delay protection function. The compressor will start to work about 3 to 5 minutes after it is power connected or powered off. Please use the wine cooler under the N type of climate. The temperature inside the cabinet will fluctuate and influence the refrigerating effect if the surrounding temperature is too high or too cold.**

**\*Wine Serving Temperature Chart**

All wines mature at the same temperature, which is a constant temperature set between 12°C to 14°C. The below chart is an indicative temperature chart to indicate the best temperature for drinking purposes

Types of Wines	Temperature
Champagne , Sparkling, Spumante	6 °C
Dry White Semillon, Sauvignon Blanc	8 °C
Dry White Chardonnay, Dry White Gewurztraminer, Riesling, Champagne Vintage,, Pinot Grigio, Sweet White Sauternes, Montbazillac, Ice Wine, Late Harvest	10 °C
Beaujolais	13 °C
Sweet White Vintage Sauternes, White Vintage Chardonnay	14°C
Red Pinot Noir, Red Grenache, Syrah	16 °C
Red Vintage Pinot Noir, Shiraz, Cabernet, Merlot, Sauvignon Cabernet.	18 °C

Note: Euro wine cooler has been designed to guarantee optimum conditions for storing and/or serving your wines. Fine wines require long and gentle developments and need specific conditions in which to reach their full potential. Not all wines will improve over the years. Some should be consumed at an early stage (2 to 3 years) while others have tremendous ageing capability (50 and over). All wines have a peak in maturity. Do check with your wine merchant to get the relevant information.

**\*Sliding Shelves: To prevent damaging the door gasket, make sure to have the door opened all the way when pulling the shelves.**

-For easy access to the bottles, you must pull the shelves approximately 1/3 of its depth out of the rail compartment. The wooden shelves are designed with stopper to hook against each sides of the shelf track to prevent bottles from falling.

-When removing a shelf from the rail compartment in E150WSCS, make sure to remove all items first, then move the shelf to the stop position and lift over to take the shelf out.

**\*Defrosting/Hygrometry/Condensation/Ventilation**

Your wine cooler is designed with auto defrost system. During its running, wine cooler has one time

defrosting process every 8 hours and it will last about 30 minutes. The defrost water from the wine cooler storage compartment drains automatically and part of it goes into a drainage container, which is located at the back of the wine cooler next to the compressor. The heat is transferred from the compressor and evaporates any condensation that has collected in the pan. Part of the remaining water is collected within the wine cooler for humidity purposes. All Euro wine coolers are equipped with a double glazed glass door to minimize condensation on the glass door. The unit is not totally sealed, fresh air admission is permitted through the drainpipe. Air is circulated through the wine cooler by means of a fan /fans and the hollow shelves.

Notes: The water collected by condensation, is therefore recycled. Under extremely dry environmental conditions, you may have to add some water into the water container provided with your wine cooler. During the refrigerating cycle, heat is given off and disperses through the external surfaces of the wine cooler. Avoid touching the surfaces during those cycles.

### **\*Reversing the Door Swing of Wine Cooler**

The unit is delivered to you with the door opening from the left side (hinge on right side). The door of this appliance is capable of opening from either the left or right side . To reverse the door swing of your cooler and open from the right side, please follow the instructions and diagram as follows.

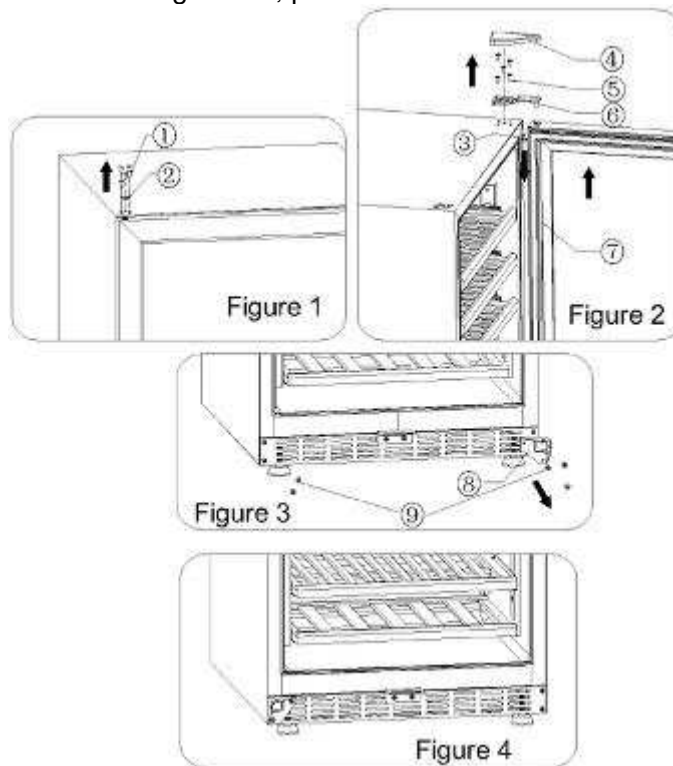



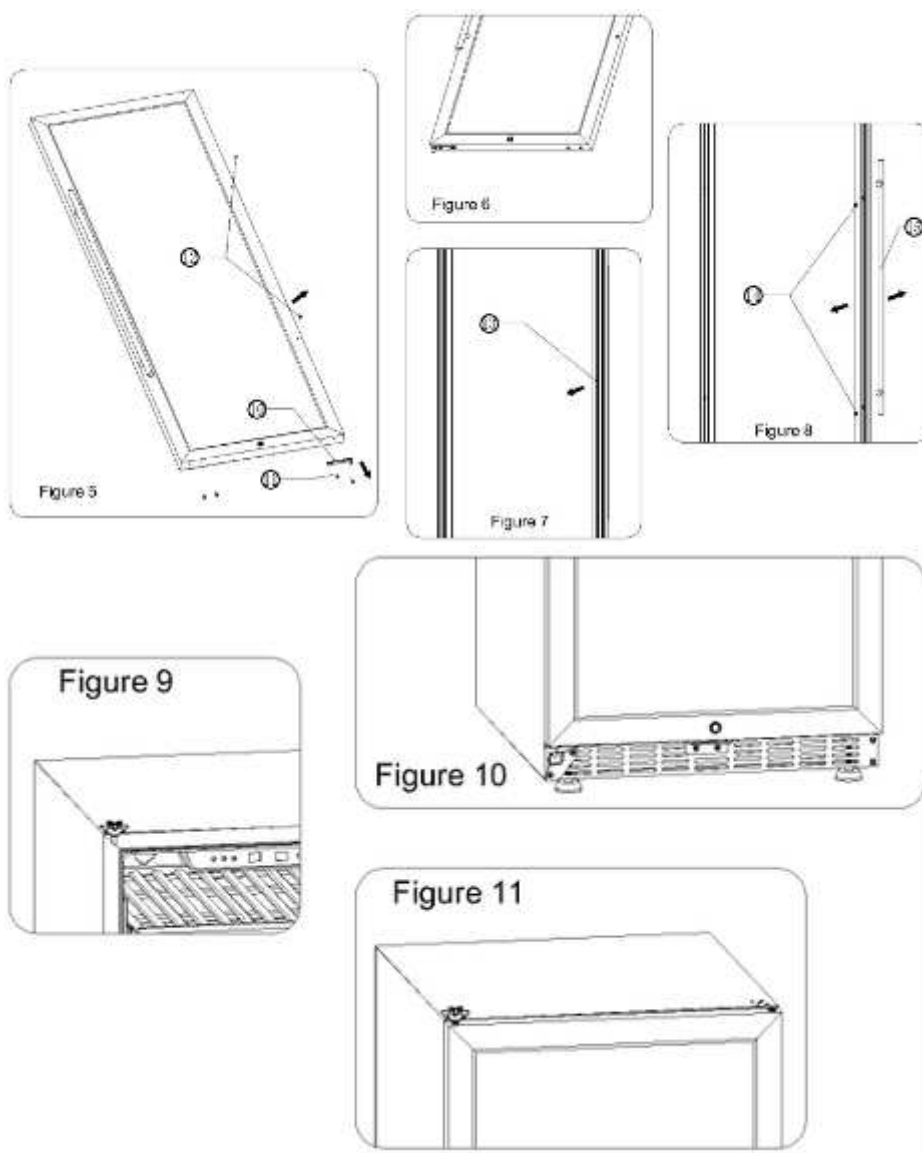

**NOTE:** All parts removed must be saved to allow the door swing to be reversed

1. Use the sharp tools to pry open the decoration nail on the top of the cabinet and the cap of door spindle carefully. (Fig 1)
2. Open the door to an angle, unscrew the screw of the door hinges cover, remove the cover of the upper door hinge; then unscrew all the screws on the upper door hinge. Be careful to hold the glass door firmly after removing the screw and take off the door. (Fig 2)
3. Remove the screw of lower door hinge and the left side screw of the front vent (Fig 3); and then install the lower door hinge at the designated position on the opposite side (Fig 4).
4. Remove the screw of door handle, then remove the bottom screw of left side of the door and remove the lower supporter of the door. (Fig 5); Install the lower support of the door to the opposite side. (Fig 6).
5. Pull open middle section of the door gasket, then it will come out the handle screw hole. (Fig 7); remove the handle and install it on the opposite side. (Fig 8)
6. Install the upper door hinge to the opposite side and tighten the screws. (Fig 9)
7. Set glass door shaft to aim the shaft of lower door hinge (Fig 10); and then aim the upper door hinge (Fig 11); adjust the door and the cabinet is aligned and leveled, then tighten all the lock screws. You also can call customer service for reversal instructions if it is necessary.

### **\* Installing Stainless Steel Handle**

This wine cooler includes a stainless steel handle that is required to operate this unit. To install the handle please follow the below instruction:

Pull away the door gasket in the area where the handle is to be installed – you can see two designated holes for handle installation. The gasket is easily displaced by hand, no tools are necessary.

Install the handle tightly as shown below with the two screws. Lock washers and flat washers provided. (DO NOT over tighten as this will cause damage to the handle assembly and stainless steel surface of glass door).

Replace the door gasket to its original position.

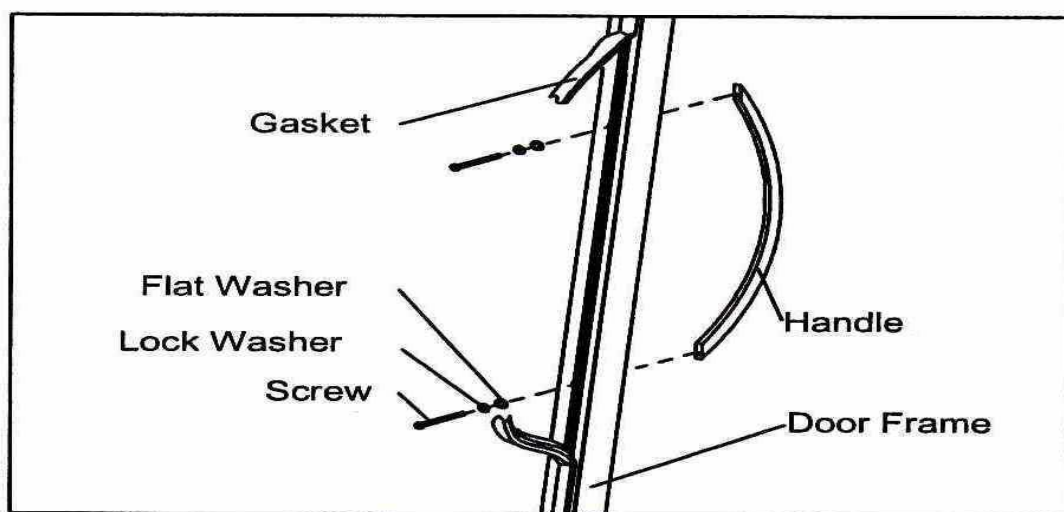

### **\*Power Failures and Operation Anomalies**

In the event of a power interruption, all previous temperature settings are automatically erased and it will revert to a preset temperature setting. Most power failures are corrected within a short period of time. An hour or two's loss of power will not affect your wine cooler's temperatures. To avoid sudden change of temperature while the power is off, you should avoid opening the door. For longer period of power failure, do take steps to protect your wine.

**Note: Irrespective of the cause, if you notice either abnormal temperature or humidity levels inside your wine cooler, be reassured that only long and frequent exposure to these abnormal conditions can cause a detrimental effect on your wines.**

Ensure that there is power to the electrical supply plug by connecting another electrical appliance to it. Check Fuse, if any. Make sure that the door is closed properly.

If your wine cooler appears to be malfunctioning, unplug it and contact EURO after sales service on 1800 440 335. Any intervention on the cold circuit should be performed by a refrigeration technician who should carry out an inspection of the circuit sealing system. Similarly, any intervention on the electrical circuit should be performed by a qualified electrician.

**Noted: Any Intervention performed by a non-technician will lead to the warranty being considered as null and void.**

**\*Troubleshooting Guide**

PROBLEM	POSSIBLE CAUSE
Wine Cooler does not operate.	Not plugged in. The appliance is turned off. The circuit breaker tripped or a blown fuse.
Wine Cooler is not cold enough.	Check the temperature control setting. External environment may require a higher setting. The door is opened too often. The door is not closed completely. The door gasket does not seal properly.
Turn on and off frequently.	The room temperature is hotter than normal. A large amount of contents has been added to the Wine Cooler. The door is opened too often. The door is not closed completely. The temperature control is not set correctly. The door gasket does not seal properly.
The light does not work.	Not plugged in. The circuit breaker tripped or a blown fuse. The bulb has burned out. The light button is “OFF” .
Vibrations.	Check to assure that the Wine Cooler is on level.
The Wine Cooler seems to make too much noise.	The rattling noise may come from the flow of the refrigerator, which is normal. As each cycle ends, you may hear gurgling sounds caused by the flow of refrigerator in your Wine Cooler. Contraction and expansion of the inside walls may cause popping and crackling noises. The Wine Cooler is not on level.
The door will not close properly.	The Wine Cooler is not on level. The door was reversed and not properly installed. The gasket is dirty. The shelves are out of position.

Notes: The replacement of LED light must need the qualified technician. First to unscrew the 2 screws on the light cover, then take out the screw on the LED panel, and replace LED light of same specification.

Eurostyle Group trading as Euro Appliances  
No. 6 Pattinson Road, Newton SA 5073  
Service Line: 1800 440 335  
Fax: (08) 8462 9127  
Email: [service@eurostylegroup.com.au](mailto:service@eurostylegroup.com.au)