



INSTALLATION INSTRUCTIONS

POLARIS
RAZER 900 XP

SAFETY INSTRUCTIONS

Warning: Failure to heed all safety and operating instructions and warnings regarding use of this product can result in serious bodily injury.

READ PROPERLY COMPLETE ASSEMBLY INSTRUCTIONS BEFORE STARTING OF ASSEMBLY

Install all parts indicated in assembly instructions. Failure to fully assemble product before use could result in personal injury.

Assembly of product requires use of hand or power tools. If you are not experienced in using these types of tools, have product dealer do the install for you.

Some parts contain sharp edges, wear protective gloves if necessary.

Always keep your assembly area clean, uncluttered and well lit.

Keep visitors and children a safe distance away from the assembly area. Visitors should wear the same safety equipment described under.

Never operate your UTV with the cab doors open. Failure to properly latch the doors before moving the vehicle could result in serious injury.

Dress for safety. DO NOT wear loose clothing, gloves, neckties or jewelry if using power tools to assemble this product.

Insert all nut covers after you finish installation.

Never drive your UTV with the cab front window in open position. Failure of improperly latched/locked front window before driving the vehicle could result in serious injury.

Please be careful to not break the plastic washers, if you are tightening screws with plastic washers use maximal power 3,7 foot-pound force (5 Nm)!!!

WARNING: For safety purposes, if the DFK Cab doors are removed, it is mandatory that the OEM manufactured Half Doors or Nets are **REINSTALLED** before operating the vehicle.

MAINTANCE AND CLEANING

To clean polycarbonate surface use soapy water solution or other subtle means.

Dirt and dust wash by gently water stream and swipe only with wet or damp means in the direction from top to bottom.

The recommended frequency of cleaning of polycarbonate part is about 1 time per month or according to the actual degree of pollution.

*Do not use detergents that could scratch the surface plates.
(abrasives, harsh fabrics, etc.)*

*Do not use solvents or alkaline detergents or cleaners with ammonia
(ammonium hydroxide).*

Do not remove the impurities from the surface of the razor blades or other sharp items.

Do not clean cabine, when the polycarbonate plates are heated by the sun.

Do not use the squeegee, it could be scratched surface plates.

Do not clean the water current strength greater than 50 bar (WAP)

The manufacturer is not responsible for scratching the surface in case of failure to comply with the above instructions.

All bolted connections of cab must be by user at regular intervals checked and tightened.

Please by carefull to not broken the plastic washers, if you tightening screws with plastic washers use maximal power 3,7 foot-pound force (5 Nm)!!!

PREPARATION FOR INSTALLATION:

Uninstall all additional systems from the roller cages (work lights, rear mirrors, drink holders etc.)

CAB PREVIEW

4

Uninstall the original side ledge (red line) from the UTV rollercage on both sides.



5

ELECTROINSTALLATION 1.
HEATER

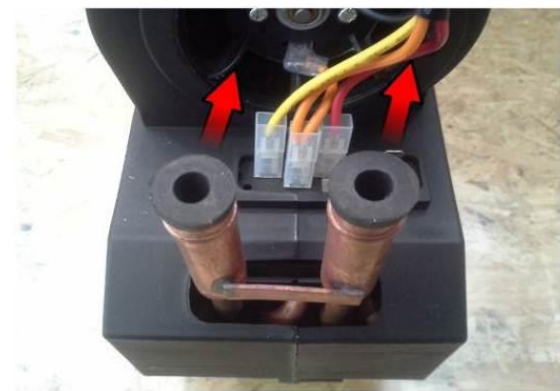
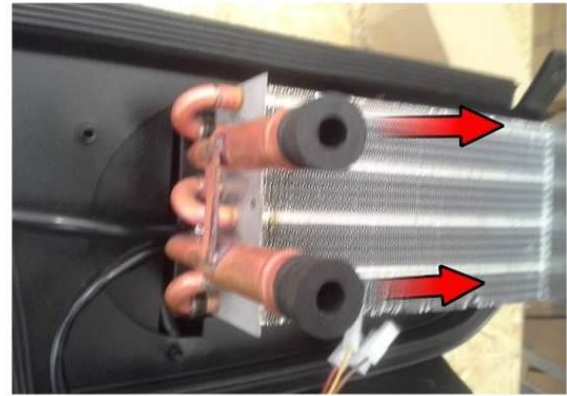

TAKE OUT THE RUBBER PLUGS FROM HEATER TUBES.

Uninstall seats, middle tunnel and bottom dashboard cover from the UTV.



Install the heater with the holder under the front dashboard onto the best position and fix by included washers and nuts.

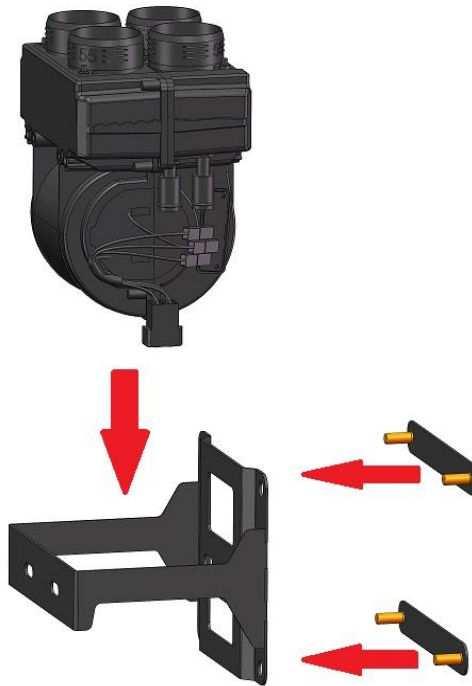

Install 2 air hoses PVC onto the heater air tubes and fix by included aluminium tape. Next 2 (free) heater air tubes need to be blinded.

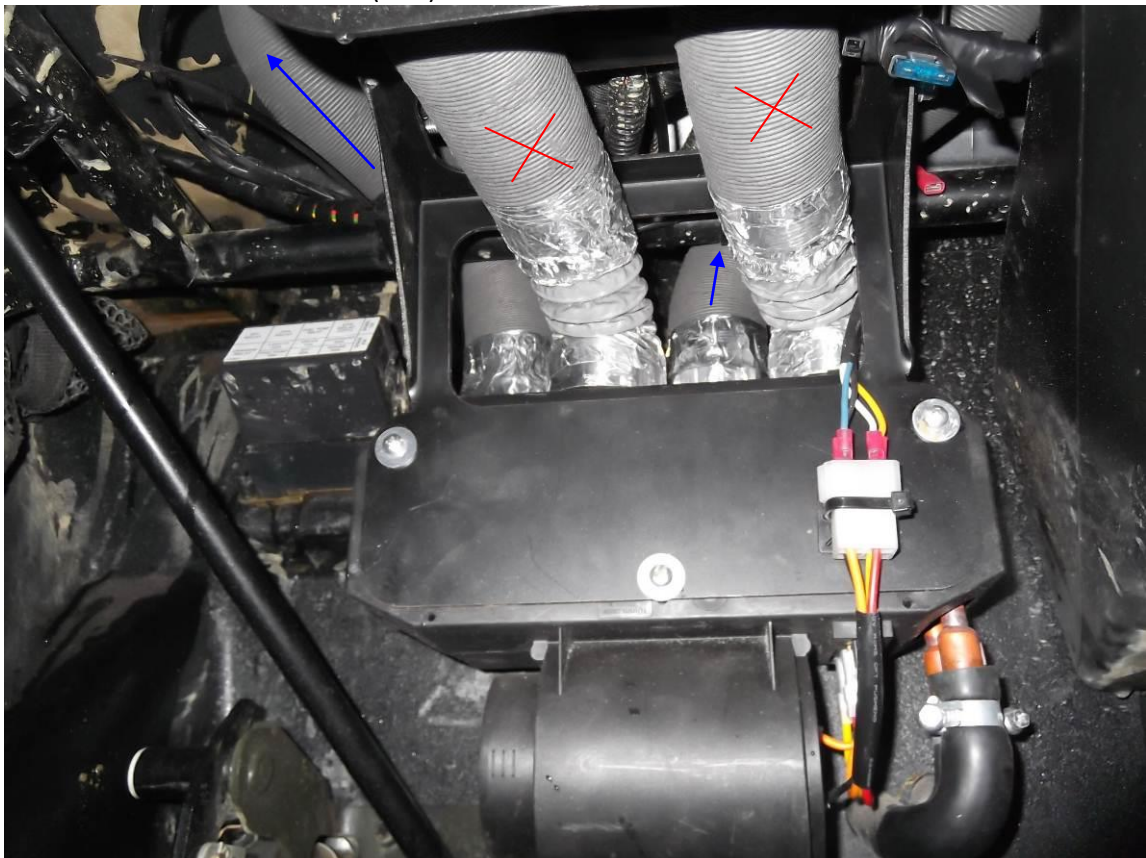

Connect the harness branch with the heater connector.

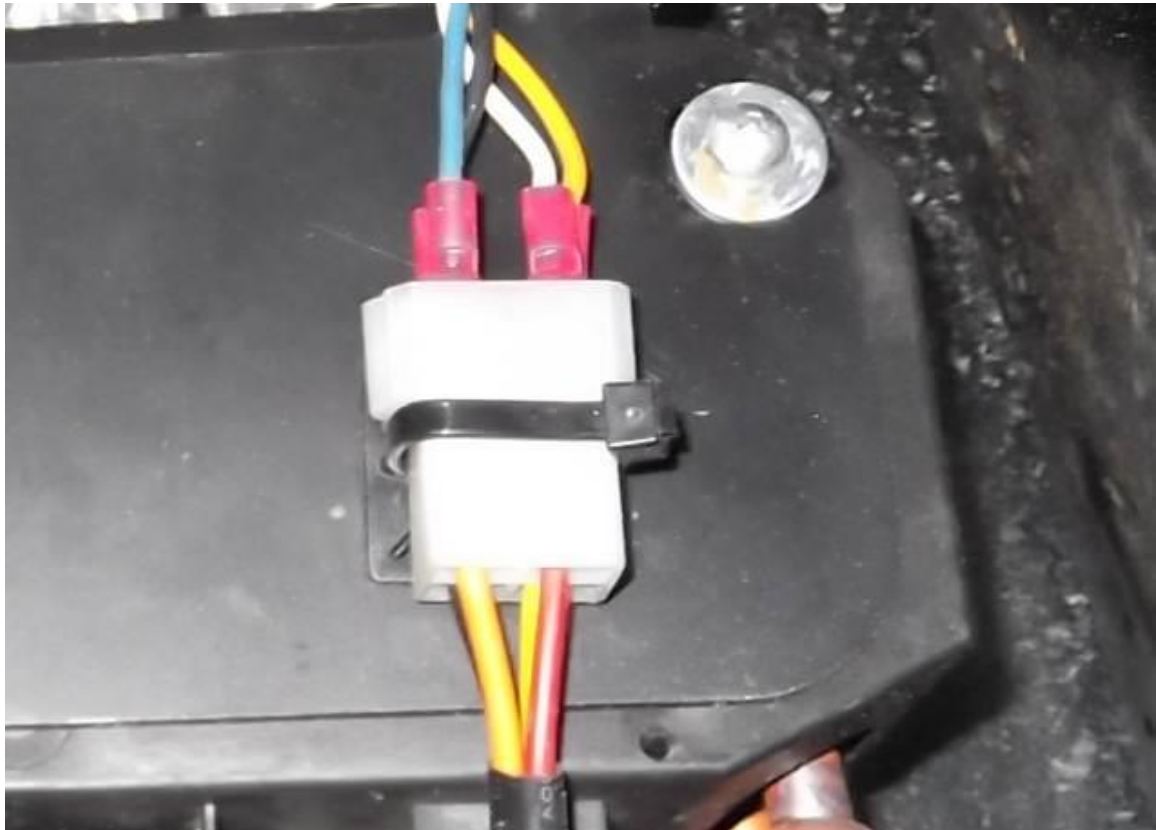

Drill 1 hole \varnothing 11,5-14mm (0,45-0,55 in) and 2 holes \varnothing 2,5-4 mm (0,1- 0,16 in) into the dashboard in accordance with the heater switch base (red circle). Drill the hole \varnothing 25 mm into the dashboard for the el.valve. Place the selfglued stick onto the dashboard (green circle).



10

Connect the heater switch body with the harness branch. (Detail view)

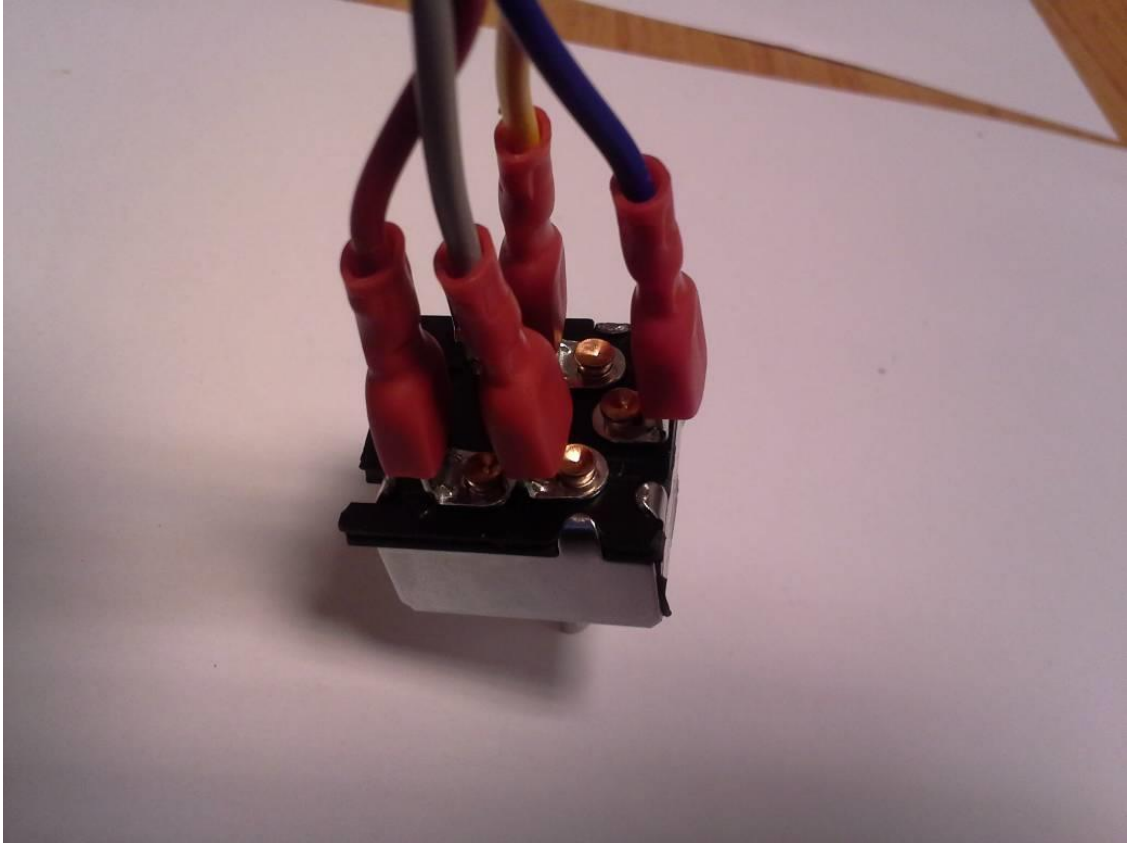

Connect the harness branch with the el. valve switch. (Detail view)
Press the el. valve switch into the hole.

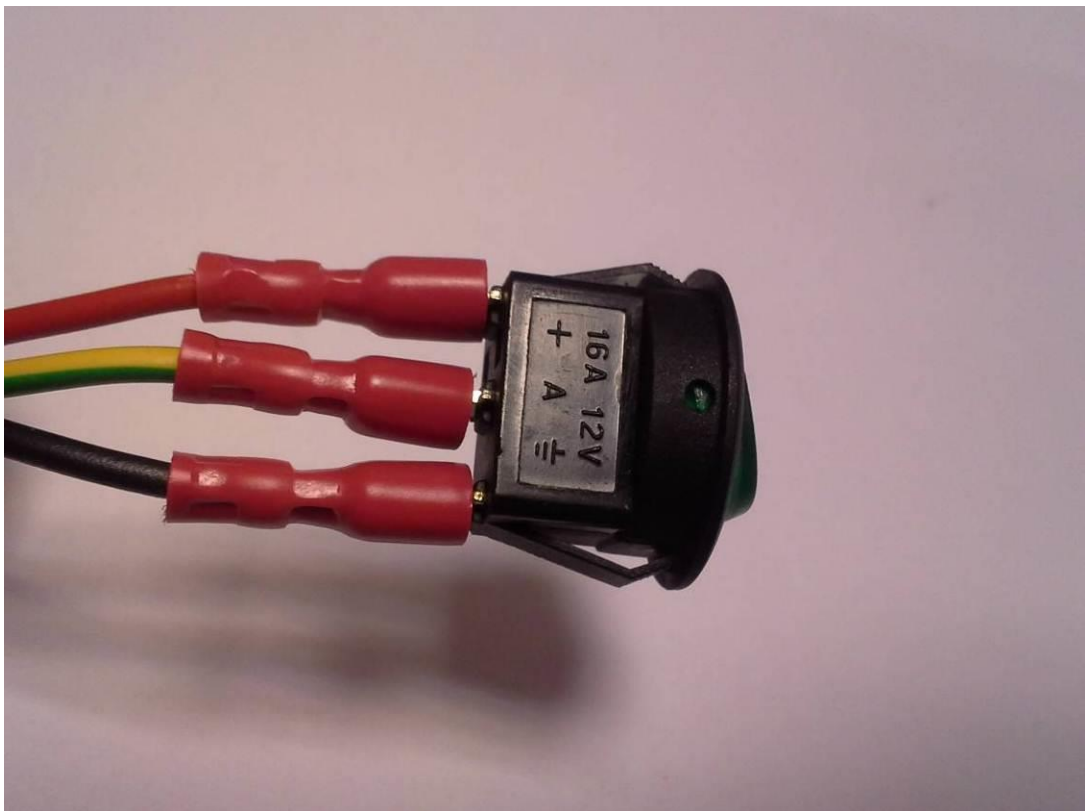

Carefully cut holes $\varnothing 50\text{mm}$ into the upper dashboard cover for air vents (red circle). Lead the air hoses PVC through and install the air vents onto the hoses and press the air vents into the holes.



Drill 2 holes $\varnothing 25\text{mm}$ into the inner front wall (red circle). Connect the bended hoses with the heater and fix by included tightening straps. Lead bended hoses through the holes.



Install the el. valve onto the bended hose.



13

Connect the el. valve harness branch to el. valve (detailed view).

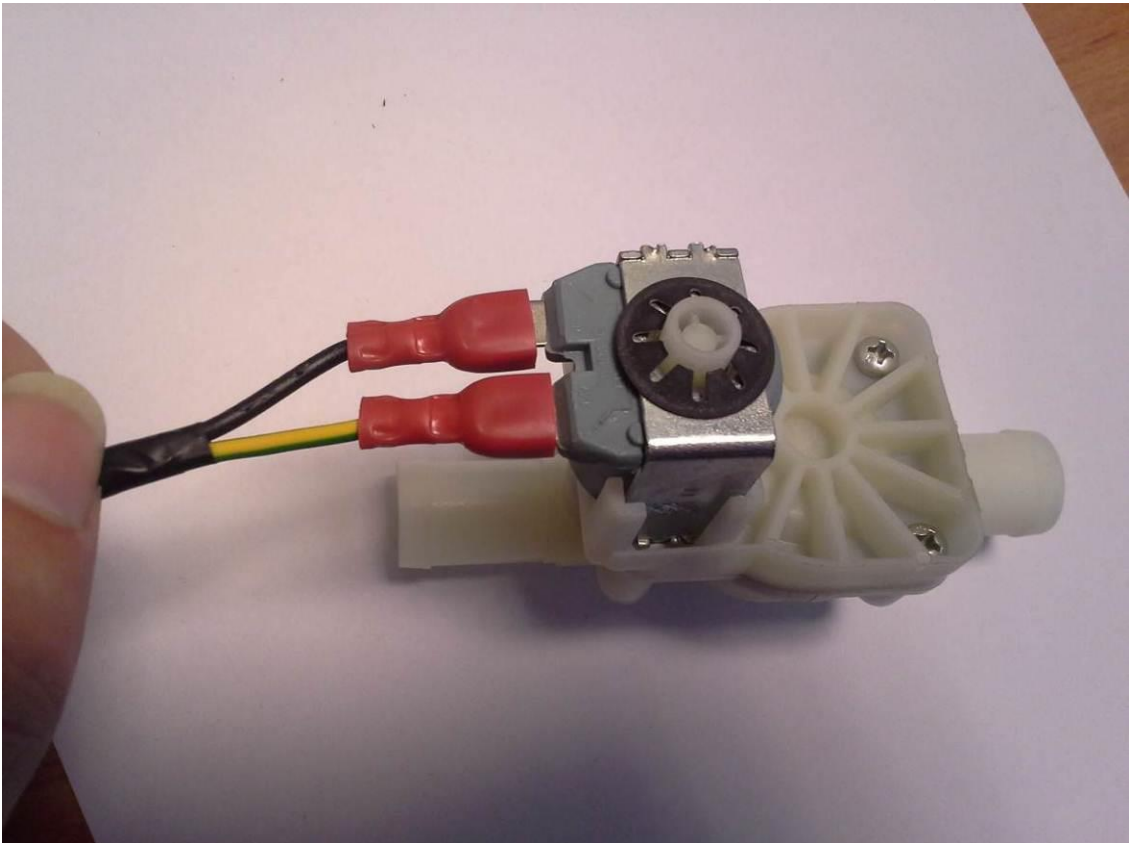

Install "Y" couplings onto the original cooling system hoses and fix by included tightening straps. Connect the heater hoses with the couplings and fix by tightening straps.

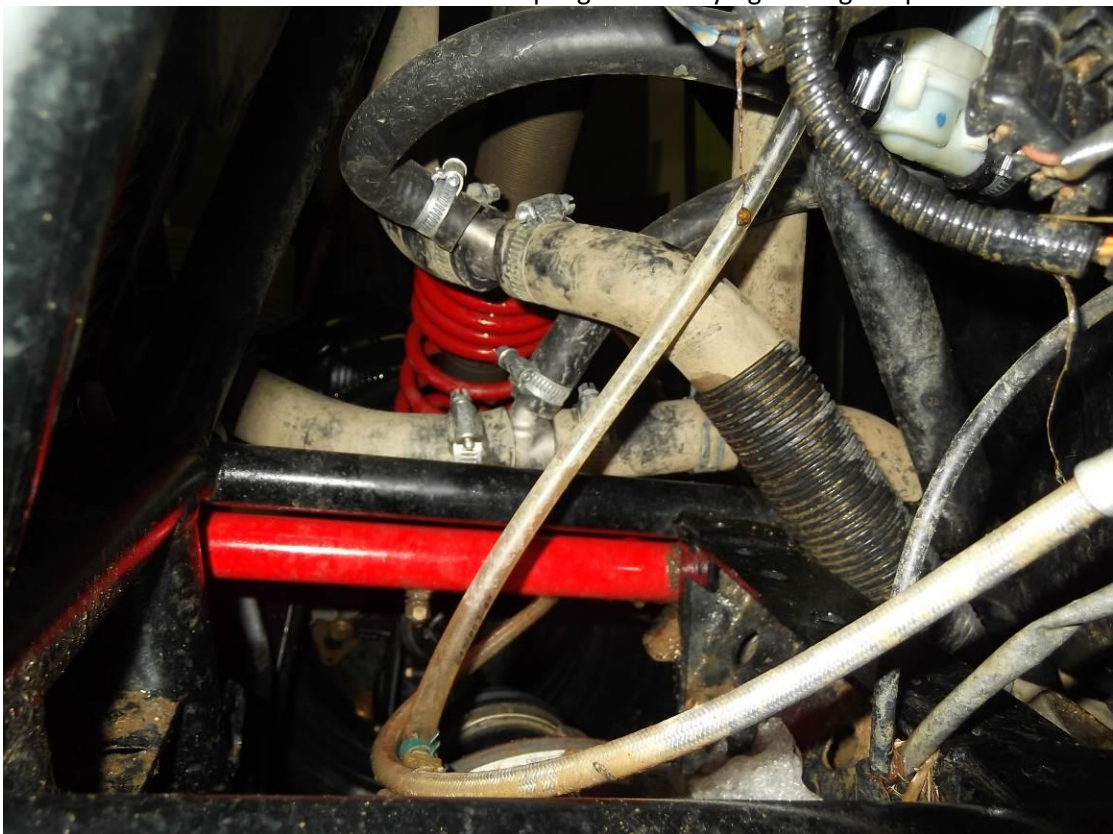

Connect the heater harness branch with the original electroinstalation.



15

REAR PANEL 1.

Place the rear bottom ledge onto the UTV rollercage.



16

Fix the rear bottom panel with the UTV rollercage by included holder, screws, washers, nuts and covers on both sides.

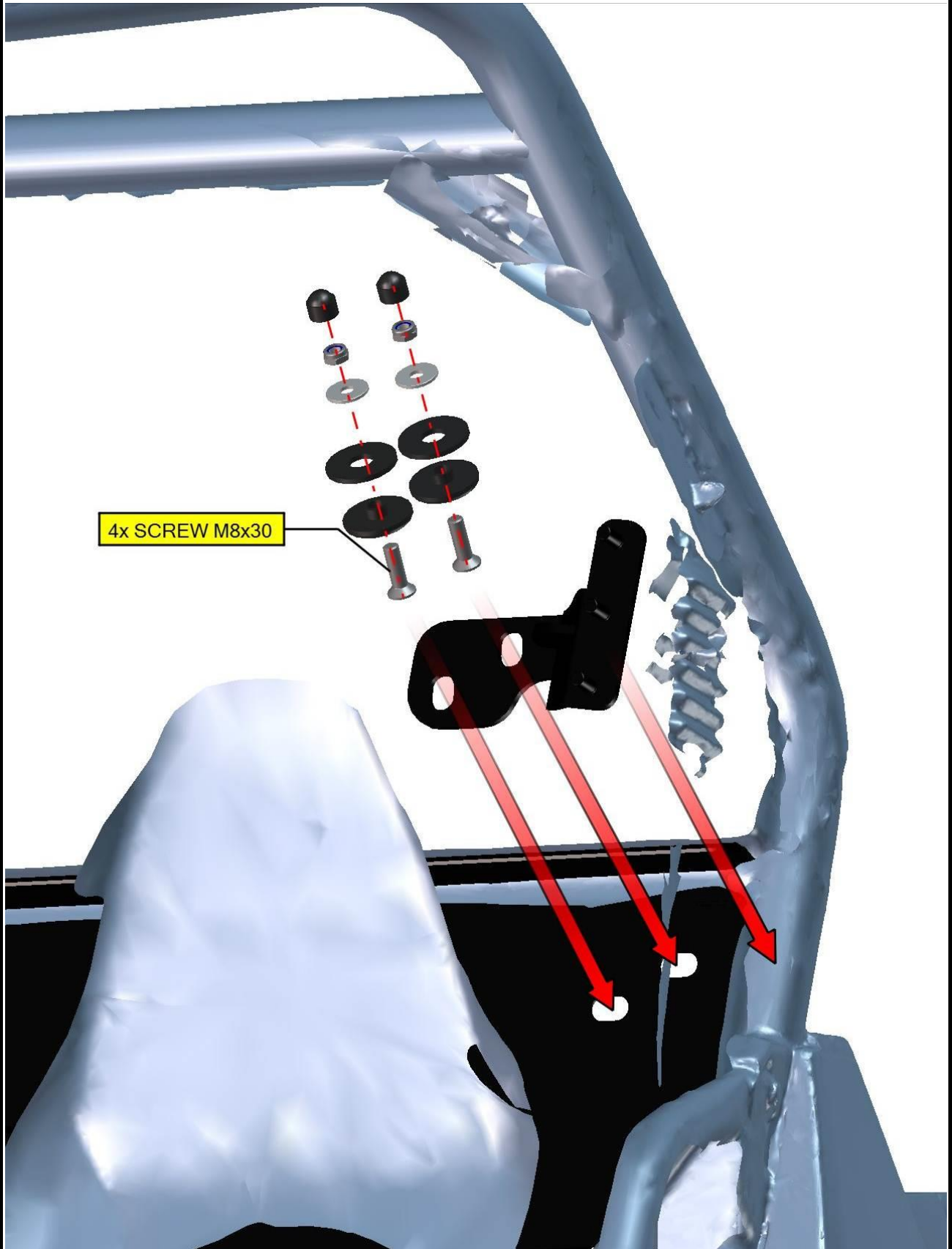

LEFT DOOR + RIGHT DOOR 1.

Place the left door base onto the UTV rollercage and fix by included screws, washers, nuts and covers.

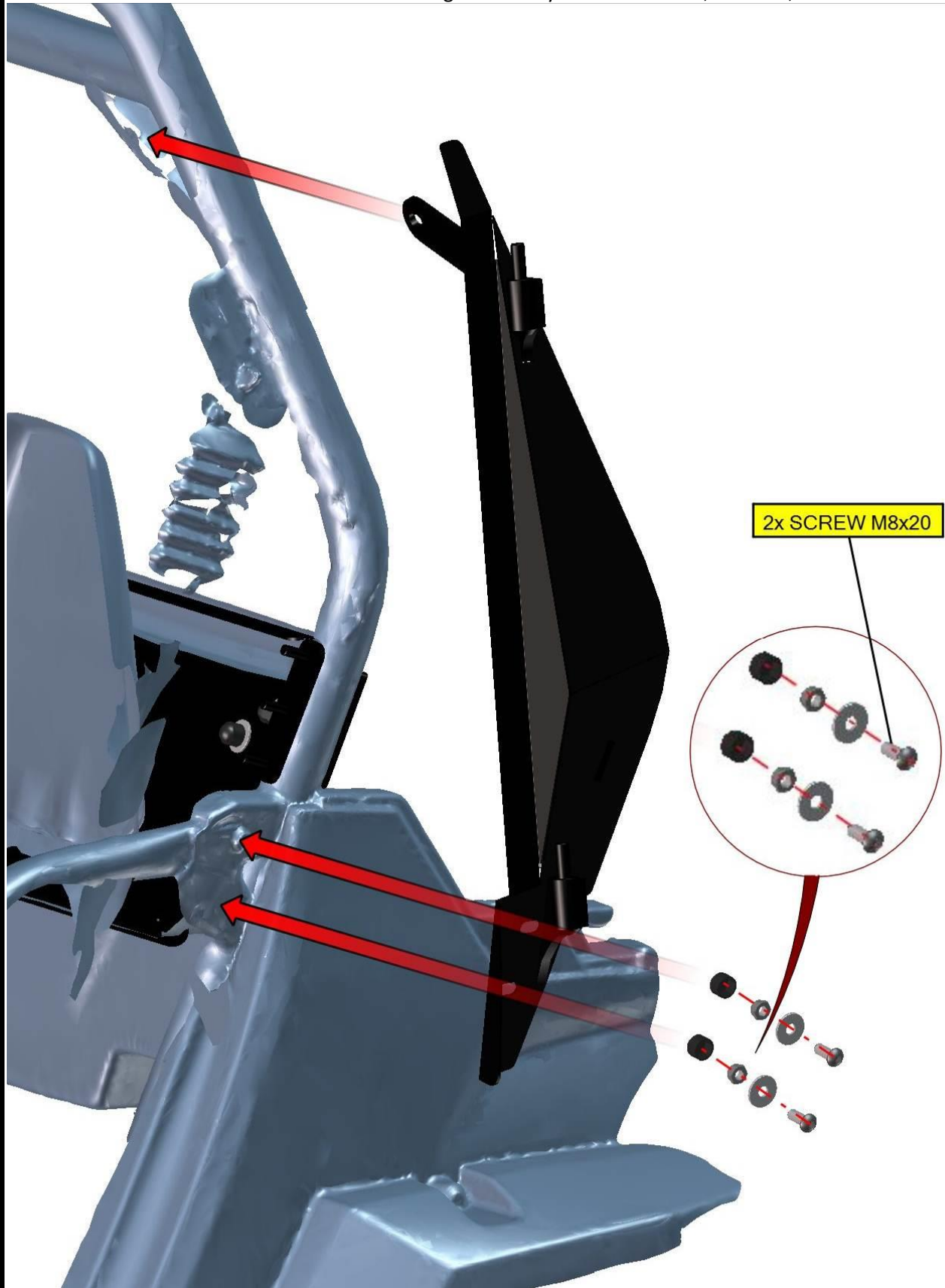

Fix the left door base with the rear panel holder by included nuts, washers and covers.

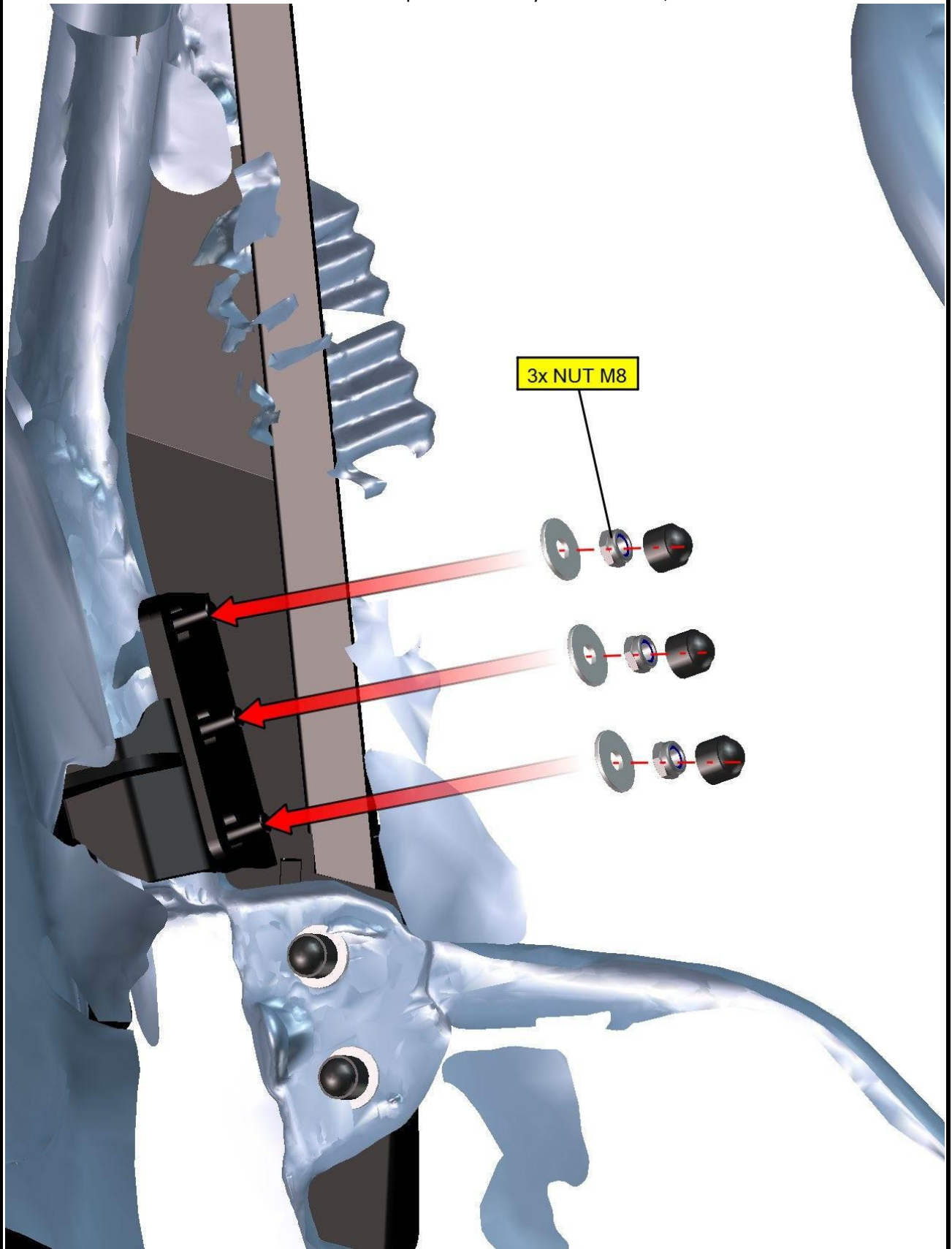

3x NUT M8

REPEAT PREVIOUS STEPS WITH THE RIGHT DOOR BASE.

REAR PANEL 2.

Place the rear upper ledge onto the UTV rollercage and install included screws and washers.

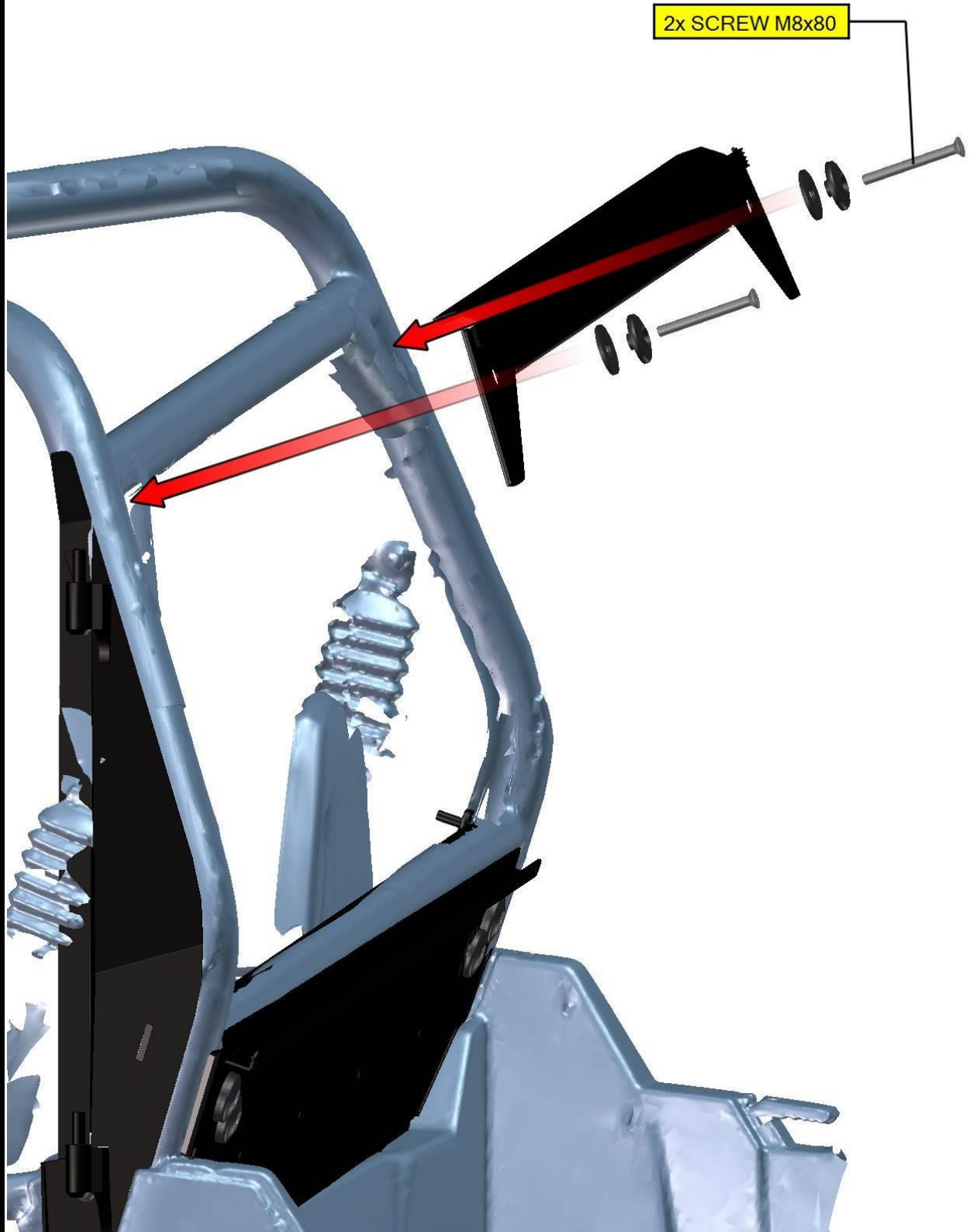

Install the rear upper ledge holder onto the rear upper ledge screws and fix by included nuts, washers and covers.

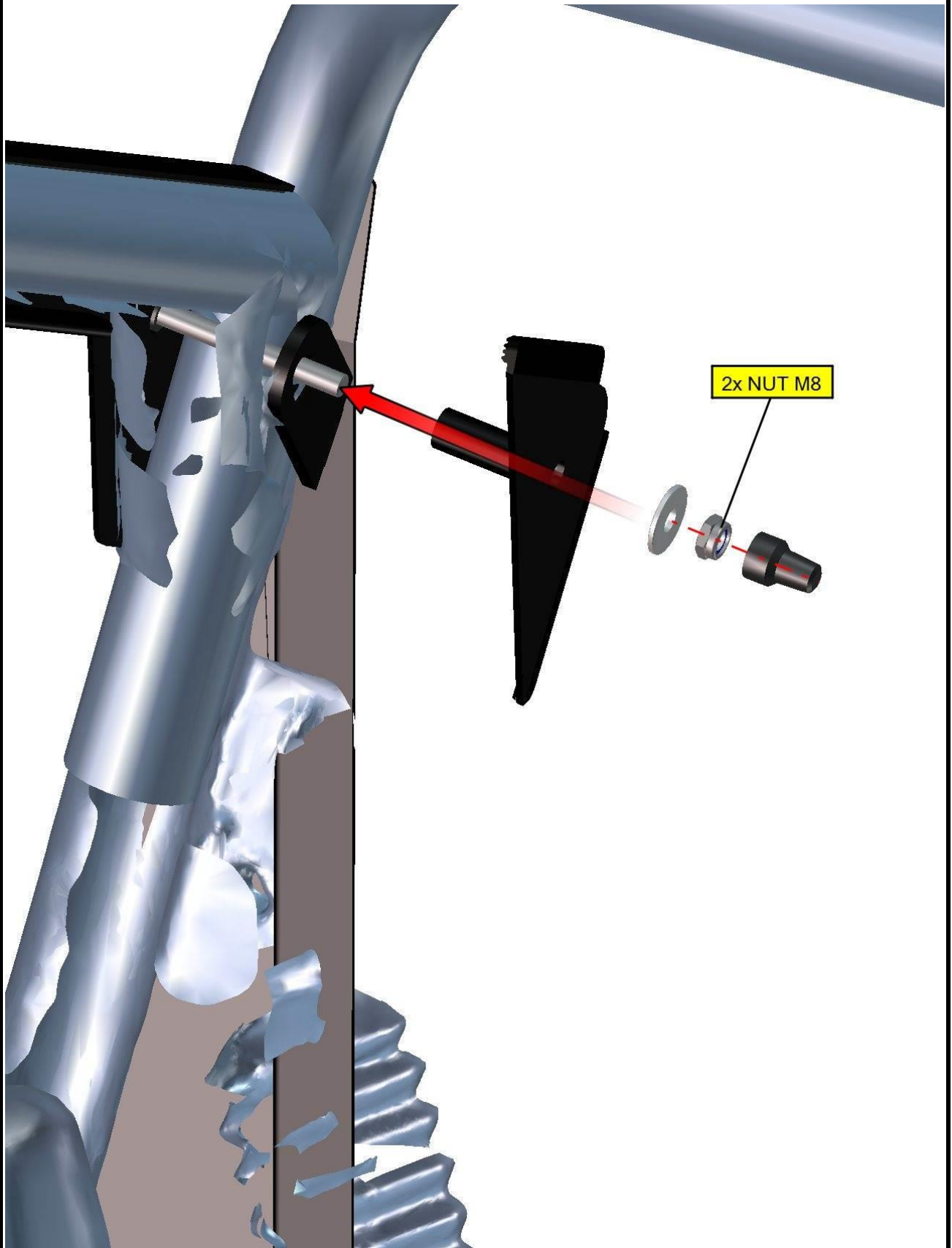

Place the rear glass assembly onto the rear bottom ledge.

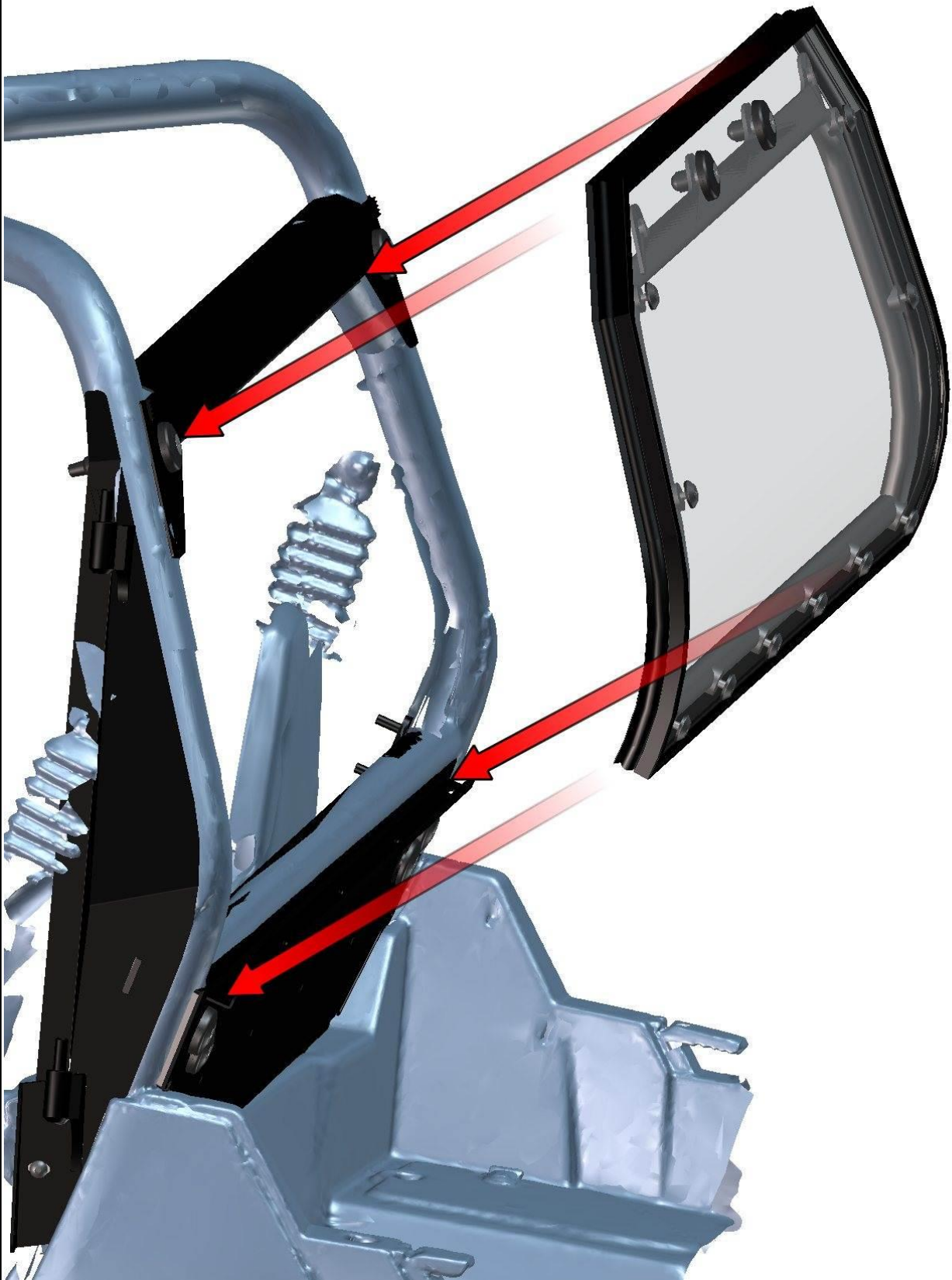

Fix the rear glass assembly with rear upper ledge by included holder, screw, washers and fast-lock handle on both sides.

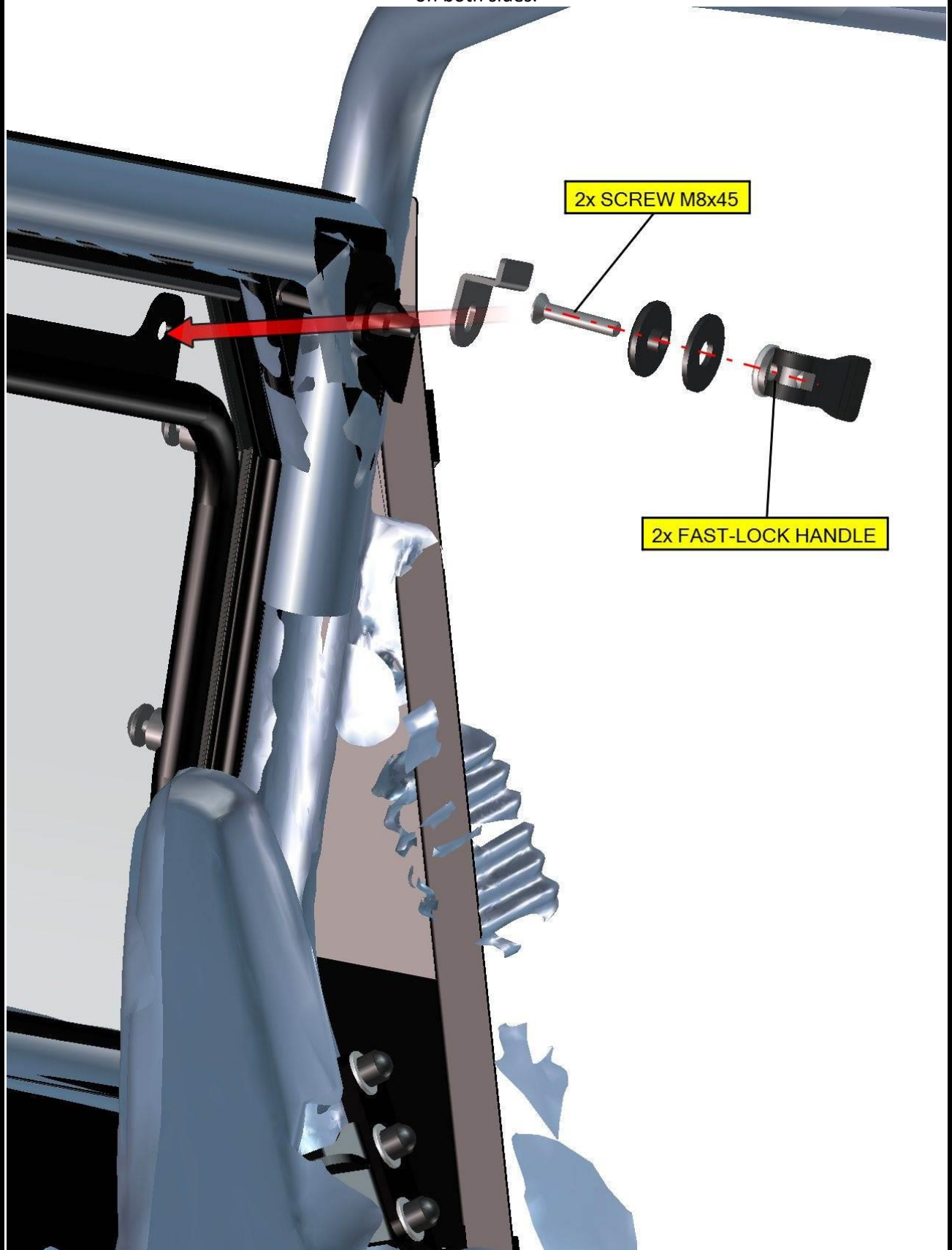

FRONT PANEL 1.

One by one uninstal original screws from UTV rollercage and replace them with intlcuded M10x70 screws.



24

SEE NEXT PAGE

Place the rear bottom ledge onto the UTV rollercage.

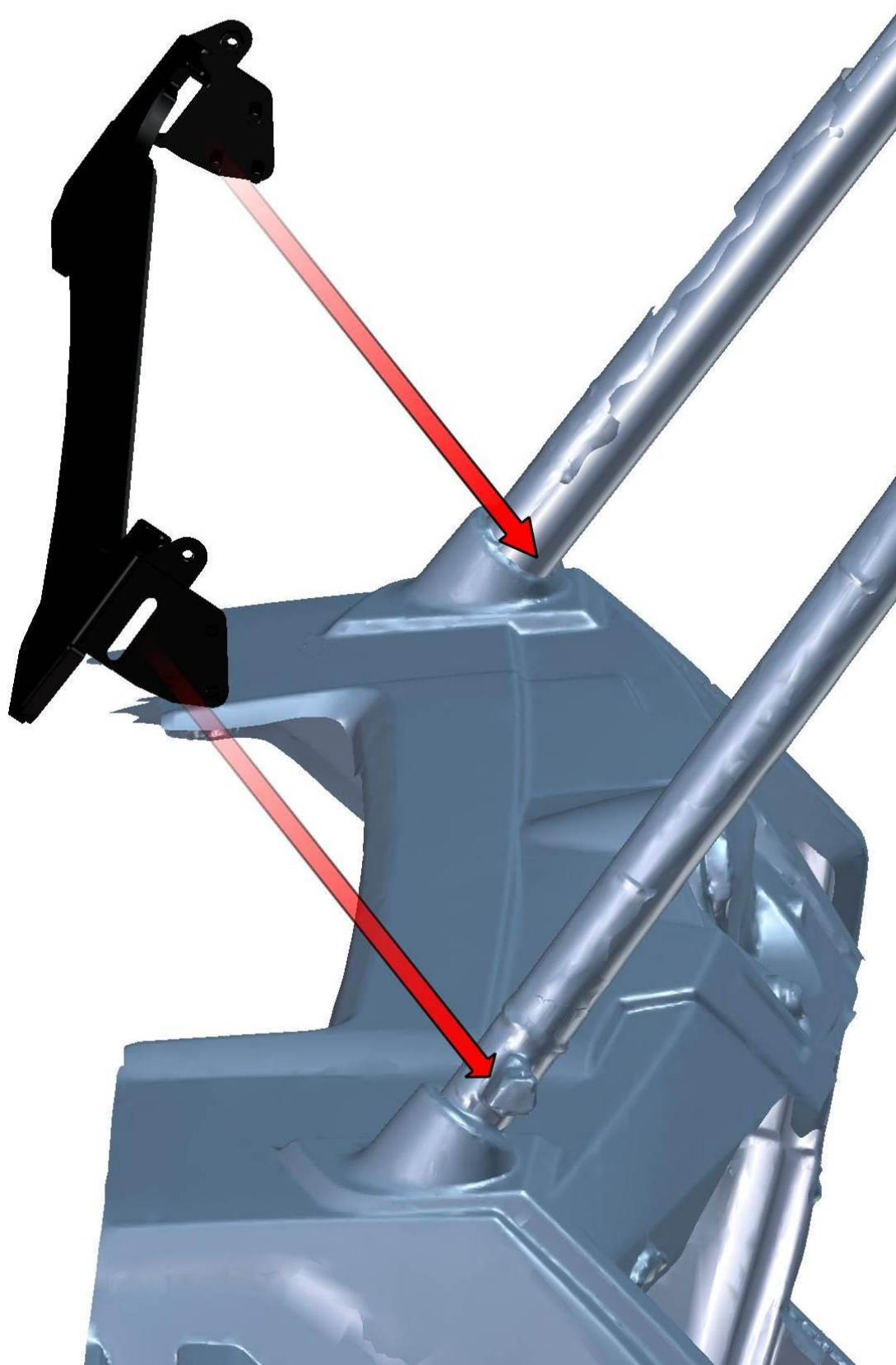

25

Fix the front bottom ledge with the UTV roller cage by screws from previous step, nuts, washers and covers.

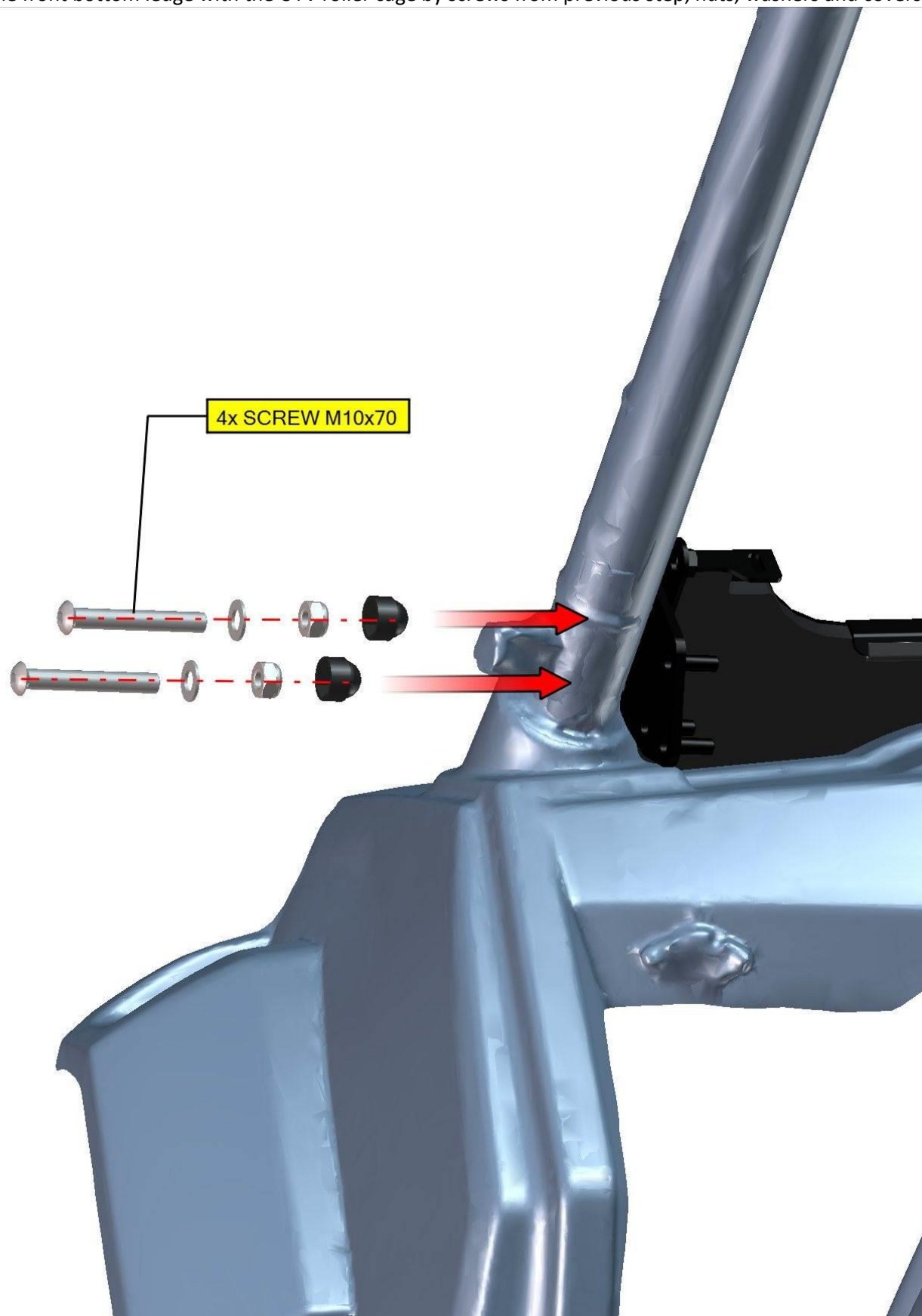

26

Install the front glass lock onto the holder and fix the whole assembly with the front bottom ledge by included screw, washer, nut and cover on both sides.

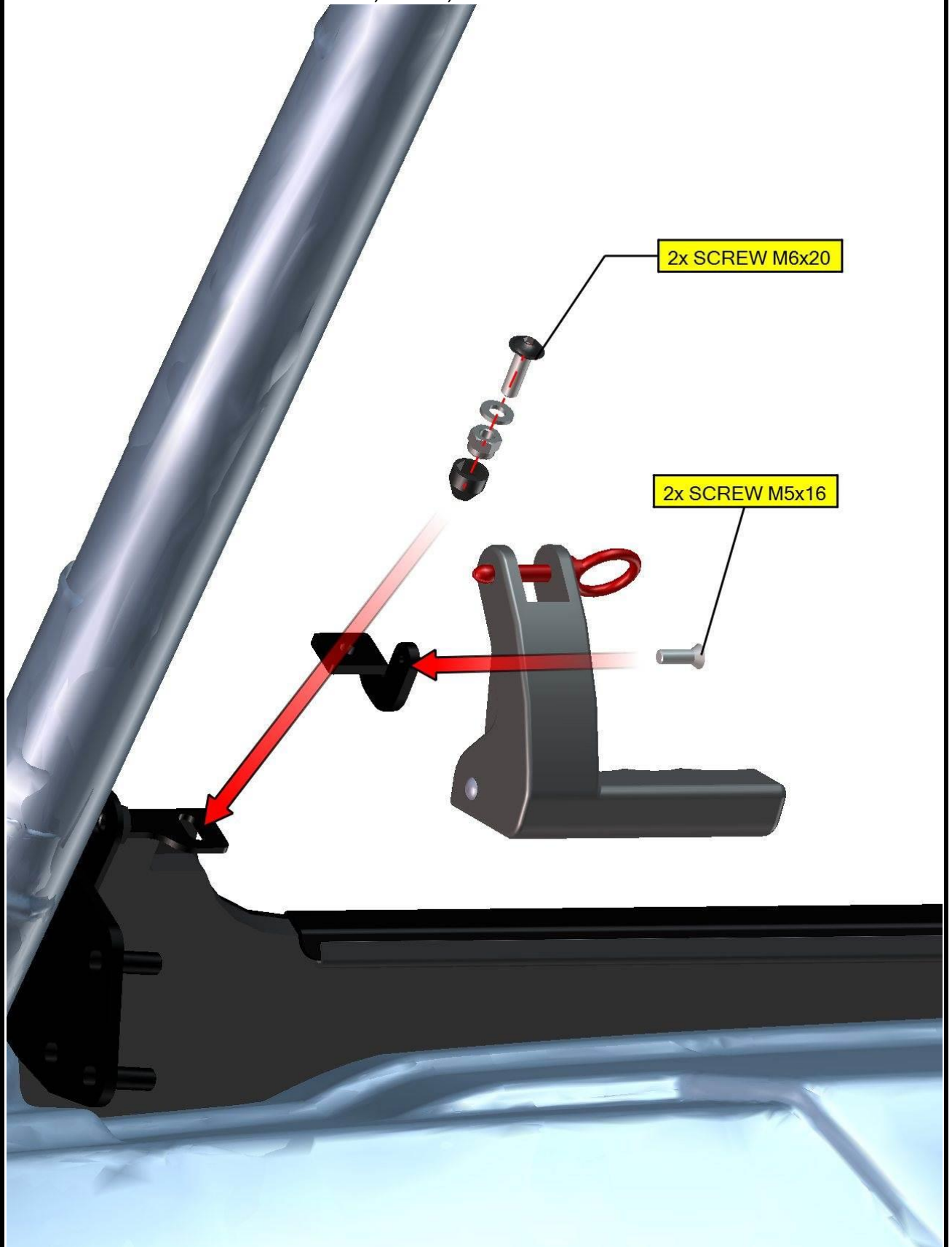

ELECTROINSTALLATION 2.

WIPER SET

View onto the wiper motor with the cover and with the middle ledge.



Place the washer onto the wiper longer pin.

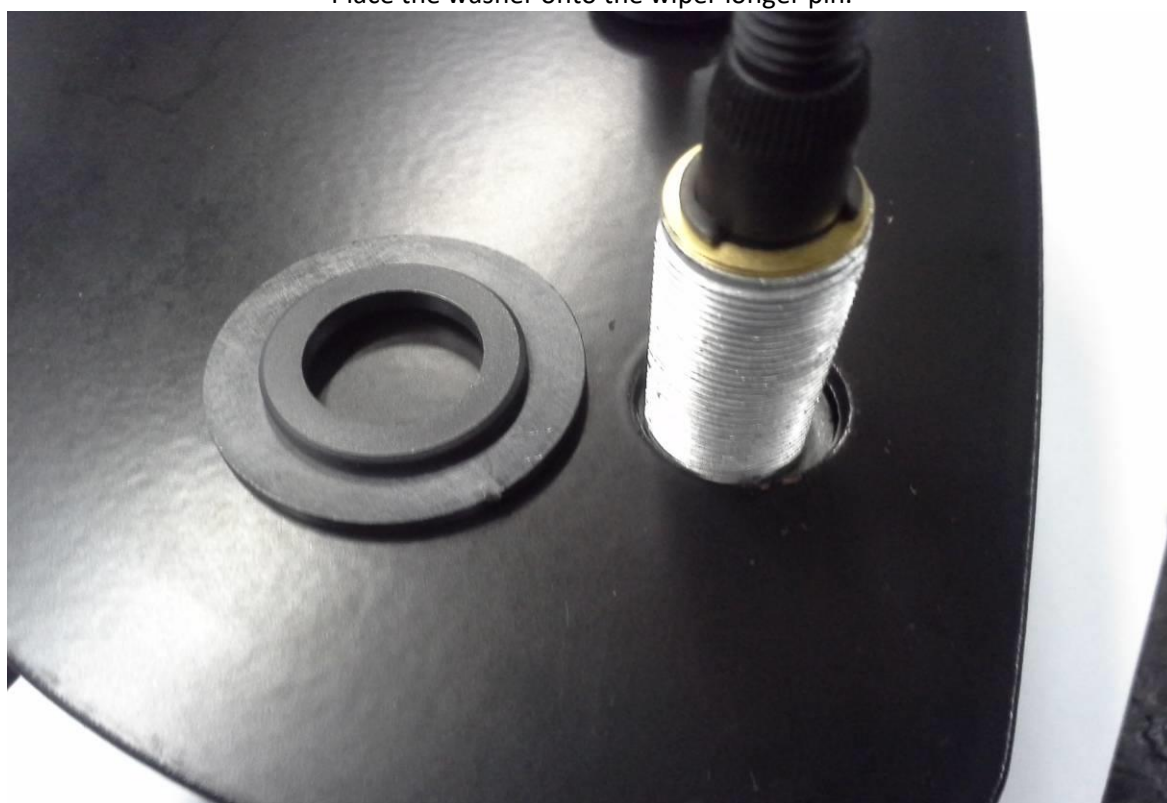

Place the washer onto shorter wiper pin.



View onto installed washers.



Place the wiper assembly onto the front glass from inner side.
 Insert these washers onto the wiper's pins and onto the glass from outer side.



Fix the wiper motor with the front glass by included nuts and tighten these correctly.



FRONT PANEL 2.

Place the front glass assembly onto the front upper ledge and fix by included screws, washers, nuts and covers.

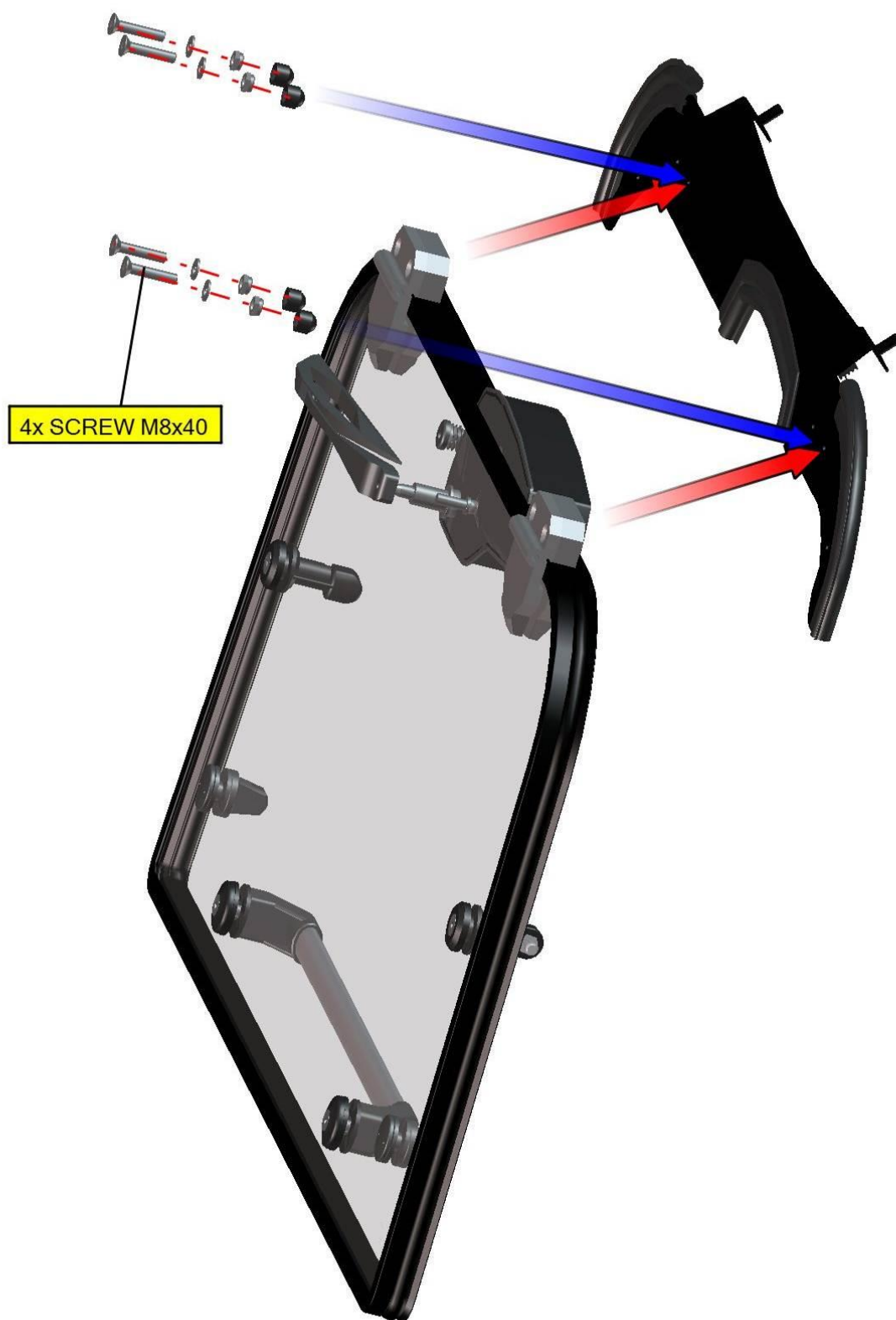

Place the front upper ledge tightening strap onto the UTV rollercage on both sides.

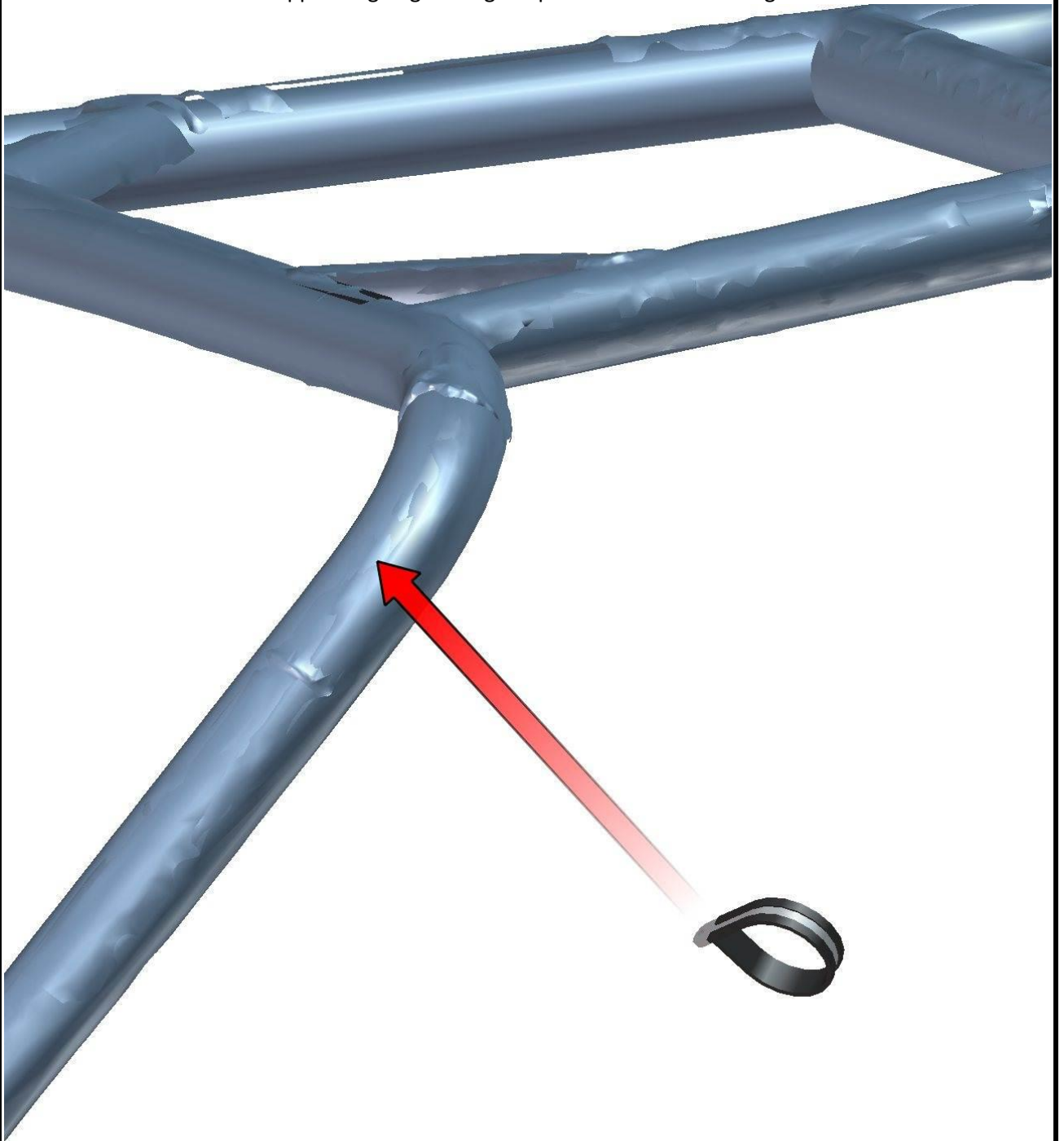

32

Place the front glass assembly onto the UTV rollercage and fix with front upper ledge tightening straps by included screws, nuts, washers and covers.

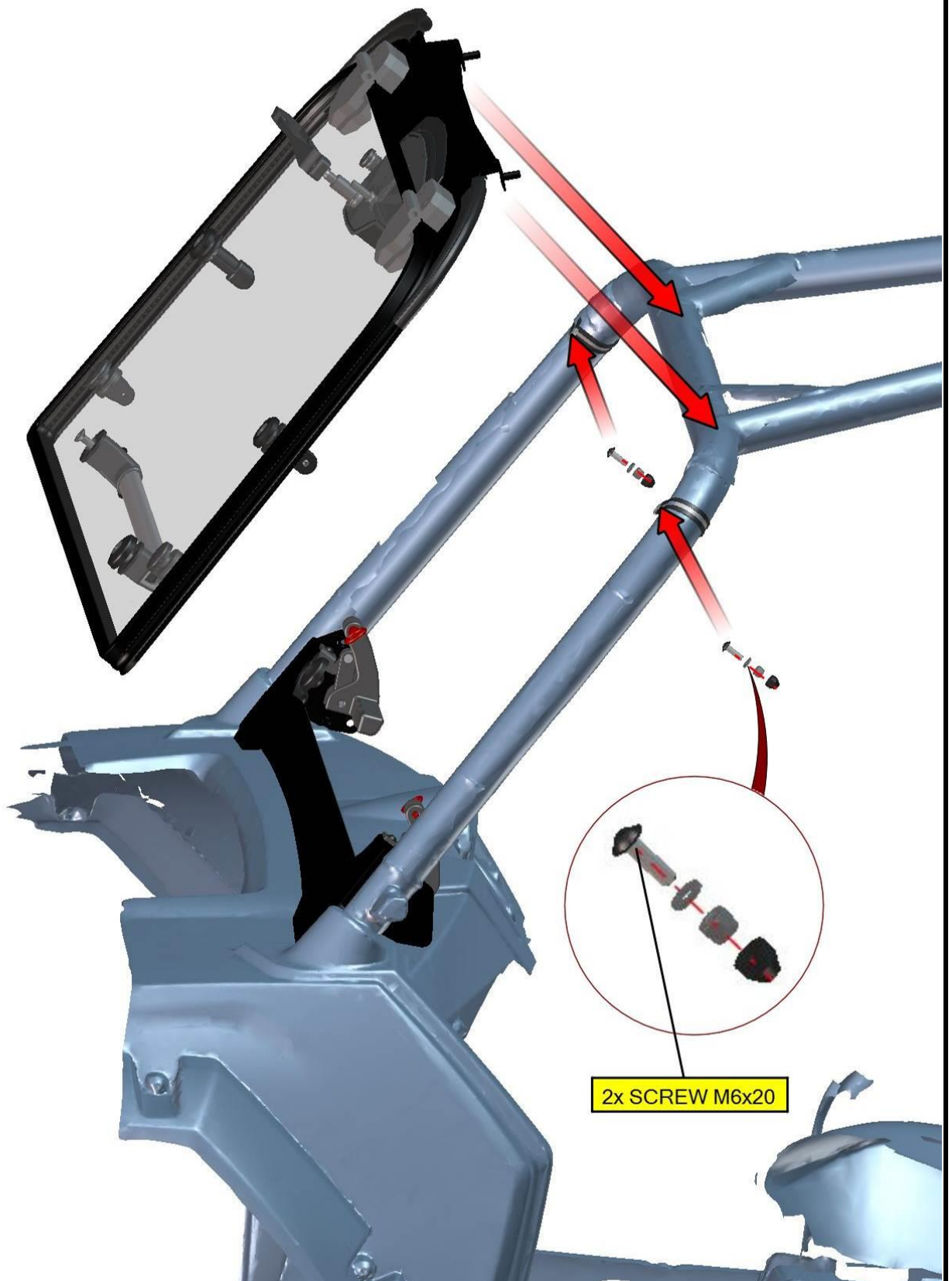

33

Fix the front upper ledge with the UTV rollercage by included holder, nuts, washers and covers.

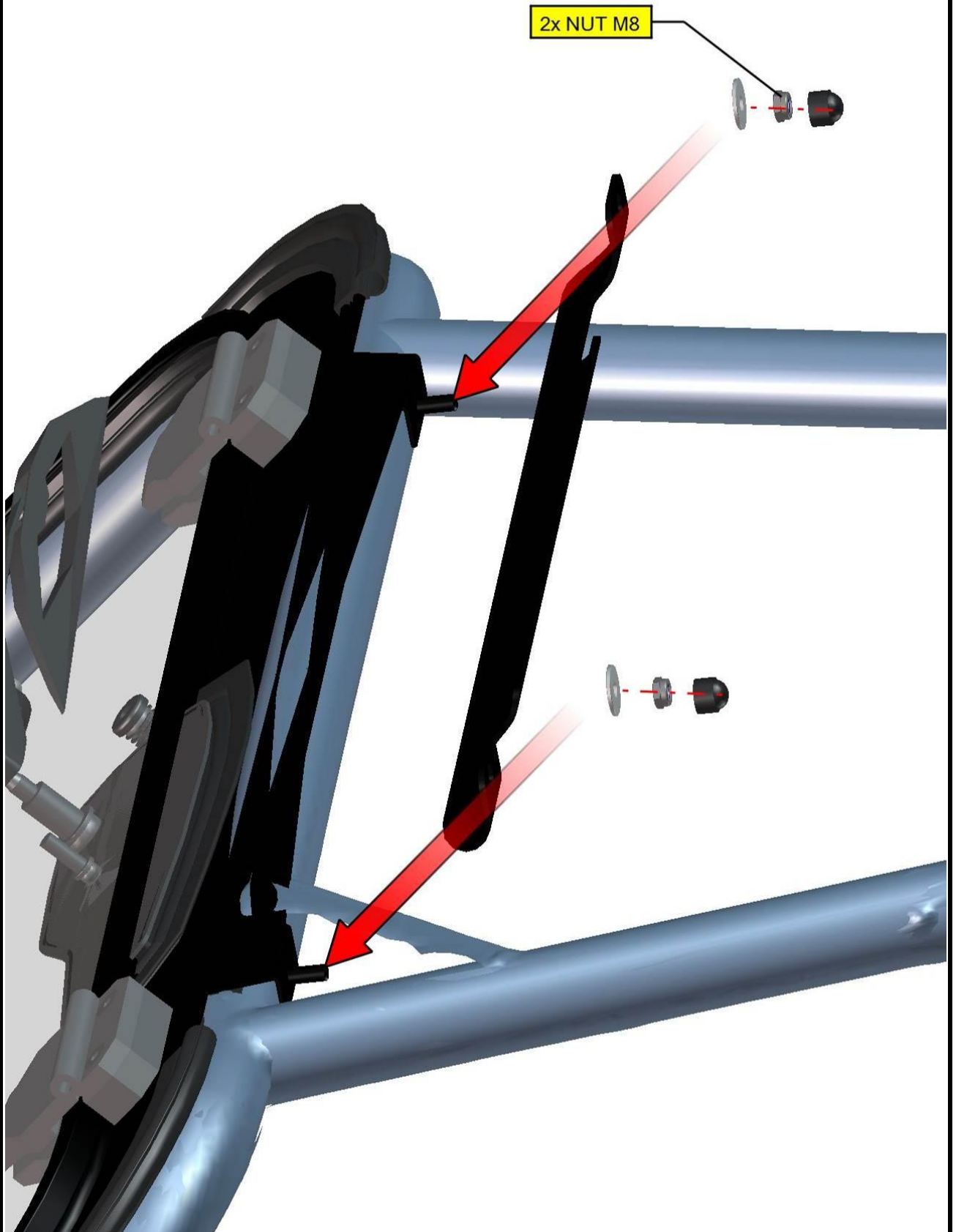

34

Adjust the front glass lock assembly into the best position and fix.

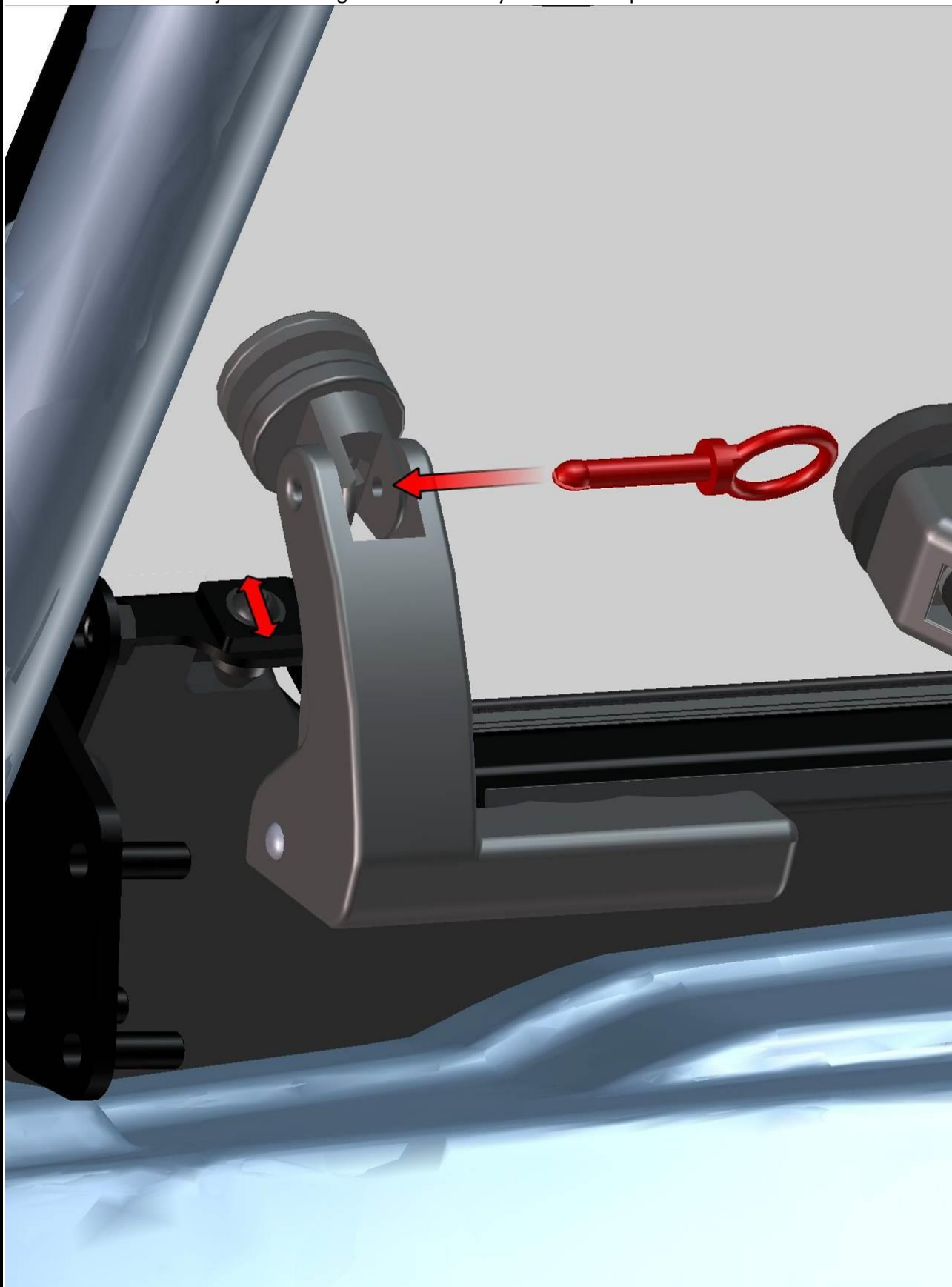

35

Install the front gas spring into the gas spring holders on both sides.

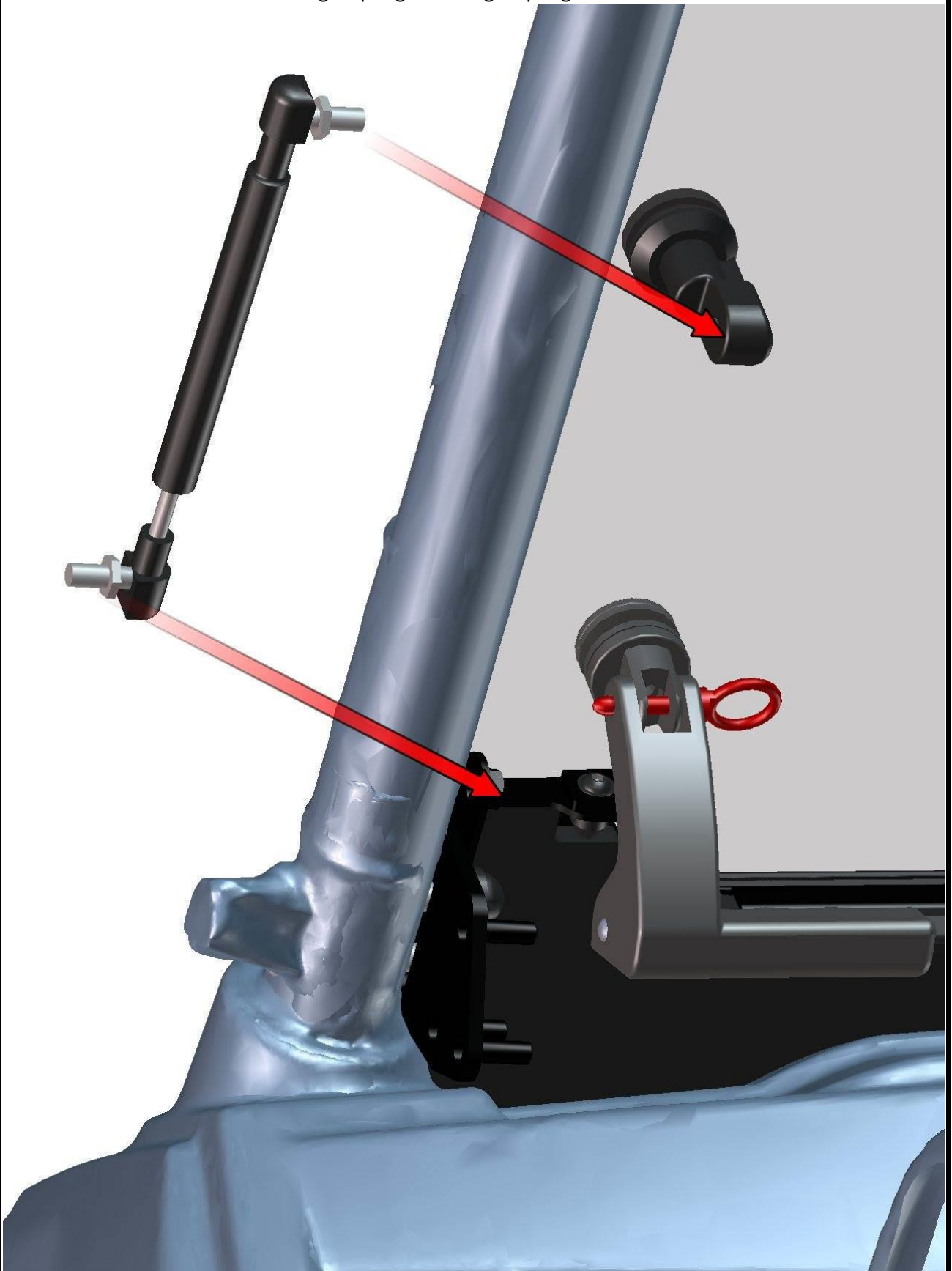

36

ROOF

Place the roof onto the UTV rollercage and adjust into the best position.

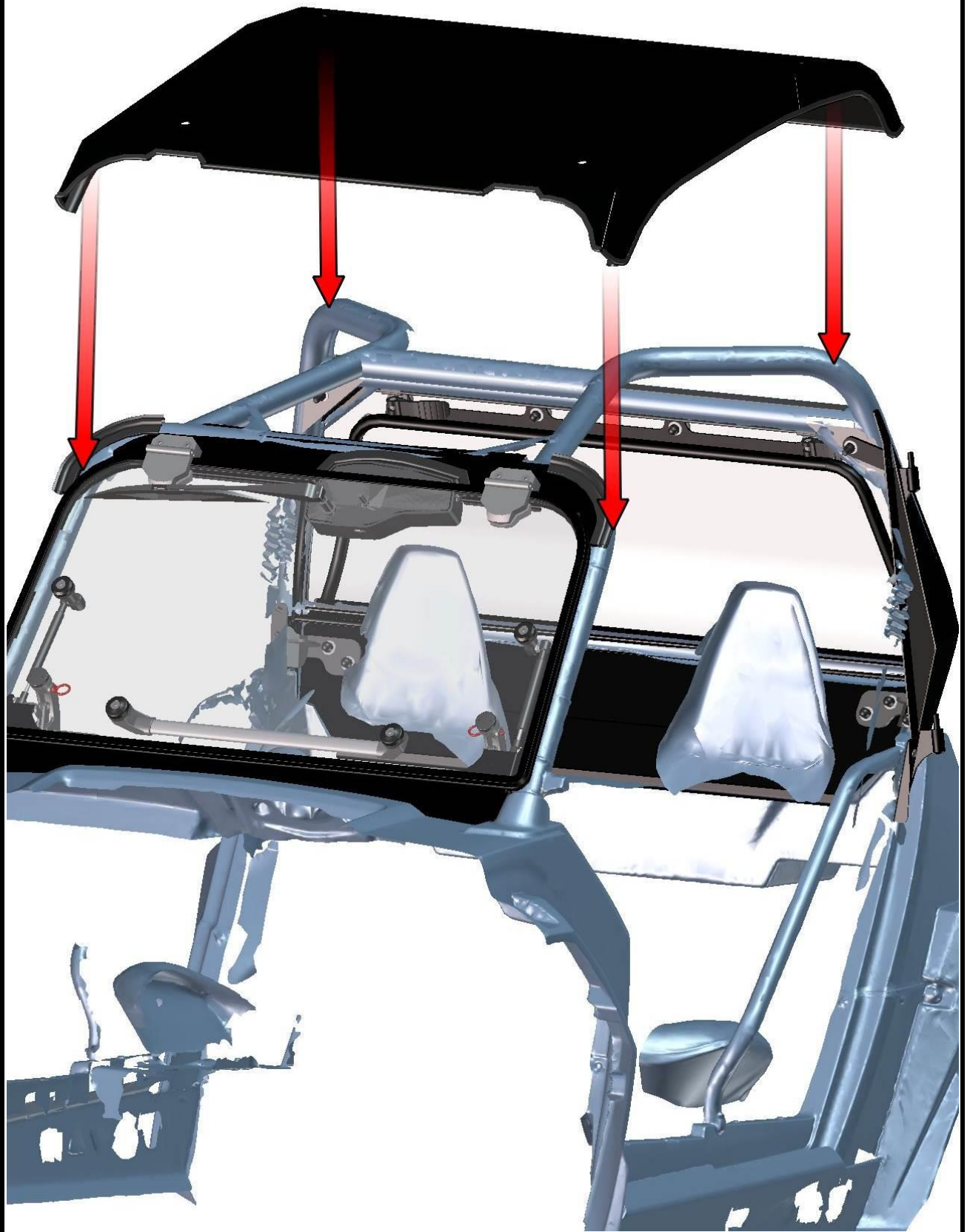

37

Fix the roof with the UTV rollercage by included holders, screws, washers and fast lock handles on both sides.

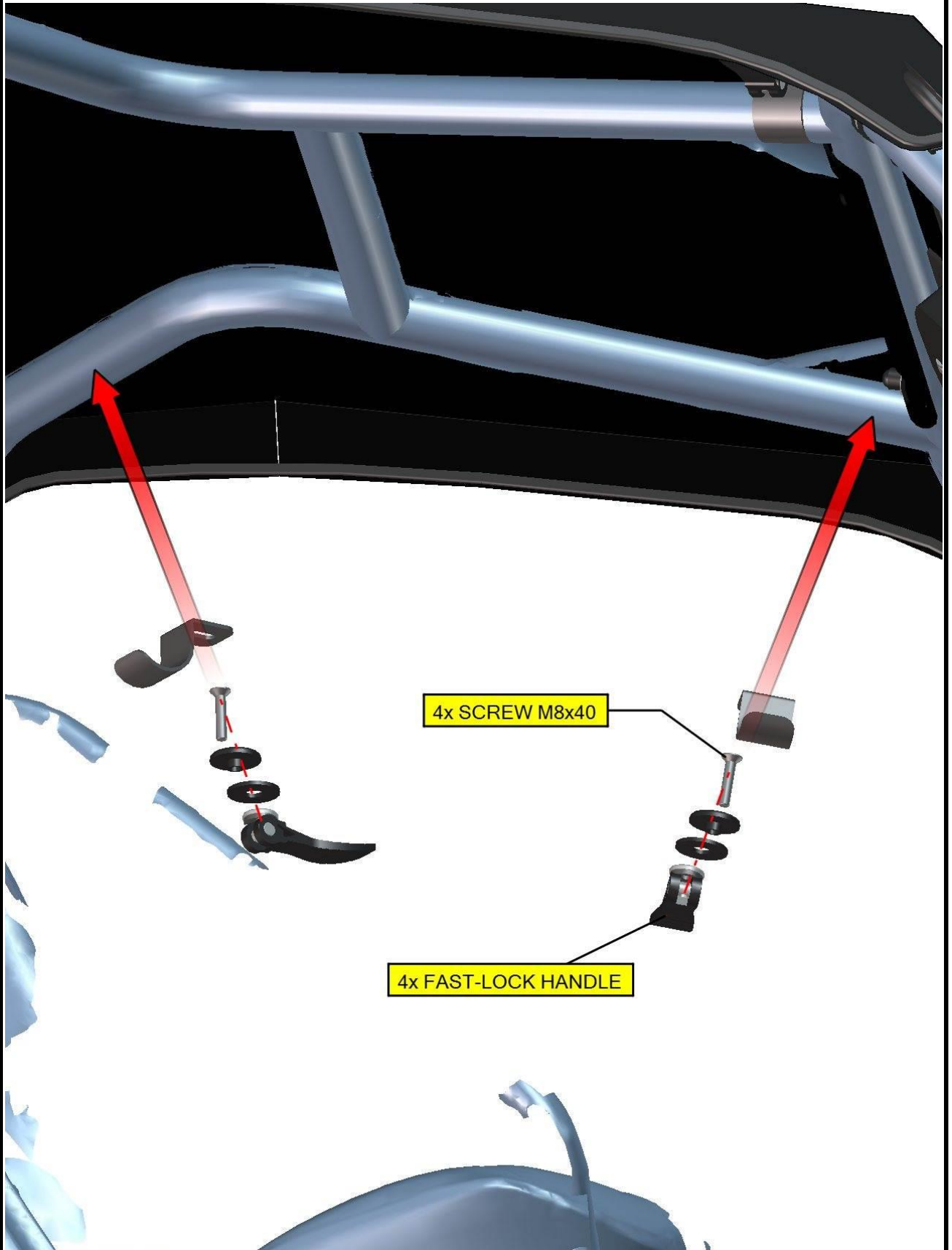

LEFT DOOR + RIGHT DOOR 2.

Install washers onto the hinges pins. Place the left door onto the hinges.

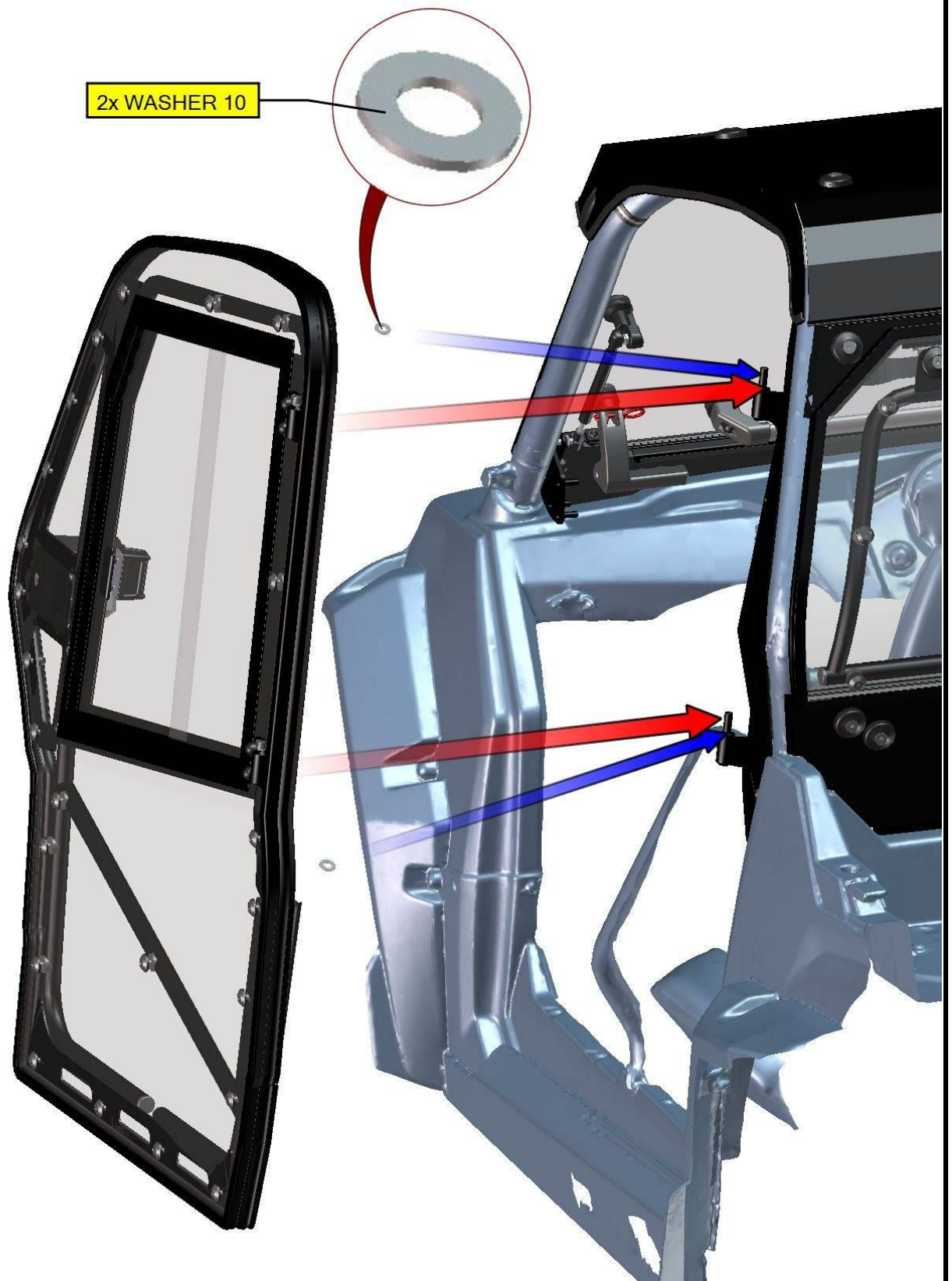

Adjust the left door into the best position by hinges and tighten screws hard.



40

Instal the door stop assembly into the left door stop holder.

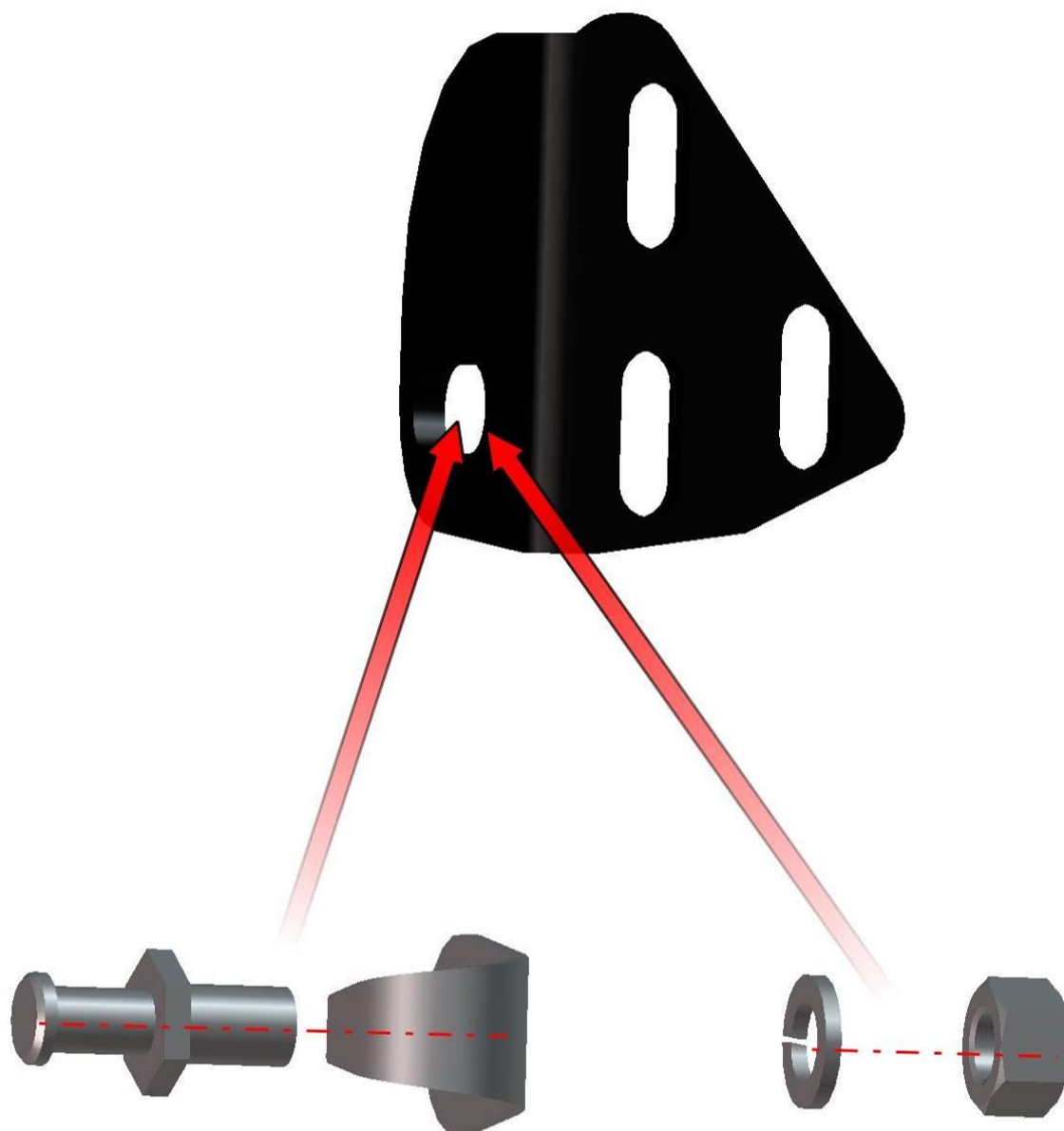

41

Place the left door stop assembly onto the front bottom ledge welded pins and fix by included nuts, washers and covers.

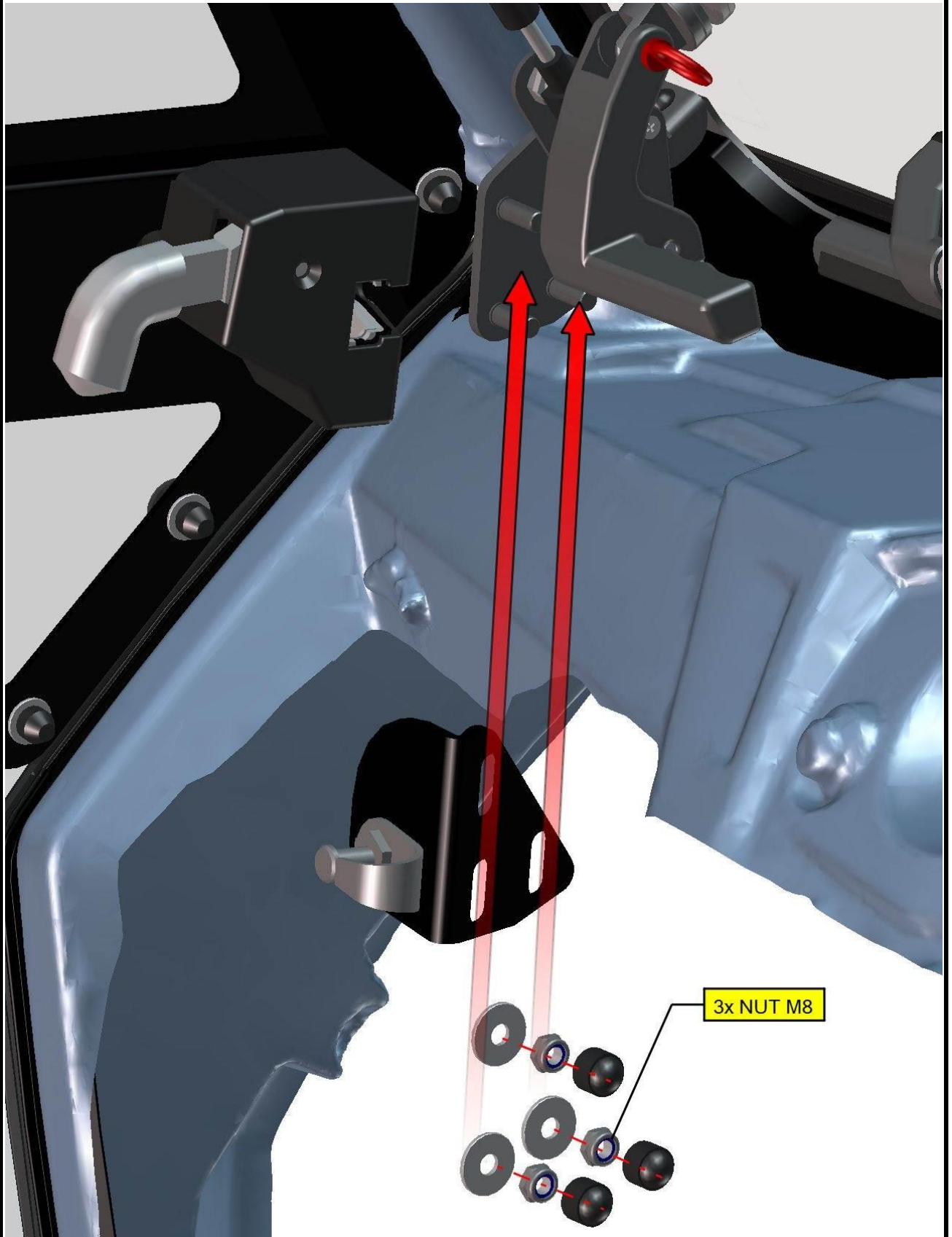

42

Adjust the left door stop assembly into the best position and tighten screws hard.

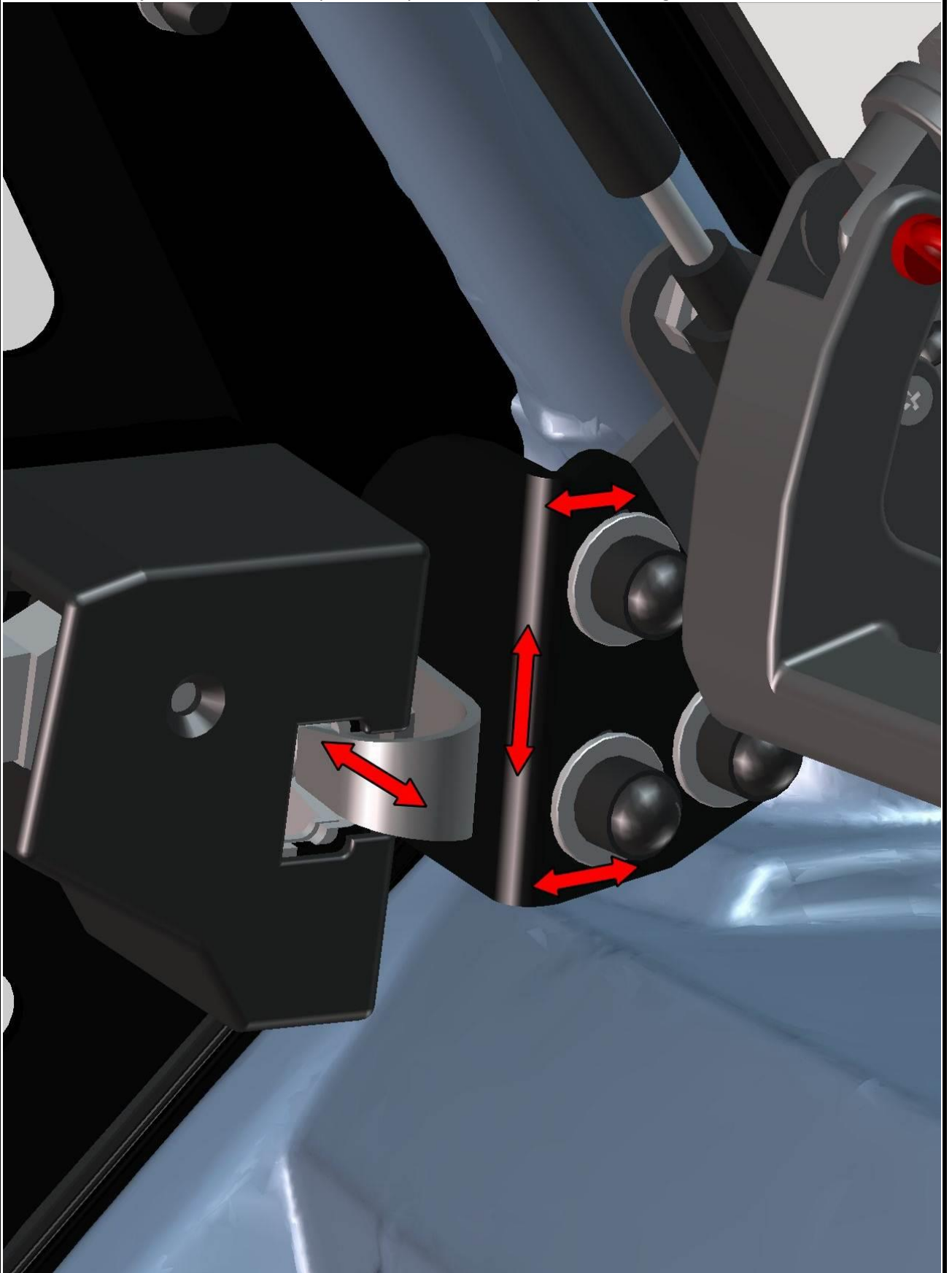

43

Install the left mirror onto the left mirror holder.

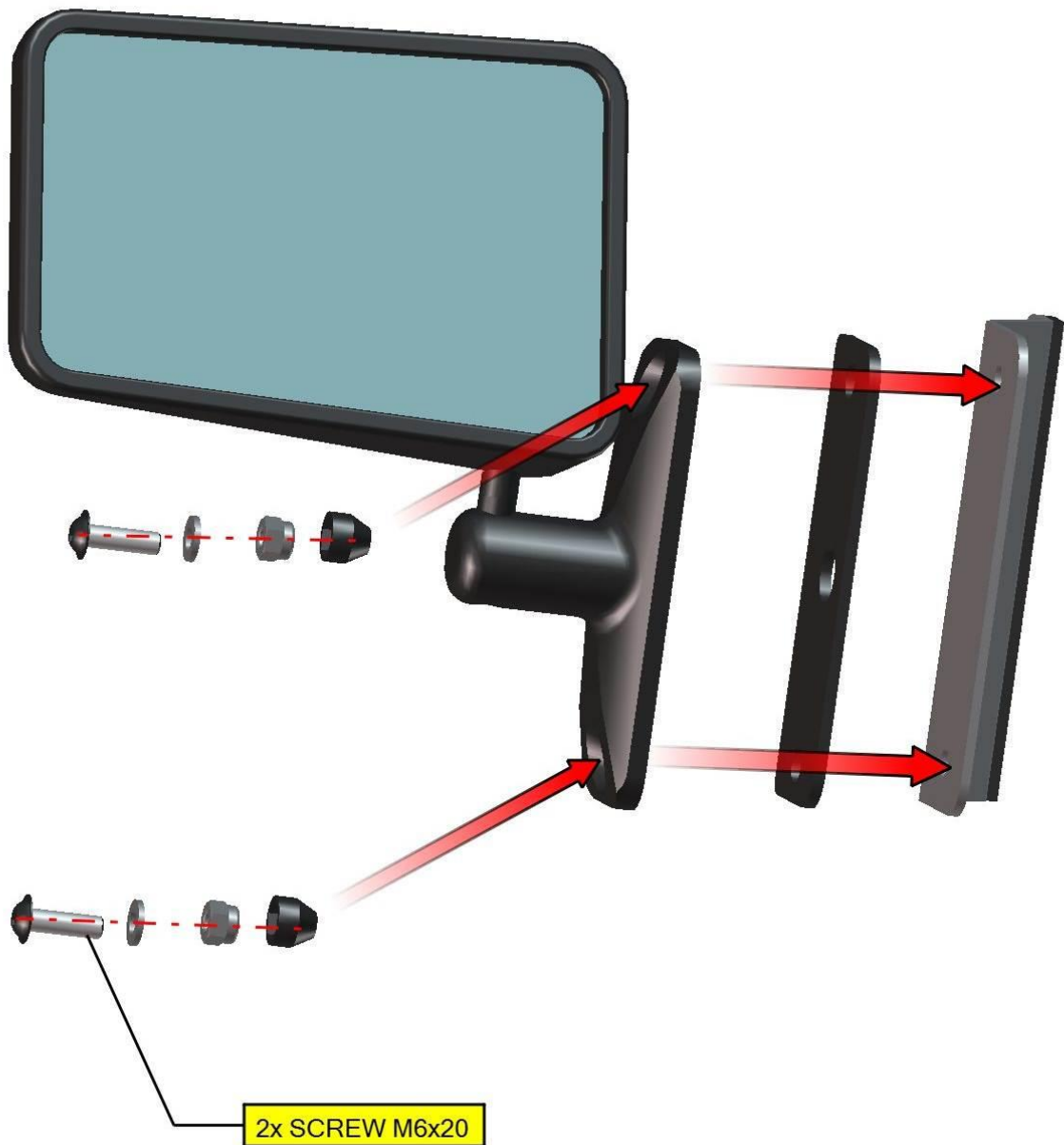

44

Place the left mirror assembly onto the left door frame and fix by included screws, and washers.

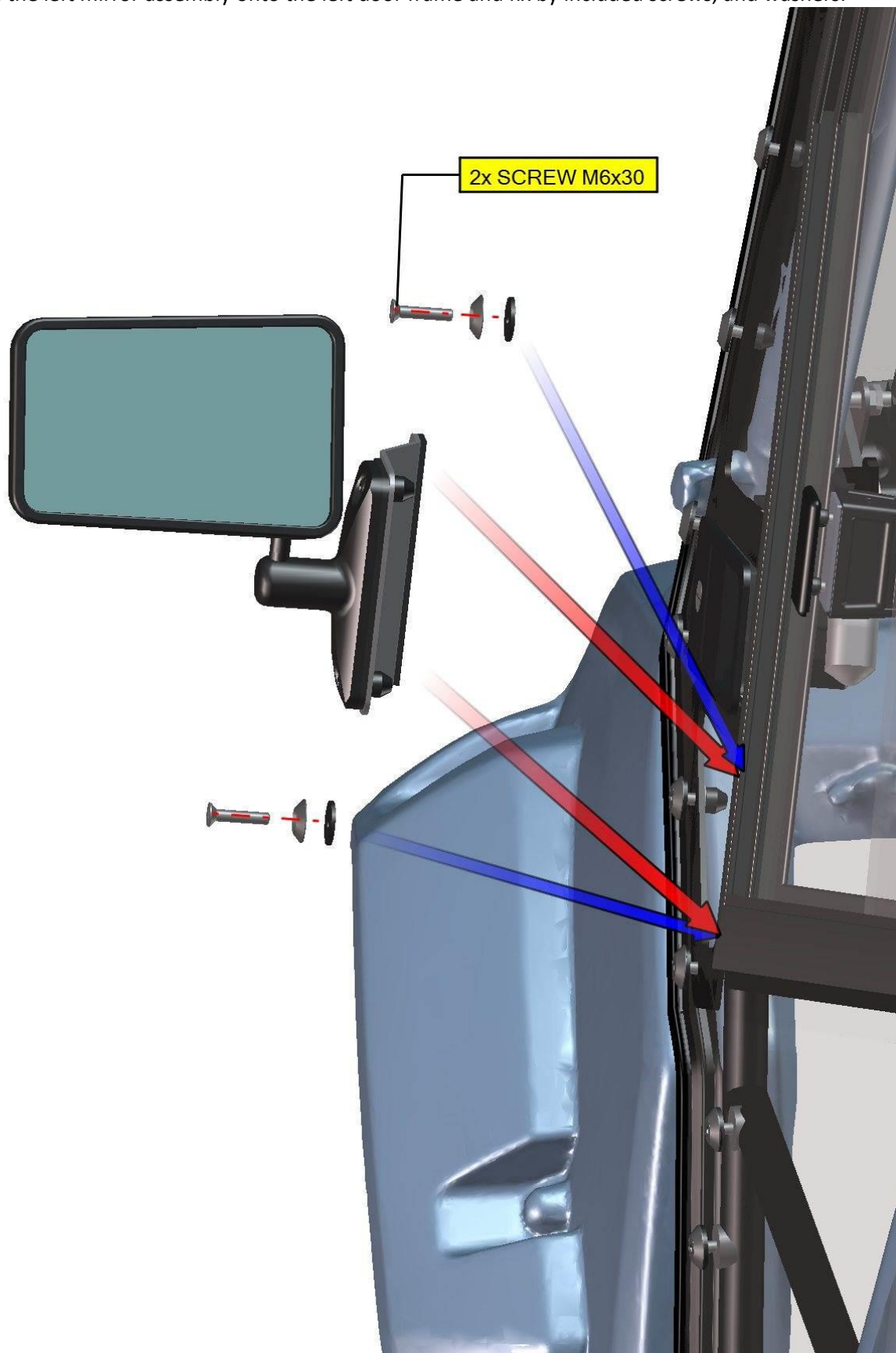

45

Repeat previous steps with the right door.



46

ELECTROINSTALLATION 3.
WIPER/WASHER

Drill hole $\varnothing 8\text{mm}$ (0,33-0,38in) into the front boot ledge and install washer tang holder by included screw, washer and cover.



48

Install the washer tank onto the holder and lead the washer harness to the front dashboard bottom space.



Uninstall bottom dashboard cover and connect wiper and washer harness with the original electroinstalation.



Install the wiper/washer switch into the dashboard, if you don't have original hole, cut the rectangle 44,1x22,1mm into the dashboard into the best position (red rectangle).



Run the wiper harness through the switch hole. Connect the wiper and the washer harnesses with the switch and press the switch into the dashboard.

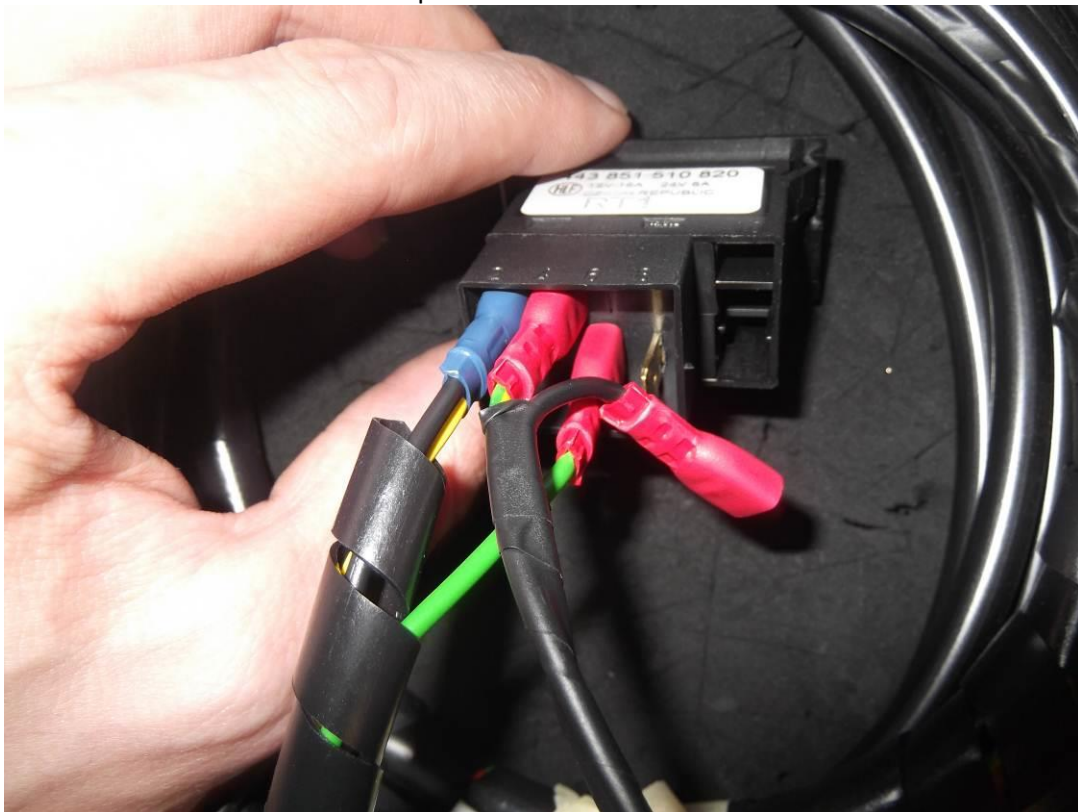

Lead the wiper harness branch and washer hose to the wiper motor.

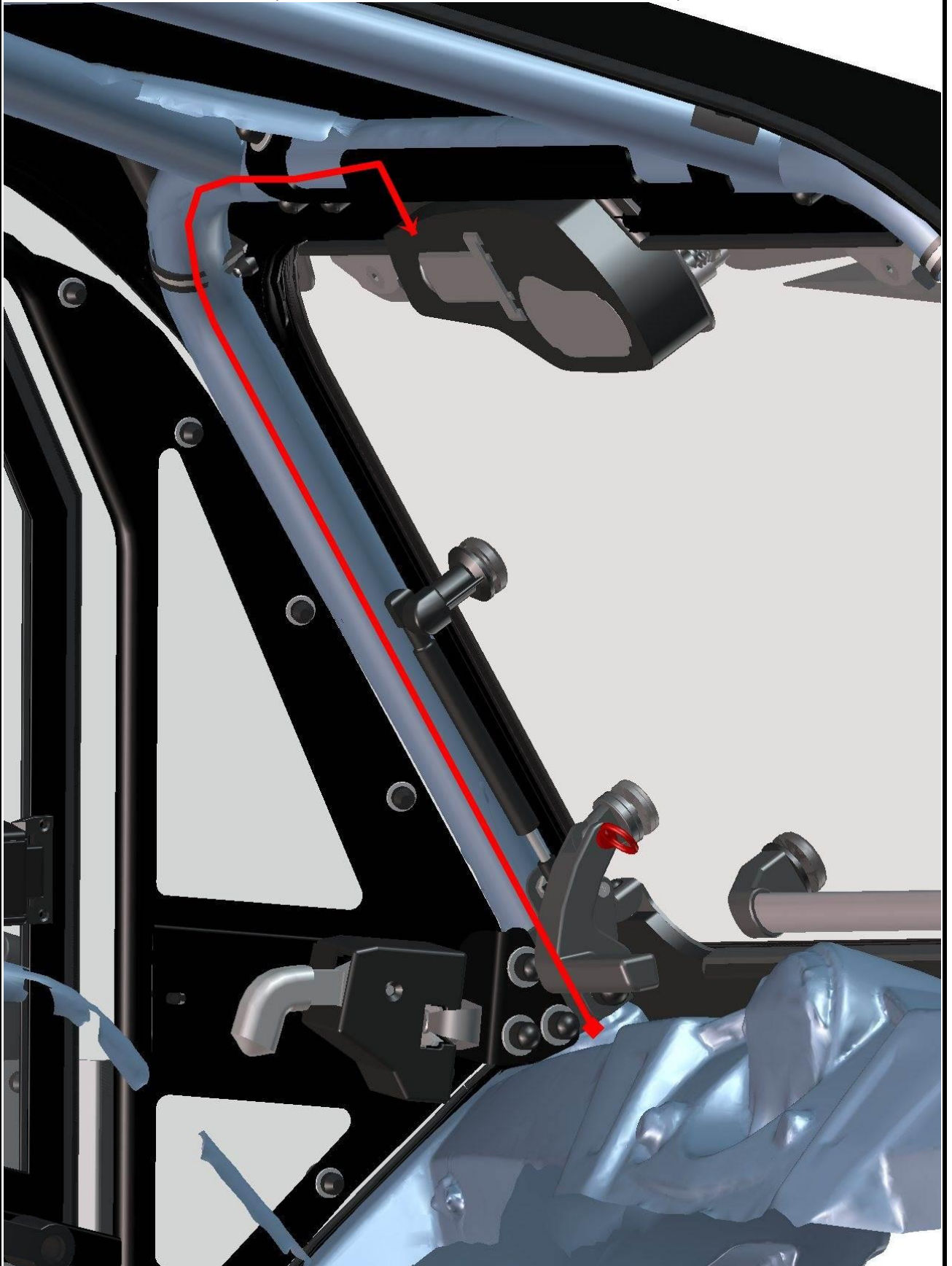

51

Connect the branch with the wiper motor. DETAIL VIEW CONNECTION

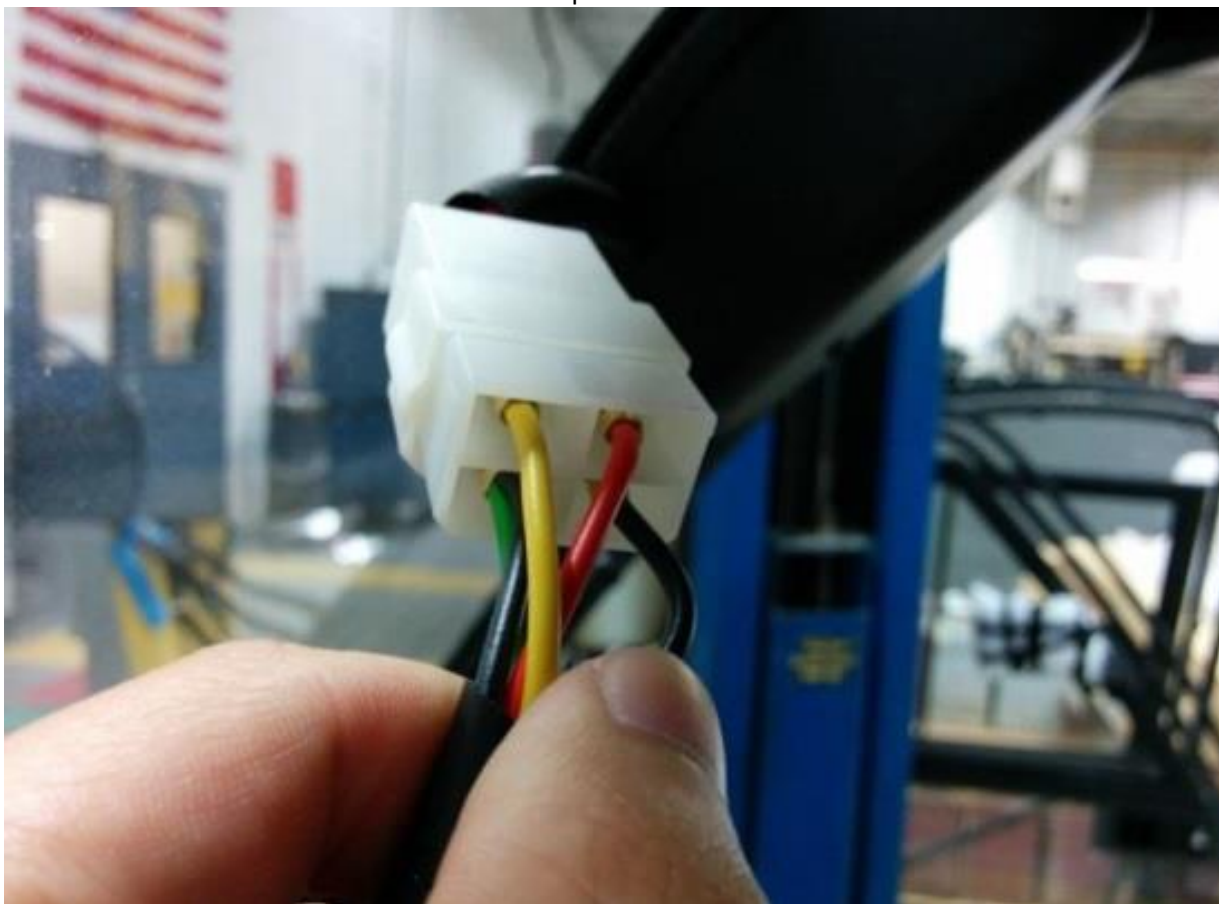

BEFORE FIRST USAGE FILL THE WASHER TANK WITH THE WASHER LIQUID.

52