

INSTALLATION INSTRUCTIONS
High Clearance Rear A-Arms:
for Polaris RZRS[®]

Item	Description	Item	Description
A	Rear Upper A-Arm, Left	E	Brake Line Clip x 2
B	Rear Upper A-Arm, Right	F	Sway Bar Link x 2
C	Rear Lower A-Arm, Left	H	Grease Fitting x 6
D	Rear Lower A-Arm, Right		

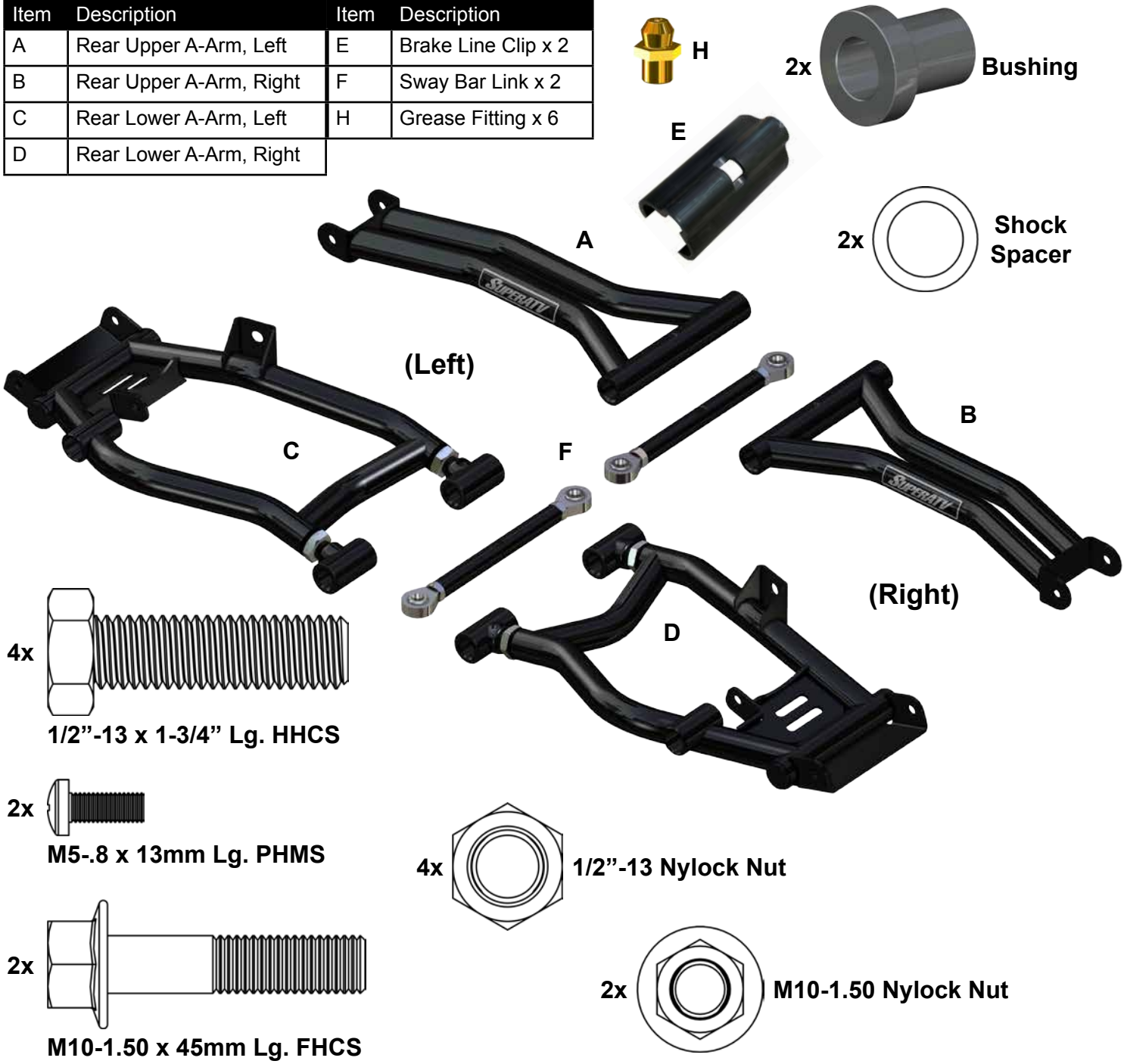

Visit SuperATV.com for A-Arm installation video.

Need help with your installation?

sales@superatv.com
www.superatv.com

1-855-743-3427
 8:00am - 9:00pm EST M-Th
 8:00am - 7:00pm EST Friday
 9:00am - 2:00pm EST Saturday

Read instructions and view illustrations before beginning.

Thank You
 For Choosing
SUPERATV.COM[®]

Do not tighten hardware completely unless noted. Keep all components removed from machine.

1. Raise Rear of machine off ground, secure with jack stands.
 - Remove Wheels.
 - Unbolt Sway Bar Links and Shocks from Lower A-Arms. See Fig. 1.
 - Remove Brake Lines from A-Arms.
 - Remove Spindles. See Fig. 1.
2. Remove stock Upper and Lower A-Arms from Frame. See Fig. 1.
3. Remove Sway Bar Links from machine. See Fig. 1a.
4. Transfer stock Bushings, or install SuperATV Poly Bushing Kit AAB-P-RZR, into A-Arms (A-D). See Fig. 2.
 - Install Grease Fittings (H) into A-Arms (A-D). See Fig. 2.
 - Adjust Pivot Blocks. See pages 4 - 5.
6. Install A-Arms (A-D) to Frame with stock hardware. SuperATV recommends using Loc-Tite on Nuts when installing. **Do not install Nuts to Lowers until all final adjustments have been completed.** See Fig. 3.
7. Install Sway Bar Links (F) to stock Sway Bar. See page 7.
8. Reinstall necessary components with stock hardware; tighten completely. **Do not install any Nuts to Lowers until all final adjustments have been completed.** See Fig. 3a.
9. Reinstall Tires and see page 8 for Camber adjustments if required. Add Nuts to previously installed hardware and tighten completely. SuperATV recommends using Loc-Tite on Nuts when installing.
10. Ensure no binding can occur, and secure Brake Lines with Brake Line Clips (E) and hardware shown. See Fig. 3a.

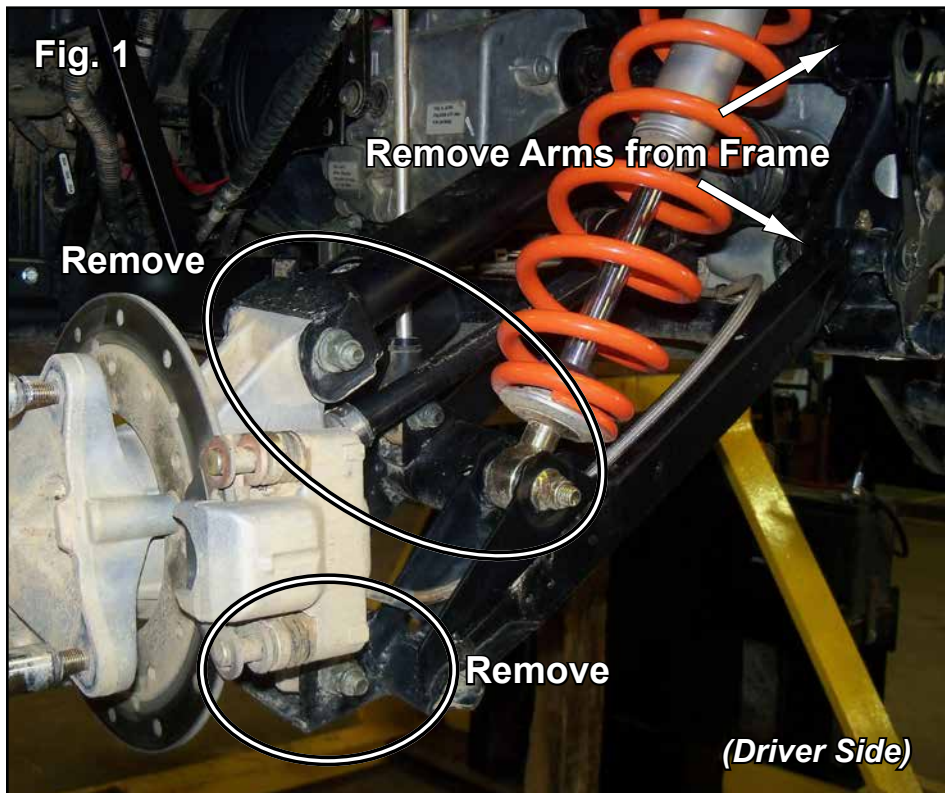

Fig. 2

Install stock Bearings or SuperATV Poly Bushing Kit AAB-P-RZR into A-Arms (A-D)

If using SuperATV Poly Kit:

1. Assemble Bushing to Sleeve.
2. Insert into A-Arm.
3. Install Bushing.

Sleeve

Bushing

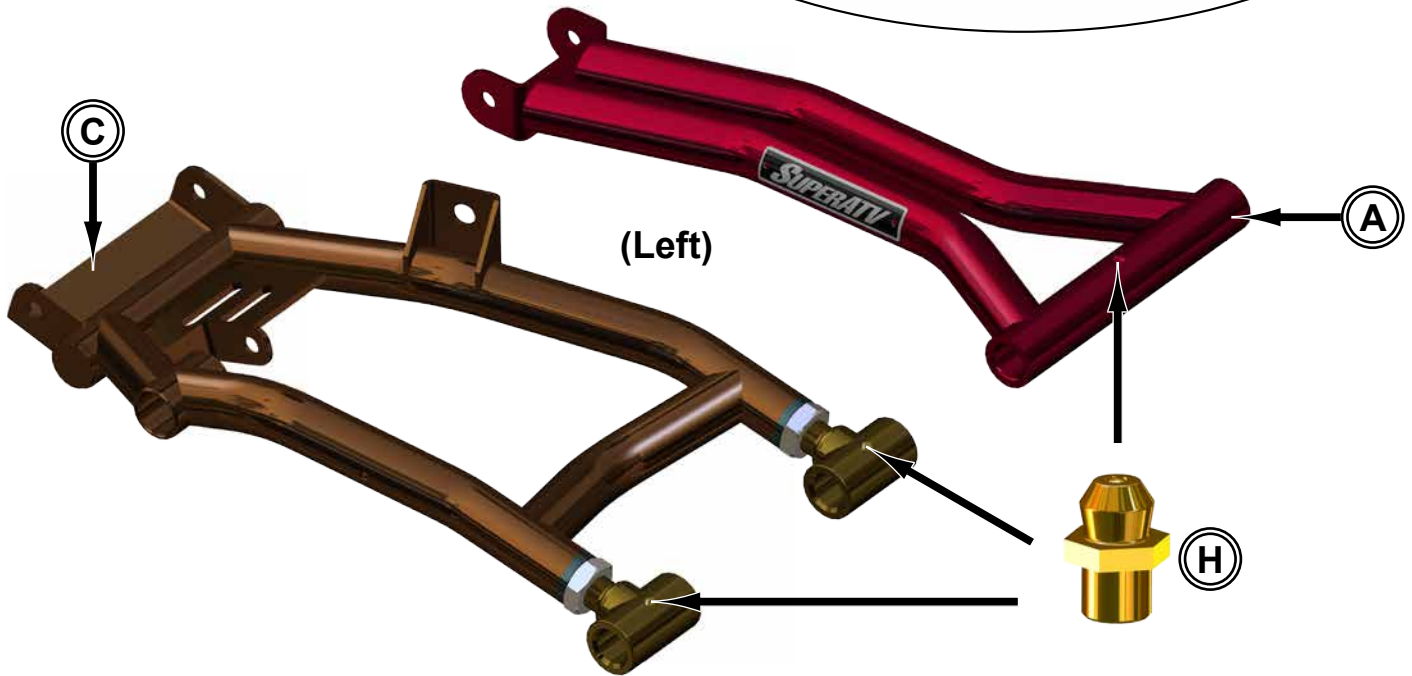

Number will vary slightly between machines.
Slight variations may be required.

**Install Grease Fittings (H) into
A-Arms (A-D)**

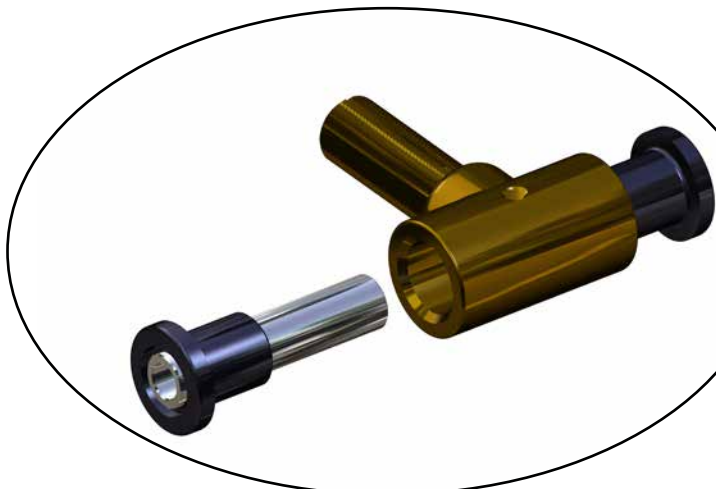

If using SuperATV Poly Kit:

1. Assemble Bushing to Sleeve.
2. Insert into A-Arm.
3. Install Bushing.

Bushing

Sleeve

PIVOT BLOCK SETTINGS

- Place stock A-Arms onto a flat surface and take measurements as shown.
- Record numbers.

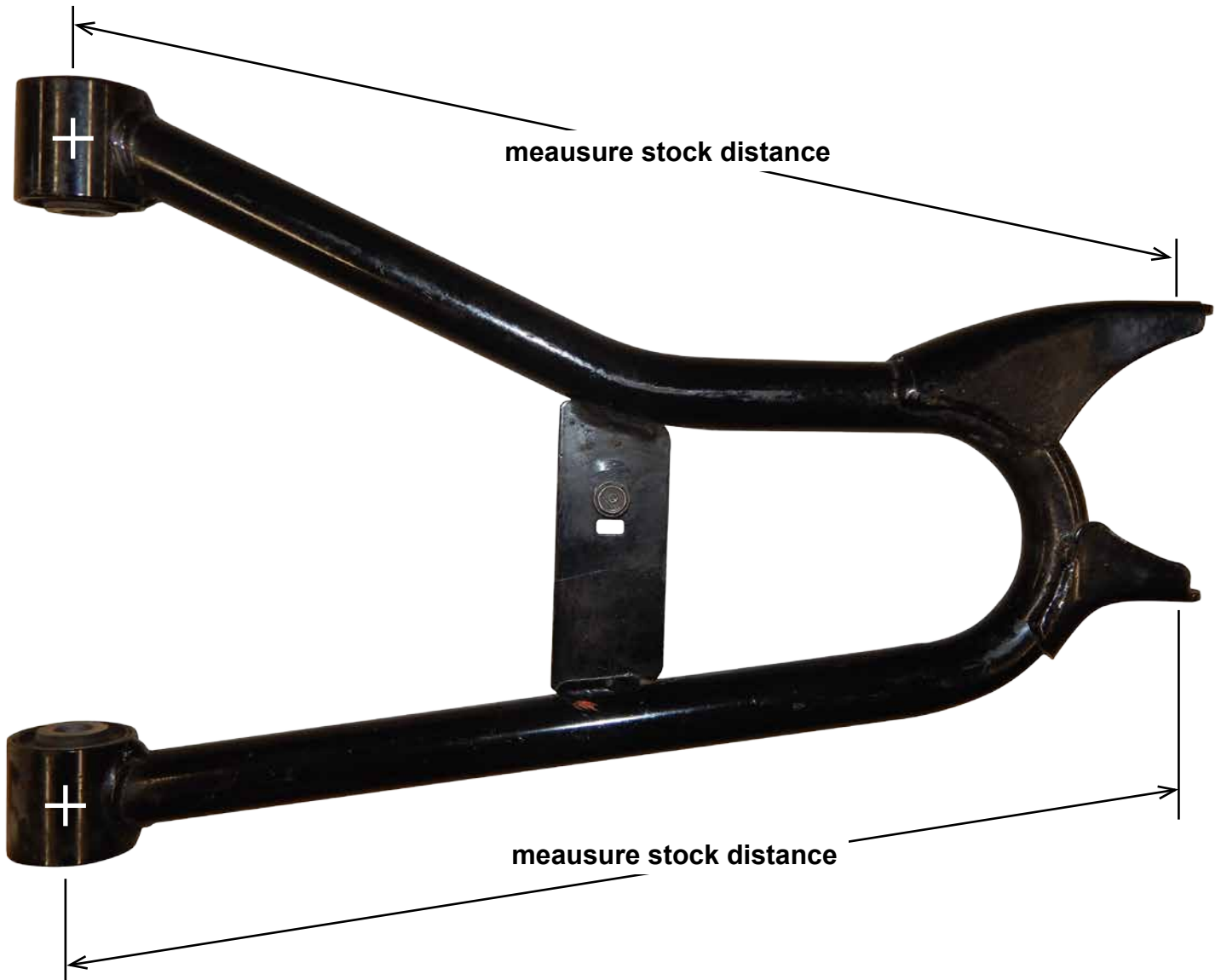

***TAKE ALL MEAUREMENTS FROM CENTER OF PIVOT TUBE
TO CENTER OF BOLT HOLES AT END OF ARM.***

PIVOT BLOCK SETTINGS CONTINUED

- Place new A-Arms onto a flat surface and set Pivot Blocks to measurements previously recorded.

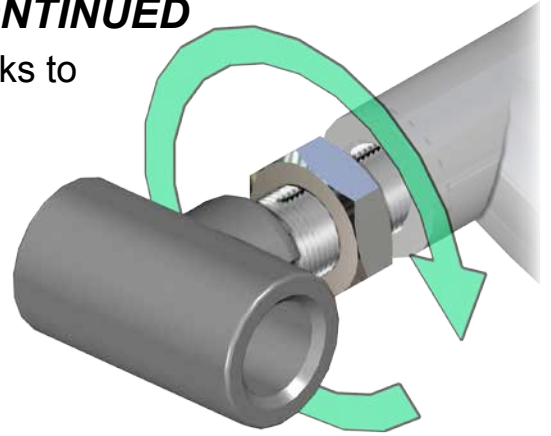

1 full turn, 360°, of Pivot Block is 1mm of adjustment.
(note: 6 full turns is 1/4")

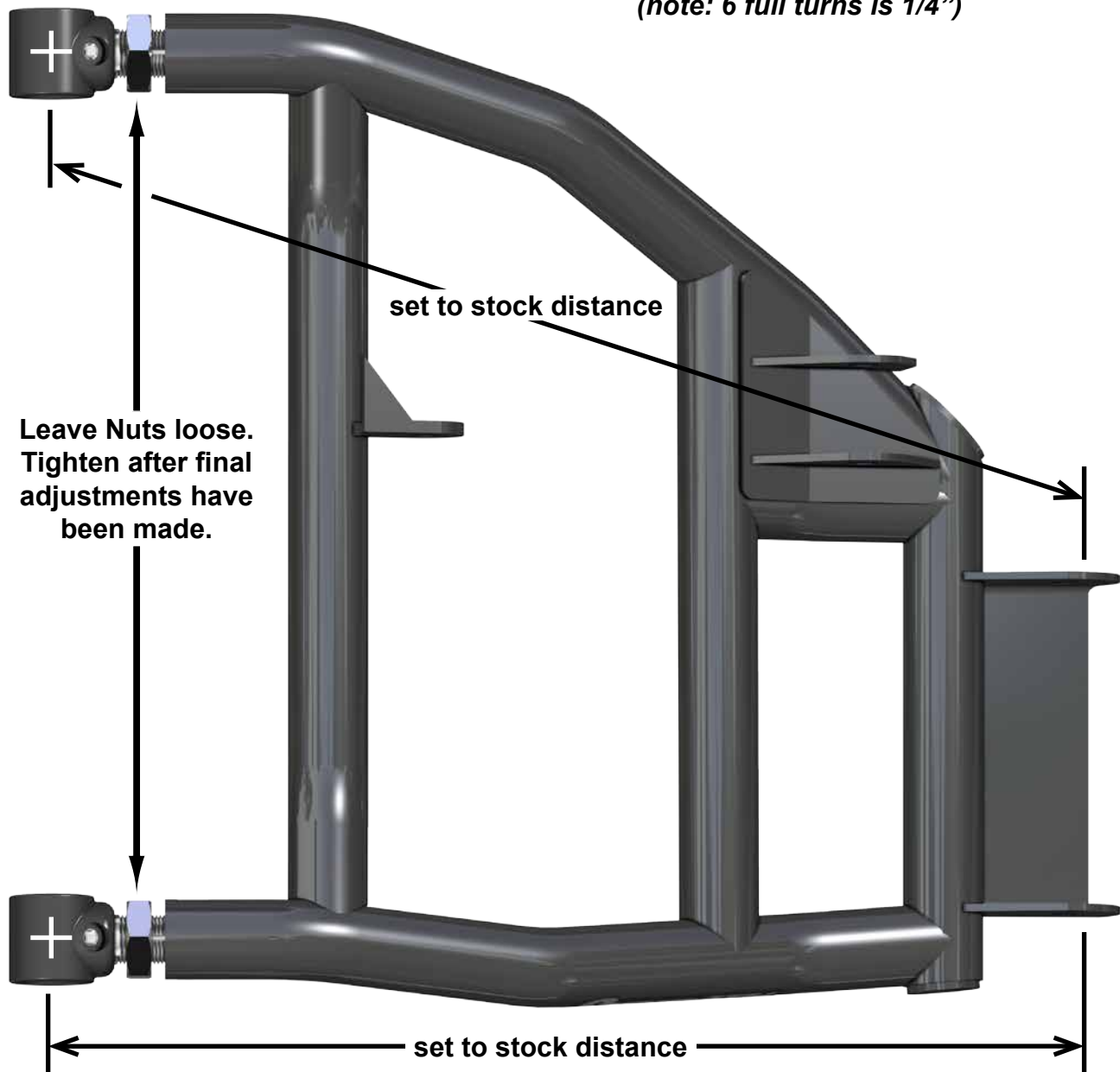

**TAKE ALL MEASUREMENTS FROM CENTER OF PIVOT TUBE
TO CENTER OF BOLT HOLES AT END OF ARM.**

Install A-Arms (A-D) to Frame with stock hardware Fig. 3

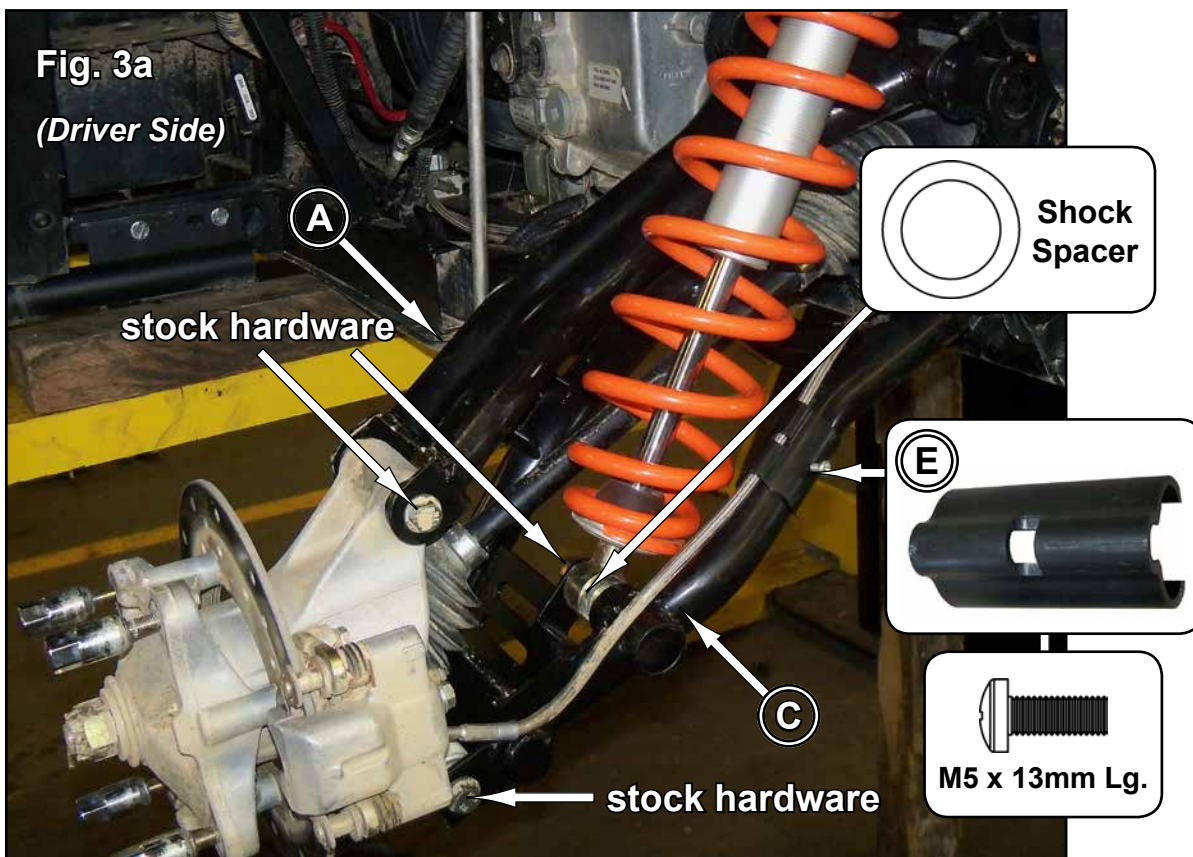

Sway Bar Link Installation

- Install Sway Bar Links (F) to stock Sway Bar with Bushings and hardware shown.
- Install Sway Bar Links (F) to Lower A-Arms (C)(D) with hardware shown.
- Tighten all hardware completely.

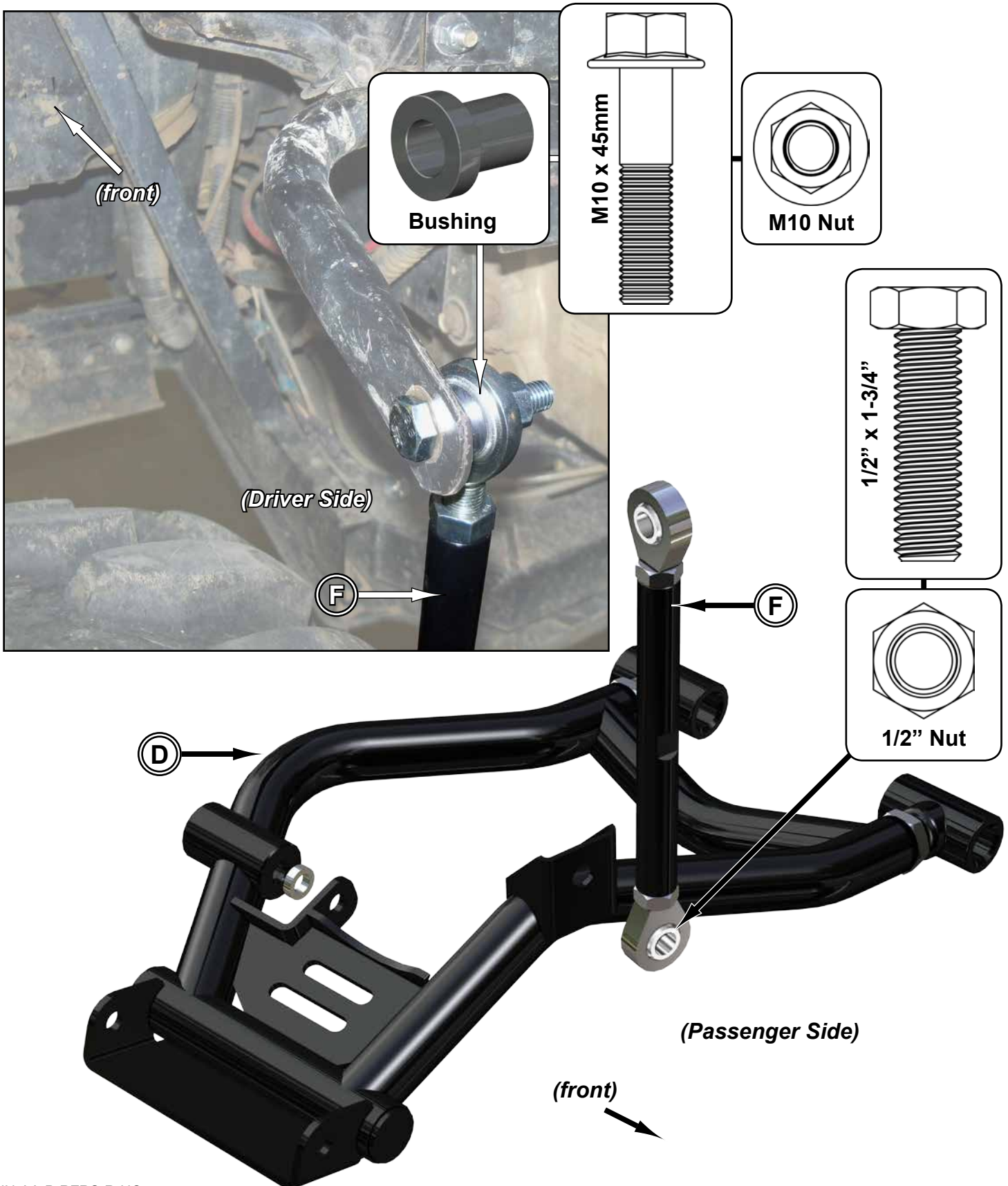

FRONT TIRES MUST HAVE EQUAL AIR PRESSURE BEFORE MAKING ANY ADJUSTMENTS.

CAMBER



Perform adjustments in small increments.



Adjustments are to be made after all suspension components have been completely assembled.
Tires must not be in contact with ground when making adjustments.

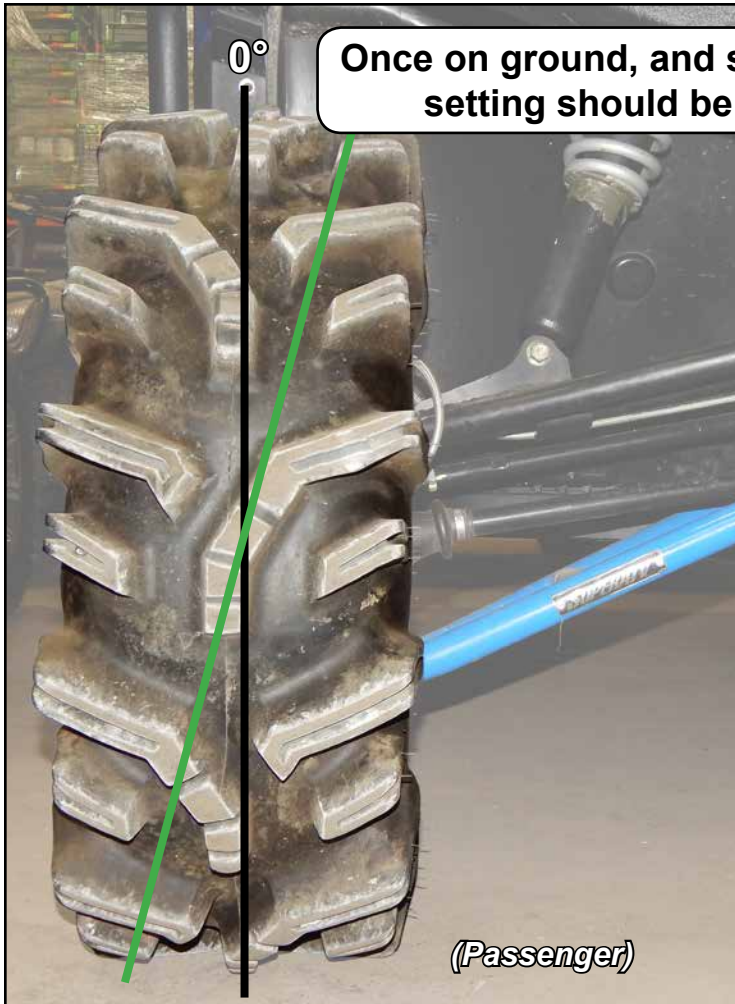

Once on ground, and suspension is settled,
setting should be: negative 1° - 2°

(Passenger)

1. Raise machine so that tires are off ground.
 2. Remove A-Arms from Frame and turn Pivot Blocks to adjust camber. Reinstall Arms.
 3. Lower machine and settle suspension components by rolling machine back and forth several feet at a time.
 4. Check settings and make small adjustments as needed.
- Each time an adjustment is made, machine must be rolled back and forth to settle suspension components.

Adjust Pivot Blocks, in or out, to achieve correct setting.
1 full turn, 360°, of Pivot Block is 1mm of adjustment.
(note: 6 full turns is 1/4")

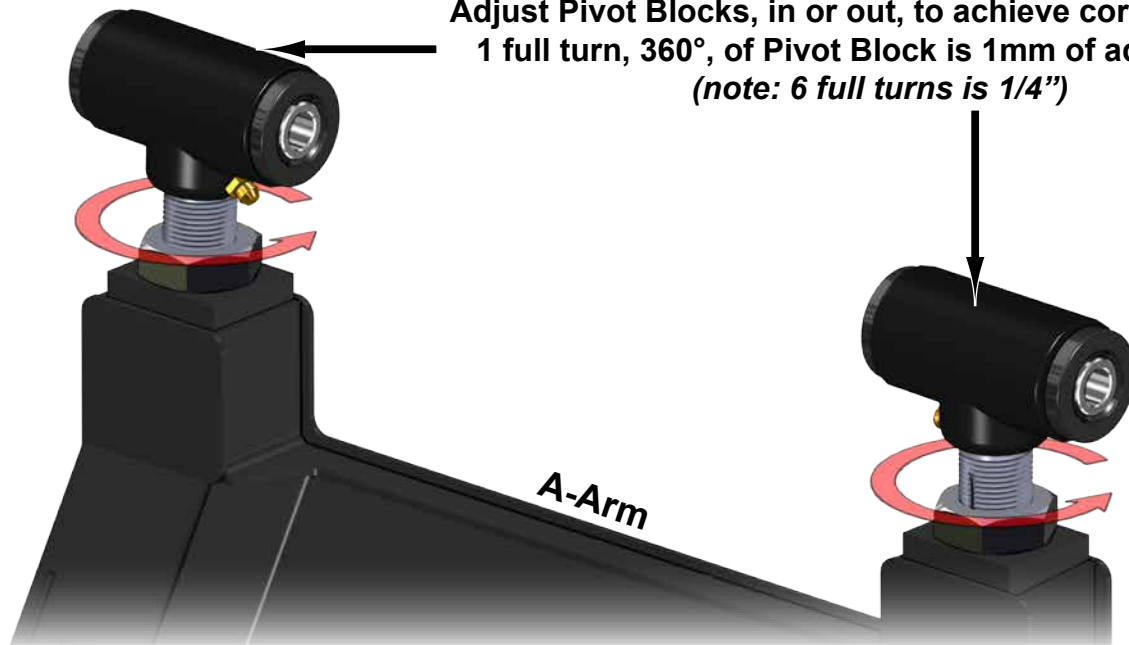

Liability Statement

SuperATV's® products are designed to best fit user's ATV/UTV under stock conditions. Adding, modifying, or fabricating any factory or aftermarket parts will void any warranty provided by SuperATV® and is not recommended. SuperATV's® products could interfere with other aftermarket accessories. If user has aftermarket products on machine, contact SuperATV® to verify that they will work together.

Although SuperATV® has thousands of satisfied customers, user should be aware that installing lift kits, long travel, or suspension kits, tires, etc. will change the ride of machine and may increase maintenance and part wear. Operating any off-road machine while, or after, consuming alcohol and/or drugs increases risk of bodily harm or death. No warranty or representation is made as to this product's ability to protect user from severe injury or death. SuperATV® urges operators and occupants to wear a helmet and appropriate riding gear at all times.

By purchasing and installing SuperATV® products, user agrees that should damages occur, SuperATV® will not be held responsible for loss of time, use, labor fees, replacement parts, or freight charges. SuperATV®, nor any 3rd party, will not be held responsible for any direct, indirect, incidental, special, or consequential damages that result from any product purchased from SuperATV®. The total liability of seller to user for all damages, losses, and causes of action, if any, shall not exceed the total purchase price paid for the product that gave rise to the claim.

SuperATV® will warranty only parts provided by SuperATV®. Any damage or problems with OEM housings, bearings, seals, or other manufacturers' products will not be covered by SuperATV®. SuperATV® parts and products are not warrantied if item was not installed properly, misused, or modified.

Installing, adding, modifying, or fabricating any factory or aftermarket product to your ATV/UTV may violate certain local, state, and federal laws. Be advised that laws vary depending on town, city, county, state, etc. Use of certain products on public streets, roads, or highways may be in violation law. The Buyer is solely and exclusively legally and personally responsible for any violation of the law by the installation or use of the product. You must abide by all local, state, and federal laws, including but not limited to vehicle safety, traffic laws, and ordinances. It is your responsibility to know the laws and how they apply to you.

The Buyer is responsible to fully understand the capability and limitations of his/her vehicle according to manufacturer specifications, warnings and instructions and agrees to hold SuperATV® harmless from any damage resulting from failure to adhere to such specifications, warnings and/ or instructions. The Buyer is also responsible to obey all applicable federal, state, and local laws and ordinances when operating his/her vehicle while using this product, and the Buyer agrees to hold SuperATV® harmless from any violation thereof.