

Polaris Ranger Mid-Size (Round Tube) Rear Panel



Product Instructions | Part No: 2732

Application: Verify accessory fitment at Kolpin.com.

Before You Begin: Read these instructions and check to be sure all parts are accounted for. If any items are missing, do not return to the store. Call us at 1-877-956-5746 for assistance. Please retain these instructions for future reference and parts ordering information.

Dealers: Provide Instruction Manual to customer at time of purchase.

Tools Required: 4mm Hex Wrench or Socket, Torque Wrench

Product Contents:

Item	Description	Qty	Part Number
1	Rear Windshield Panel	1	
2	Clamp - 1.75" Diameter	8	
3	M6 x 18mm Button Head Screw	*24	K100137 (Qty 4)
4	M6 Lock Washer	*24	
5	M6 Domed Shoulder Washer	*16	
6	Rubber Clamp Spacer	4	K100189 (Qty 2)
7	M6 x 38mm Button Head Screw	6	K100178 (Qty 3)
8	M6 Lock Washer	6	
9	M6 Domed Shoulder Washer	6	
10	14mm Nylon Standoff	6	
11	M6 Shoulder Washer	**6	
12	M6 Lock Nut	**6	

* Extra Component Quantity Supplied

** Component Not Used

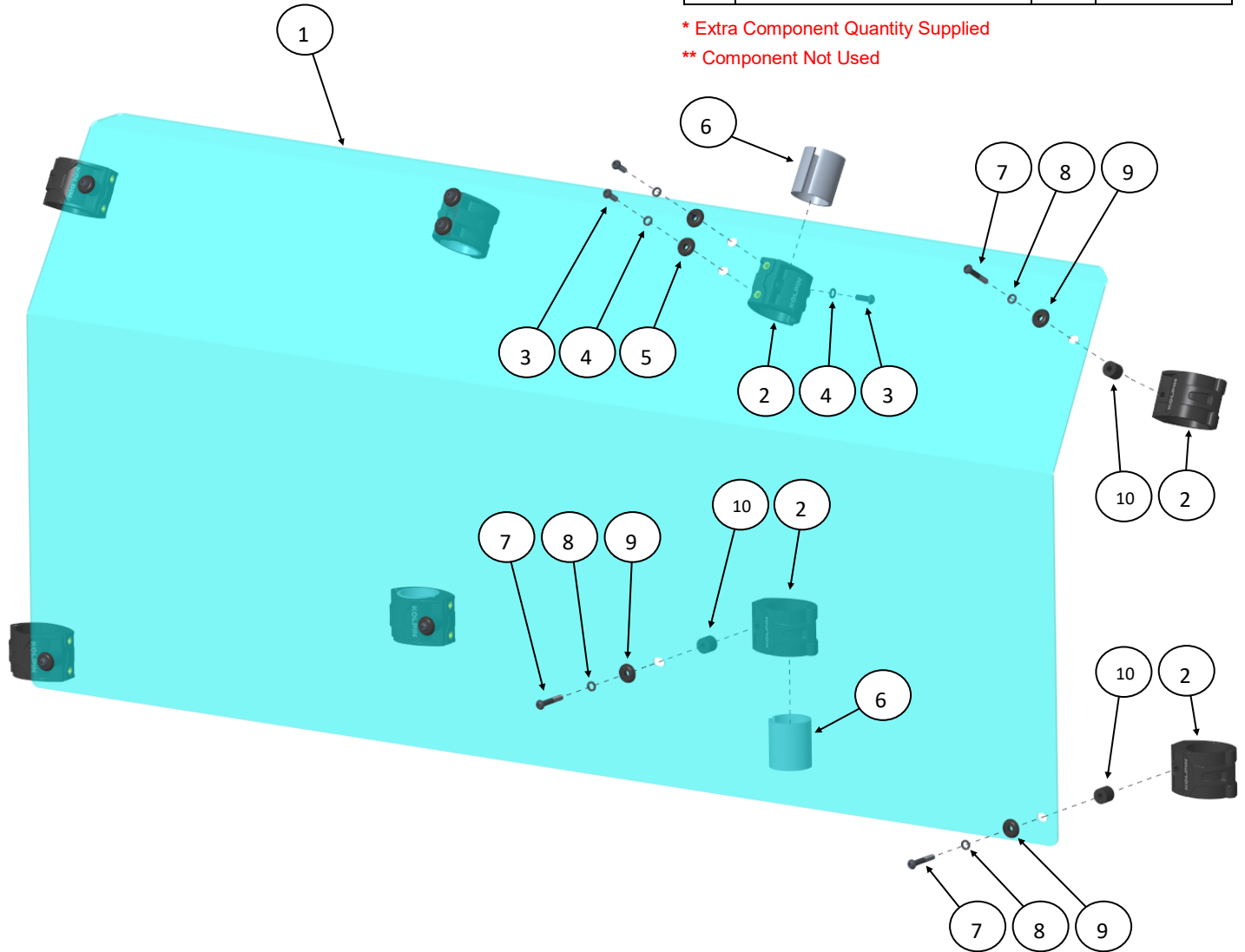

Kolpin Outdoors, Inc. | 9955 59th Ave N | Plymouth, MN 55442

(877) 956-5746 or (763) 478-5800 | www.kolpin.com | customerservice@kolpin.com

Assembly Time: Approximately 25 minutes

Important: This product is exclusively designed for your vehicle. Please read the installation instructions thoroughly before beginning. Installation is easier if the vehicle is clean and free of debris. For your safety, and to ensure a satisfactory installation, perform all installation steps correctly in the sequence shown.

Installation Instructions:

1. Shift vehicle transmission into PARK. Turn key to OFF position and remove from vehicle.
2. Carefully remove Rear Windshield Panel from the box and place on a clean flat surface that won't scratch the Windshield. To protect the Windshield Panels during assembly, only peel back the protective film in areas where the Mounting Components attach. There is film on both sides.
3. Attach the two upper Clamps [Item 2] to the bars in the center of the Roll Cage. The Kolpin logo on the Clamps should face the outside of the vehicle. Each Clamp uses one Rubber Clamp Spacer [Item 6], one M6 Lock Washer [Item 4] and one M6 x 18mm Button Head Screw [Item 3]. Do not fully tighten Clamps, exact position may need to be adjusted. See Illustration 1-1.
4. Attach the Rear Windshield Panel [Item 1] to the two Clamps on the Roll Cage from Step 3. Each Clamp uses two M6 Domed Shoulder Washers [Item 5], two M6 Lock Washers [Item 4], and two M6 x 18mm Button Head Screws [Item 3]. Do not fully tighten, exact position may need to be adjusted. See Illustration 1-2.
5. Attach the two lower Clamps [Item 2] to the bars in the center of the Roll Cage. The Kolpin logo on the Clamps should face the rear of the vehicle. Each Clamp uses one Rubber Clamp Spacer [Item 6], one 14mm Nylon Standoff [Item 10], one M6 Domed Shoulder Washer [Item 9], one M6 Lock Washer [Item 8] and one M6 x 38mm Button Head Screw [Item 7]. Do not fully tighten, exact position may need to be adjusted. See Illustration 1-3.

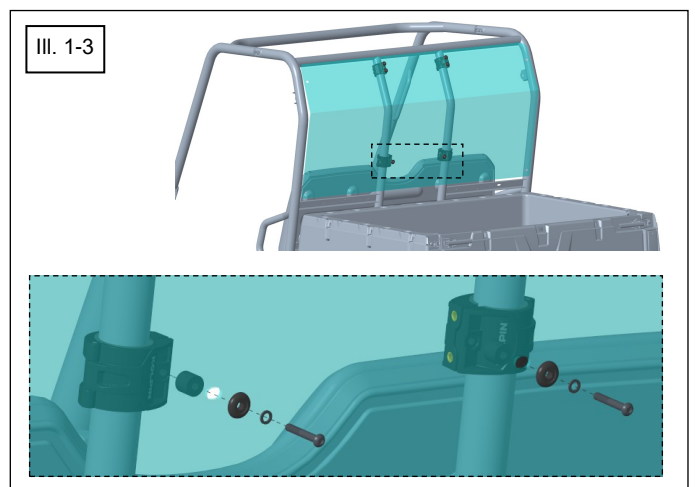
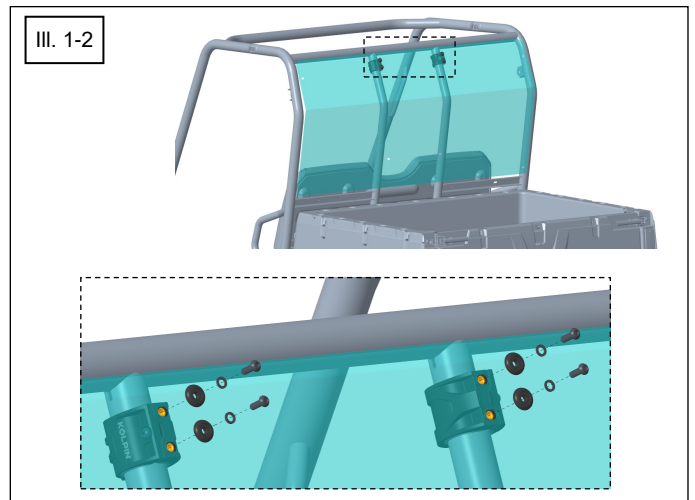
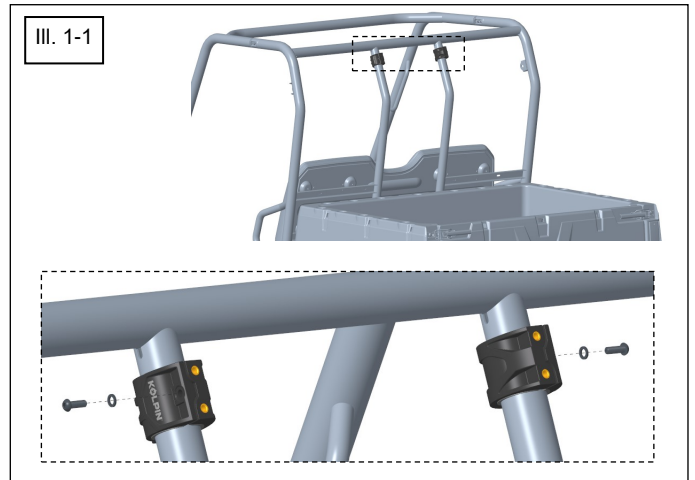

Kolpin Outdoors, Inc. | 9955 59th Ave N | Plymouth, MN 55442

(877) 956-5746 or (763) 478-5800 | www.kolpin.com | customerservice@kolpin.com

6. Attach the lower driver side Clamp [Item 2] to the Roll Cage. The Kolpin logo on the Clamp should face the rear of the vehicle. Each Clamp uses one 14mm Nylon Standoff [Item 10], one M6 Domed Shoulder Washer [Item 9], one M6 Lock Washer [Item 8] and one M6 x 38mm Button Head Screw [Item 7]. Do not fully tighten, exact position may need to be adjusted. See Illustration 1-4.
7. Repeat Step 6 for the upper driver side Clamp. See Illustration 1-4.
8. Repeat Steps 6 & 7 for the upper and lower passenger side Clamps. See Illustration 1-5.
9. Adjust position and alignment of Rear Windshield Panel as necessary and tighten all Hardware to the specified torque below.

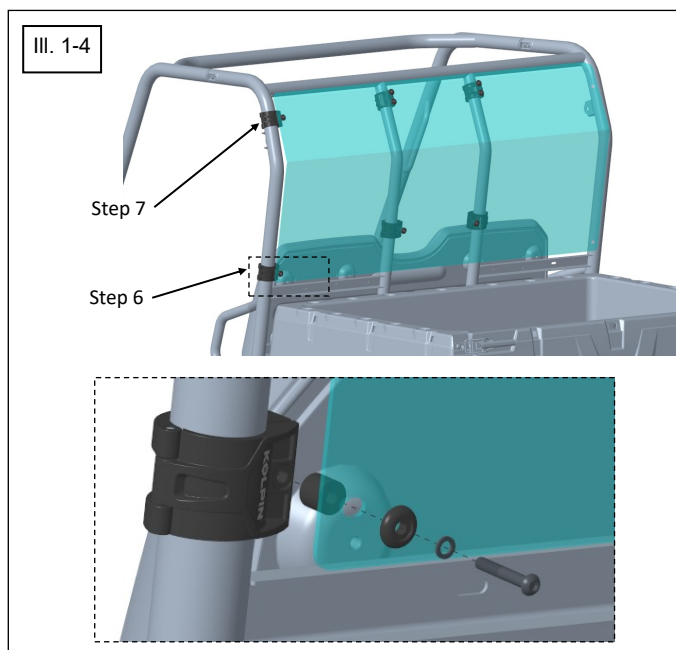

 = T
SPECIFIED FASTENER TORQUE:
7 ft. lbs. (84 in-lb) (9.5 Nm)

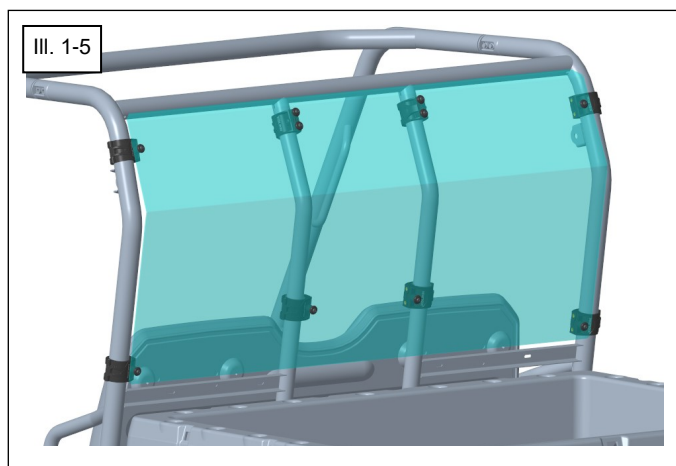

10. The remaining hardware components can be discarded.
11. Remove the protective film from **BOTH** sides of the Windshield Panel. Protective film may be clear on one or both sides which can be difficult to see.
12. Re-inspect hardware before and after riding or trailering.



DANGER



TO AVOID SERIOUS INJURY OR DEATH:

1. DO NOT TRAILER VEHICLE FACING REARWARD WITH WINDSHIELD INSTALLED. AIRFLOW MAY CAUSE WINDSHIELD TO SEPARATE FROM VEHICLE, RESULTING IN AN ACCIDENT AND SEVERE INJURY OR DEATH. REMOVE WINDSHIELD OR TRANSPORT VEHICLE IN ENCLOSED TRAILER.
2. UTVs ARE TO ONLY BE DRIVEN WITH CLEAN WINDSHIELDS FOR DRIVING VISIBILITY. IF DIRT OR DEBRIS ACCUMULATES ON THE WINDSHIELD WHEN RIDING, STOP THE UTV AT THE NEXT SAFE LOCATION ON THE TRAIL TO CLEAR OFF THE WINDSHIELD BEFORE YOU RESUME RIDING.
3. ONLY INSTALL WINDSHIELDS THAT ARE DESIGNED FOR THE MAKE AND MODEL OF THE UTV. INSTALLATION OF A WINDSHIELD THAT WAS NOT DESIGNED FOR THE UTV MAKE AND MODEL CAN IMPACT WINDSHIELD DURABILITY AND PERFORMANCE.
4. READ AND UNDERSTAND WINDSHIELD INSTRUCTION SHEETS AND UTV OWNER MANUAL BEFORE WINDSHIELD INSTALLATION OR OPERATING THE VEHICLE.
5. PERIODICALLY CHECK FOR WEAR AND TIGHTNESS OF ALL FASTENERS. ALWAYS INSPECT BEFORE AND AFTER RIDING OR TRAILERING. REPLACE OR RE-TORQUE FASTENERS AS NECESSARY.

Windshield Cleaning Information:

- Remove all dirt, mud, dust and debris from Windshield with water before cleaning.
- Use a mild soap or dishwashing detergent along with a soft sponge or soft cotton cloth to clean Windshield surface. Do not apply in direct sunlight. Rinse with water immediately and dry with a soft cotton cloth or chamois.
- Always test cleaning agents in a small inconspicuous area prior to cleaning entire panel.
- Never use Windshield cleaning fluids (409, Windex, etc.), gasoline, high alkaline cleaners, or solvents.
- Never use abrasives, brushes, razor blades, scrapers, squeegees, gloves or dirty cloths.

For additional assistance, please contact Kolpin customer service department at (877) 956-5746 or (763) 478-5800 or email customerservice@kolpin.com.

One Year Limited Warranty

For the period of one (1) year from the purchase date, Kolpin will replace for the original purchaser, free of charge, any part or parts found upon examination by Kolpin to be defective in material, workmanship, or both.

All transportation costs incurred submitting product to Kolpin for warranty consideration must be borne by the purchaser. If Kolpin determines that the product must be returned to the factory for credit, please call 1-877-956-5746 for a Return Merchandise Authorization (RMA) number and shipping instructions.

This warranty does not apply to parts that have been damaged by accident, alteration, abuse, improper maintenance, normal wear, or other causes beyond the manufacturer's control. In order to protect you and your ATV, certain parts of the accessory system and/or hardware are designed to fail when the equipment is over-stressed. Parts that are lost due to loosening and improper maintenance are not covered under warranty. This warranty does not cover removal or reinstallation labor fees of the plow system and related components.

Peripheral products such as engines, electric motors, and actuators may carry an original manufacturer's warranty. Most hardware is general in nature and is easily obtained locally. Be sure to replace with minimum metric class 8.8 specification.