

EZ CANOE CARRIER

Model # 44-0102



PARTS LIST	
Qty	Name
4	Foam Block
1	15' Cinch Strap
2	Bow & Stern Tie Down
1	Mesh Storage Bag



15' CINCH STRAPS



FOAM BLOCKS



**BOW & STERN
TIE DOWNS**

SAFETY INFORMATION

Suspenz is very serious about safety. It is critical that you properly mount the foam blocks to your boat and vehicle. Failure to do so could result in serious bodily injury or property damage. Before assembly please read the manual completely. Be sure that you have all the parts and that they are not damaged in any way. Do not modify the blocks in any manner. Check to make sure that both the blocks and kayak are secure before driving. Periodically inspect the blocks and all parts for signs of wear or damage.

 This symbol in the instructions indicates an important warning. Please heed these warnings. 12/2017

SUSPENZ, INC.
8725 ROSWELL ROAD #0-220
ATLANTA GA 30350



CUSTOMER SERVICE: 770-518-0045
FAX: 770-518-8507
WEBSITE: WWW.SUSPENZ.COM

Assembly

1. Snap two foam blocks on each side of canoe gunwales. Space the blocks about 42" apart and centered.
2. Adjust block spacing to maximize spacing and avoid the sunroof if present.



Loading

1. Make sure bottom of blocks are clean and free of debris.
2. Center canoe bottom up on vehicle. Do not place blocks on sunroof.



Secure

1. Open vehicle doors. Toss non-buckle end of 15' cinch strap over the center of canoe and pull both ends through doors. Close doors.
2. Thread end of strap through buckle and pull tight.

Note: Putting a couple of twists in the strap before threading into buckle will reduce wind noise.



Secure Bow & Stern Tie Downs

Attach S-hook to grab handles on both ends of canoe & secure ratcheting hook to metal frame of vehicle.

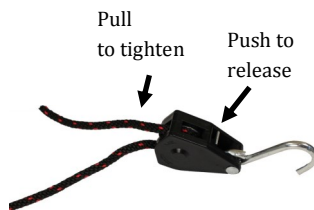

 **New straps & ropes stretch!** For the first few weeks of use, check to make sure straps are tight every 30 minutes of driving.



WARNINGS

- Do not exceed load limits for your vehicle.
- Holds one canoe.
- Always tie down the bow & stern of canoe to vehicle steel frame, never the plastic bumper.
- Before each use, inspect blocks and straps and tighten if necessary - these can loosen over time.
- Use caution when opening your hatch - longer canoes may prevent the hatch from fully opening.
- Roof antenna may need to be removed to prevent interference with longer kayaks.
- Remove canoe before entering an automatic car wash.
- Do not let children play on blocks.
- To clean, use a soft cloth with water and mild detergent to clean parts.
- Suspenz is not responsible for any damage.

FOR TECHNICAL ASSISTANCE OR REPLACEMENT PARTS: CALL 866.787.7369

OUR PLEDGE TO YOU

Suspenz® products are warranted for life against defects in material or workmanship to the original owner. Product must be used for its intended purpose under normal conditions. Please visit www.Suspenz.com for complete warranty information.

SUSPENZ, INC.
8725 ROSWELL ROAD #0-220
ATLANTA GA 30350



CUSTOMER SERVICE: 770-518-0045
FAX: 770-518-8507
WEBSITE: WWW.SUSPENZ.COM