

**Bead Color/# Needed:**

- Red - 145
- Black - 8
- White - 12
- Clear - 6

**Instructions**

1. Use the large square and small hexagon pegboards for your project. If you're using a clear pegboard, slide the actual-size pattern underneath it. Place all the beads for the design.
2. Cover the completed design with the ironing paper. Keeping the iron level, gently iron the beads in a circular motion for about 10 seconds to fuse the beads evenly. Ironed properly, the beads will still have an open center. On a 3-D project such as this, DO NOT OVER-IRON the beads as it will make the centers of the beads close and can make assembly difficult.
3. Once the design is cool, peel off the ironing paper. Lift your design from the pegboard; flip the design over and repeat step #2. Your pegboard and ironing paper are reusable.

Continued on next page

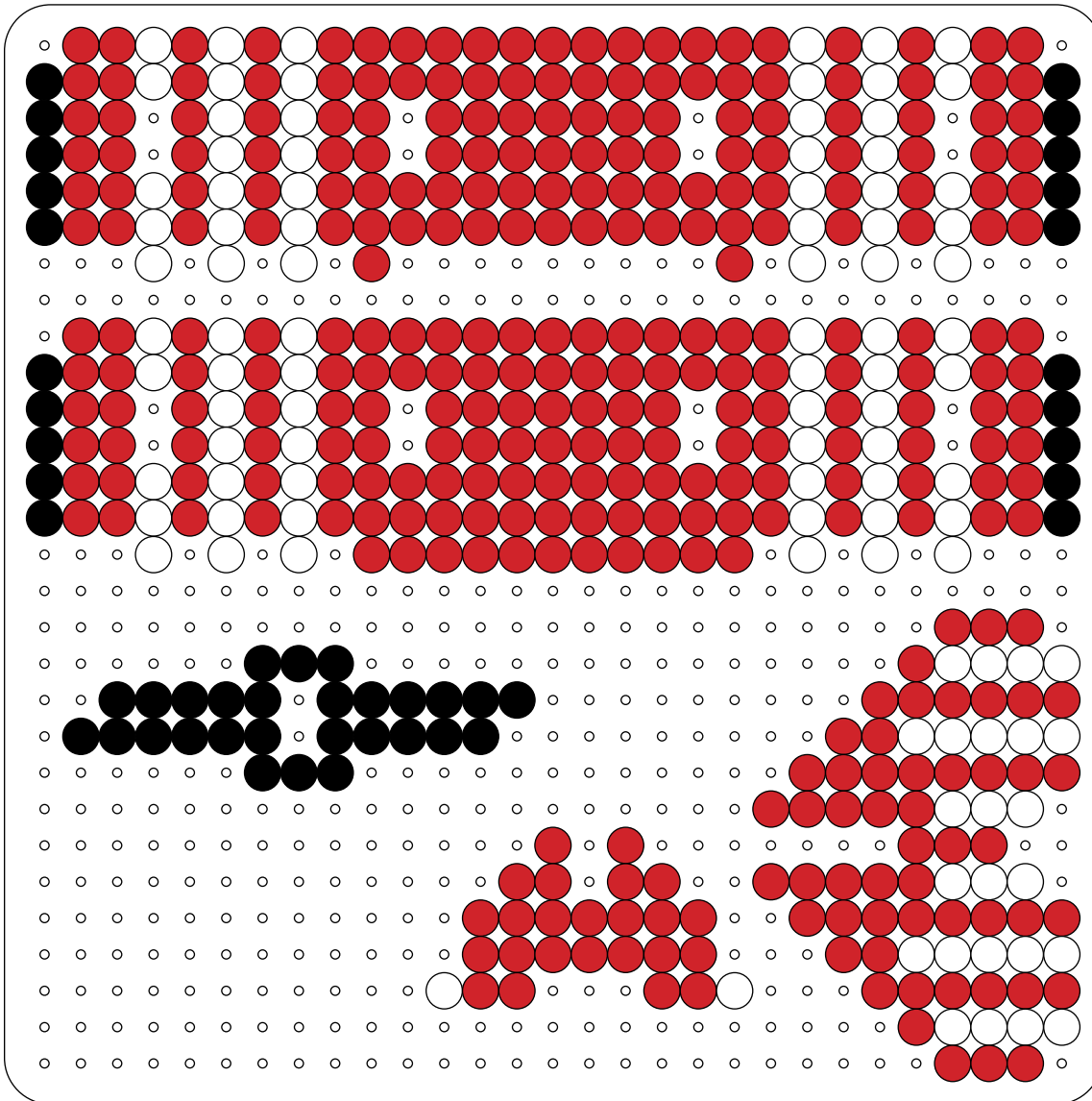

- Bead Color/# Needed:**
- Red - 370
  - Black - 60
  - White - 138

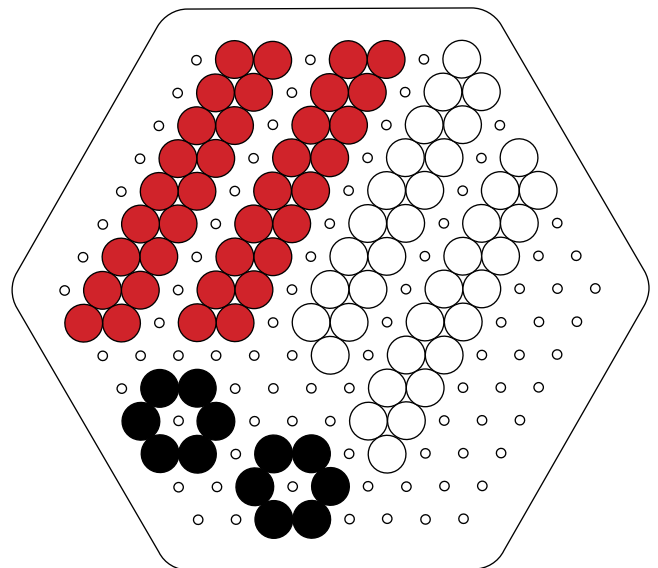

Continued on next page

# Assembly

1

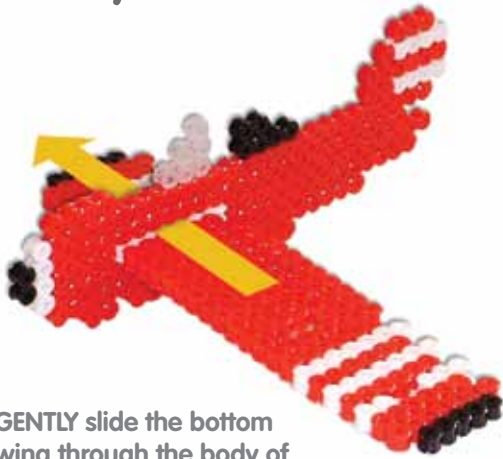

GENTLY slide the bottom wing through the body of the plane.

2

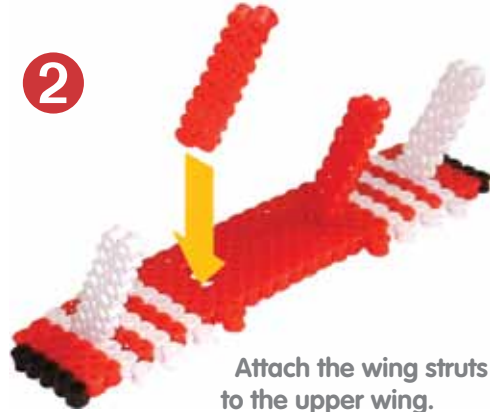

Attach the wing struts to the upper wing.

3



Attach the upper wing to the lower wing.

4



Slide on the propeller and tail fin.

5

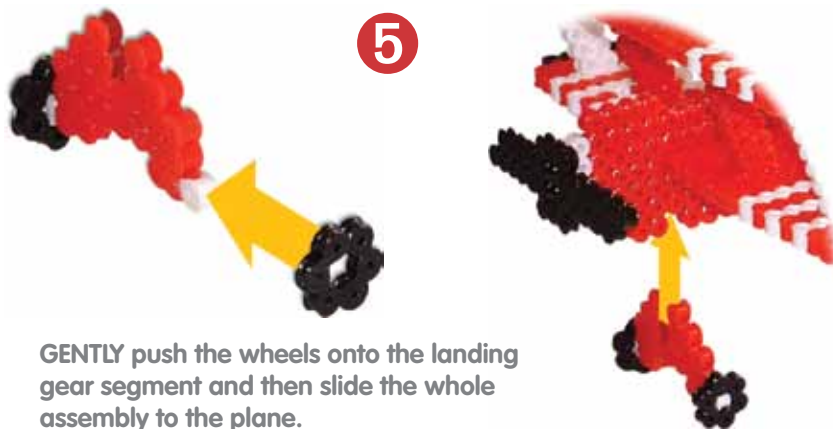

GENTLY push the wheels onto the landing gear segment and then slide the whole assembly to the plane.