

MAZDA ND MIATA COILOVER INSTRUCTIONS (KONI / OEM)

GROUND CONTROL

www.groundcontrolstore.com
3885 Dividend Drive
Shingle Springs, CA 95682
(530)677-8600 fax (530)677-9090

WRAP ELECTRICAL TAPE AROUND BODY OF SHOCK BEFORE INSTALLING THREADED TUBE

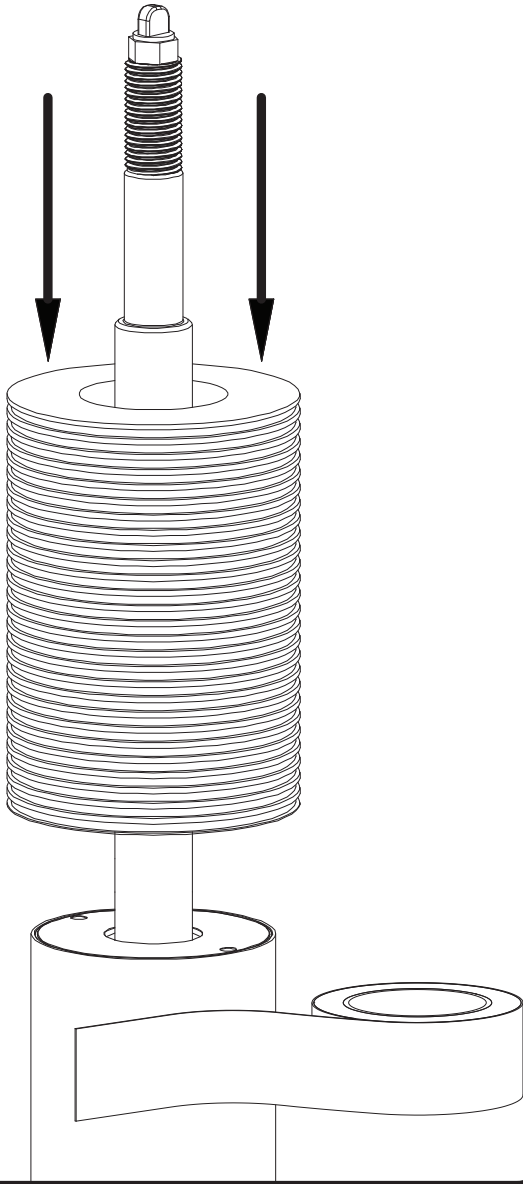

CUT BUMP STOP 1.5 INCHES FROM TOP AND DISCARD LOWER PORTION

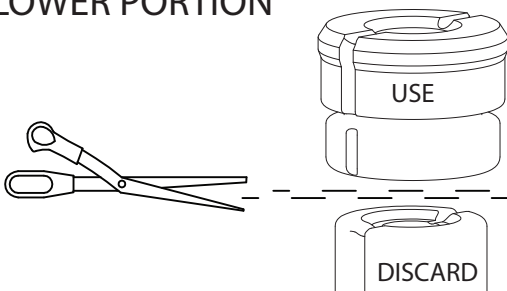

FRONT

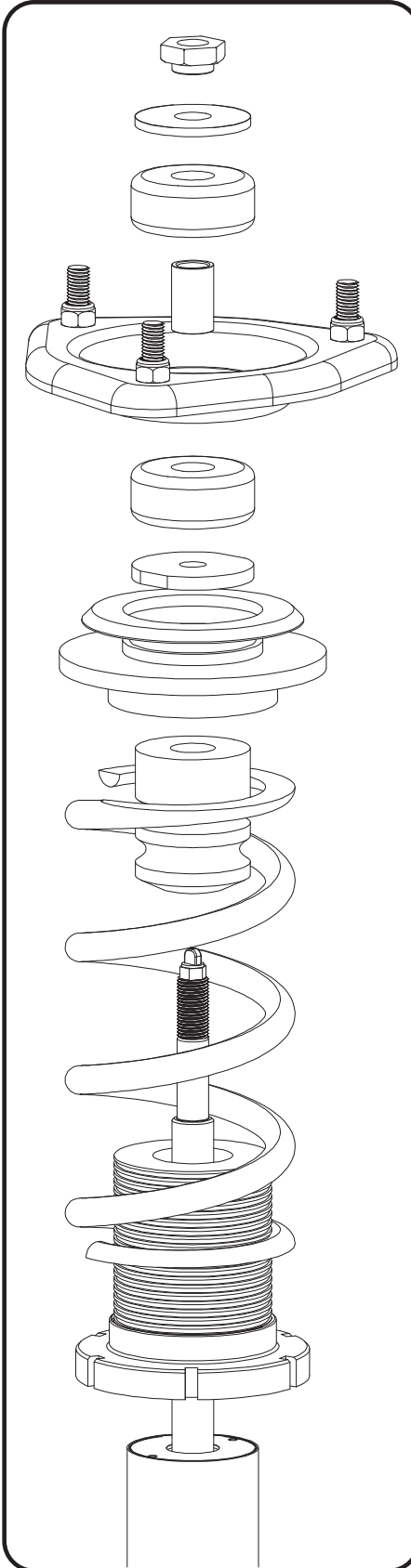

REAR

