

S550 MUSTANG PLATE INSTRUCTIONS

- PART **A** IS ABOVE THE STRUT TOWER
- PART **B** IS BELOW THE STRUT TOWER

PASSENGER VIEWS

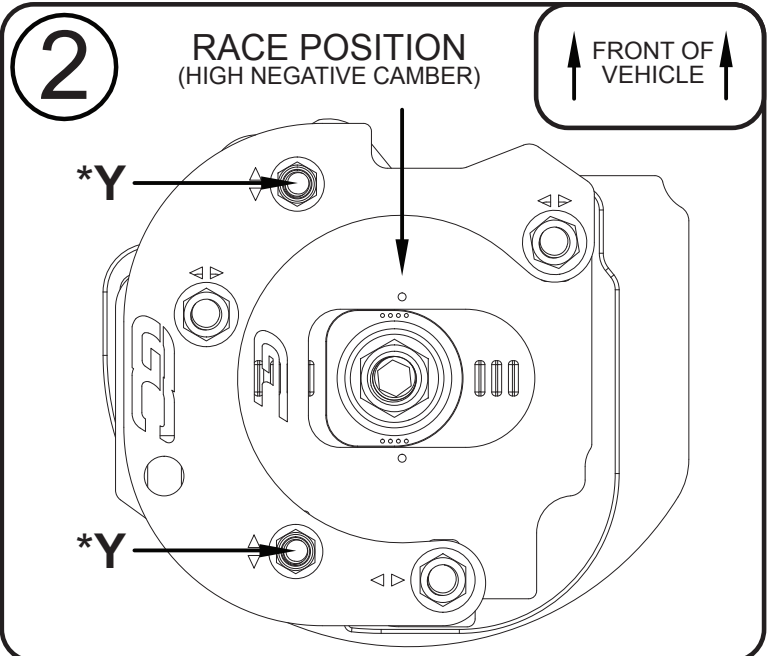
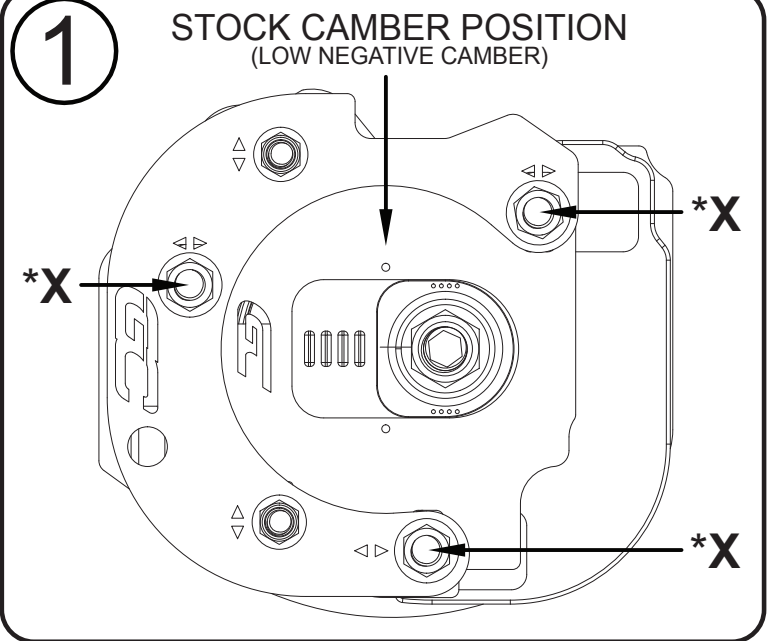
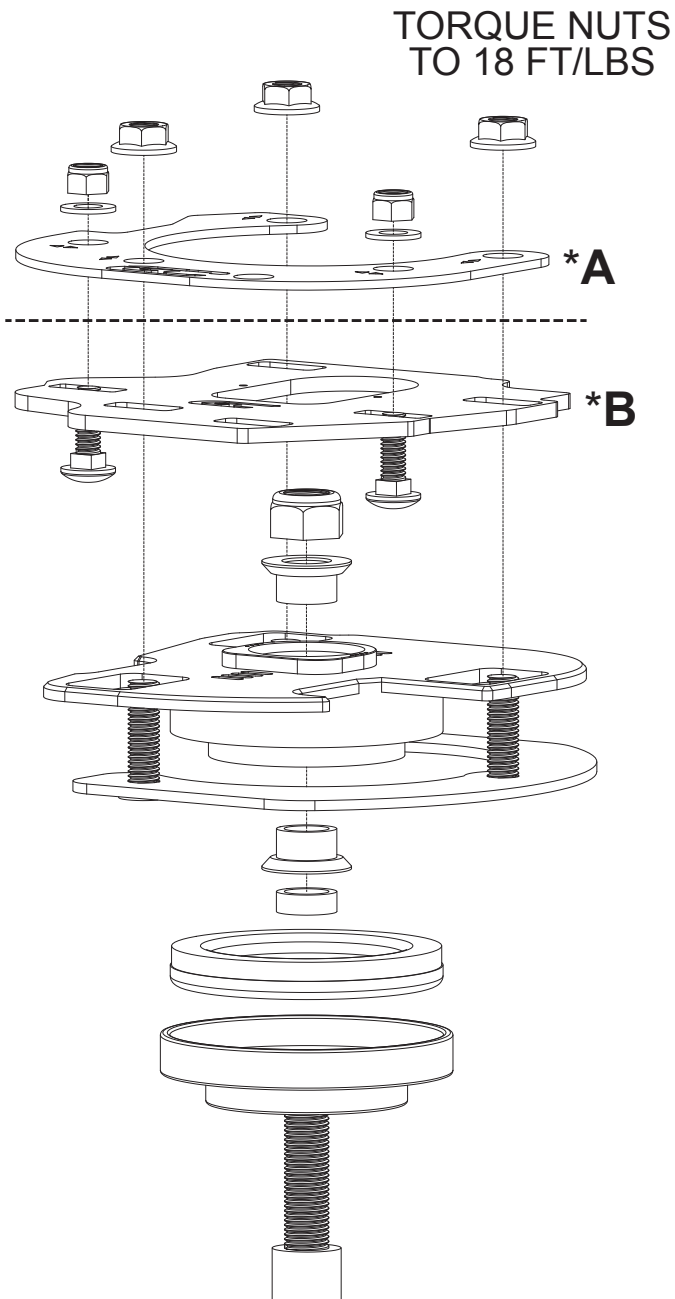

- CAMBER AND CASTER ADJUSTMENTS ARE MADE SEPARATELY
- ADJUST CASTER BY LOOSENING NUTS MARKED **X** AND **Y** IN EXAMPLES 1 AND 2

GROUND CONTROL

www.groundcontrolstore.com
3885 Dividend Drive
Shingle Springs, CA 95682
(530)677-8600 fax (530)677-9090

- ADJUST CAMBER BY LOOSENING NUTS MARKED **X** IN EXAMPLE 1