

MK7 VW CAMBER PLATE INSTRUCTIONS

- PART **A** IS ABOVE THE STRUT TOWER
- PART **B** IS BELOW THE STRUT TOWER
- PART **C** IS SUPPLIED WHEN USING STOCK SPRING
- PART **D & E** ARE SUPPLIED WHEN USING COILOVER SPRING

TORQUE NUTS
TO 18 FT/LBS

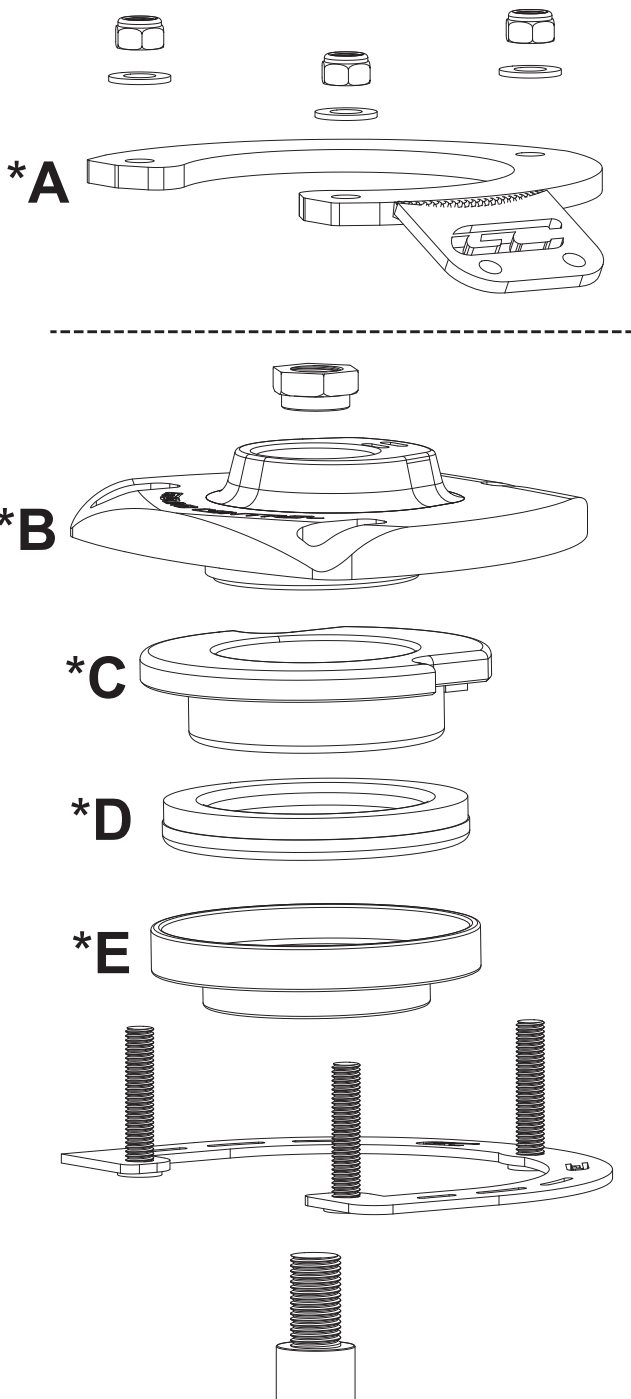

DRIVER SIDE TOP VIEWS

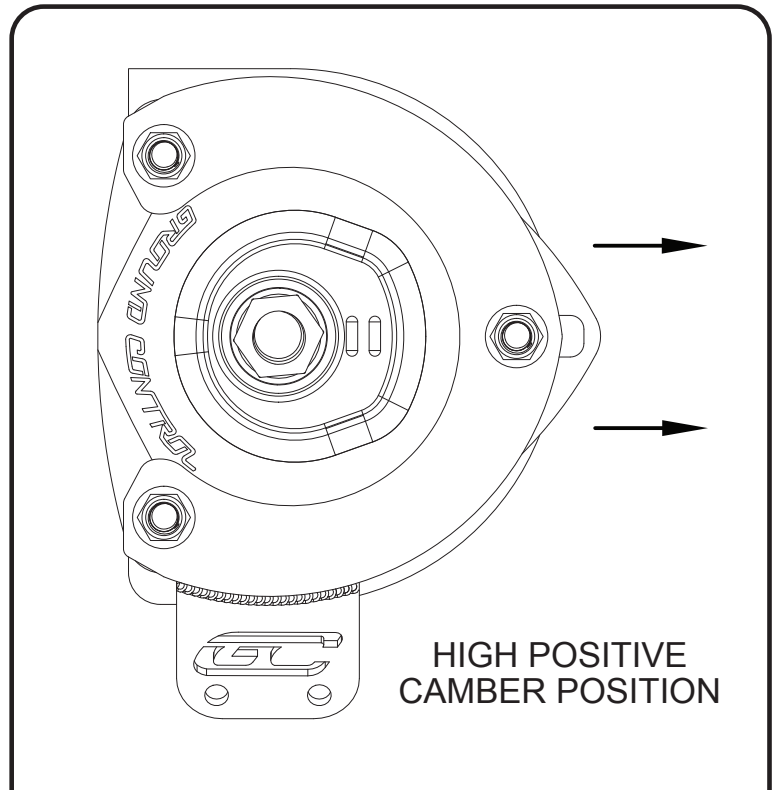
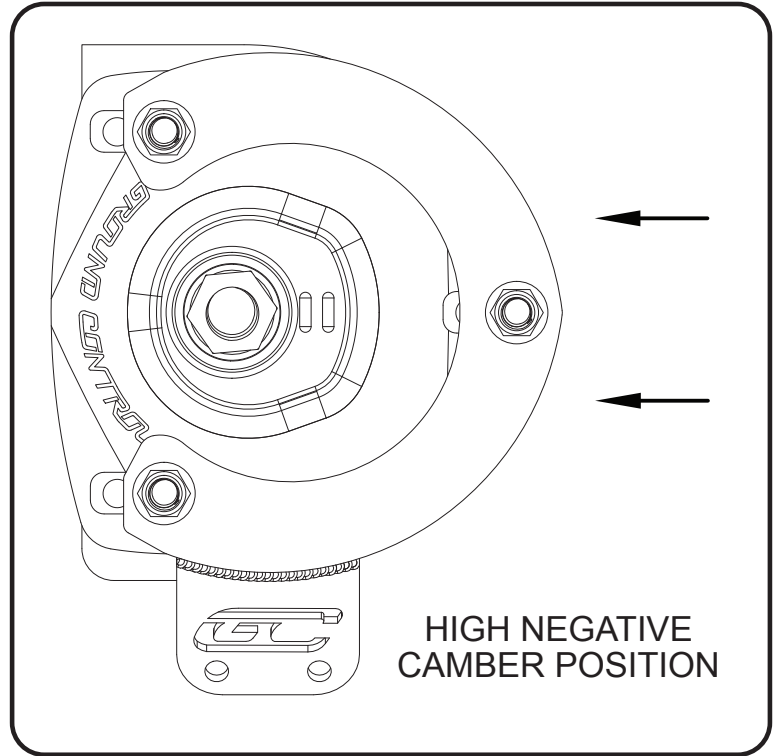

GROUND CONTROL

www.groundcontrolstore.com
3885 Dividend Drive
Shingle Springs, CA 95682
(530)677-8600 fax (530)677-9090

↓ FRONT OF VEHICLE ↓