

MK7 / MQB COILOVER INSTRUCTIONS

INSTALL SUPPLIED BEARING AND SPRING HAT ON OEM UPPER MOUNT

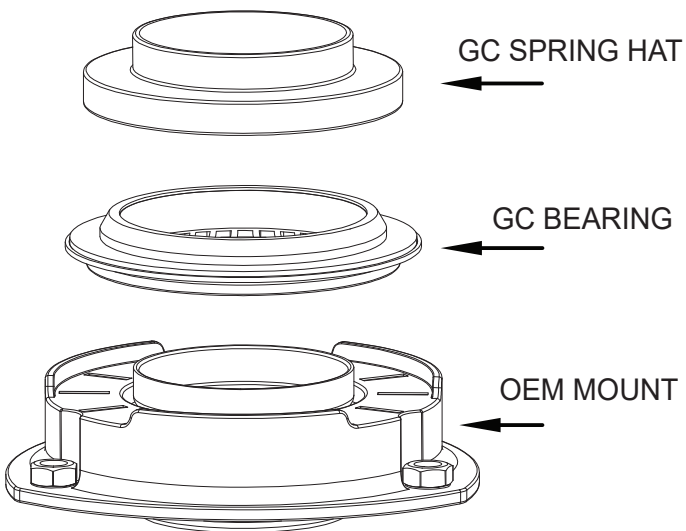

INSTALL STEEL RING AND O-RING BEFORE THREADED ADJUSTER

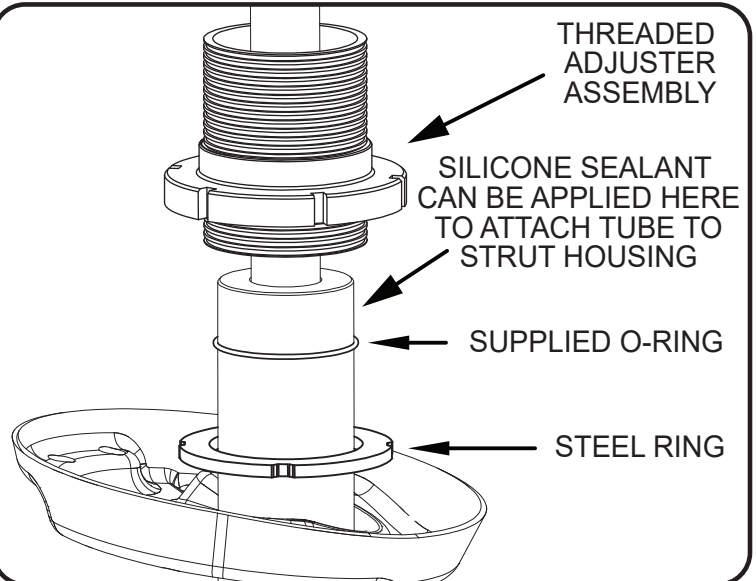

CUT BUMPSTOPS AS SHOWN BELOW
NOT REQUIRED ON 8S/8V TTRS/RS3

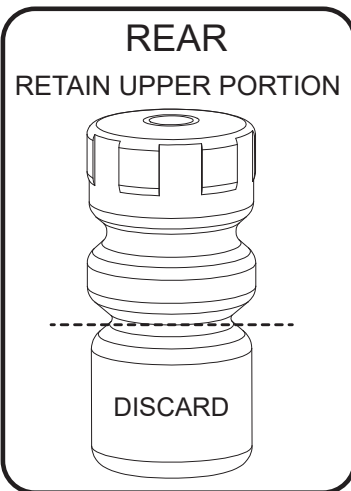
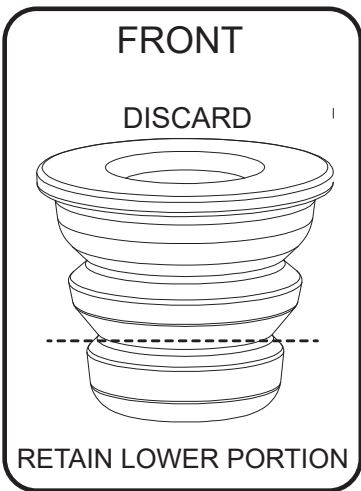

USE SNAP RING TO SECURE THE ASSEMBLY ON LOWER CONTROL ARM

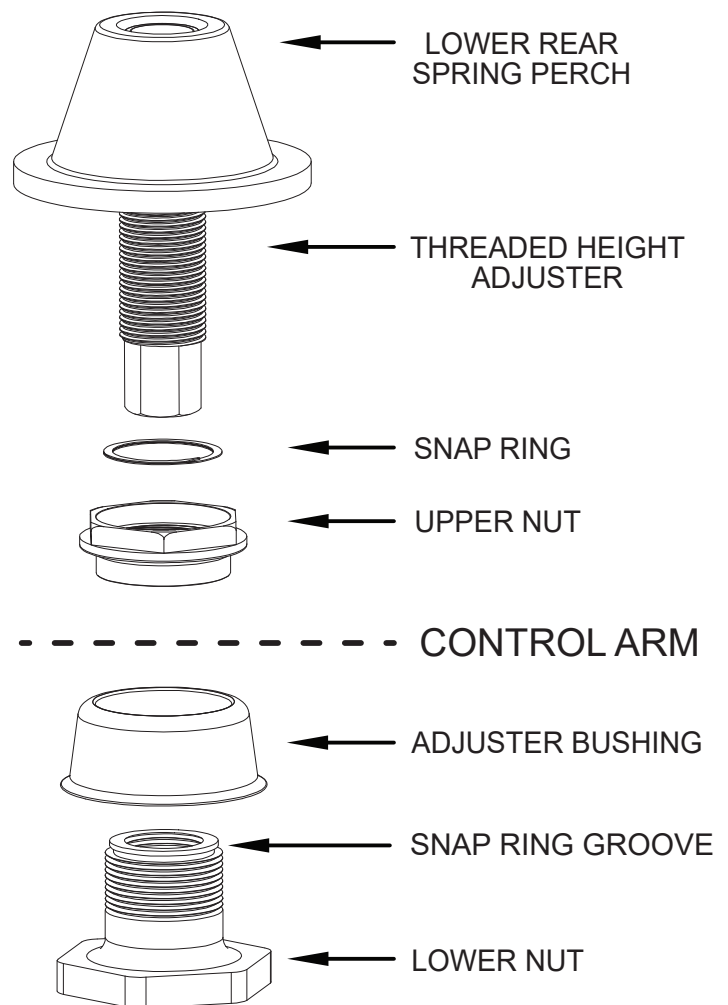

INSTALL UPPER REAR SPRING CONE WITH SUPPLIED HARDWARE

INSERT RUBBER PLUG THROUGH CONE AND INTO BODY OF CAR

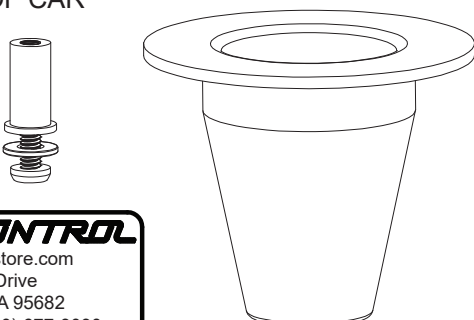

GROUND CONTROL

www.groundcontrolstore.com
3885 Dividend Drive
Shingle Springs, CA 95682
(530) 677-8600 Fax (530) 677-9090