

BMW E30 M3 FRONT

1

REMOVE STOCK SPRING PERCH BY CUTTING THROUGH THE HOUSING.

CUT JUST ABOVE WELD

1

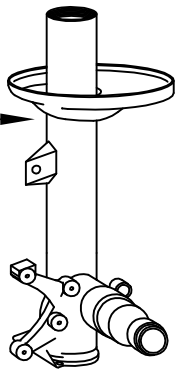

2

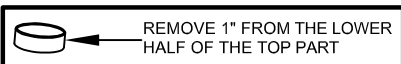

REMOVE 1" FROM THE LOWER HALF OF THE TOP PART

DISCARD SPRING PERCH SHORTEN HOUSING ONE INCH FROM TOP SECTION.

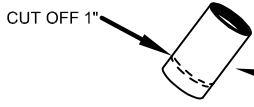

CUT OFF 1"

REMOVE THE ONE INCH PART FROM THE TOP SECTION

TRASH

2

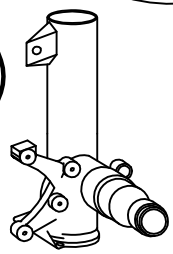

3

INSERT CARTRIDGE AND SPACER (IF NEEDED). LINE UP STRUT PIECES. TACK WELD, AND REMOVE THE CARTRIDGE BEFORE WELDING COMPLETELY.



STOCK GLAND NUT MUST BE 2" O.D. MAX

SPACER

4

WELD SPRING PERCH ONTO THE STRUT HOUSING TWO AND ONE HALF INCHES BELOW THE TOP, WITH THE FLAT EDGE FACING THE TIRE.

3

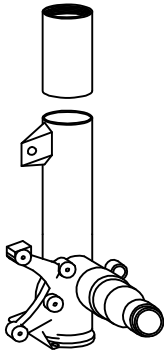

5

REINSTALL CARTRIDGE AND SPACER. IF STOCK GLAND NUT IS LARGE, IT MUST BE GROUND OR MACHINED DOWN TO 2" O.D.

2 1/2 INCHES

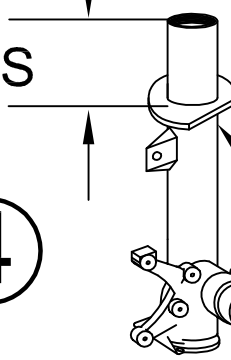

FLAT SIDE OF PERCH TOWARD SPINDLE

WELD TUBE FIRST THEN SPRING PERCH

6

INSTALL COIL OVER SLEEVE TO SIT ONTO SPRING PERCH, INSTALL AND TIGHTEN GLAND NUT.

GROUND CONTROL

www.ground-control.com
3885 Dividend Drive
Shingle Springs, CA 95682
(530)677-8600 fax (530)677-9090