

93-UP CAMARO / FIREBIRD FRONT

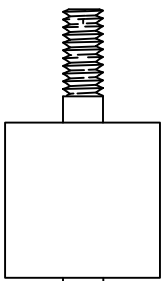
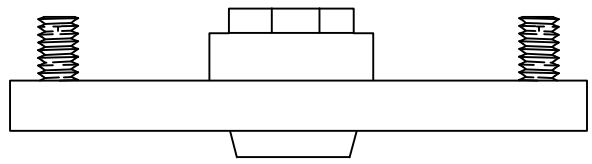

(KYB Shocks)
Grind Lip
Down to
2" Then
Install Red
Sleeve

← NEW
BUMP STOP

If Needed
Knock Off
Gold Cap and
Reinstall After
Tube is
Installed

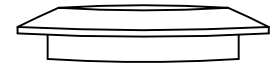
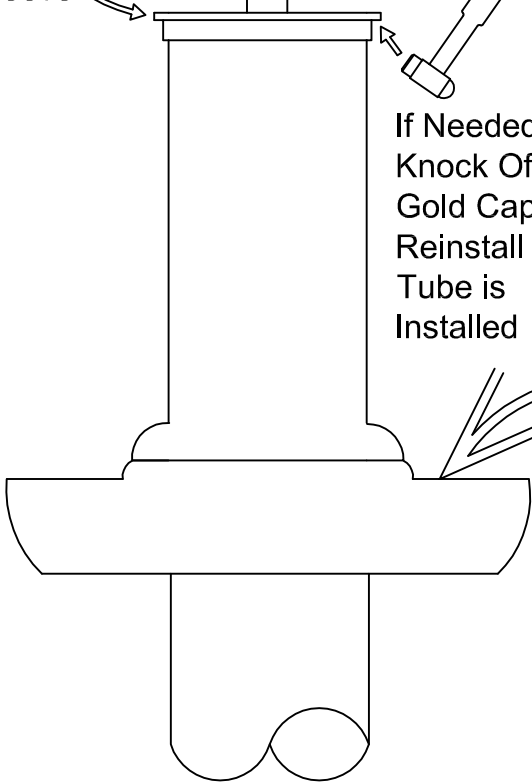

← SUPPLIED
ALUMINUM
TOP HAT

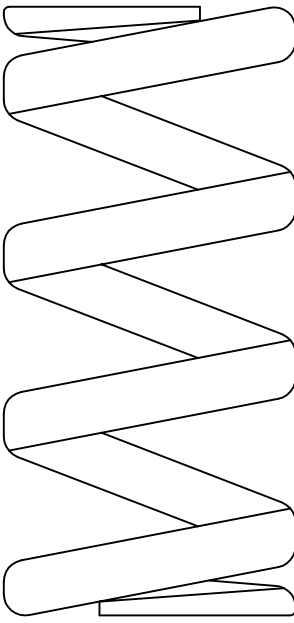

← SPRING

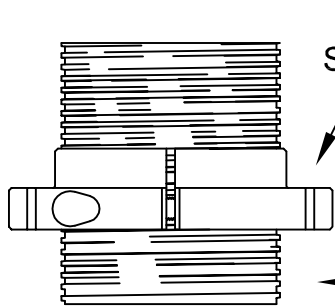

← ADJUSTABLE
SPRING PERCH

← THREADED
SLEEVE

GROUND CONTROL
www.groundcontrolstore.com
3885 Dividend Drive
Shingle Springs, CA 95682
(530)677-8600 fax (530)677-9090