

TK22 - 10/22 Takedown® Stock

IMPORTANT SAFETY WARNING

! This product is designed for use with the designated firearm only. Improper operation or misuse with your firearm could lead to personal injury or death of the operator or others. Safe firearms handling procedures must be practiced at all times.

Before handling the firearm with this product attached, read and understand the entire contents of your firearm manual and instructions, especially the safety precautions and procedures for safe firearms handling. Always practice safe firearms handling techniques. Failure to comply with correct safety precautions and safe firearms handling techniques can result in serious injury, damage to property or death.

Never point the firearm at anything or anyone that you don't intend to shoot. Always keep your finger outside the trigger guard and off the trigger until ready to fire. Always verify that the chamber of the firearm is empty or "clear" before attempting to mount or dismount this product. Follow the cleaning procedures as set forth in the manual of your firearm. Always remove this product from the firearm when performing maintenance or cleaning.

STOCK INSTALLATION

Remove Original Stock

1. With rifle pointing in a safe direction and fingers outside trigger guard, remove magazine, open bolt and confirm (visually and by touch) that chamber is empty. Allow bolt to close
2. Separate the stock. Loosen the rifle adjustment knob by turning it clockwise. Lock the bolt back, push the locking lever forward, and rotate the barrel assembly clockwise. Remove screws on bottom side of front and rear stock and set aside. Remove the factory barrel retention band on forend (not needed for installation)
3. Position rifle safety so equal amount of safety button is exposed on each side of receiver
4. Swing receiver assembly upward and forward (away) from factory stock. Be careful receiver cross pins and bolt stop pin do not fall out

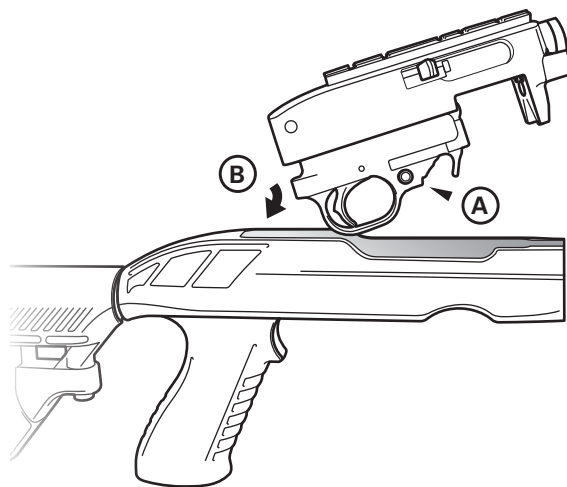

Install Takedown stock

1. Confirm an equal amount of safety button is exposed on each side of receiver (A).
2. Swing receiver assembly down and toward rear-stock (B). **NOTE:** Stock is engineered to be a tight fit. Final seating of receiver into stock is completed with tightening of bottom receiver screw in the following step.
3. Re-install rifle bottom screw (rear) and tighten (C).
4. Place barrel in stock forend. Re-install and tighten screw on bottom of forend (D).

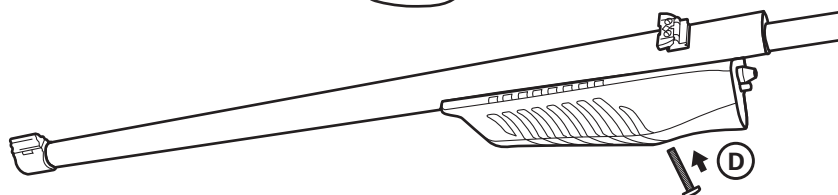
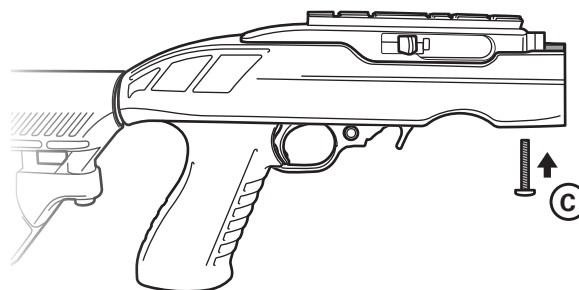

TK22 - 10/22 Takedown® Stock

CONNECT 10/22 TAKEDOWN RIFLE BARREL

Insert the barrel into the receiver, rotate clockwise until it clicks into place. You should feel some resistance when turning the barrel assembly, but it should not be difficult. **IMPORTANT:** If further adjustment is needed, remove the barrel and tighten or loosen the adjustment knob accordingly. Using finger pressure, tighten the adjustment knob by rotating it counterclockwise one or two (1-2) more clicks. Then reinstall barrel. *NOTE: Refer to Ruger factory Takedown Manual for exact steps and safety precautions.*

BARREL INSERT

1. If necessary to accommodate bull barrel, remove standard barrel-insert
2. Using a philips-head driver, remove exposed screws from barrel-insert (A)
3. Lift and set aside barrel-insert (B)
4. Install Bull barrel receiver unit

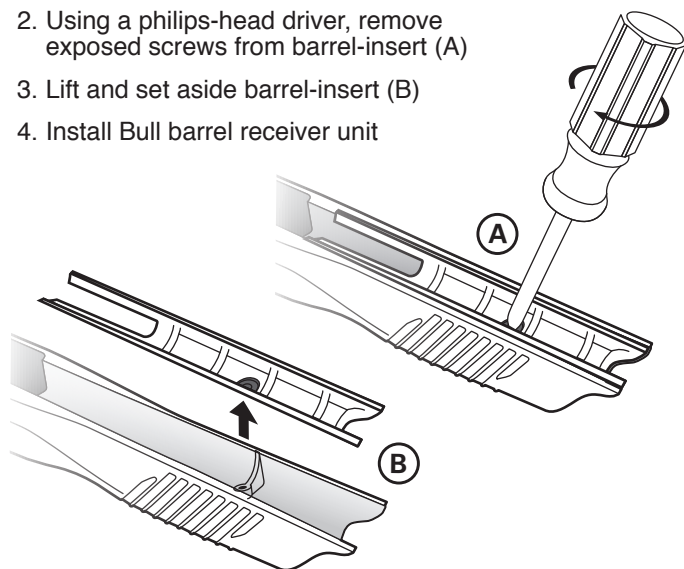

ADJUSTABLE REAR STOCK

The four position rear stock is adjustable in length from 11"-14" (or 10"-13" with recoil pad removed).

1. To adjust stock length, squeeze and hold rear adjustment lever (A).
2. Slide rear portion of stock to desired length and release lever (B). Rear-stock will automatically engage at the nearest corresponding position. To ensure engagement, push or pull on rear portion of stock.

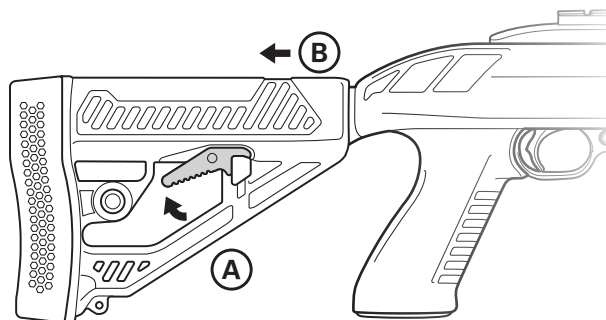

TACTRED™ MONOPOD (NOT INCLUDED)

1. Verify your firearm is unloaded. Remove the barrel-receiver unit from your stock
2. Remove endcap from stock grip handle (A)
3. Insert TacTRED into stock grip handle (B)
4. Look through stock's barrel-receiver cavity and align screw holes (C)
5. Insert and tighten provided assembly screw using philips-head screwdriver (D)

