



DRIFTSUN

WWW.DRIFTSUN.COM

ALMANOR KAYAK

110, 130 & 146

OWNER MANUAL

READ FIRST!

THIS MANUAL CONTAINS IMPORTANT PRODUCT
AND SAFETY INFORMATION

INTRODUCTION AND SAFETY	01
INCLUDED	02
INFLATION	02
SEAT SETUP	03
FIN INSTALL	04
DEFLATION	05
OPERATION	06
STORAGE	06
CARE AND MAINTENANCE	07
REPAIRS	07
TROUBLESHOOTING	08
WARRANTY	09
DISCLAIMER	09

INTRODUCTION AND SAFETY

Before hitting the water with your Driftsun Inflatable Kayak, read through these instructions to insure you have a safe and epic ride.

IT IS THE OWNER'S RESPONSIBILITY to ready the owner's manual and instruct all users in the safe operation of these products. By inflating these products, you agree to the Terms and Conditions, Disclaimer and Warnings in this manual. Please read this manual prior to inflating and using these products and keep for future reference. As with any action sport, recklessness, inexperience, misuse or neglect of the equipment may result in serious injury or death.

WARNING:

- Driftsun strongly recommends the use of a US Coast Guard Approved PFD (personal flotation device or life jacket). Check with your local government to see how rules apply to you before your first journey as the USCG classifies inflatable kayaks as vessels and some states/countries require you to have a PFD when on your board.
- Protect yourself by learning to read water and weather, and never leave shore in conditions for which you are unprepared. Consult local tide charts and maps, talk to experts and be aware of weather forecasts.
- We recommend bringing a buddy as it is always safer (and more fun!) to paddle with a friend.

- Minors should not kayak without adult supervision.
- Do not leave the kayak exposed to direct sunlight as this may cause damage.
- Do not use this kayak for anything other than its intended purpose. Using this kayak in any other manner will void the warranty.
- Always exercise safe kayaking and do not attempt maneuvers or kayak in conditions which are out of your realm of ability.
- Do not operate this vessel while intoxicated or after using any form of substance that will impair your ability to operate the kayak.
- Beware of offshore winds and currents. Never underestimate the forces of nature.
- Receive paddlesport instruction from a licensed or certified instructor.
- Dress appropriately for weather conditions; cold water and/or cold weather can result in hypothermia.
- Check your equipment prior to each use for signs of wear or failure.
- Be aware of appropriate river water levels, tidal changes, dangerous currents and weather changes.
- Do not exceed your paddling ability; be honest with yourself.
- Consult your physician prior to beginning your paddlesport training.
- Be on the lookout for potential hazards such as other boats, weather and other natural dangers.

ATTENTION: Each time before taking your inflatable out on the water, it is recommended that you inflate and check all of your equipment to insure there are no leaks, damage or wear that may cause your equipment to break during use.

Only follow the listed inflation instructions. Damage caused by inflating your inflatable by any other way will void the warranty on this product. Do not use an air compressor to inflate your kayak. This can damage your kayak and will void the warranty. Only use the provided pump.

INCLUDED:**Almanor 110**

1 x Kayak Body
 1 x Kayak Seat
 1 x Dual Blade Paddle
 1 x Foot Rest
 1 x Removable Fin
 1 x Dual Action Pump
 1 x Travel Bag
 1 x Repair Kit

Almanor 130

1 x Kayak Body
 2 x Kayak Seats
 2 x Dual Blade Paddles
 2 x Foot Rests
 1 x Removable Fin
 1 x Dual Action Pump
 1 x Travel Bag
 1 x Repair Kit

Almanor 146

1 x Kayak Body
 2 x Kayak Seats
 1 x Child Seat
 2 x Dual Blade Paddles
 2 x Foot Rests
 1 x Removable Fin
 1 x Dual Action Pump
 1 x Travel Bag
 1 x Repair Kit

INFLATION

Find a clean and flat area to set up your kayak. Ensure there are no sharp rocks or debris that could damage your kayak. Do not drag your kayak. Have a friend help you if you cannot lift the kayak by yourself.

Your kayak has three main air chambers and uses standard Boston Valves. This common valve has great function and durability and is compatible with most standard pumps.

Make sure the valve body is screwed in tightly to the valve base. Make sure that the valve tether does not get caught between the valve insert and base. Remove the valve cap and use the appropriate pump nozzle to inflate.

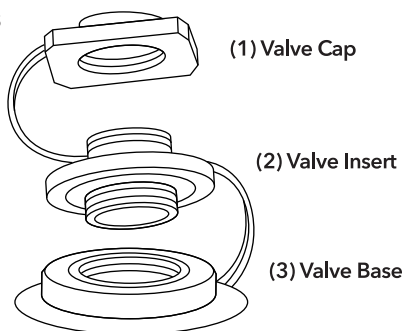

1. Unfold your kayak and inspect it for any damage.
2. Remove the valve caps use the provided pump to partially inflate the side bladders and the floor. Make sure the floor is tucked underneath the sides.
3. Finish inflating the floor and then inflate the sides. Max pressure of the floor chamber is **1 PSI / 0,07 BAR** and the max pressure for the side chambers is **2 PSI / 0,14 BAR**. **DO NOT** exceed these pressures as your kayak air chambers can rupture. Exceeding this pressure will void the warranty. Do not use a compressor, CO2 or compressed air. Only use the provided pump.

FLOOR: 1 PSI / 0,07 BAR

SIDE BLADDERS: 2 PSI / 0,14 BAR

Note: The kayak might twist during inflation. If this occurs, inflate the left chamber 30%, then inflate the right chamber 30%. Keep alternating sides until they are at the correct pressure.

SEAT SETUP

1. Place the seat(s) into the kayak so that they connect to the floor with velcro. The seat(s) should be placed so that the rider(s) are evenly balanced when the boat is in the water. A single rider should be slightly back of center in the kayak. If there are two riders, the heavier rider should be in the back.
2. Locate the left Top Straps (A) on the top back portion of the seat. Connect the hook to the D-ring (B) in front of the seat on the inner left side of the kayak. Repeat this step for the right side of the seat. Locate the left Bottom Strap (C) on the lower back portion of the seat. Connect the hook to the D-ring (D) behind the seat on the left inner side of the kayak. Repeat this step for right side of the seat. Adjust the straps so the Top Straps (A) are pulling the top of the seat are forward and so that the Bottom Straps (C) are securing the base of the seat in place.
3. Place the velcro foot rests onto the floor of the kayak so that the straps are facing towards rider. The rider's knees should be slightly bent with their heels resting on the foot rest.

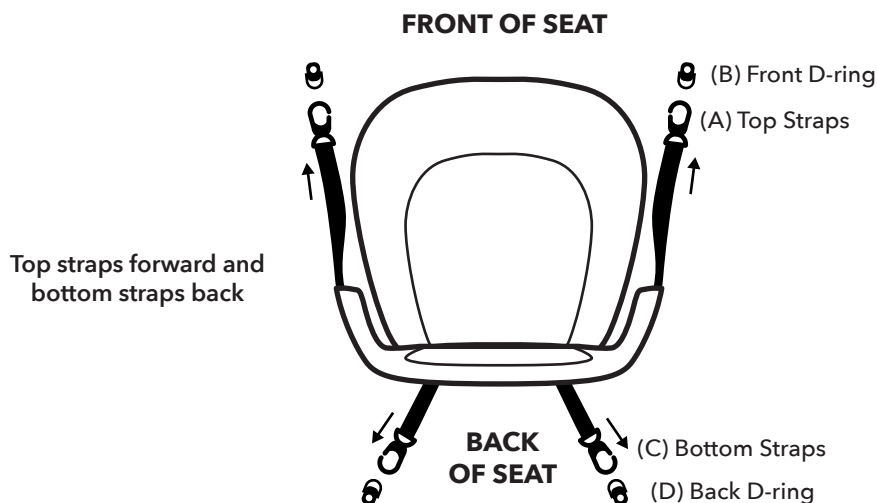

FIN INSTALLATION

Install the tracking fin. To do so, insert the front hook of the fin into the fin box so that it catches on the edge inside the fin box. Rock the back end of the fin into the back portion of the fin box. Firmly push the fin as far back into the fin box as it will go and insert the retention clip.

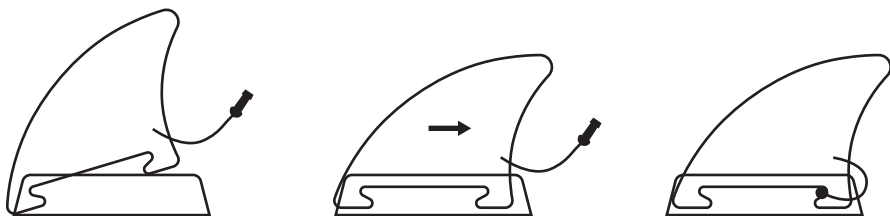

Note: Check your fin before each use. Ensure that it is connected correctly.

Attention: For whitewater use, remove the fin.

DEFLATION

Unscrew the valve inserts from the chambers to allow the air to rush out. Once the chambers are deflated you can use your pump to vacuum out any additional air to improve folding. Simply remove the pump hose from the pump and fit it onto the other side of the pump.

FOLDING

Completely deflate all of the air chambers, thoroughly dry the kayak and remove the seats. Fold the side bladders so they lay flat on top of the floor. Fold the kayak into thirds lengthwise. Starting from the nose of the kayak (opposite from the valves), roll the kayak up tight.

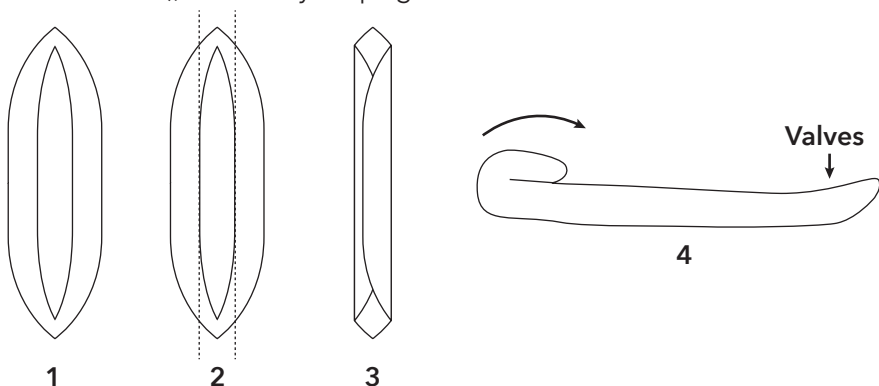

OPERATION

As stated before, do not drag your kayak. This can cause permanent damage to your kayak and can ruin its ability to retain air. If you cannot carry the kayak yourself, ask for someone to help you.

Open the drain plugs to drain water out of the kayak. If you are using the kayak for whitewater use, keep the drain plugs open during use to allow for water to rapidly drain and to avoid having your kayak submerge too deep in the water.

Do not exceed the recommended riders per your model's specifications. See the capacity plate located on the inside wall of your kayak.

If the product is showing any signs of losing air, cease use immediately. Check for air retention and do not use the kayak until this is confirmed. See the Repair section of this manual if repairs are needed.

Water temperature and weather will affect the air pressure of the kayak. In cold weather and water you kayak will lose some pressure. If this occurs, you may want to add a bit more air to the kayak to improve performance. In hot weather or prolonged sunlight, the air inside the kayak will expand. You must let some air out of the appropriate chambers to prevent the kayak from failing due to overpressure. You should avoid exposing your kayak to extreme temperatures (hot or cold).

STORAGE

It is okay to store your kayak inflated. Check the air pressure before each use. Be aware of the air temperature as this can affect the air pressure inside of the kayak.

Always allow your kayak to fully dry before storage. Your kayak will dry better when it is inflated rather than deflated.

For long-term storage, fully deflate the kayak and store in the travel bag. See the deflation section of this manual.

Do not store in direct sunlight, in a damp location or directly on concrete. Never store at temperatures below 40°F (4°C).

Store your kayak out of direct sunlight, covered and in a dry location.

CARE AND MAINTENANCE

Minor abrasions, dents or scratches are normal and will not affect the performance of your kayak.

Over time, the color may fade if left in the sun for prolonged periods of time. This is normal. When not in use we recommend that you store your kayak away from direct sunlight.

Always carry the kayak and paddle to the body of water you will paddle in. Do not drag the kayak or paddle.

Before storing, wash the kayak with fresh water and towel dry or allow to air dry.

When storing your paddle, unclip and dismantle the paddle and allow to air dry.

Do not let your kayak sit in sunlight or extreme heat for extended periods of time.

Do not use this kayak for anything other than its intended purpose.

REPAIRS

- 1.** Cut a round patch at least 1/2 inch larger than the hole or cut.
- 2.** Clean the area where the patch will be placed with water and mild soap.
- 3.** Make sure all surfaces are dry.
- 4.** In a well ventilated area, spread a thin layer of glue on both the patch and on/around the damaged area. Wait 3 to 5 minutes or until the glue is tacky.
- 5.** Apply the patch to the damaged area. Rub the top of the patch and the edges of the patch to insure it is fully applied and does not have any air bubbles.
- 6.** Wait 24 hours before inflating the kayak.

TROUBLESHOOTING

Kayak is sagging or under inflated

Be sure that the right pump is being used. Only use the provided pump that came with your kayak. A 12-V electric pump does not supply enough pressure to fully inflate the kayak. The 12-V can be used to partially inflate the kayak but one of the other pumps is needed to top it off.

Kayak will not hold pressure for more than a couple hours

Make sure that all of the components of each valve are in good condition, free of cracks or damage and are fully assembled and tightly screwed together.

Kayak still loses air

If you have checked all the previous possible reasons for the kayak losing air, then there may be a pinhole or split seam somewhere. If you cannot see or hear where a leak may be, take a clean rag with soapy water and begin rubbing the kayak while it is inflated. If a hole is present, bubbles will continually form. Repair using the provided repair kit. If it is a very small pinhole, a dab of rubber cement may be sufficient. See the Repair section of the manual for more information.

Chamber is kinked or bent

The air chambers just needs to be adjusted. When the kayak is fully deflated try adjusting the position of the chambers within their outer cover. Also, inflate each chamber just a small amount, and check for alignment and position. Repeat until the kayak is fully inflated. Adjust the air chambers during this process.

There is water in the kayak

There will almost always be a little water in the kayak. One reason is the water drips off of the paddle and into the kayak.

Ensure that the drain plug is fully closed.

The kayak does not track well

Try moving your seat forward a little more. This will allow for better weight distribution and better tracking. Also, make sure that the removable tracking fin is installed correctly.

1 YEAR LIMITED WARRANTY

We aim to provide our customers with high quality watersports equipment, but sometimes the unexpected happens. All Driftsun products are warranted to be free of defects in materials and workmanship for a period of one year. This excludes any damage due to misuse, improper care, handling impact damage and light abrasions.

HOW TO OBTAIN WARRANTY

Be sure to register your product at www.driftsun.com/register to register your warranty. You must register your product within 30 days of purchase to guarantee full coverage. To obtain repair or replacement, call Driftsun customer service at 1-877-528-3269 or email Driftsun at cs@driftsun.com. In the event of warranty claim, on initial contact please attach the product name, your full name, address, phone number, brief description of the problem and proof of purchase date.

DISCLAIMER

The use of this assumes all risks of any personal injury or death and willfully releases Driftsun and/or Marketfleet Inc. of any and all liabilities. This product is not a life saving device. Do not leave a child unattended while in use. Do not use this product in conditions which are hazardous. When in the ocean, watch for rip currents and inspect the area for rocks, reefs, and other objects that can be considered dangerous. Keep a safe distance from surfers and swimmers. Only use this product if you are a competent swimmer. Adult supervision is strongly recommended.

Marketfleet, Inc., doing business as Driftsun® is in no event liable for any direct, indirect, punitive, incidental, special consequential damages, to property or life, whatsoever arising out of or connected with the use or misuse of our products.

TERMS OF USE

This product is offered to you, conditioned upon your acceptance without modification of the terms, conditions and notices explicitly described, or implicitly obtained through normal use of the product. This product may not be used for unlawful purposes, and its use is expressly prohibited under the terms and conditions of its use. The use of this product in any way not in accordance with the terms of use, description, law, or instructions, might be unsafe and lead to injury.

DRIFTSUN(R) EXPRESSLY DISCLAIMS ALL RESPONSIBILITY FOR CONSEQUENTIAL DAMAGES OR INCIDENTAL LOSSES CAUSED BY USE OF THIS PRODUCT.

Faults that occur through, improper use, damage, abuse, use with incorrect voltage, acts of

nature, events beyond the control of Marketfleet, Inc., repair or alteration by a person other than a person authorized by Marketfleet, Inc., or failure to follow instructions for use void any guarantee or warranty.

Additionally, normal wear and tear, including, but not limited to, minor discoloration and scratches are not covered by any guarantee or warranty.

The rights under these terms and conditions, shall only apply to the original purchaser and shall not extend to commercial or communal use.

If your product includes a country-specific guarantee or warranty insert please refer to the terms and conditions of such guarantee or warranty in place of this guarantee or contact your local authorized dealer for more information.

Our entire terms of use are for the product you purchase are governed by the laws of the Commonwealth of Puerto Rico, USA. You hereby consent to the exclusive jurisdiction and venue of the courts of competent jurisdiction, in all disputes arising out of or relating to the use of this product. Use of this product is unauthorized in any jurisdiction that does not give effect to all provisions of these terms and conditions, including without limitation this paragraph.

This product is not intended for use by persons (including children) with reduced physical, sensory or mental capabilities, or lack of experience and knowledge, unless they have been given supervision or instruction concerning use of the product by a person responsible for their safety.

Children should be supervised to ensure that they do not play with the product. Keep the product and any cord, or small components, out of reach of children less than 8 years old.

PROP 65 DISCLAIMER:

This product can expose you to chemicals including polystyrene, acrylonitrile butadiene styrene (ABS), styrene acrylonitrile (SAN), lead, formaldehyde, cadmium, and phthalates, which are known to the State of California to cause cancer, and polystyrene, acrylonitrile butadiene styrene (ABS), styrene acrylonitrile (SAN), lead, formaldehyde, cadmium, and phthalates, which are known to the State of California to cause birth defects or other reproductive harm. For more information go to www.p65warnings.ca.gov.

MODIFICATIONS TO TERMS OF USE

Marketfleet, Inc., reserves the right to change the terms, conditions and notices under which their products are offered.



DRIFTSUN

WWW.DRIFTSUN.COM

CHICO, CA
CS@DRIFTSUN.COM
MADE IN CHINA

IF AFTER READING THIS BOOKLET AND YOU HAVE ANY QUESTIONS OR COMMENTS,
CALL 1 (877) 528-3269, OR EMAIL CS@DRIFTSUN.COM

YOU MAY NOT MODIFY, COPY OR REPRODUCE THIS PRODUCT.

©COPYRIGHT 2021 MARKETFLEET, INC., CHICO, CA.

ALL RIGHTS RESERVED.

DESIGNED IN CALIFORNIA. MANUFACTURED IN CHINA.