

## CAN-AM® MAVERICK R AMP POWER HARNESS

PART #: UTVS-HRN-AMP-PWR-86



1

REMOVE THE SINGLE SCREW ON  
CENTER CONSOLE PANEL



2

POP OUT THE CLIPS HOLDING IN THE  
CENTER CONSOLE PANEL



3

REMOVE THE SINGLE SCREW  
BEHIND THE PANEL



4

REMOVE THE ENTIRE CENTER  
CONSOLE PANEL



5

REMOVE THE PLASTIC CLIP NEAR THE  
FOOT REST



6

POP OUT THE CLIPS AND REMOVE  
THE PANEL



7

RUN YOUR POWER HARNESS WIRE  
THROUGH CENTER CONSOLE



8

RUN THE WIRE UP THROUGH THE DASH  
ON DRIVER SIDE



9

ADD HEATSHRINK AND CRIMP ON THE  
AMP HARNESS CONNECTOR



10

SHRINK THE CONNECTORS



11

CONNECT YOUR POSITIVE LEAD (RED)  
TO THE POSITIVE TERMINAL ON BATTERY



12

CONNECT YOUR NEGATIVE LEAD (BLACK)  
TO THE GROUND TERMINAL ON BATTERY

# MAVERICK R



## CAN-AM® MAVERICK R RCA & SUB OUT HARNESSES

PART #: UTVS-R-RCA-OUT & UTVS-R-SUB-OUT

THESE SETTINGS ARE REQUIRED TO ACTIVATE AUDIO OUTPUT



START BY GOING TO SETTINGS > PREFERENCES

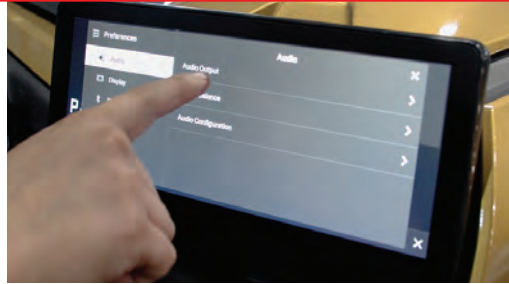

ON THE AUDIO TAB TAP "AUDIO OUTPUT"

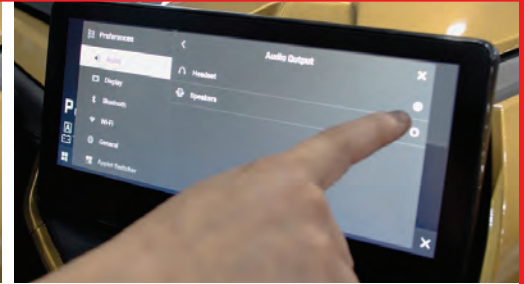

CHANGE THE AUDIO OUTPUT TO "SPEAKERS"  
\*DEFAULT IS SET TO HEADSET

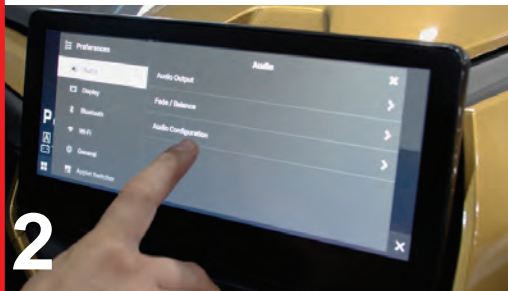

TAP "AUDIO CONFIGURATION"

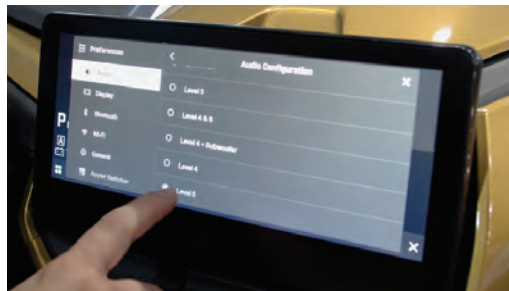

SELECT "LEVEL 5"  
\*YOU WILL BE PROMPTED TO RESTART THE VEHICLE



RESTART THE IGNITION

### TIPS:

IF YOU LOSE AUDIO, FOR EXAMPLE WHEN DOING SOFTWARE UPDATES, REVERT BACK TO STEPS 1 & 2.  
IF EVER YOUR BLUETOOTH WON'T CONNECT, "FORGET DEVICE" FROM PHONE, THEN TRY RESETTING HEADUNIT AND REPEAT STEPS 1 & 2.



OPEN THE SIDE PANEL AS SHOWN



REMOVE THE T-25 SCREW AND REMOVE THE A-PILLAR COVER



REMOVE THE 10MM BOLT & T-30 SCREW

CONTINUE ON BACK →





## CAN-AM® MAVERICK R RCA & SUB OUT HARNESSES

PART #: UTVS-R-RCA-OUT & UTVS-R-SUB-OUT



4 REMOVE THE HOOD PIECE



5 REMOVE THE DASH PANEL



6 REMOVE BOTH 10MM BOLTS



7 REMOVE THE PANEL



8 LOCATE THE OEM PLUGS



9 REMOVE THE OEM CAPS ON BOTH PLUGS

### RCA OUTPUT



1 PLUG IN THE WHITE HARNESS PLUG INTO THE LARGER OEM PLUG



2 CONNECT THE REMOTE (BLUE) WIRE

### SUB OUTPUT



1 PLUG IN THE WHITE HARNESS PLUG INTO THE SMALLER OEM PLUG



2 CONNECT THE REMOTE (BLUE) WIRE

**RUN RCA'S & REMOTE WIRE TO AMP(S)**





# MAVERICK R

## CAN-AM® MAVERICK R 10" SUBWOOFER ENCLOSURE

(FRONT DRIVER OR PASSENGER)

PART #: UTVS-R-ENC-10-FRONT

### FRONT SEAT REMOVAL



**1** SLIDE SEAT FORWARD AND REMOVE BOTH BOLTS FROM FLOOR



**2** REMOVE THE BOLTS FOR THE HARNESS LOCK MECHANISM



**3** REMOVE BOLTS FROM SEAT MOUNT ON BOTH SIDES



**4** LIFT SEAT UP TO GET TO THE BLACK SEAT BELT PLUG AND UNPLUG IT



**5** REMOVE SEAT FROM CAR

**FOLLOW SAME STEPS FOR OTHER SEAT**

\*THERE IS NO PLUG ON PASSENGER SIDE

### 10" SUBWOOFER ENCLOSURE HARDWARE LIST:

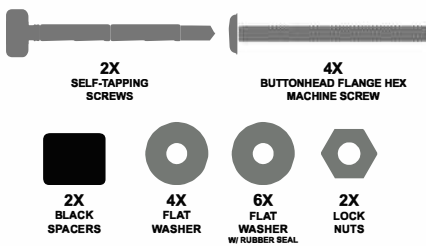

**1** REMOVE SCREW AND SPACER FROM BOTH SIDES OF ENCLOSURE



**2** RUN SUB WIRE THROUGH GROMMET

\*USE SMALL AMOUNT OF WINDEX TO HELP LUBE THE WIRE

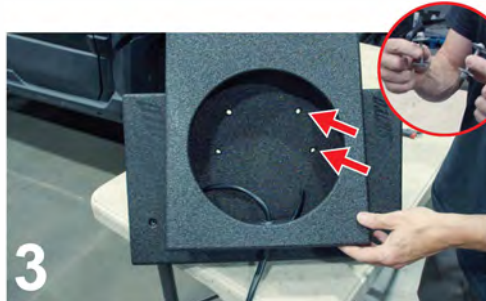
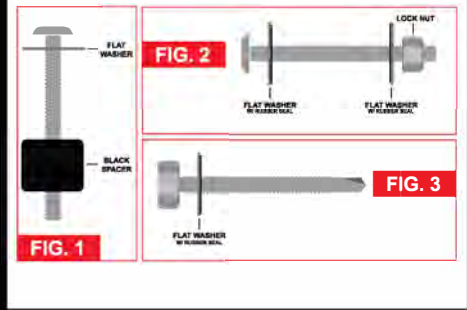

**3** USE BUTTONHEAD FLANGE HEX MACHINE SCREWS & FLAT WASHERS W/ RUBBER SEAL TO SEAL THE UNUSED HOLES (SEE FIG. 2)

\*IF INSTALLING DRIVER SIDE: PLUG HOLES ON LEFT  
IF INSTALLING ON PASSENGER SIDE: PLUG HOLES ON RIGHT

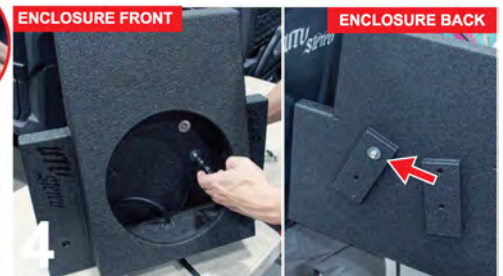

**4** TIGHTEN THE NUTS SECURELY SO THAT THE WASHERS FORM A SEAL

CONTINUED ON BACK →



# MAVERICK R

## CAN-AM® MAVERICK R 10" SUBWOOFER ENCLOSURE

(FRONT DRIVER OR PASSENGER)

PART #: UTVS-R-ENC-10-FRONT



5 LOAD ENCLOSURE INTO THE CAR



6 USE THE **BLACK SPACER** FROM STEP 1 AND SLIDE UNDER THE SEAT MOUNT BRACKET



**PRO TIP:**  
YOU CAN USE A WEDGE OR SIMILAR TOOL TO HELP ALIGN HOLES

7 \*REPEAT FOR OTHER SIDE

USE **BUTTONHEAD FLANGE HEX MACHINE SCREW & FLAT WASHER** TO FASTEN ENCLOSURE TO SEAT MOUNT BRACKET (SEE FIG. 1)



**WARNING:**  
DRILL SELF-TAPPERS IN SLOWLY TO PREVENT BLOWING OUT THE BIT

8 USE THE **SELF-TAPPING SCREWS & FLAT WASHERS W/ RUBBER SEAL** TO SECURE THE SUBWOOFER ENCLOSURE TO THE FRAME (SEE FIG. 3)



9 WIRE YOUR SUBWOOFER FOR YOUR SPECIFIC IMPEDANCE



10 ALIGN SUBWOOFER ON ENCLOSURE AND PRE-DRILL THE HOLES



11 USE THE SCREWS INCLUDED WITH SUBWOOFER TO SECURELY FASTEN THE SUBWOOFER TO THE ENCLOSURE

**REPLACE THE SEAT**

\*DON'T FORGET TO RECONNECT SEAT BELT PLUG

12

**NEED HELP? EMAIL TECH SUPPORT AT: INFO@UTVSTEREO.COM OR CALL: 480.616.2299**



## CAN-AM® MAVERICK R KICK PANEL INSTRUCTIONS



1

CUT OUT THE PROVIDED TEMPLATE  
\*YOU WILL NEED TO MARK THE MOUNTING HOLES



2

PLACE TEMPLATE IN VEHICLE AND  
TRACE SPEAKER HOLE LOCATION



3

CUT OUT THE SPEAKER HOLE



4

DRILL OUT THE MOUNTING HOLES



5

RUN SPEAKER WIRE TO SPEAKER  
LOCATION



6

ATTACH THE PROVIDED  
METAL FASTENERS



7

STRIP AND CRIMP ALL OF THE WIRES  
AND CONNECT THE RGB WIRES  
TO THE RGB PLUG



8

CRIMP THE CONNECTORS TO THE  
POWER WIRES.

\*LARGER CONNECTOR IS POSITIVE (+)



9

ATTACH SPACER RING AND THEN  
POWER WIRES AND RGB PLUG  
TO SPEAKER



10

MOUNT SPEAKER TO VEHICLE USING  
INCLUDED HARDWARE



**CAN-AM® MAVERICK R  
UPPER AMP MOUNT**

PART #: UTVS-R-AMPMT-UP



**1** REMOVE 10MM SCREW IN DASH



**2** REMOVE THE THREE YELLOW PLASTIC TRIMP PANELS (DRIVER SIDE, CENTER PIECE, PASSENGER SIDE)

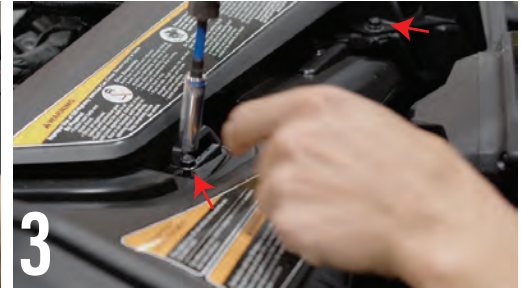

**3** REMOVE THE TWO SCREWS UNDER THE DRIVER SIDE TRIM PANEL



**4** REMOVE 3 SCREWS LOCATED UNDER DASH PANEL



**5** REMOVE THE TWO SCREWS ABOVE GLOVE BOX ON PASSENGER SIDE



**6** REMOVE THE LAST SCREW ON DASH JUST ABOVE GLOVE BOX



**7** PULL OFF THE DASH PANEL

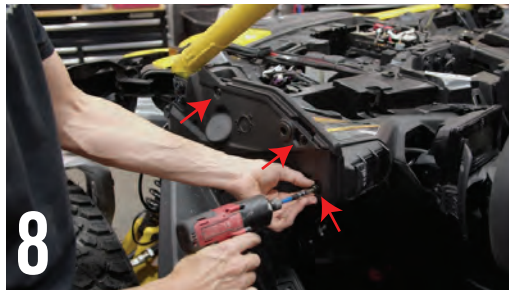

**8** REMOVE THE THREE BUTTON HEAD SCREWS LOCATED UNDER THE SIDE PANEL ON DRIVER SIDE



**9** REMOVE THE THREE SCREWS SHOWN HERE BEHIND THE STEERING WHEEL

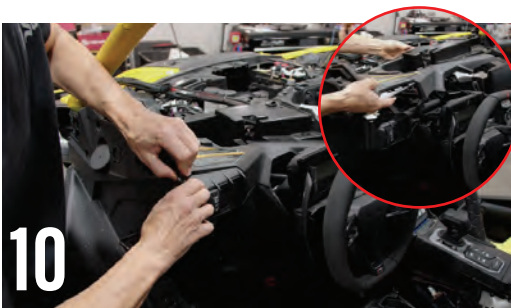

**10** ONCE ALL SCREWS HAVE BEEN REMOVED YOU CAN SPLIT THE ROCKER SWITCH DASH PANEL FROM THE TOP DASH PANEL



**11** REMOVE THE 10MM SCREW HOLDING ON THE (?) SENSOR

*\*YOU WILL NEED TO POP OUT THE PLASTIC CLIP SHOWN BY THE RED ARROW*



**12** PLACE THE L-BRACKET ONTO THE DRIVER SIDE FRAME AND SECURE IT USING THE INCLUDED HARDWARE



**CAN-AM® MAVERICK R  
UPPER AMP MOUNT**

PART #: UTVS-R-AMPMT-UP



**13**

**TRIM THE PLASTIC SHOWN HERE TO ALLOW ROOM FOR THE AMP MOUNT**



**14**

**LOAD THE AMP MOUNT INTO THE VEHICLE**



**15**

**SECURE IT WITH THE SCREW AND SPACER**



**16**

**USE THE COUNTERSUNK SCREW TO ATTACH THE MIDDLE OF THE MOUNT**



**17**

**ATTACH THE REAR BRACKET TO THE FRAME USING INCLUDED HARDWARE**



**18**

**ADD YOUR AMP IN A SLIGHT ANGLE AND SECURE USING THE 4 LONG SCREWS**



**19**

**ADD YOUR SECOND AMPLIFIER AND SECURE USING THE 4 LONG SCREWS**



**20**

**REATTACH THE SENSOR**