

LASFIT[®]

LED Rock Light

I

Accessories

- Rock Light x4



- Fuse x1



- Screw x8



- Insulated dust cap x4



- 1 with 8 pod cable x1

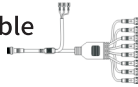

- Rubber Mounting Pad x4



- Switch x1



- Screw Driver x1



- Zip Ties x26



II

Instruction

1. Drill holes in the mounting position

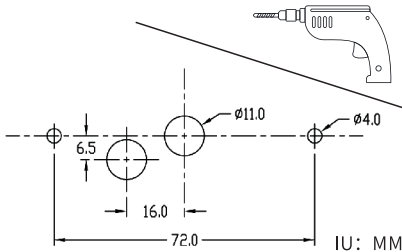

2. Route the harness through the rubber mounting pad

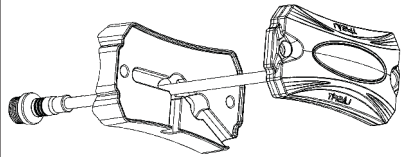

3. Tighten the screws on both sides

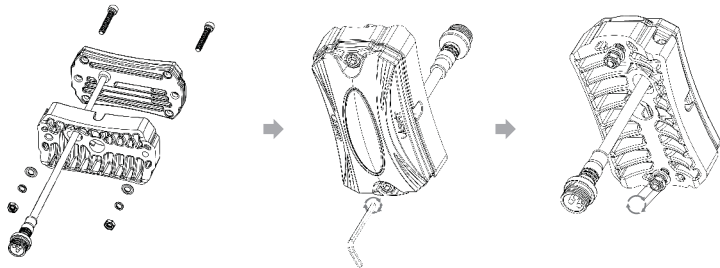

4. Wiring diagram

