



Malem Enuresis Alarm
iOS/iPhone
Setup and
Operation Booklet

IMPORTANT

Please read this instruction
booklet before use

For use with MO25 alarm

Malem MO25 Bluetooth Alarm iOS/iPHONE Setup and Operation

Content

Install the App on the iPhone	1
Link up procedures	2
Telephone number setup	4
Re-dial	6
Alarm sound select	7
Alarm duration select	8
Alarm history browser	9
Record deletion	11
Password setting	12
Unlock setting	14
Cancel password	15
Operation	17
Battery charge	17
Alarm set up/charging diagrams	19
Easy Clip© Sensor setup diagram	20
LED Indication Table	21
IMPORTANT NOTICE	22

Installation and Setup

Install the App on the iPhone

- Download the “Malem Alarm” App from Apple Store
- App installs automatically and is shown on the desktop
- Restart the iPhone to ensure the App is installed

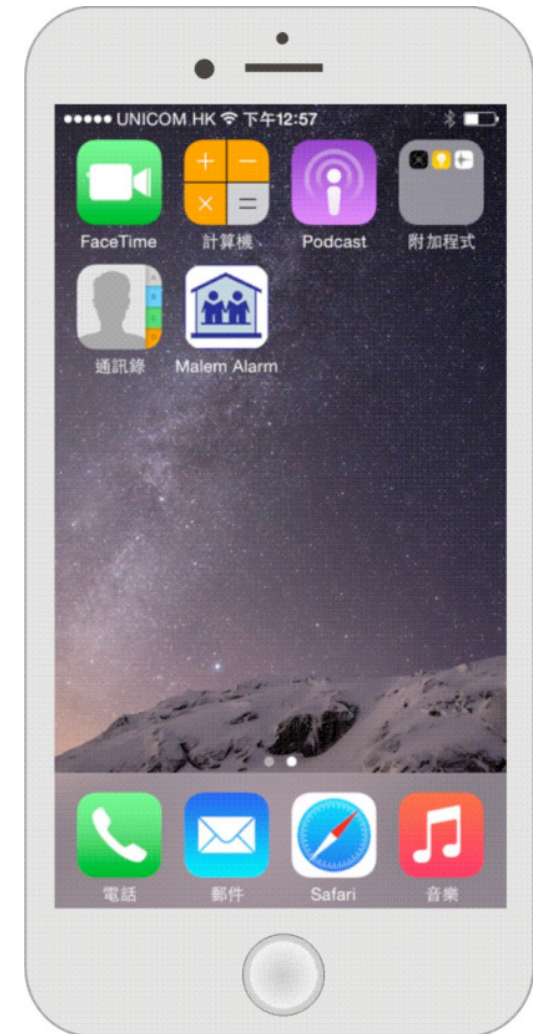

Installation and Setup

Link Up Procedures

- a) Touch the Malem Alarm shortcut icon on the iPhone desktop
- b) The program will start searching for the Alarm unit automatically
- c) Power ON the Malem Alarm unit by sliding the switch under the water resistant cover on the back
- d) Wait until the App links up with the alarm and make sure the telephone bluetooth is activated
- e) The App main menu is activated after link up
- f) Touch the ON/OFF button at the MALEM ALARM heading column

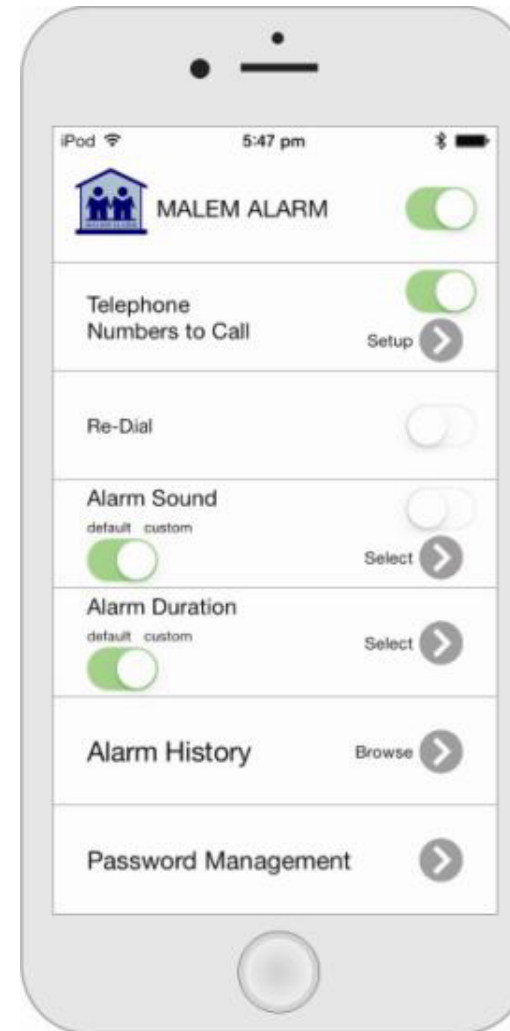
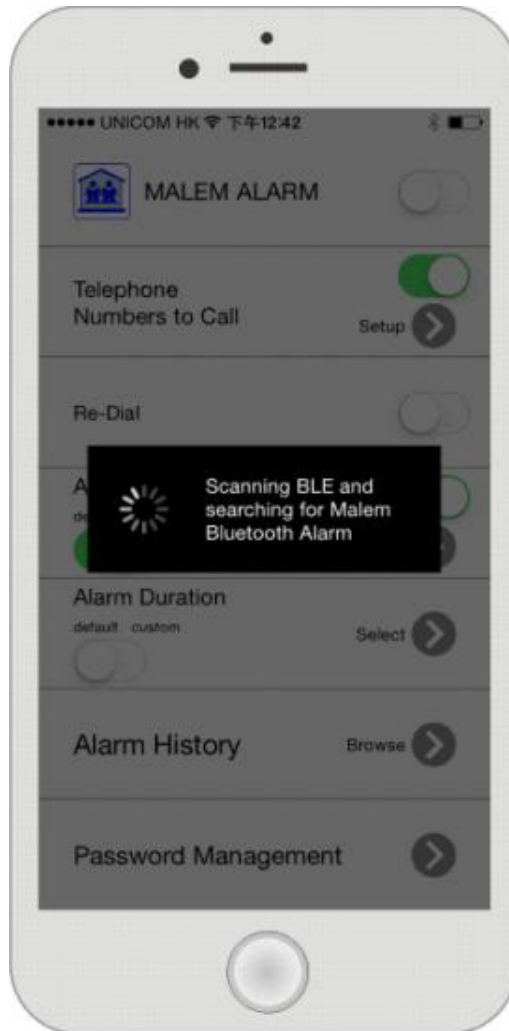

Installation and Setup

Telephone Number Setup (maximum 3 telephone numbers)

- a) Touch the telephone ON/OFF switch to set the function ON in the telephone column
- b) Touch the arrow key in the telephone column to access the telephone number settings page

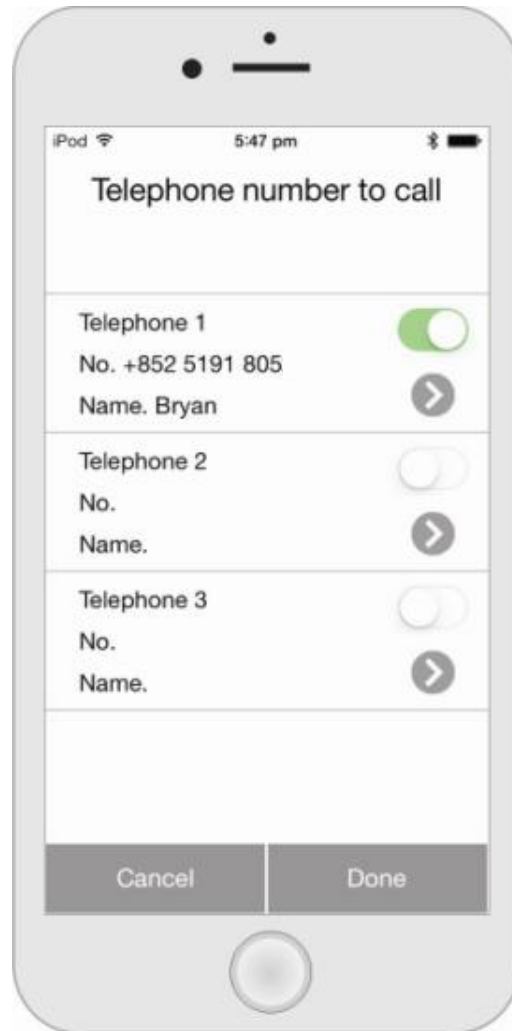

- c) Touch the arrow key in the telephone 1 column to access the telephone phonebook
- d) Select the contact person in the phonebook
- e) The program will go back to the telephone settings page automatically
- f) The selected phone number will be shown on the telephone 1 column
- g) Set the ON/OFF selector to ON to activate telephone 1
- h) Set other telephone numbers as above if necessary
- i) Touch the DONE key to return back to the main menu

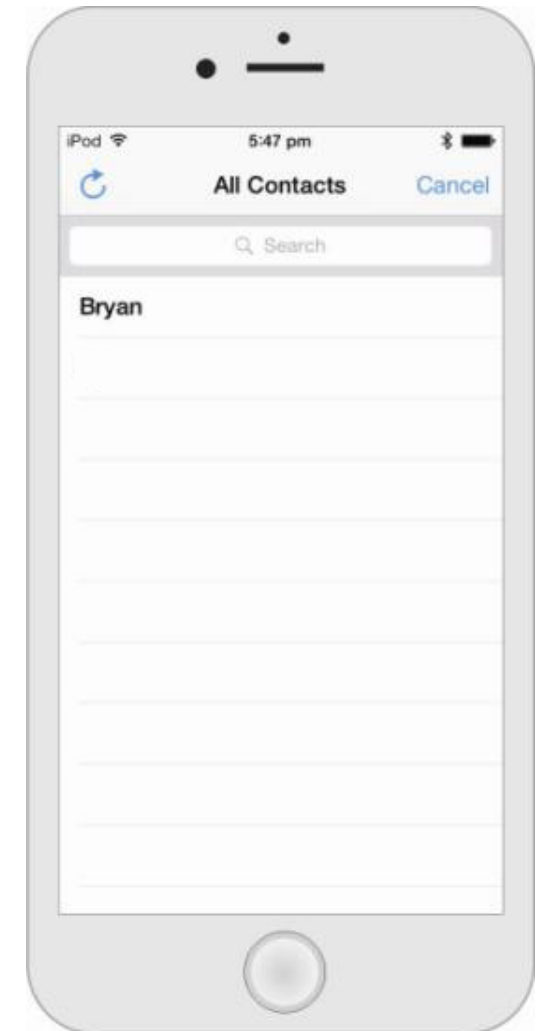

Installation and Setup

Re-Dial

- a) Touch the re-dial button to activate to redial a busy number



Alarm Sound Select

- a) Set the alarm sound function ON in the alarm sound column by touching the ON/OFF switch
- b) Set the default/custom switch to custom by touching the switch
- c) Touch the arrow key in the alarm sound column
- d) Enter the alarm sound select page
- e) Select desired alarm sound
- f) Touch DONE key to go back to the main menu
- g) Select default or custom alarm sound in the alarm sound column by touching the switch

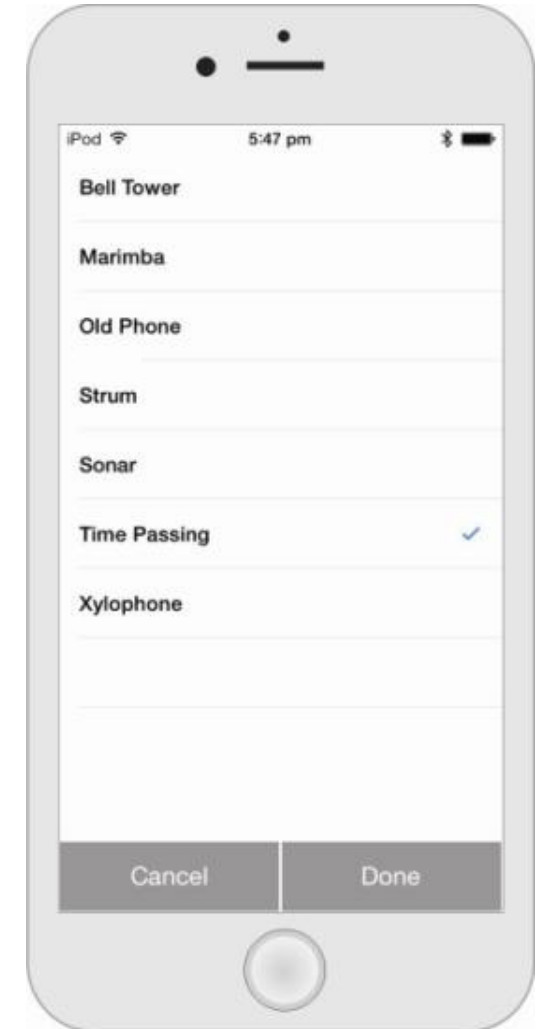

Installation and Setup

Alarm Duration Select

- a) Set the default/custom switch to custom in the alarm duration column
- b) Touch the arrow key in the Alarm duration column to enter the duration selection page
- c) Select desired alarm sound duration
- d) The telephone call will only occur after the alarm sound is finished
- e) Touch the DONE key to go back to the main menu
- f) Select default or custom duration in the alarm duration column
- g) Default duration is 10 seconds

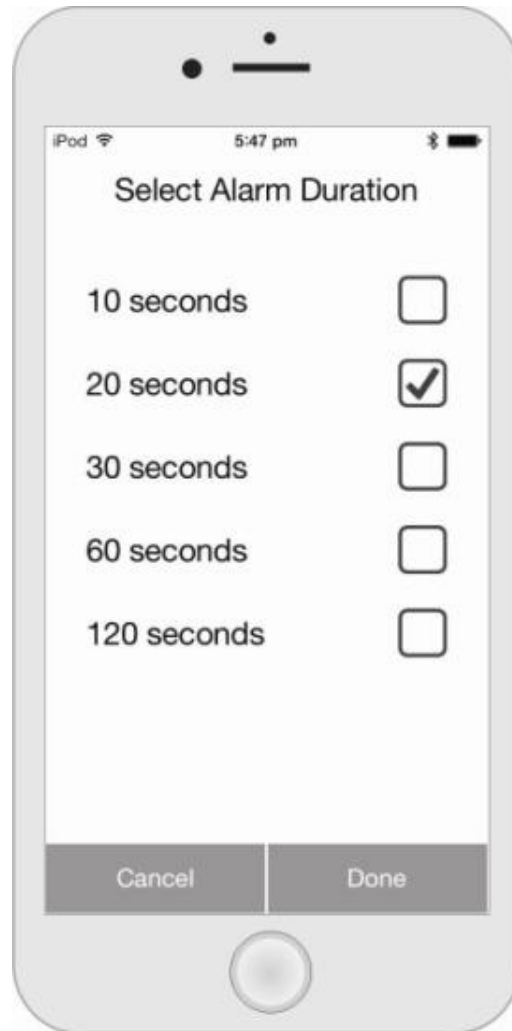

Alarm History Browser

- a) Touch the arrow key in the alarm history column to enter the history browser page
- b) Slide the screen up and down to browse the list of records
- c) Touch the GRAPH key to enter the statistic bar chart page
- d) The bar chart graphic shows the number of times the alarm has been activated each day

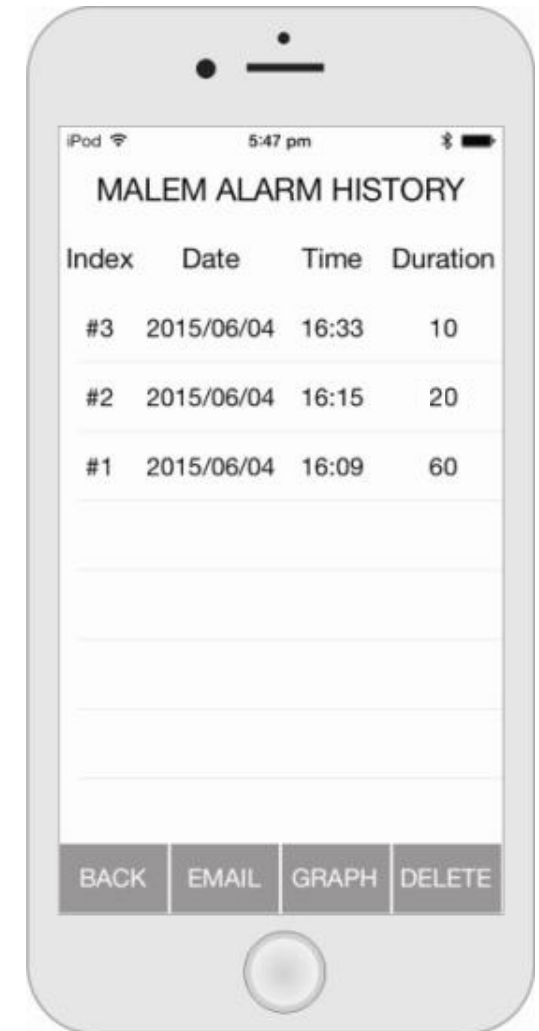

Installation and Setup

- e) Touch the left or right arrow to move the date column
- f) The records can be sent by email in text format
- g) Touch the EMAIL key to enter the email address
- h) Touch the BACK key return to the main menu

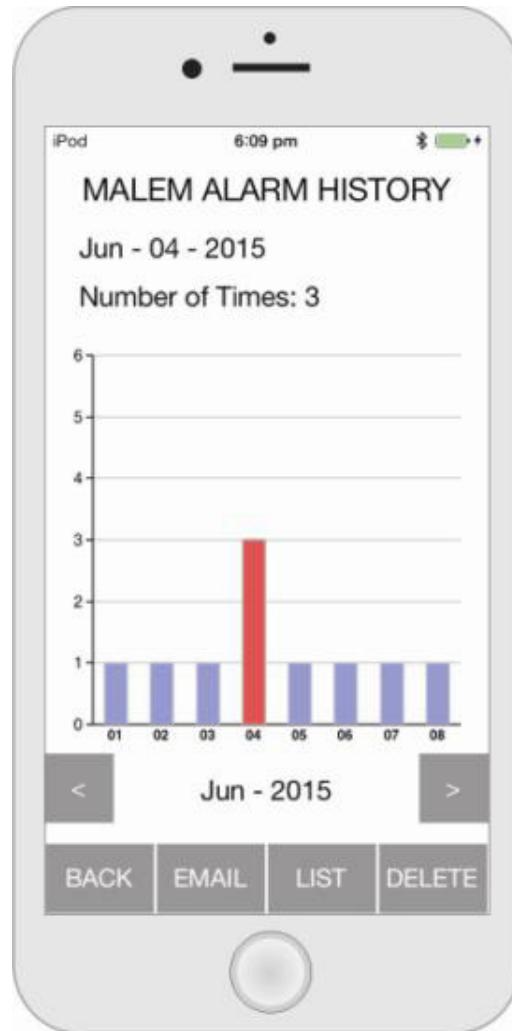

Record Deletion

- a) Touch the DELETE key in the alarm record list or bar chart graphic
- b) The password input page will appear if a password has been set
- c) Enter the password to delete the records
- d) Confirm page will appear if password has not been set
- e) Touch YES key to delete the records
- f) Touch the BACK key to return to the main menu

Installation and Setup

Password Setting

- a) Touch the password management column on the main menu to enter the password setting page
- b) Set the ON/OFF switch to ON



- c) Password setup window appears
- d) Enter the password in the pop-up window and touch DONE
- e) Confirm page appears
- f) Re-enter the password in the confirm window and touch DONE
- g) Password set successfully
- h) Touch DONE to go back to the password setting page
- i) Touch RETURN key to go back to the main menu



Installation and Setup

Unlock Setting

- a) Once the password is setup the system will be locked and will not allow any changes to the settings
- b) The password window will appear if changes to the settings are required
- c) Input the password and touch the DONE key
- d) The system unlock and return to the main menu
- e) All settings can be change at this stage
- f) The system will be locked again automatically after 2 minutes if no key is activated

Cancel Password

- a) Touch the password management column
- d) The password window will appear
- c) Enter the password and touch the DONE key
- d) Touch the password management column again to enter the password setting page

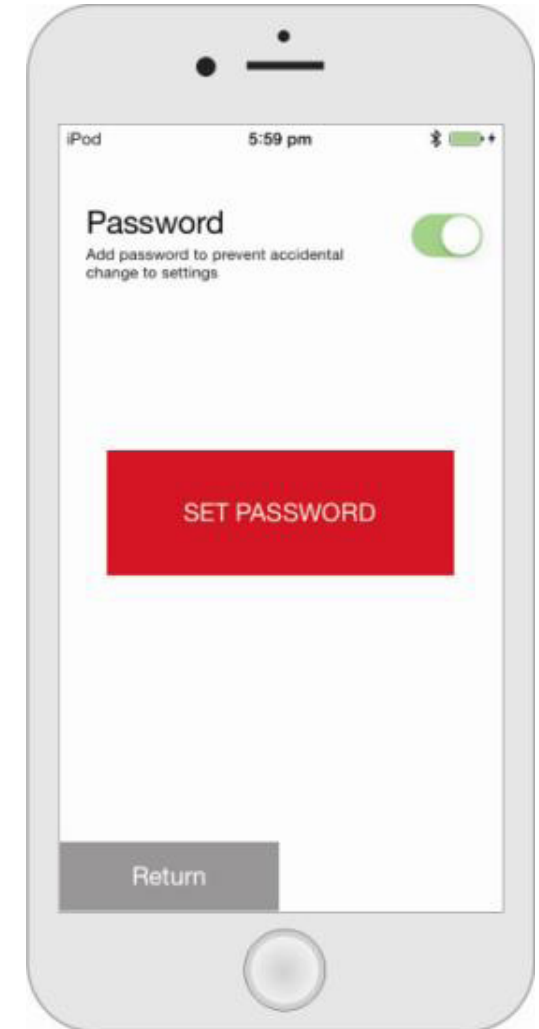

Installation and Setup

- e) Set the ON/OFF switch to OFF
- f) The password Input window appears
- g) Enter the password and touch DONE to confirm
- h) Password successfully cancelled
- i) Touch RETURN to go back to the main menu



Operation

- a) Touch the MALEM ALARM short cut icon on the iPhone desktop
- b) Power ON the alarm switch under the water resistant cover
- c) Wait until the alarm links up with the App and the main menu is activated
- d) Set the MALEM ALARM App to ON as in link up procedures
- e) **Don't not** close the App or lock the phone when using the alarm (See important notice on page 21)
- f) Clip the alarm to the top of the underpants and the Easy-Clip sensor to the appropriate position on the outside of the underwear
- g) The Alarm will activate the App when wetness is detected
- h) The iPhone alarm will sound. Touch STOP to silence.
- i) After the alarm sounds, the iPhone will display the number to dial and waits until the user touches "Call"
- j) The App will also dial second and third telephone numbers if selected and touched by the user.
- k) The alarm will not re-activate if the Easy-Clip sensor is wet
- l) The alarm will be activated after 10 minutes once the sensor is dry
- m) If the alarm and App become disconnected, the alarm will sound and a pop-up window showing "Scanning BLE....." will appear on the screen

Installation and Setup

- n) The main menu will activate again automatically after link up
- o) Please read the IMPORTANT NOTICE on page 21

Battery Charge

- a) Plug in the USB cable and carefully connect the Alarm to the computer or any 5V 0.5A power source (similar to telephone charging)
- b) Slide the alarm power switch to the ON position
- c) LED flashes once per second
- d) Charging time around 3 hours
- e) LED will glow brighter when fully charged
- f) Remove the charging cable

- g) LED flashes twice per second
 - h) Link-up the alarm to the Malem alarm App
 - i) We strongly advise charging the unit daily when not in use
 - j) Please ensure the Easy-Clip© sensor lever is always in the up position when the alarm is not in use. Lowering the lever without dry underpants material between the front jaws will drain the battery.
- Lowering the lever without any dry material in the jaws will trigger the alarm and prevent the alarm from resetting. Lift the lever and press the STOP button on the iPhone. Keeping it down will drain the battery

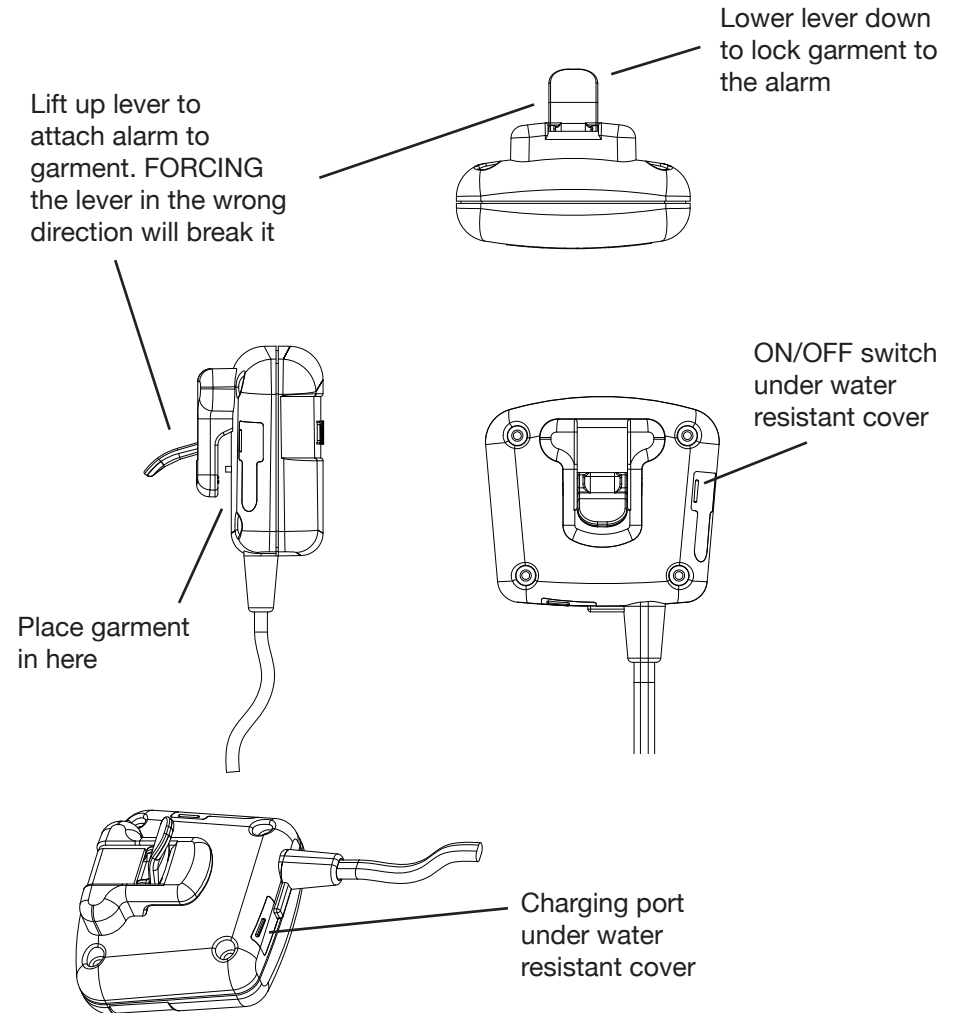

Installation and Setup

Lowering the lever without any dry material in the jaws will trigger the alarm and prevent the alarm from resetting. Lift the lever and press the STOP button on the iPhone.

IMPORTANT:
Regularly CLEAN Easy-Clip® Sensor in soapy water, rinse and shake dry.

Lock the Easy-Clip® onto the material by lowering the lever.

IMPORTANT: DO NOT PLACE ANY MATERIAL UNDER THE SECURING LEVER.

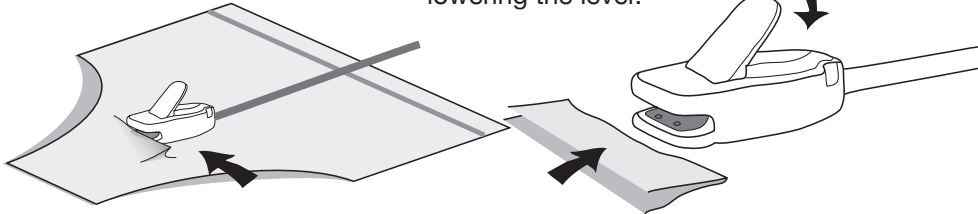

Place underwear material into mouth (jaws) at the front of the Easy-Clip®.

IMPORTANT:
Forcing the lever in the wrong direction will break it.

LED Indication Table

Status	LED Action
Stand-by	Flashes once every 3 seconds
Successful Link-up with Sensor	LED glows brighter for 3 seconds
Sending Data	LED glows brighter for 3 seconds
During Battery Charging	Flashes once every second
Battery Fully Charge	LED glows brighter until charging cable is removed
Battery Low Voltage	Flashes 3 times every second
Off link with Apps	Flashes twice every second

IMPORTANT NOTICE

- a) The App must remain visibly open. No other action can be used on the iPhone.
- b) The iPhone must not go into sleep mode. Under “Settings” Display Auto-Lock must be set to NEVER.
- c) We strongly recommend keeping the iPhone on charge.
- d) When the alarm is triggered and the iPhone is sounding, the iPhone will be displaying the programmed telephone number 1 and will wait until the user confirms by touching Call.
- e) The App will also await confirmation for dialling the second and third telephone numbers if programmed.
- f) Dialling actions need to be confirmed by the user. Limitations imposed by Apple.
- g) No such restrictions when used with an Android phone.

Disclaimer

Malem™ Alarms are designed as a helpful aid. They are not intended to replace human care or supervision and the manufacturer, Malem Medical, is not responsible for any consequences resulting from the use, misuse or failure of this device.

The manufacturer reserves the right to change specifications without prior notice.



Alarms cure by speeding up the natural process

Malem Medical Ltd, 10 Willow Holt, Lowdham
Nottingham NG14 7EJ, England, UK
Tel: + 44 (0)115 966 4440 Fax: + 44 (0)115 966 4672
E-mail: malem@malem.co.uk
Web: www.malem.co.uk Web: www.malemmedical.com