



Malem Enuresis Alarm
ANDROID
Setup and
Operation Booklet

IMPORTANT

Please read this instruction
booklet before use

For use with MO25 alarm

Malem MO25 Bluetooth Alarm ANDROID Setup and Operation

Content

Install the App on the smartphone	1
Link up procedures	2
Telephone number setup	4
Short message edit	6
Alarm sound select	8
Alarm duration select	9
Alarm history browser	10
Record deletion	12
Password setting	14
Unlocking settings	19
Cancel password	20
Operation	24
Battery charge	25
Alarm set up/charging diagrams	26
Easy-Clip© sensor setup diagram	27
LED Indication Table	28

Installation and Setup

Install the App on the ANDROID smartphone

- Download the App (Malem Alarm) from google play on to the smartphone
- App installs automatically and generates a shortcut icon in the program library folder
- Move the icon to the desktop if you wish



Installation and Setup

Link Up Procedures

- a) Touch the Malem alarm shortcut icon on the smartphone desktop
- b) The App will start searching for the alarm unit automatically
- c) Power ON the Malem alarm unit by sliding the switch underneath the water resistant cover on the back
- d) Wait until the App links up with the alarm and make sure the telephone bluetooth is activated

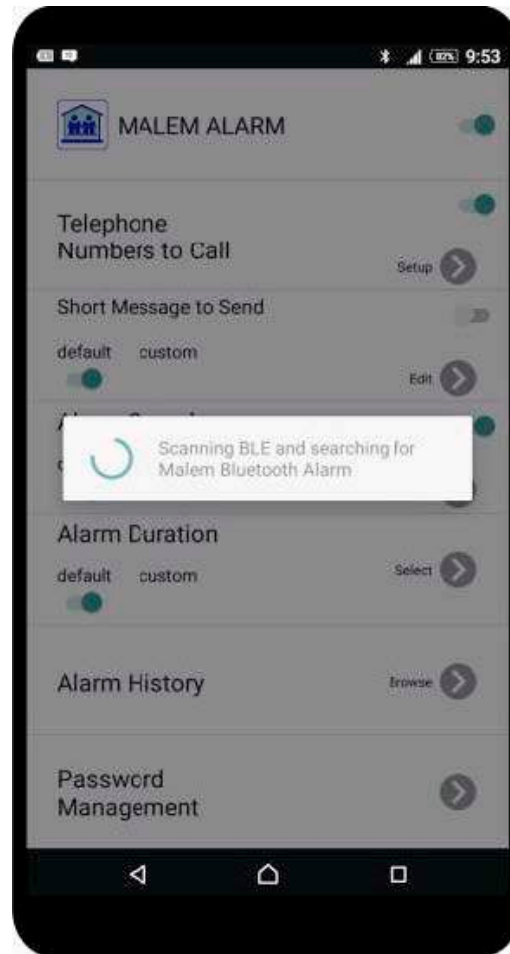

- e) Main menu activated after linkup
- f) Touch the ON/OFF button at the MALEM ALARM heading column to set the alarm to ON (Green)

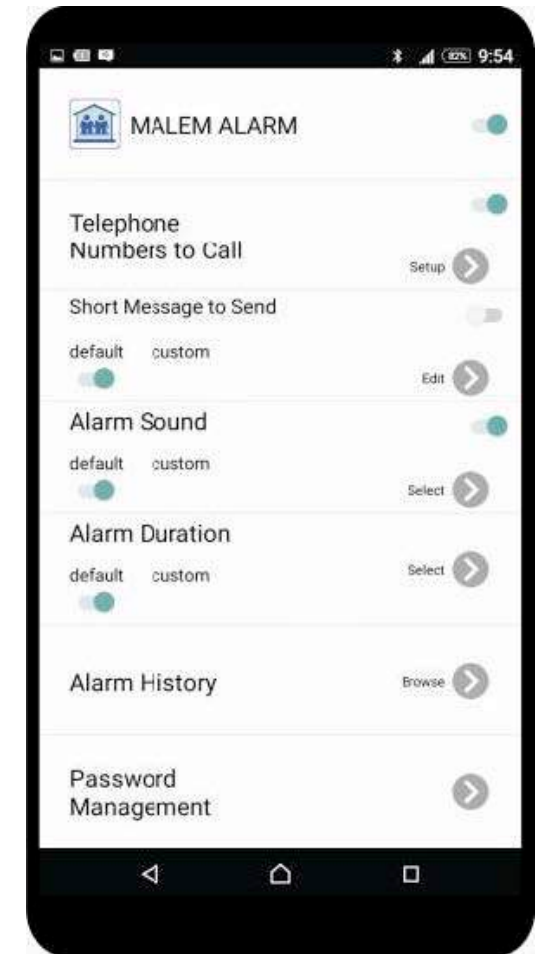

Installation and Setup

Telephone Number Setup (maximum 3 telephone numbers)

- a) Touch the telephone ON/OFF switch to set the function ON in the telephone column
- b) Touch the arrow key in the telephone column to access the telephone number settings page

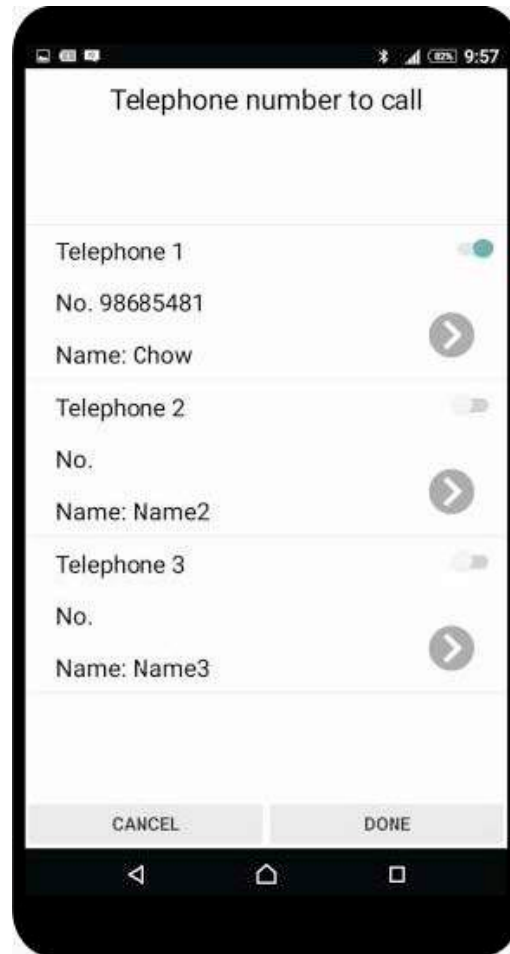

- c) Touch the arrow key in the telephone 1 column to access the telephone phonebook
- d) Select the contact in the phonebook
- e) The program will go back to the telephone settings page automatically
- f) The selected phone number will be shown on the telephone 1 column
- g) Set the ON/OFF selector to ON to activate telephone 1
- h) Set other telephone numbers as above if necessary
- i) Touch the DONE key to return back to the main menu

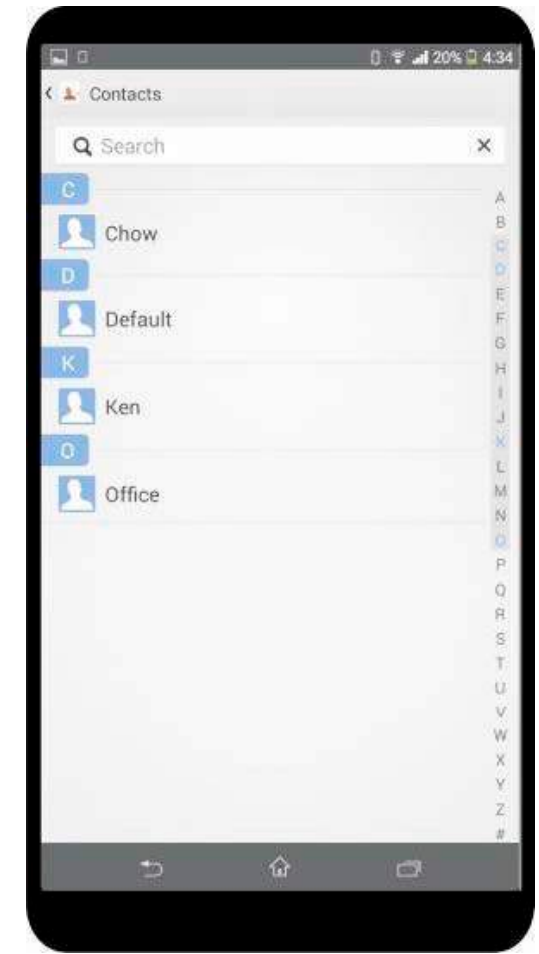

Installation and Setup

Short Message Edit

- a) Set the message function to ON in the short message column by touching the ON/OFF switch
- b) Set the default/custom switch to custom
- c) Touch the arrow key in the short message column to enter the message edit page
- d) Edit your own custom message

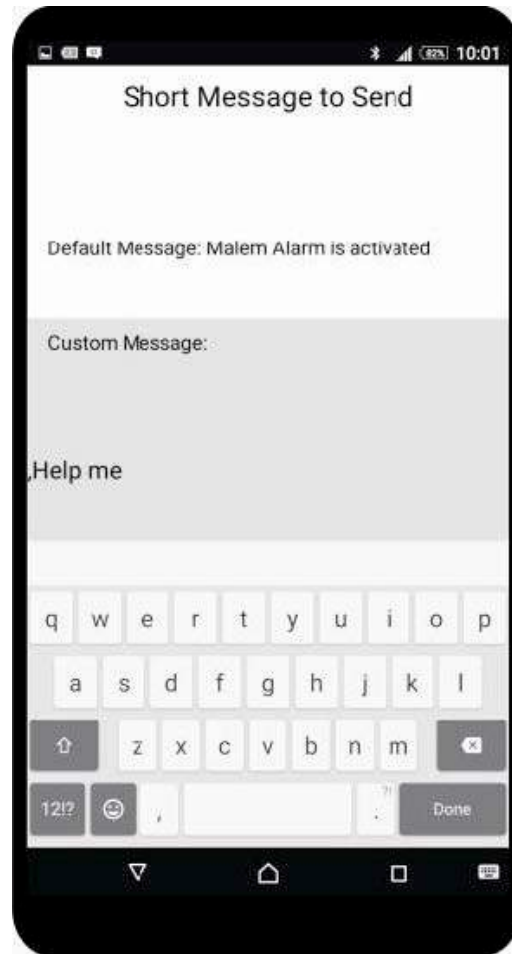

- e) Touch the DONE key return to the sub-menu
- f) Touch the DONE key to go back to the main menu
- g) Select default or custom message in the short message column by touching the default/custom switch
- h) Default message is "Malem alarm is activated"

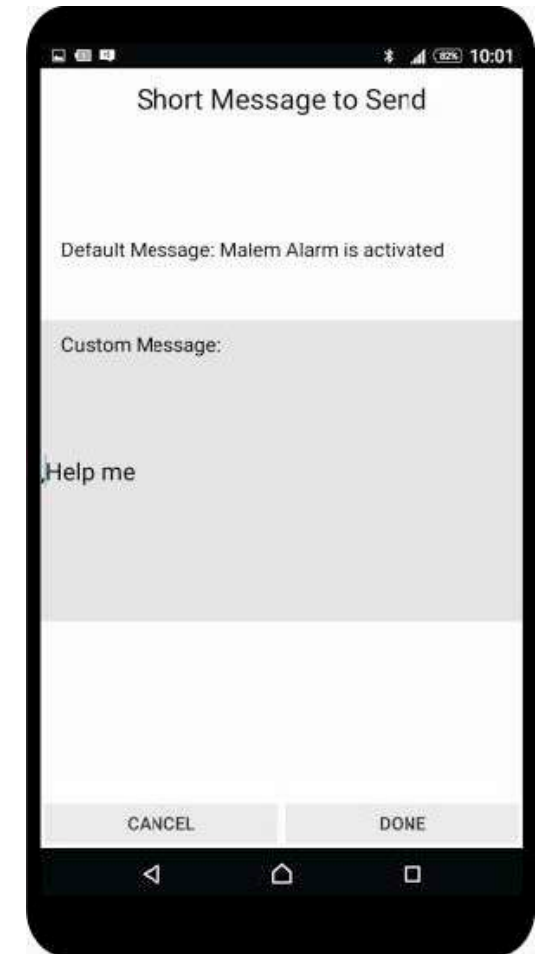

Installation and Setup

Alarm Sound Select

- a) Set the alarm sound function ON in the alarm sound column by touching the ON/OFF switch
- b) Set the default/custom switch to custom by touching the switch
- c) Touch the arrow key in the alarm sound column
- d) Enter the alarm sound select page
- e) Select desired alarm sound
- f) Touch the DONE key to go back to the main menu
- g) Select default or custom alarm sound in the alarm sound column by touching the switch

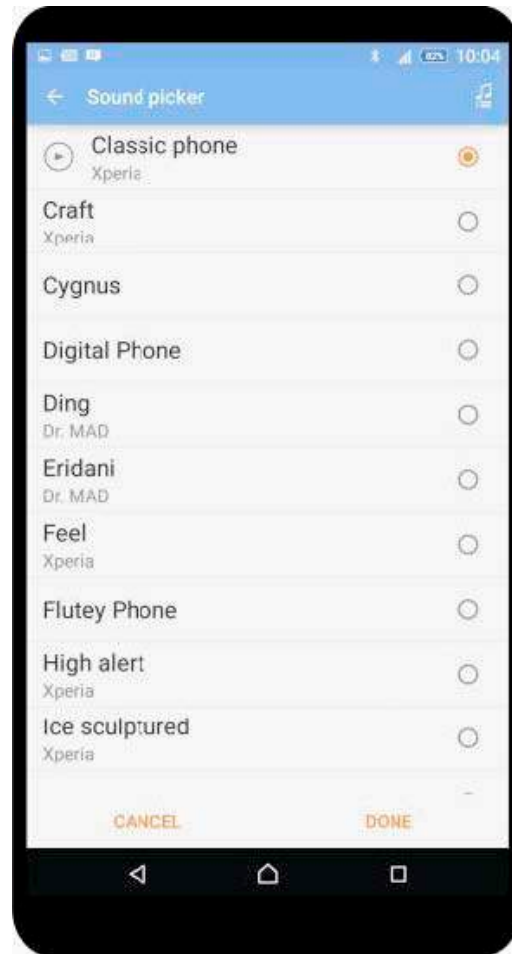

Alarm Duration Select

- a) Set the default/custom switch to custom in the alarm duration column
- b) Touch the arrow key in the alarm duration column to enter the duration selection page
- c) Select desired alarm sound duration
- d) The telephone call will only occur after the alarm sound has stopped/finished
- e) Touch the DONE key to go back to the main menu
- f) Select default or custom duration in the alarm duration column
- g) Default duration is 10 seconds

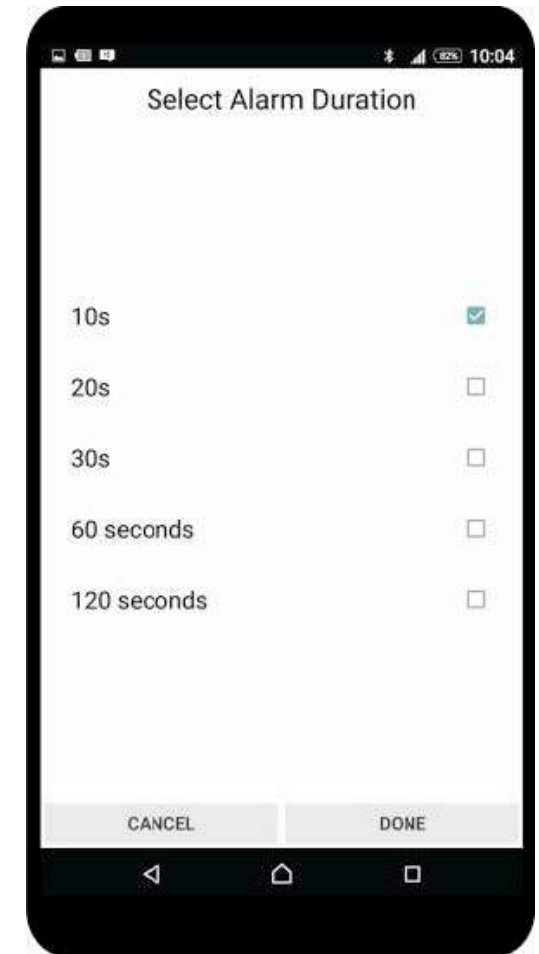

Installation and Setup

Alarm History Browser

- Touch the arrow key in the alarm history column to enter the history browser page
- Slide the screen up and down to browse the list of records
- Touch the GRAPH key to enter the statistic bar chart page
- The bar chart graphic shows the number of times the alarm has been activated per day

Index	Date	Time	Duration
#12	04/08/2015	11:21	1:55
#11	04/08/2015	11:20	1s
#10	04/08/2015	11:19	5s
#9	04/08/2015	11:17	30s
#8	04/08/2015	11:15	55s
#7	04/08/2015	11:14	1s
#6	31/07/2015	11:12	1s
#5	31/07/2015	11:12	1s
#4	31/07/2015	11:11	1s
#3	29/07/2015	11:10	1s
#2	28/07/2015	11:08	1s
#1	28/07/2015	10:52	1s

- Touch the left or right arrow to move the date column
- The records can be sent by email in text format
- Touch the EMAIL key to enter the email address
- Touch the BACK key return to the main menu

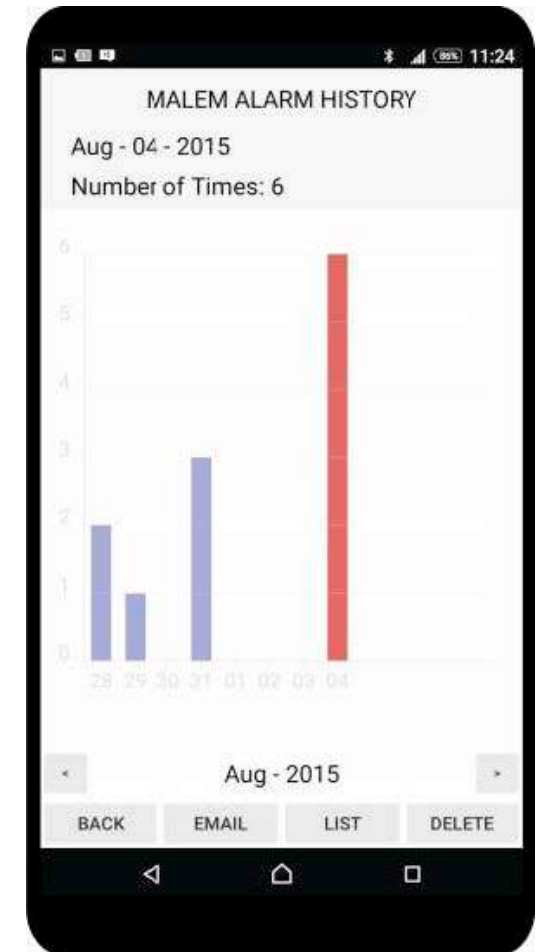

Installation and Setup

Record Deletion

- Touch the DELETE key in the alarm record list or bar chart graphic
- The password Input page will be appear if a password has been set
- Enter the password to delete the records
- Confirm message will appear if the password has not set

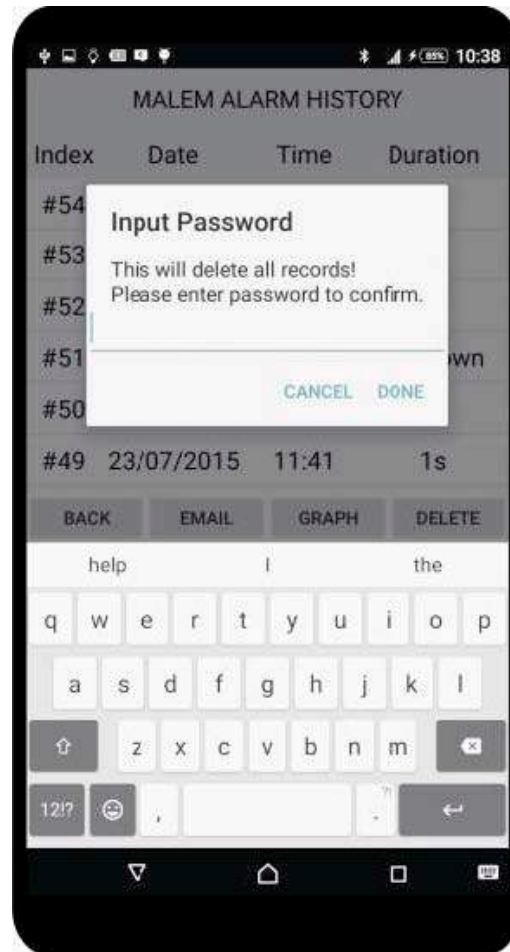

- Touch the confirm key to delete the records
- Touch the BACK key to return to the main menu

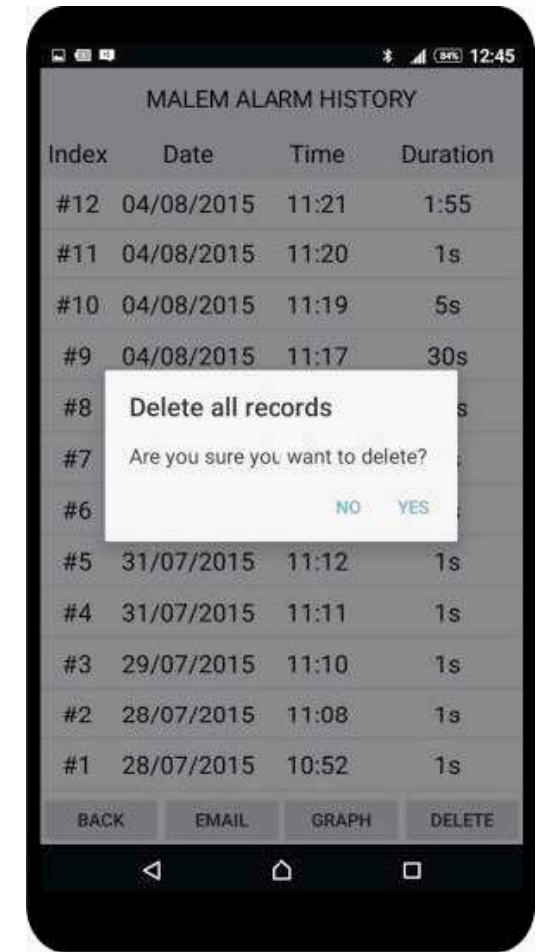

Installation and Setup

Password Setting

- a) Touch the password management column on the main menu to enter the password setting page
- b) Set the ON/OFF switch to ON

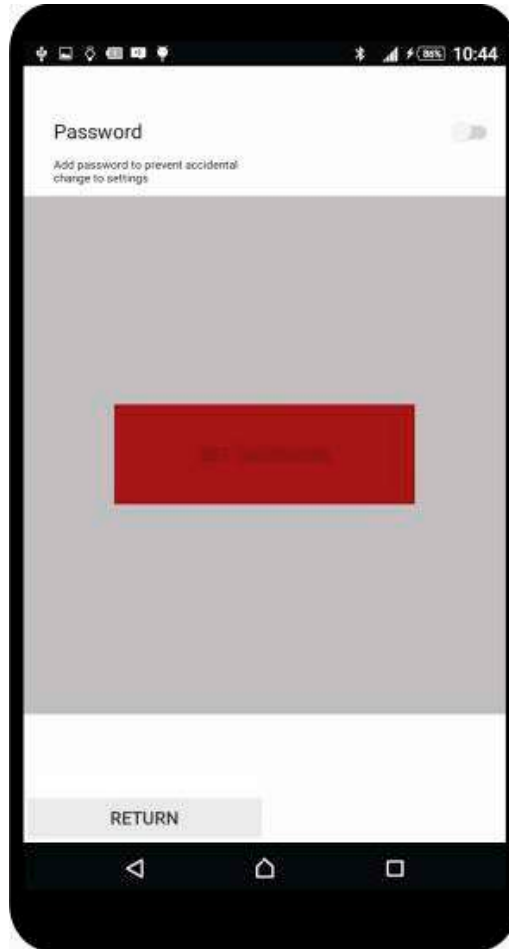

- c) Password setup window appears

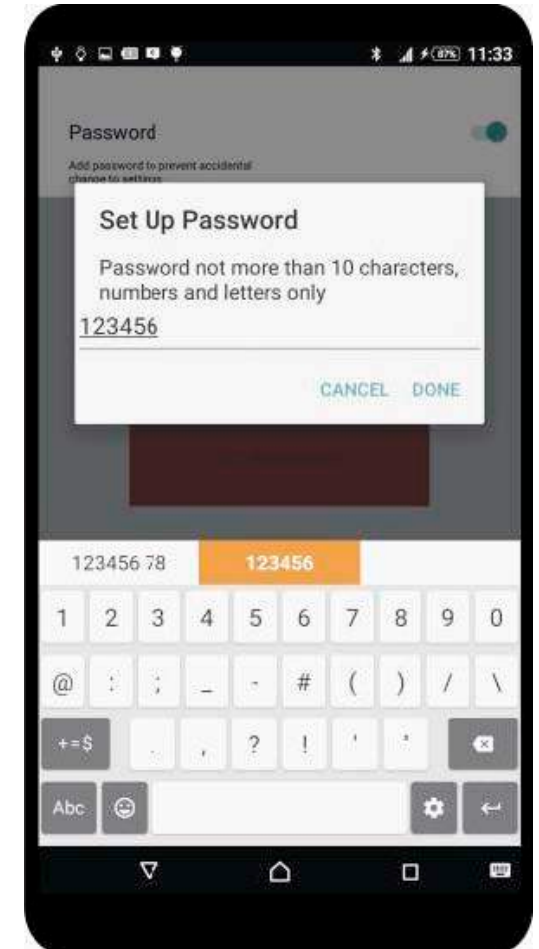

Installation and Setup

- d) Enter the password in the pop-up window and touch DONE
- e) Confirm page appears



- f) Re-enter the password in the confirm window and touch DONE
- g) Password set successfully

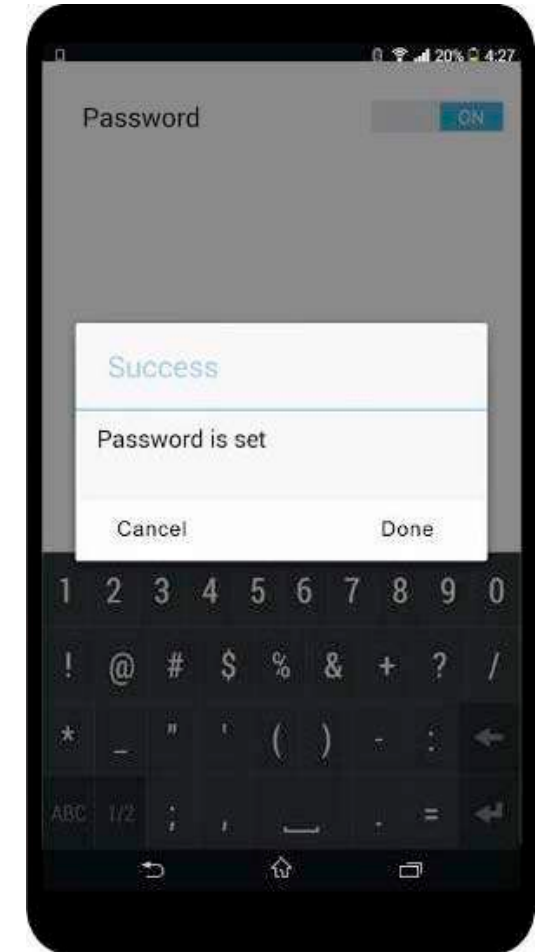

Installation and Setup

- h) Touch DONE to return to the password setting page
- i) Touch RETURN to go back to the main menu



Unlocking Settings

- a) After password setup the system will be locked and will not allow any changes to the settings
- b) The following window will appear to allow changes to the settings
- c) Input the password and touch the DONE key
- d) The system will unlock and return to the main menu
- e) All settings can be changed at this stage
- f) The system will lock again automatically after 2 minutes if no key is activated

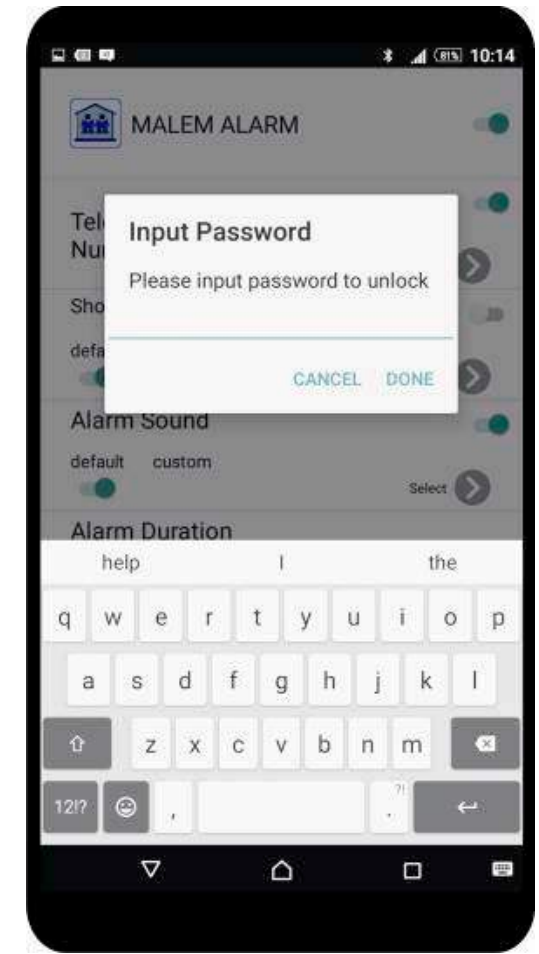

Installation and Setup

Cancel Password

- a) Touch the password management key
- b) The following window will appear

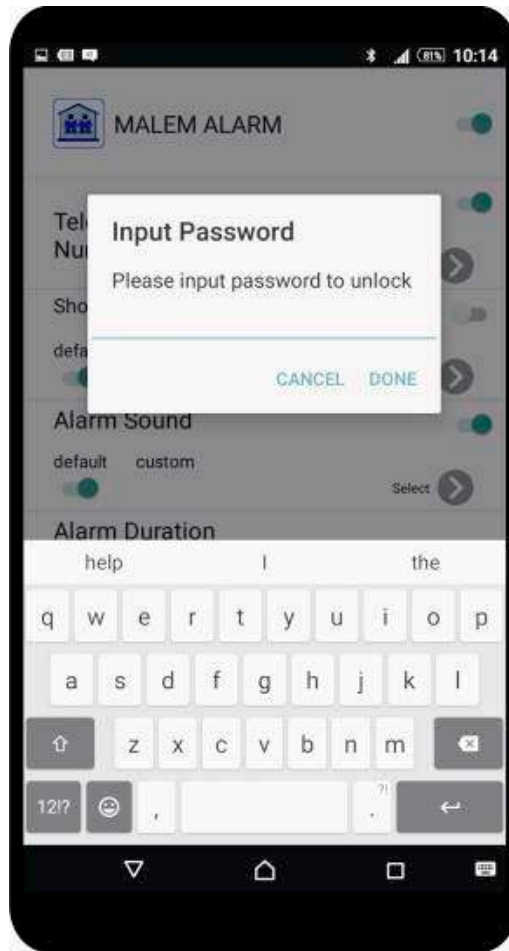

- c) Enter the password and touch the DONE key
- d) The system unlock and return to the main menu
- e) Touch the password management key again to access the password setting page

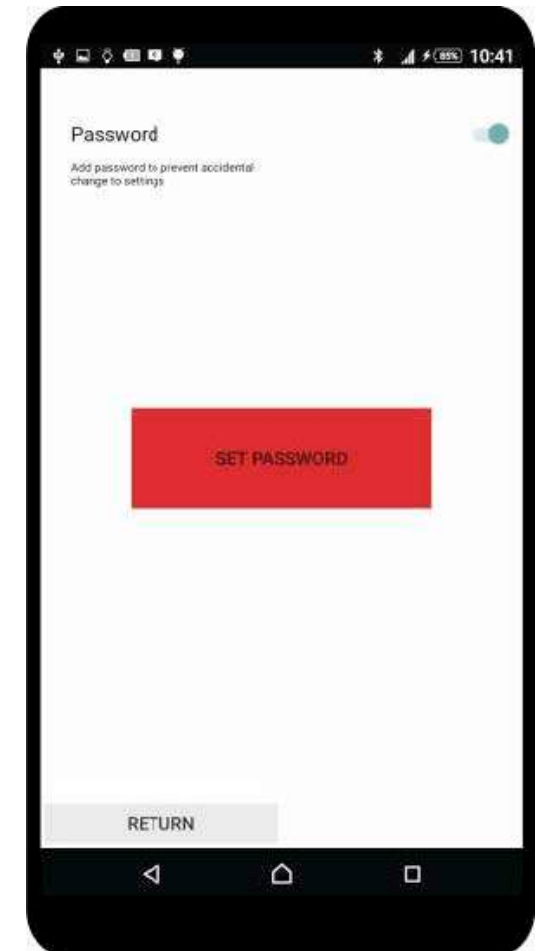

Installation and Setup

- f) Set the ON/OFF switch to OFF
- g) The password input window will appear

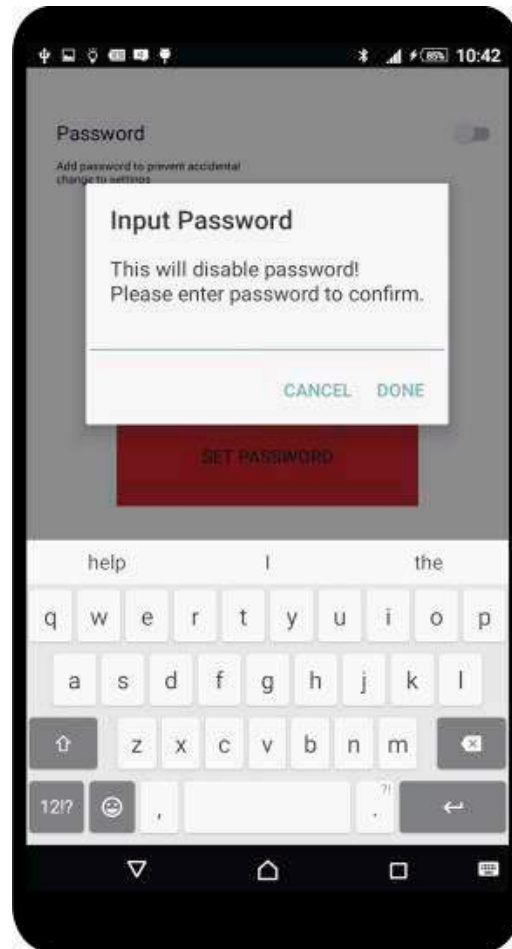

- h) Enter the password and touch DONE to confirm
- i) Password successfully cancelled
- j) Touch RETURN to go back to the main menu

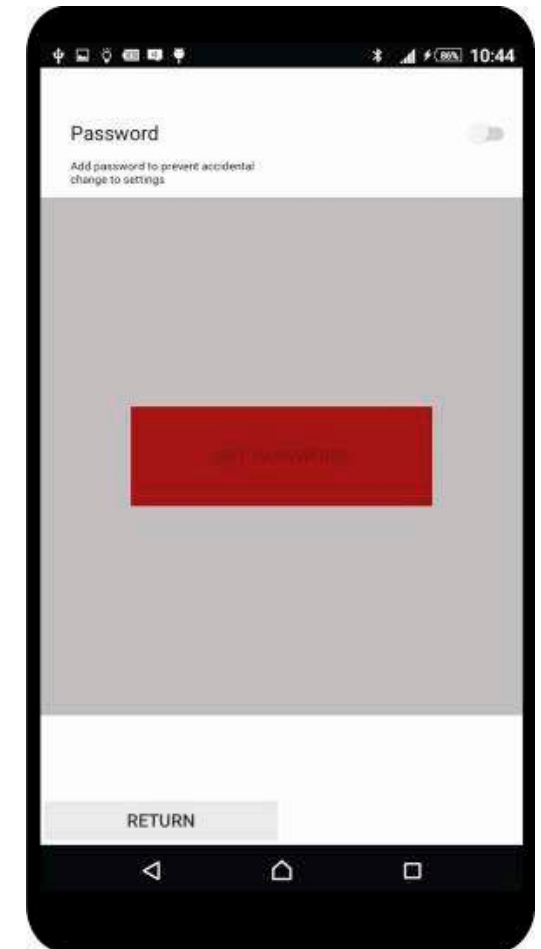

Installation and Setup

Operation

- a) Touch the Malem Alarm shortcut icon on the smartphone desktop
- b) Power ON the Alarm (The switch is under the water resistant cover)
- c) Wait until the alarm links up with the App and the main menu is activated (Ensure bluetooth is activated on the phone)
- d) Set the Malem Alarm App to ON
- e) Clip the alarm to the top of any close fitting underwear. Then clip the Easy-Clip© sensor to the appropriate position on the outside of the underwear
- f) The alarm will activate the App when wetness is detected
- g) The smartphone alarm will sound. You can silence the alarm by touching the stop key
- h) The smartphone will then send a short message(s) respectively to the selected numbers

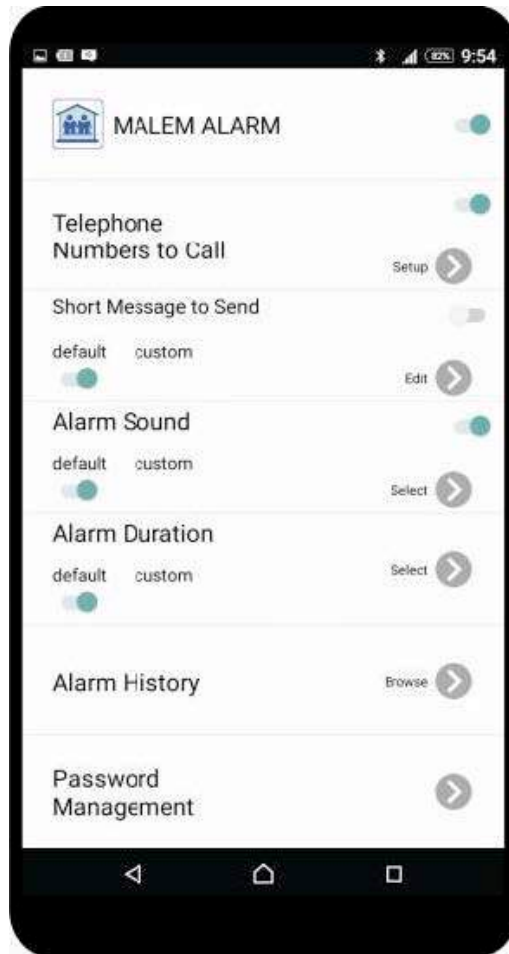

- i) The phone will then dial the selected numbers in order
- j) The phone will then go back to stand-by mode
- k) Steps h) to j) will repeat after 10 minutes if the alarm sensor remains wet
- l) In case the alarm and App become disconnected the alarm will sound and a pop-up window showing "Scanning BLE....." will appear on the screen
- m) The main menu will activate again automatically after link up
- e) LED will glow brightly when fully charged
- f) Remove the charging cable
- g) LED flash twice per second
- h) Link-up the alarm to the Malem alarm App
- i) We strongly advise charging the alarm unit daily when not in use
- j) Please ensure the Easy-Clip© sensor lever is always in the up position when the alarm is not in use

Battery Charge

- a) Plug in the USB cable and connect the Alarm to the computer or any 5V 0.5A power source (similar to telephone charging)
- b) Slide the alarm power switch to the ON position
- c) LED flashes once per second
- d) Charging time around 3 hours

Installation and Setup

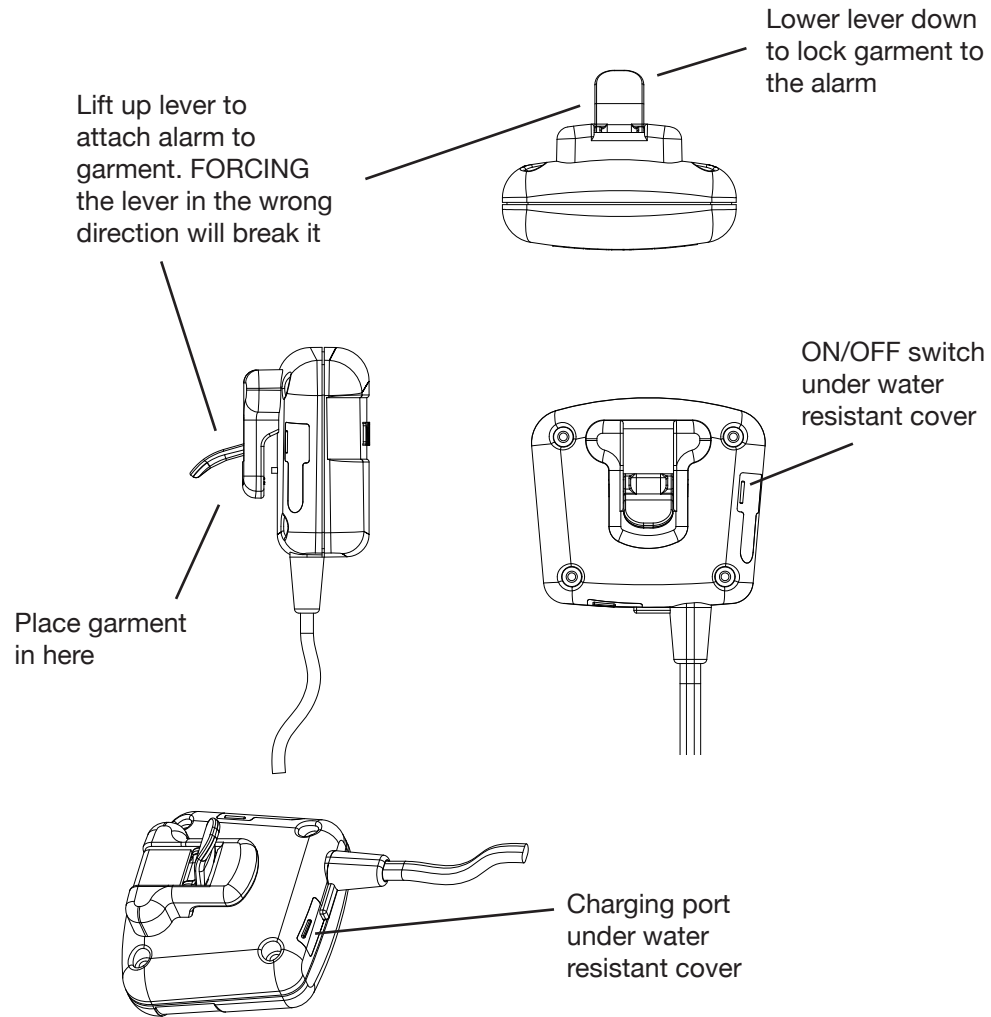

Lowering the lever without any dry material in the jaws will trigger the alarm and prevent the alarm from resetting. Lift the lever and press the STOP button on the smartphone.

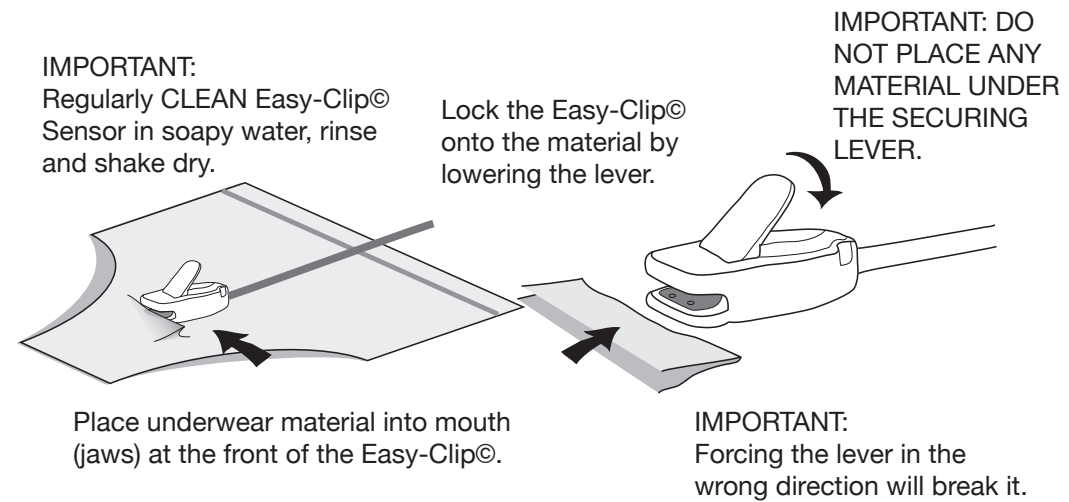

Installation and Setup

LED Indication Table

Status	LED Action
Stand-by	Flashes once every per 3 seconds
Successful Link-up with Sensor	LED glows brighter for 3 seconds
Sending Data	LED glows brighter for 3 seconds
During Battery Charging	Flashes once every second
Battery Fully Charge	LED glows brighter until charging cable is removed
Battery Low Voltage	Flashes 3 times every second
Off link with App	Flashes twice every second

Disclaimer

Malem™ Alarms are designed as a helpful aid. They are not intended to replace human care or supervision and the manufacturer, Malem Medical, is not responsible for any consequences resulting from the use, misuse or failure of this device.

The manufacturer reserves the right to change specifications without prior notice.



Alarms cure by speeding up the natural process

Malem Medical Ltd, 10 Willow Holt, Lowdham
Nottingham NG14 7EJ, England, UK
Tel: + 44 (0)115 966 4440 Fax: + 44 (0)115 966 4672
E-mail: malem@malem.co.uk
Web: www.malem.co.uk Web: www.malemmedical.com