

GEM+ | Data Sheet

GEM+ Front Light

GEM+ Rear Light

Light Mode(s)

High constant, medium constant, medium constant + flash
Pulse, strobe, eco-flash

High constant, medium constant, medium constant + flash
Pulse, strobe, eco-flash

Brake light: Constant, strobe, off

In the Box

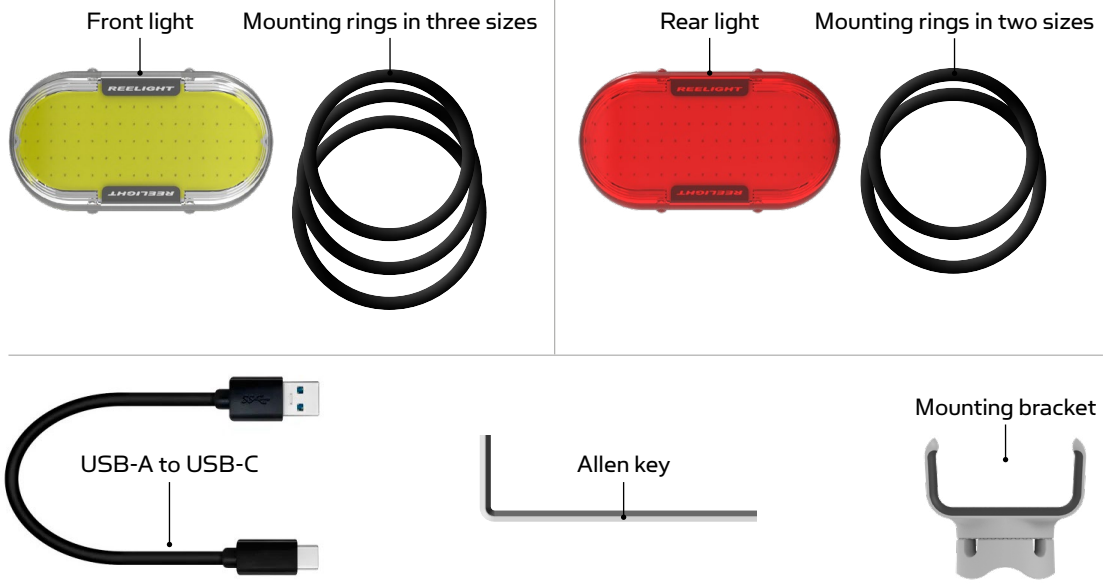

Size and Weight

Light unit (incl. battery): 40 g / 1.41 oz
Battery: 15 g / 0.53 oz
Bracket: 17 g / 0.6 oz
Total: 57 g / 2.01 oz

Light unit (incl. battery): 40 g / 1.41 oz
Battery: 15 g / 0.53 oz
Bracket: 17 g / 0.6 oz
Total: 57 g / 2.01 oz

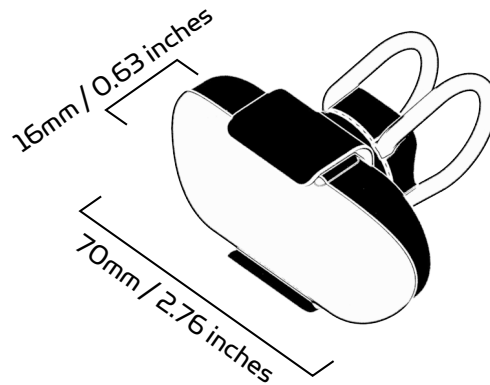

IP rating

IPX4: Protected against low pressure water stream from any angle.

GEM+ Front Light

GEM+ Rear Light

Light Output

High constant: 200 lumen / Pulse: 200 lumen
 Medium constant: 80 lumen / Strobe: 160 lumen
 Medium + flash: 80 - 320 lumen / Eco-flash: 25 lumen

High constant: 75 lumen / Pulse: 75 lumen
 Medium constant: 35 lumen / Strobe: 50 lumen
 Medium + flash: 35 - 150 lumen / Eco-flash: 15 lumen

Burn Time

High constant: 3 hours / Pulse: 11 hours
 Medium constant: 6,5 hours / Strobe: 9 hours
 Medium + flash: 6 hours / Eco-flash: 86 hours

High constant: 2 hours / Pulse: 7 hours
 Medium constant: 4 hours / Strobe: 6 hours
 Medium + flash: 4 hours / Eco-flash: 82 hours

Legal Requirements

Bike lights are tested and approved in conformity with:

- Danish legislation according to decree BEK no. 976, 28-06-2016

Retail Packaging

Version: V1
 Box size: 125 x 85 x 32 mm
 Weight: 107 g / 3.77 oz
 Item no.: RE-21001
 GTIN13: 5708441210013

Version: V1
 Box size: 125 x 85 x 32 mm
 Weight: 102 g / 3.6 oz
 Item no.: RE-31001
 GTIN13: 5708441310010



Whole Sale Unit

Inner carton: 195 x 178 x 140 mm (10 pcs)
 Weight: 1,1 kg / 2.43 lb
 Volume: 0,0049 m³
 GTIN14: 15708441210010

Inner carton: 195 x 178 x 140 mm (10 pcs)
 Weight: 1,1 kg / 2.43 lb
 Volume: 0,0049 m³
 GTIN14: 15708441310017

Master carton: 210 x 185 x 695 mm (5 x 10 pcs)
 Weight: 5,5 kg / 12.13 lb
 Volume: 0,0270 m³
 GTIN14: 25708441210017

Master carton: 210 x 185 x 695 mm (5 x 10 pcs)
 Weight: 5,5 kg / 12.13 lb
 Volume: 0,0270 m³
 GTIN14: 25708441310014

GEM+ Front Light**GEM+ Rear Light****Declaration of
Conformity**

The product(s) detailed in this document is / are in conformity with the following EC Directives, including all amendments:

- Directive 2001/95/EC on general product safety.
- Directive 2011/65/EU (RoHS Directive) on the restriction of the use of certain hazardous substances in electrical and electronic equipment.
- Directive 2014/30/EU on Electromagnetic compatibility (EMC Directive).
- Directive 2012/19/EU on waste electrical and electronic equipment (WEEE Directive).
- Directive 94/62/EC on packaging and packaging waste (PPW Directive).
- Directive 2009/125/EC establishing a framework for the setting of eco-design requirements for energy-related products (Ecodesign Directive).

The following harmonized standards have been applied:

- Cenelec EN 50581:2012 Technical documentation for the assessment of electrical and electronic products with respect to the restriction of hazardous substances.
- Cenelec EN 55015:2013 Limits and methods of measurement of radio disturbance characteristics of electrical lighting and similar equipment.
- EN 13427:2004 Packaging - Requirements for the use of European Standards in the field of packaging and packaging waste.
- EN 13428:2004 Packaging - Requirements specific to manufacturing and composition - Prevention by source reduction.
- EN 50419:2006 Marking of electrical and electronic equipment in accordance with WEEE Directive.
- EN 13431:2004 Packaging - Requirements for packaging recoverable in the form of energy recovery, including specification of minimum inferior calorific value.

Reelight declares that none of the substances listed in the Candidate List of substances of very high concern for Authorisation (<https://echa.europa.eu/candidate-list-table> - as of date of signing) in accordance with Article 59(10) of the REACH Regulation are intentionally added or used in the product(s) detailed in this document.

Full name and identification of the person responsible for product quality and accordance with standards on behalf of the manufacturer:

Date:
01-06-2023

Place:
Hasselager Centervej 11 st.
DK-8260 Viby J

Jes Jakobsen
Product Manager