

all ABOUT US

Furnished with jaw-dropping feature walls and elegant furnishings, this four-bedroom family home perfectly embodies all of the homeowners' favourite things

TEXT Germaine Cheah PHOTOS Wong Weiliang

AT A GLANCE



SPACE

4-bedroom condominium unit



LOCATION

Faber Walk



RENO PERIOD

6 weeks



HOME TO

2 adults, 2 children



OVERALL

Wanting to create a bigger space that could accommodate more friends and family whenever necessary, the original dining and living spaces were swapped. While the addition of 1m-high purple wainscoting that lines the space evokes a English Victorian feel to the space, the use of contemporary elements like a dining table from Danish Design Co and dining chairs from BoConcept help to transform it into a modern space.



Not many people would want to take on the daunting task of coordinating their home's renovation without the help of an interior designer, but for mummy blogger Liang May and her husband Meyer Yang, it was a natural – and simple – decision. Realising that they already had such a strong sense of how they wanted their home to look like, the couple decided to cut out the middleman and take matters into their own hands. They then scoured sites like Instagram, Pinterest and other design websites to put together a mood board that would help to clearly relay their intended design concept to their contractor.

Retaining the kitchen and the common and master bathrooms as how the developer designed it, the homeowners concentrated on imparting each inhabitant's personalities into the communal spaces and bedrooms. For starters, the living and dining room's

THE YANG FAMILY
Homeowners Meyer Yang and Liang May (together with their children Yang Jing Faye and Yang Ewan) took it upon themselves to conceptualise and coordinate the renovation of their home with the help of artisans and contractors.



Brass pendant lamp from Meraki Decoration

LIVING ROOM

Living up the space is the addition of black wall shelves that serves as a platform to display flowers and ferns. In addition to Patricia Braune's Island Frond Moonlit wallpaper design next to the corridor, three paintings by local botanical artist Sarah Lim of Poppy Flora Studio beneath the shelf further accentuates the nature theme and is complemented well by the gold-trimmed wall mirror that hangs just beside.



placements were swapped, offering the family of four a bigger space to accommodate visitors whenever necessary. And to highlight the unit's high ceilings, 1m-high wainscoting was added along the walls to. Believing that a living room – or in this case, a dining-cum-living-room – should cultivate meaningful conversations and genuine interactions instead of being a space where everyone just sits around with their eyes glued to the television, the omission of a television set serves a practical purpose for the homeowners and their hosting duties.

Largely inspired by art murals, the dining zone's botanical-inspired wallpaper was just the start of the family home's many eye-catching feature walls. With the help of local custom wallpaper specialist LayerPlay Design, they installed Patricia Braune's



Island Frond Moonlit wallpaper design that was provided by bespoke wallpaper company Robin Sprong, chosen for the blue-base and gold accents that would complement the space's design theme. Meanwhile on the opposite wall, two customised wall shelves allow for the display of family trinkets and ornamental decor. Unable to find ready-made shelves tall enough to complement the high ceilings, Liang May had the shelves customised, which the carpenter made from plywood and finished with dark woodgrained laminates, complete with a white backing to create a seamless continuity with the rest of the wall. A giraffe canvas painting by animal artist Thierry Bisch ties the two wall features together.

When it came to her son Ewan's room, Liang May's heart was set on a monochromatic



Dining room feature wall
Wallpaper from LayerPlay Design

DINING ROOM

In the dining room, two customised display shelves, made from wood and lined with dark woodgrained laminates, house the family's trinkets and other ornamental decor. For visual consistency, the backing of the shelves was swathed in white paint to match the surroundings.

SON'S BEDROOM

Going with a monochromatic colour theme, the son's bedroom was clad in black paint and fitted out with black-and-white wall decor to further accentuate the design concept. The wall paint was purposely left unfinished three-quarters upwards to prevent the space from feeling too dark. For safety reasons, the once laminated staircase was overlaid with black carpet to prevent the slippery surface from tripping up the young occupant when going up and down the stairs.



colour scheme. However, not wanting to create a space that would seem too “adult” for the young boy, she decided on a Batman theme that the 5-year-old would not only love, but one that would also fit into her design plans as well. With the help of Nippon Paint’s professional painters, the adjoining wall next to the loft staircase was painted in black from the floor to roughly three-quarters of the way up, with the unfinished look creating the illusion of the various buildings and skyscrapers found in Gotham City. Further accentuating the superhero theme was the use of multiple Batman wall decals and a three-dimensional wall hook from local children’s lifestyle store Owl Bliss. As the loft structure was from the developer, the original staircase finish was made from laminates and had many sharp edges.

DAUGHTER'S BEDROOM LOFT

Made from timber, the loft structure was specially installed to encompass the young occupant's playroom and library, complete with wall shelves that serve as a landing spot for storybooks. Meanwhile, the space is highlighted by a hand-painted watercolour mural that evokes a sense of dream and fantasy in the space.

Foreseeing that the kids may tumble and fall if not careful, the couple made another thoughtful modification in the room by lining the staircase in black carpet to make the space kid-friendly. Moving on to daughter Faye's bedroom, the space features various shades of dusty pink that is befitting the young occupant. Steering clear from a typical children’s bed, Liang May worked with custom interior decor shop Urban Li'l to create a bespoke house-framed bed, including a chimney. The bed frame was also designed for long-term usage in mind, offering the option of being converted into a playpen should Faye outgrow the bed. For the wallpaper, Liang May chose Daleen Roodt's Satyrium Occellatum wallpaper design as the timeless design meant that there wouldn't be a need to change the



DAUGHTER'S BEDROOM

Featuring various shades of a dusty pink, this bedroom is home to a customised house-framed bed. While now flushed against the wall, the frame can be elevated depending on preference. Sitting directly across the customised bed is a clothes rack, made out of wood and painted white on the ends, that displays some of the little girl's clothes.

MASTER BEDROOM

The master boudoir is characterised by a feature wall layered over with boldly-designed wallpaper, bringing the botanical design theme from the communal zone into the private living space. The room also features a customised solid wood bar counter that doubles up as a workstation for the occupants' late night work sessions. Black metal rods were added to the bar counter to give it an industrial feel.



Bedroom feature wall
Wallpaper from LayerPlay Design

MASTER BEDROOM LOUNGE

Creating an en-suite living room that follows the style of most hotel rooms, the master bedroom's lounge area features a television cabinet that replaced an original wardrobe. The cabinet also features display shelves for photographs as well as storage units for the homeowners' accessories. Next to the cabinetry, a full-length Donna Solovei's Red Lines and Circle wallpaper design adds visual interest to the space.

wallpaper as Faye grows up. Similar to her brother's room, Faye's personal space also features a full-timber loft structure, specially constructed and installed by the carpenter. Up on the loft hides the little girl's playroom and library, highlighted by a watercolour feature wall of carousel and fairy lights.

As the original layout of the master bedroom was compact, the couple made a decision to hack a hole in the wall to combine the master bedroom and an adjoining bedroom to create an expanded private living space. This space also encompasses two of the four wallpaper feature walls in the home. The first one is Room 13's Botanical design that sits at the bed's rear wall, and the second is Donna Solovei's Red Lines and Circle that sits on the opposing wall. To cater to a home theatre system, the original wardrobe in the master bedroom was removed and replaced with a television-cum-display cabinet made from a wooden frame and finished with grey laminates. The final modification made in this room was a solid wood bar counter customised by local design studio WoodFix, and framed by black metal rods. Installed on the plain wall next



SMART TWEAKS

Existing wardrobe knocked down in favour of a television display cabinet

Partition wall between original master bedroom and adjoining room knocked down to create an expanded master boudoir

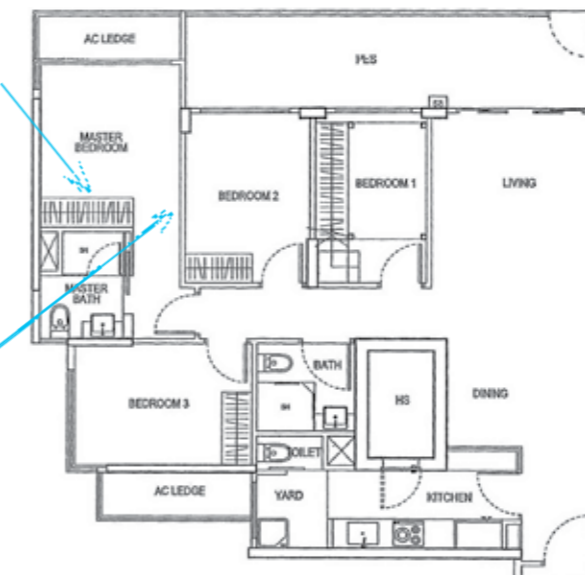

to the pull-out sofa bed, the bar counter offers a cosy area for the couple to complete their work before heading to bed.

The self-helmed project wasn't without its fair share of challenges though. For one, the homeowners weren't experienced in the art of interior design, and found themselves doubting if the colours and designs they chose for respective furnishings and fittings would complement each other in the same space. Secondly, Meyer's job and EMBA studies saw him travelling quite frequently, leaving Liang May to oversee and make decisions for quite a fair bit of the project by herself. But if anything, this savvy couple is the perfect example of how anyone can create their dream home even without the help of an interior designer. All you need is a solid design concept, the courage to make adventurous choices, and a good working collaboration with all parties involved.