

**Step 1** Examine the break & prep the glass. Ideal glass temp should be 35°F to 85°F. Test break stability by applying small amount of pressure with probe around the break.

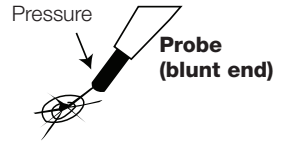

**Step 2** Clean loose debris with probe point. If impact point can't be felt, drill to create an opening. Many breaks will not need to be drilled. Attach mirror to inside of glass.

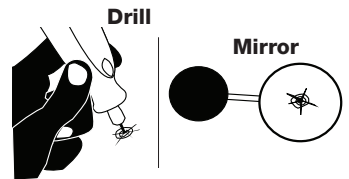

**Step 3** Place the Vanish Bridge on the glass, pressing down until suction cups are fully depressed, centering over the break.



**Step 4** Insert Injector body into bridge, lining up SpeedLock knob with line on bridge. Give injector body a quarter turn to seat seal.

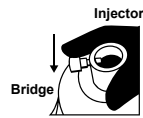

**Step 5** Use mirror to adjust horizontal alignment, moving the bridge to ensure a good seal on the break.

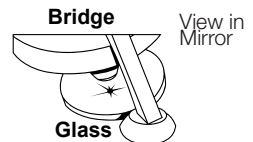

**Step 6** Apply HV resin to the Grey Plunger Seals at base of plunger to lubricate.

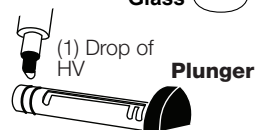

**Step 7** Apply 5 drops of Diamond Clear™ Resin into the injector body. Check GT Tools® Catalog for proper resin choice.



**Step 8** If outdoors, place a UV Sunshade (GT Tools® Part# SS) over the Repair Area.

**Step 9** Pull the Silver Release Pin knob on the side of the injector body and insert the plunger into the injector body. Release the pin, twisting until the pin slips into the plunger groove.

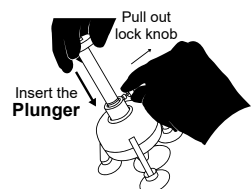

**Step 10** Vacuum Cycle: Depress OneTouch Button, Bottom out plunger, slowly pull plunger up and twist to lock in vacuum. Wait 1 Minute.

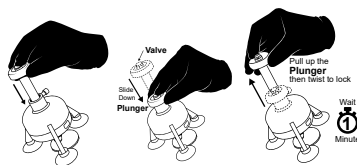

**Step 11** Pressure Cycle: Depress OneTouch Button, twist plunger, depress until there is fair resistance, twist plunger to lock into desired pressure slot. Wait 2 Minutes.

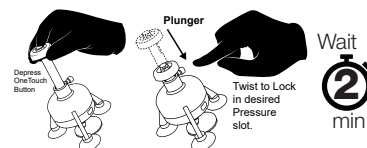

**Step 12** Alternate between cycles of step 10 (Vacuum: 1 min) and Step 11 (Pressure: 2 min) until break is completely filled.



**Step 13** During Final Pressure Cycle: Press Power Button on side of Vanish Bridge to turn on for curing cycle. Wait 15 seconds for cure to finish.

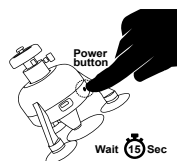

**Step 14** Depress OneTouch Button, Remove Injector Body from Bridge, Apply small bead of PF above the pit on glass.

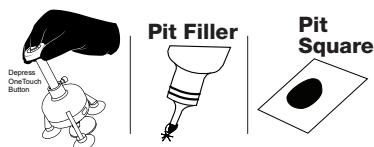

**Step 15** Press Power Button on Vanish Bridge to cure the pit for curing



**Step 16** Remove Bridge & Pit Square. Scrape clean razor blade (held perpendicular to glass) vigorously back & forth until only a small circle of pit filler remains.



**Step 17** Apply small bead of Pit Gloss to the pit. Polish with paper towel or cork until glossy finish achieved.



**Step 18** Clean the glass. Clean ALL injector components with isopropyl alcohol at the end of each day. DONE!

**CLEAN EVERYTHING**