

5' SMALL



*Optional 200 watt halogen lights



*Package includes padded nylon travel bag

Graphic Specification

Graphic Size: 83.54W " x 59.92H" (includes 11.81" end panels on both sides)

Product Features

Our ultra lightweight aluminum alloy fabric pop-up display in a matte satin anodized finish is an ideal eye-catcher for your trade show, exhibition, or conference. Its versatility and simple 2-minute setup, as well as its Velcro attachment, makes it functional for special events as well as an in-office promotional tool for walk-in customers. Another convenient feature is that your graphic stays attached in your free travel/carry bag that comes with each frame you purchase.

Graphic Size	83.54"W x 59.92"H
Display Size	60"W x 60"H x 12"D

Finishing

2" loop Velcro perimeter

Printing Material	Fabric
-------------------	--------

Construction

Aluminum Frame

2" Hook Velcro Strips

Plastic Hooks

Weights - Dimensions

Shipping Weight	15lbs
Shipping Dimensions	34" x 15" x 11"

Parts List

(1) Aluminum Frame	(1) Padded Nylon Carry Bag
(1) Digital Print on Fabric w/ End Panels	

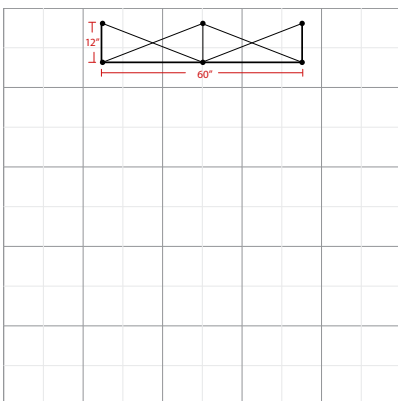

The box represents 10' x 10' booth.

8' MEDIUM STRAIGHT



*Optional 200 watt halogen lights



*Package includes padded nylon travel bag

Graphic Specification

Graphic Size: 112.6W" x 88.98H" (includes 11.81" end panels on both sides)

Product Features

Our ultra lightweight aluminum alloy fabric pop-up display in a matte satin anodized finish is an ideal eye-catcher for your trade show, exhibition, or conference. Its versatility and simple 2-minute setup, as well as its Velcro attachment, makes it functional for special events as well as an in-office promotional tool for walk-in customers. Another convenient feature is that your graphic stays attached in your free travel/carry bag that comes with each frame you purchase.

Graphic Size	112.60"W x 88.98"H
--------------	--------------------

Display Size	89"W x 89"H x 12"D
--------------	--------------------

Finishing

2" loop Velcro perimeter

Printing Material	Fabric
-------------------	--------

Construction

Aluminum Frame

2" Hook Velcro Strips

Plastic Hooks

Weights - Dimensions

Shipping Weight	28lbs
-----------------	-------

Shipping Dimensions	34" x 12" x 14"
---------------------	-----------------

Parts List

(1) Aluminum Frame	(1) Padded Nylon Bag with drawstring
--------------------	--------------------------------------

(1) Digital Print on Fabric w/ End Panels	(1) Wheel Frame for Carry Bag
---	-------------------------------

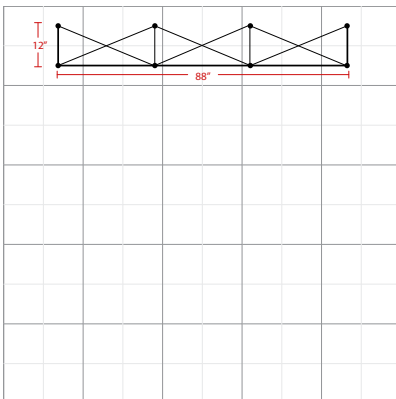

The box represents 10' x 10' booth.

8' MEDIUM CURVED



*Optional 200 watt halogen lights



*Package includes padded nylon travel bag

Graphic Specification
 Graphic Size: 106.75W " x 88.75H" (includes 11.81" end panels on both sides)

Product Features	
Our ultra lightweight aluminum alloy fabric pop-up display in a matte satin anodized finish is an ideal eye-catcher for your trade show, exhibition, or conference. Its versatility and simple 2-minute setup, as well as its Velcro attachment, makes it functional for special events as well as an in-office promotional tool for walk-in customers. Another convenient feature is that your graphic stays attached in your free travel/carry bag that comes with each frame you purchase.	
Graphic Size	106.75"W x 88.75"H
Display Size	90"W x 89"H x 24"D
Finishing	
2" loop Velcro perimeter	
Printing Material	Fabric
Construction	
Aluminum Frame	
2" Hook Velcro Strips	
Plastic Hooks	
Weights - Dimensions	
Shipping Weight	28lbs
Shipping Dimensions	34" x 12" x 14"
Parts List	
(1) Aluminum Frame	(1) Padded Nylon Bag with drawstring
(1) Digital Print on Fabric w/ End Panels	(1) Wheel Frame for Carry Bag

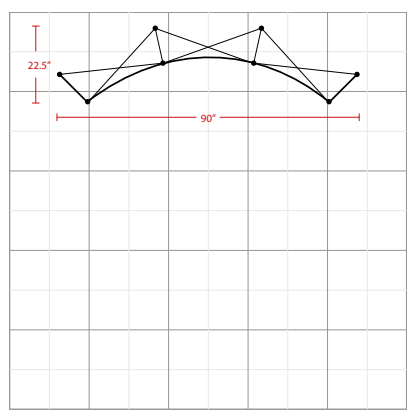

The box represents 10' x 10' booth.

10' LARGE STRAIGHT



*Optional 200 watt halogen lights



*Package includes padded nylon travel bag

Graphic Specification

Graphic Size: 141.50W "x 88.98H" (includes 11.81" end panels on both sides)

Product Features

Our ultra lightweight aluminum alloy fabric pop-up display in a matte satin anodized finish is an ideal eye-catcher for your trade show, exhibition, or conference. Its versatility and simple 2-minute setup, as well as its Velcro attachment, makes it functional for special events as well as an in-office promotional tool for walk-in customers. Another convenient feature is that your graphic stays attached in your free travel/carry bag that comes with each frame you purchase.

Graphic Size	141.5"W x 88.98"H
Display Size	118"W x 89"H x 12"D

Finishing

2" loop Velcro perimeter

Printing Material	Fabric
-------------------	--------

Construction

Aluminum Frame

2" Hook Velcro Strips

Plastic Hooks

Weights - Dimensions

Shipping Weight	35lbs
Shipping Dimensions	34" x 17" x 13"

Parts List

(1) Aluminum Frame	(1) Padded Nylon Bag with drawstring
(1) Digital Print on Fabric w/ End Panels	(1) Wheel Frame for Carry Bag

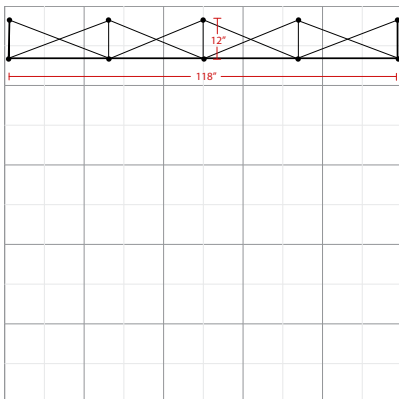

The box represents 10' x 10' booth.

10' LARGE CURVED

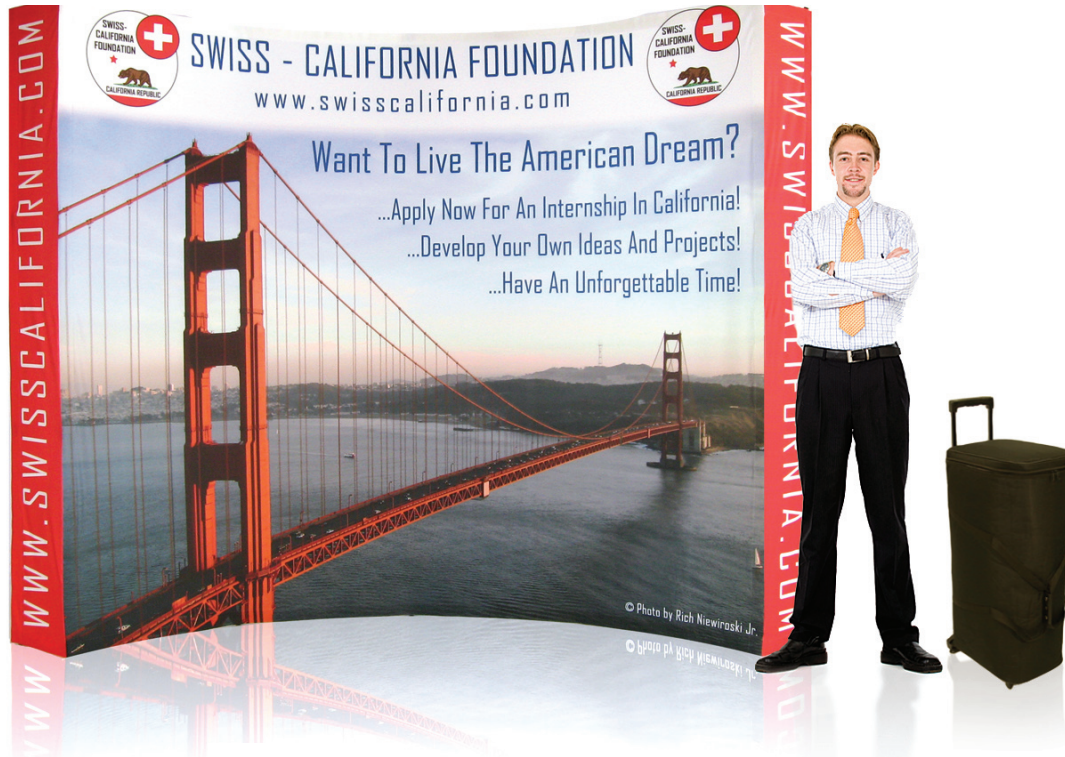

*Optional 200 watt halogen lights



*Package includes padded nylon travel bag

Graphic Specification

Graphic Size: 133.75W " x 88.75H" (includes 11.81" end panels on both sides)

Product Features

Our ultra lightweight aluminum alloy fabric pop-up display in a matte satin anodized finish is an ideal eye-catcher for your trade show, exhibition, or conference. Its versatility and simple 2-minute setup, as well as its Velcro attachment, makes it functional for special events as well as an in-office promotional tool for walk-in customers. Another convenient feature is that your graphic stays attached in your free travel/carry bag that comes with each frame you purchase.

Graphic Size	133.75"W x 88.75"H
--------------	--------------------

Display Size	112"W x 89"H x 35"D
--------------	---------------------

Finishing

2" loop Velcro perimeter

Printing Material	Fabric
-------------------	--------

Construction

Aluminum Frame

2" Hook Velcro Strips

Plastic Hooks

Weights - Dimensions

Shipping Weight	35lbs
-----------------	-------

Shipping Dimensions	34" x 17" x 13"
---------------------	-----------------

Parts List

(1) Aluminum Frame	(1) Padded Nylon Bag with drawstring
--------------------	--------------------------------------

(1) Digital Print on Fabric w/ End Panels	(1) Wheel Frame for Carry Bag
---	-------------------------------

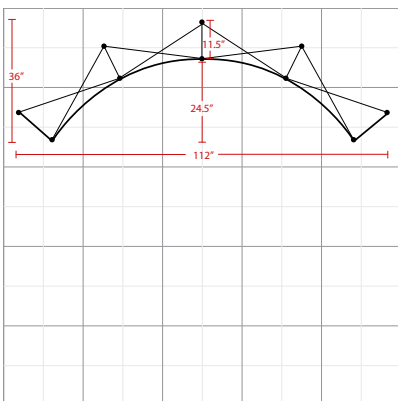

The box represents 10' x 10' booth.

FABRIC COUNTER

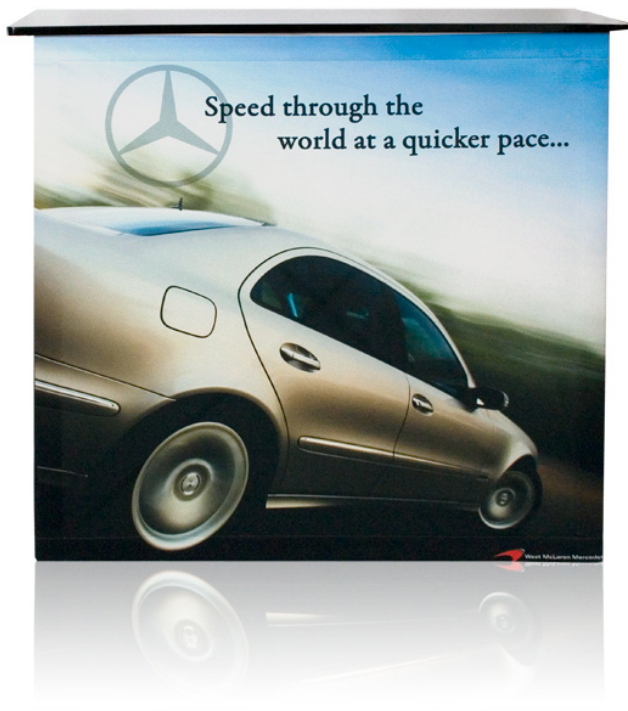

Product Features

It comes with a countertop. Its versatility and simple 2-minute setup, as well as its Velcro attachment, makes it functional for special events as well as an in-office promotional tool for walk-in customers.

Podium Dimensions	40"W x 40" H x 12.5"D
Countertop Size	15.5" x 42"

Construction

Aluminum Frame

2" Hook Velcro Strips

Plastic Hooks

Weights - Dimensions

Shipping Weight	
Shipping Dimensions	

Parts List

(1) Aluminum Frame

(1) Countertop

(1) Digital Print on Fabric w/End Panels

Price

Graphic Specification

Graphic Size: 64.5W" x 39.5H" (includes 12.5" end panels on both sides)

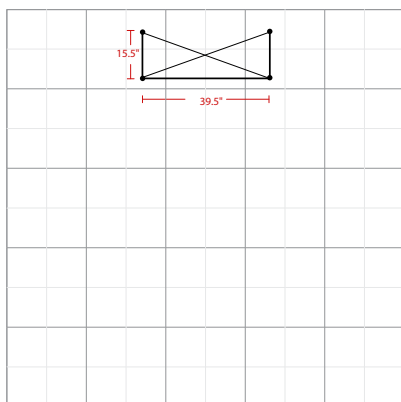

The box represents 10' x 10' booth.

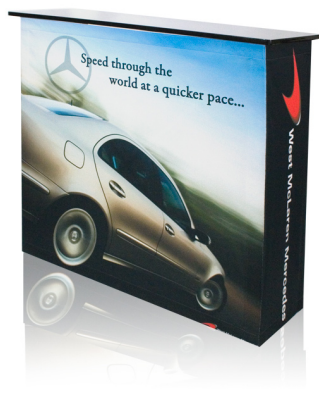

READY POP EXTRA LARGE STRAIGHT

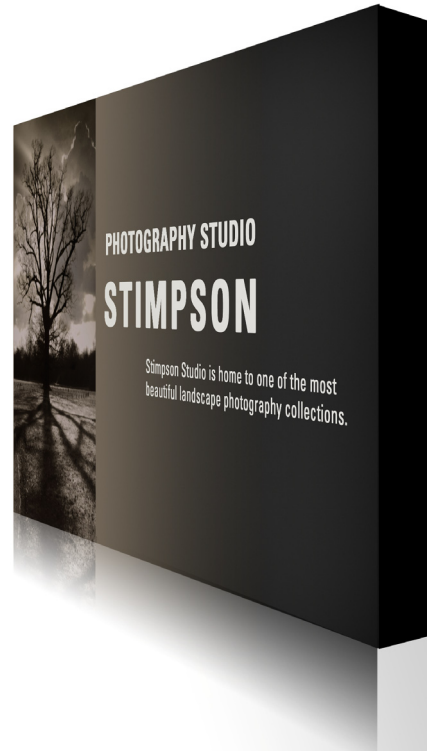
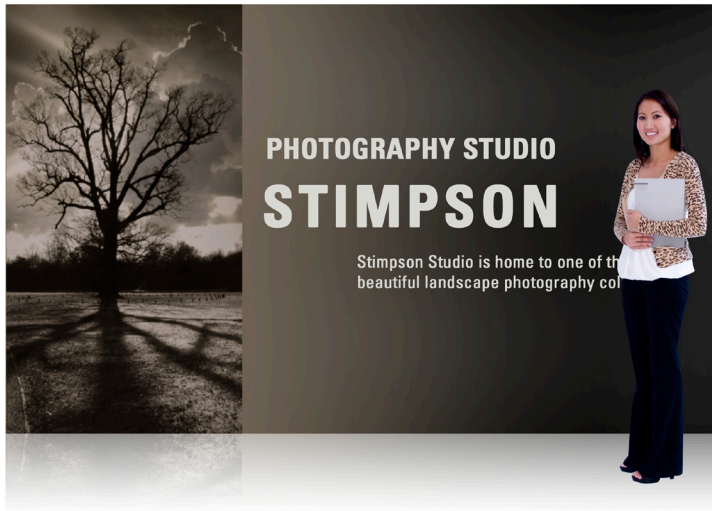

*Optional 200 watt halogen lights available



*Package includes travel bag with wheels

Graphic Specification

Graphic Size: 175W" x 92H" (includes 11.76" end panels on both sides)

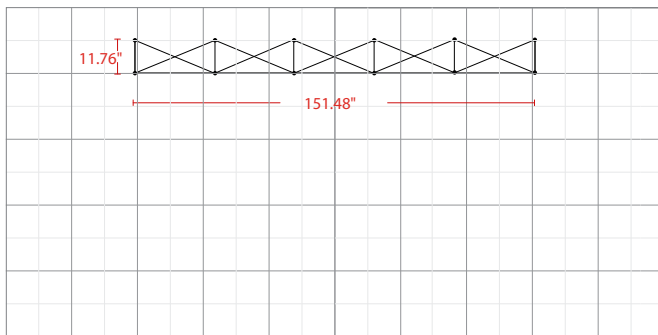

The box represents 10' x 20' booth.

Product Features

Our ultra lightweight aluminum alloy fabric pop-up display in a matte satin anodized finish is an ideal eye-catcher for your trade show, exhibition, or conference. Its versatility and simple 2-minute setup, as well as its Velcro attachment, makes it functional for special events as well as an in-office promotional tool for walk-in customers. Another convenient feature is that your graphic stays attached in your free travel/carry bag that comes with each frame you purchase.

Graphic Size	175"W x 92"H
Display Size	151.48"W x 92"H x 11.76"D

Finishing

2" loop Velcro perimeter

Printing Material	Fabric
-------------------	--------

Construction

Frame	Aluminum
	2" Hook Velcro Strips
	Metal Hooks

Weights - Dimensions

Shipping Weight	31 lbs (without Graphic)
Shipping Weight	38 lbs (with Graphic)
Shipping Dimensions	35" x 21" x 15"

Parts List

Aluminum Frame	2" Loop Velcro
Nylon Bag with drawstring	2" Hook Velcro