

How to Wear?

- Measure your neck size and make sure you order the right-sized Collar from the Size Chart below
- Be seated comfortably and make sure your neck is in a neutral position
- Widen the two parts of the collar to customize it as per the exact measurement of the neck size
- Wrap it around the neck snugly with the trough of the collar matching the chin
- Fasten the hook tape to the loop tape to a comfortable fit
- Complete the strap closure and readjust if there is any discomfort in breathing, especially pressure on the larynx (Adam's Apple)

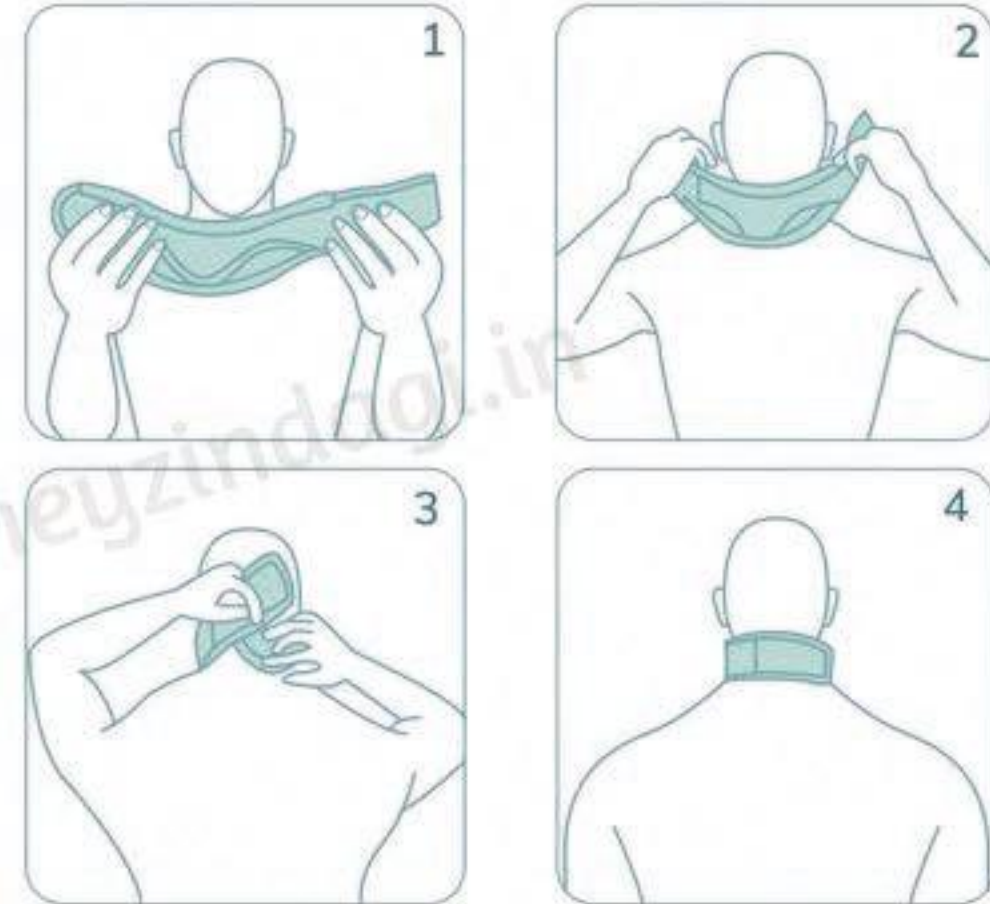

REMEMBER

- Do not use the height adjustment in the collar for sizing purpose. Only use it for matching the collar height with the height of the neck
- Please avoid wearing any jewelry or dresses with collars that might rub between the collar and your skin often resulting in rashes
- Seek assistance if you are struggling when wearing the collar - it might result in you overstraining your neck
- Discontinue use and consult the doctor in case of impaired blood flow, allergic reactions on skin and persistence or increase of pain
- Consult the doctor in case of simultaneous use with any other medical device
- Improper use of the device may lead to adverse effects or decreased effectiveness. Follow the instructions on the packaging carefully before using
- Keep it out of reach of children

P.S.: Kindly consult your Physician or Orthopaedic Specialist before using this product