

## COMPONENTS

- |                      |                     |
|----------------------|---------------------|
| 1. Nebulizer kit     | 9. Air Filter Slot  |
| 2. Nozzle            | 10. Air Output      |
| 3. Angled mouthpiece | 11. Power Switch    |
| 4. Air filter        | 12. AC Adaptor Jack |
| 5. Child mask        |                     |
| 6. Adult mask        |                     |
| 7. AC Adaptor        |                     |
| 8. Air Tube          |                     |

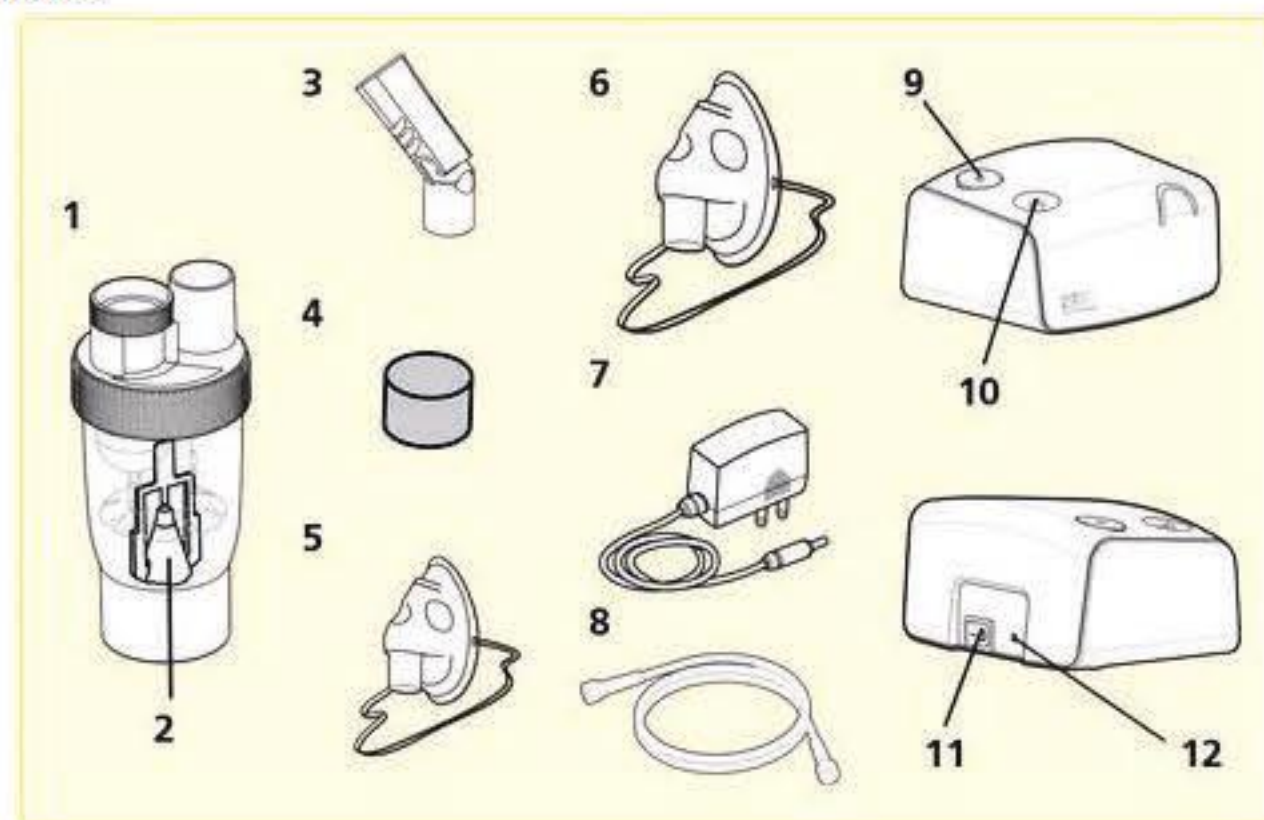

P.S.: Please consult your licensed Respiratory Specialist/Pulmonologist before you order any nebulisation product

## How to Use?

- Place the compressor on a flat, stable surface within reach
- Gently twist and pull straight up on the lid of the nebulizer to separate into two parts (medication cup and cover)
- Make sure that the nozzle is properly installed on the upper cover
- Add the prescribed amount of medication to the medication cup
- Reassemble the nebulizer by carefully twisting the medication cup and cover together

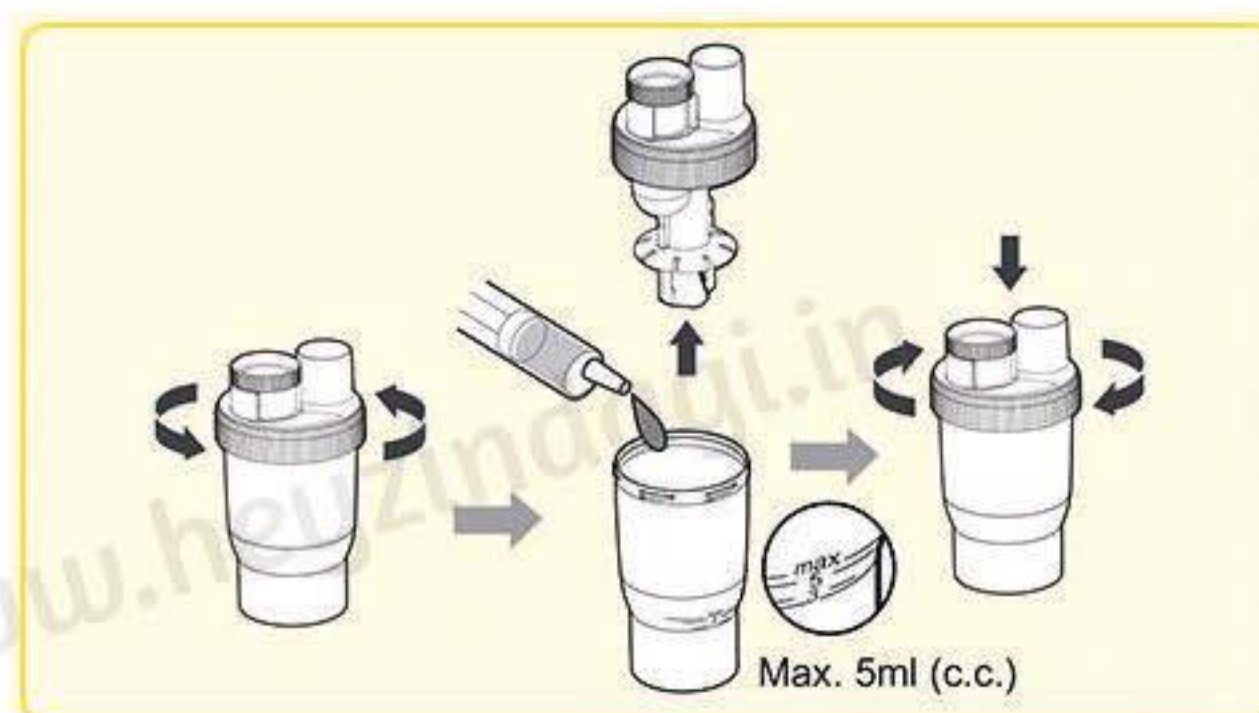

- Connect the AC adapter with the AC adapter jack in the back of the unit ensuring power switch is in "OFF" position
- Plug the AC adapter into the socket. (AC adapters with required voltage and current indicated near the AC adapter jack)
- Press the power-switch to the "ON" position.

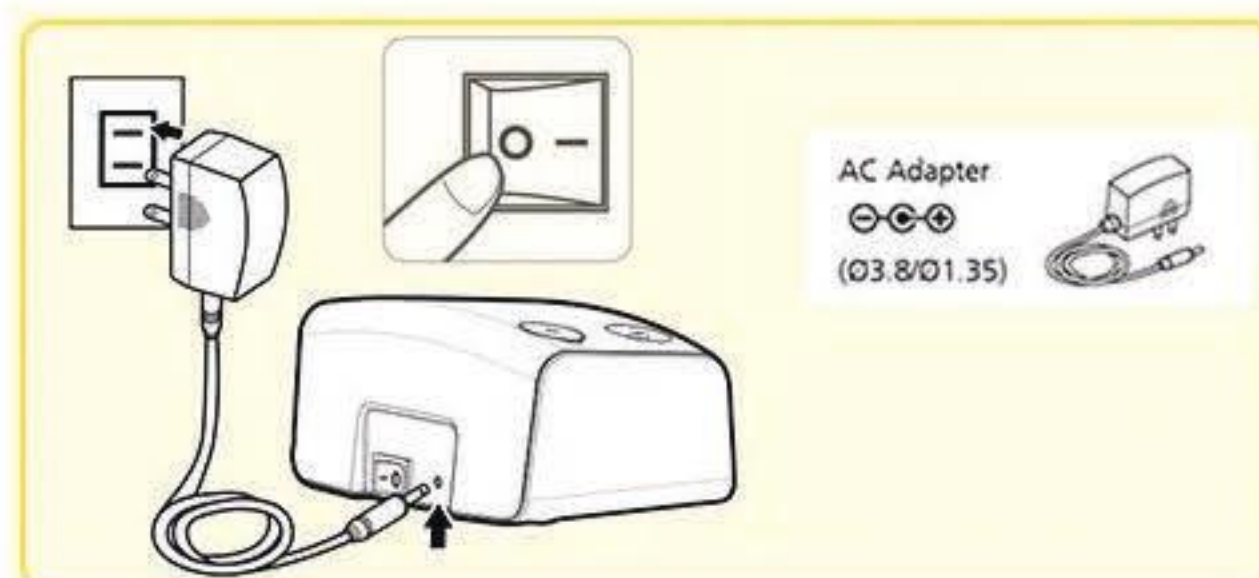

- Attach one end of the air tube connector to the air output.
- Carefully attach the opposite end of the air tubing connector to the stem at the base of the nebulizer kit
- Attach the angled mouthpiece or mask to the top of the nebulizer
- Be seated in a stable manner near the nebulizer
- Position your mouth accordingly with the angled mouthpiece and start inhalation

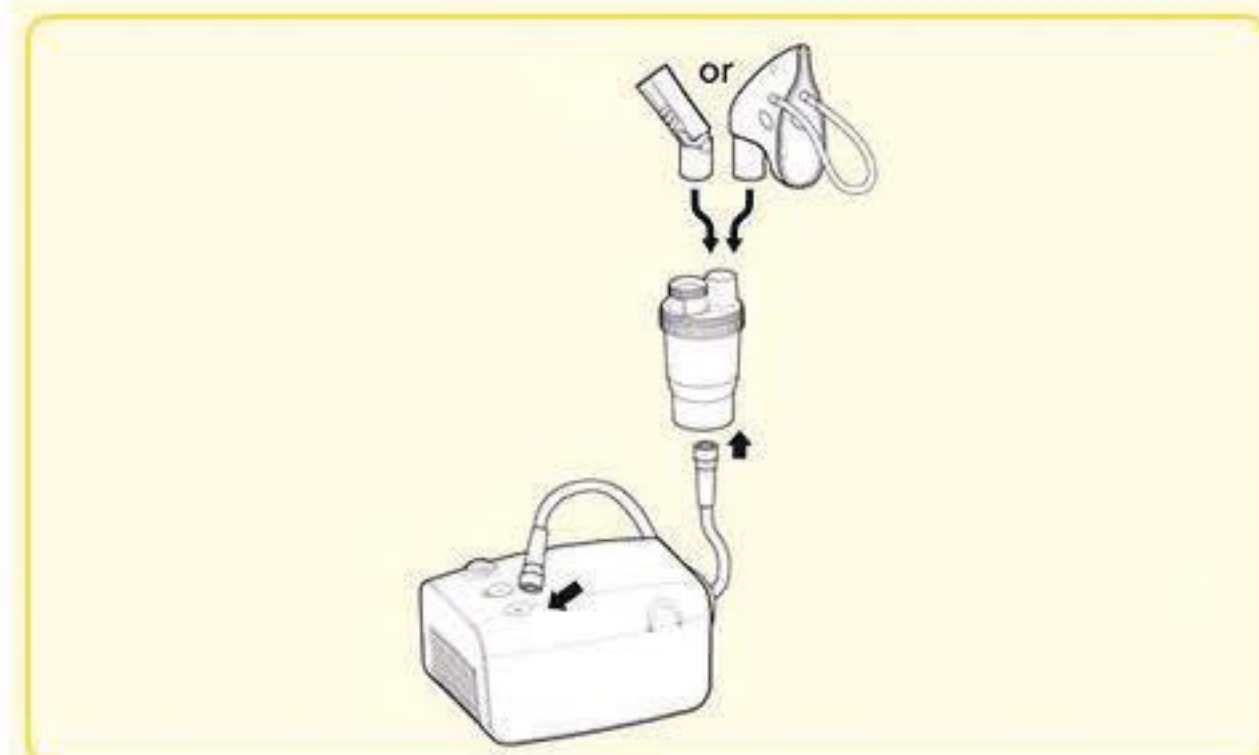

## REMEMBER

- Follow the cleaning instructions given under "Cleaning Technique" in the User Manual (link for download given below) when using the nebulizer for the first time
- Always unplug the Compressor and make sure the power switch is turned to the "OFF" position before assembling and before or after each use
- Use only the authorized AC Adaptor with this nebulizer

- The nebulizer is operable at up to a 45° angle. If the angle is greater than 45°, no aerosol will be generated
- After use, unplug the unit from the power source and allow it to completely cool
- Carefully detach the air tubing from the nebulizer after using and pour out any remaining medication
- A 30-minute interval is recommended after each use