

QUICK START GUIDE

ACCESSORIES

1. Pump
2. High Quality Rubber Tube
3. Fuse
4. Repairing Kit



- Place the mattress on the bed frame with the hose end at the foot section
- Secure the mattress firmly by fixing the flags to the bed frame
- Using the integrated hangers, securely hang the pump at the foot end of the bed or place on a smooth flat surface
- Connect the air hoses from the mattress to the pump unit. Check that the air hoses are not kinked or tucked
- Plug the pump into a wall electrical outlet at a safe distance from the patient's bed
- Turn on the power switch on the control panel of the pump. The pump will automatically begin to inflate the mattress
- During inflation, adjust the pressure setting based upon patient's comfort level by turning the pressure adjustment knob clockwise to increase firmness

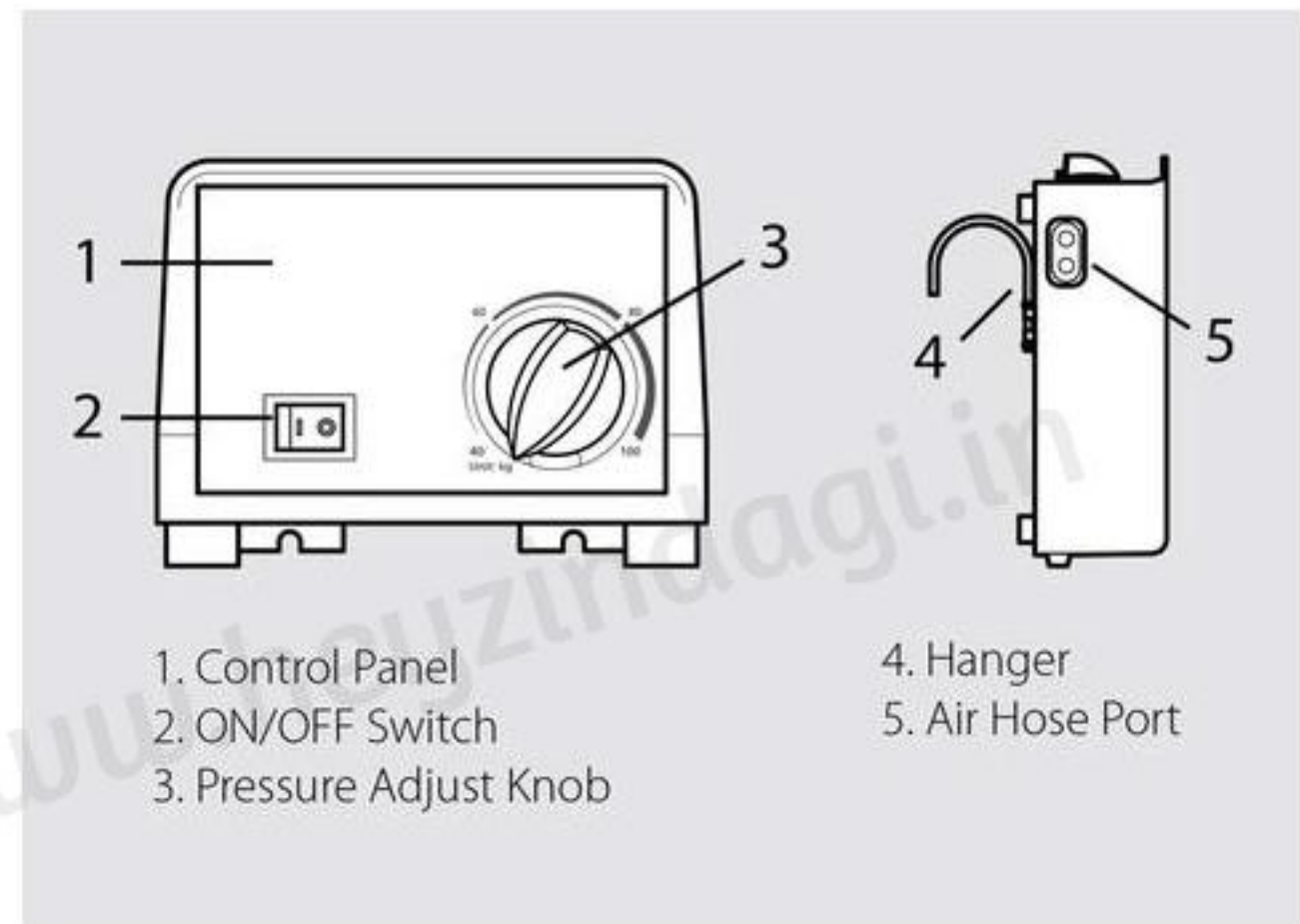

1. Control Panel
2. ON/OFF Switch
3. Pressure Adjust Knob

4. Hanger
5. Air Hose Port

P.S.: Please consult your licensed medical practitioner before ordering this product

REMEMBER

- Every time the mattress is set up for use, it is recommended that the pressure first to be set to max., and then adjust air mattress weight levels to the desired softness after set up has been completed
- Keep the pump away from heated surfaces and flammable anaesthetics to avoid explosion risk

- Do not use with patients who have a spinal cord injury
- If you suspect that you may have had or are having an allergic reaction, please consult your physician immediately