

COMPONENTS

1. Compressor (Main unit)
2. Nebulizer Kit
3. Adult Mask
4. Child Mask
5. Air tube (100 cm)
6. Mouthpiece
7. Spare Air Filters
8. AC Adapter, Storage Bag, Instruction Manual

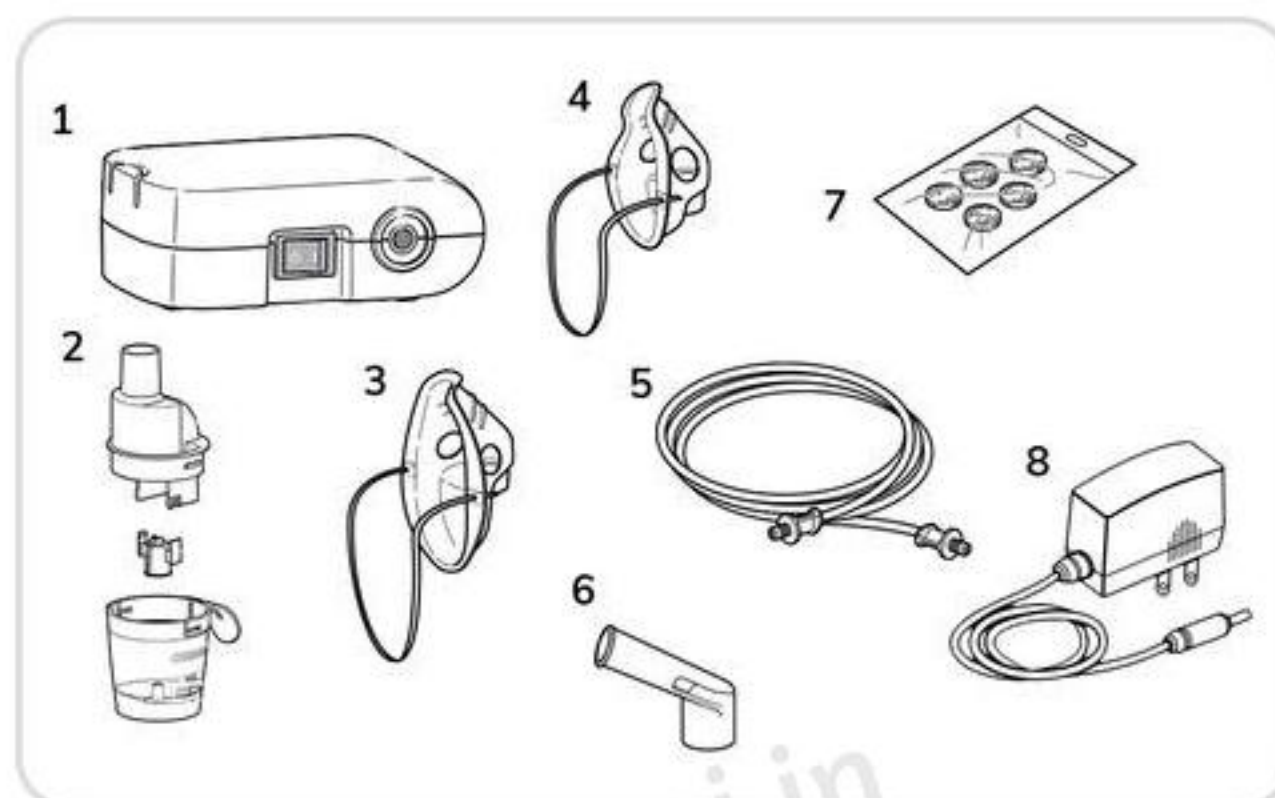

P.S.: Please consult your licensed Respiratory Specialist/Pulmonologist before ordering any nebulizer

How to Use?

- Before using the nebuliser for the first time, clean and disinfect the kit, mask, mouthpiece and optional nosepiece
- Connect the AC adapter to the compressor and plug the power plug into a power outlet
- Remove the inhalation top along with the vaporizer head from the medication tank
- Add the prescribed medicine in the exact amount as advised by your doctor into the medication tank
- Attach the vaporizer head to the inhalation top securely
- Put the inhalation top back into the medication tank
- Tightly attach the mask, mouthpiece or optional nosepiece to the nebulizer kit
- Attach the air tube by pushing the air tube plugs firmly into the air tube connectors
- Be seated comfortably in a stable manner near the nebulizer
- Hold the nebulizer kit as diagrammatically shown in the instruction manual
- Now turn on the power switch of the nebulizer
- When the compressor starts, check that aerosol is being generated
- Position your mouth accordingly with the mouthpiece or the mask as per your convenience and start inhalation
- Turn off the switch and unplug the AC adapter after usage
- Check that there is no condensation or moisture in the air tube
- Clean and store the nebulizer

REMEMBER

- Change the air filter every 60 days or whenever necessary
- Check the air tube before each use for any kinks and ensure that there is no leakage
- Keep the medication tank, mouthpiece, optional nosepiece and mask clean and disinfected for future use. Wash as per the detailed instructions given in the instruction manual.
- Keep the nebulizer and other accessories out of reach of small children as the small parts might be a choking hazard