

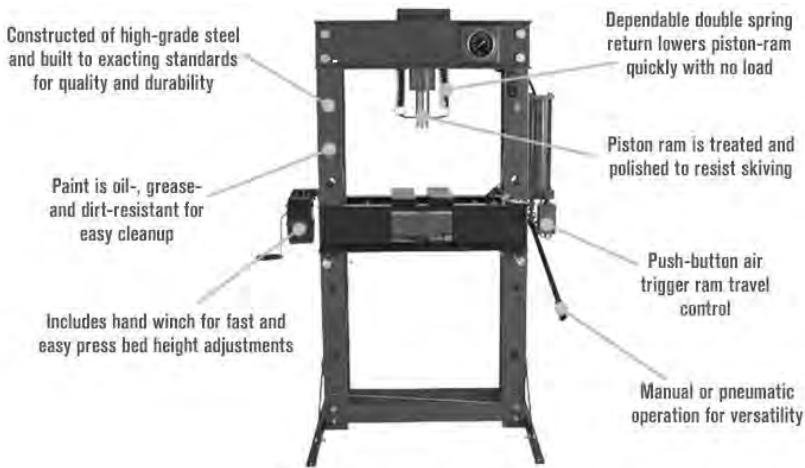

OWNER'S MANUAL
PRODUCT CODE: 50TASP

AIR/HYDRAULIC BENCH PRESS
50,000kg



Working Capacity	Height	Width	Depth	Stroke
50,000kg	1660mm	1220mm	800mm	175mm

WARNING

IMPORTANT: READ ALL INSTRUCTIONS BEFORE USE



The instructions and warnings contained in this manual should be read and understood before using or operating this equipment. Do not allow anyone to use or operate this equipment until they have read this manual and have developed a thorough understanding of how this equipment works. Failure to observe any of the instructions contained in the manual could result in severe personal injury to the user or bystanders, or cause damage to the equipment and property. Keep this manual in a convenient and safe place for future reference.

Whilst every effort has been made to ensure accuracy of information contained in this manual, the TQB Brands Pty Ltd policy of continuous improvement determines the right to make modifications without prior warning.

CONTENT

WARNING2

CONTENT2

SAFETY INSTRUCTIONS3

ASSEMBLY, OPERATION, PREVENTITIVE MAINTENANCE.....4

TROUBLESHOOTING13

PARTS LIST ASSEMBLY DIAGRAM.....14

PARTS LIST PUMP ASSEMBLY DIAGRAM.....16

PARTS LIST RAM ASSEMBLY DIAGRAM18

WARRANTY19

SAFETY INSTRUCTIONS



SAFETY OPERATING INSTRUCTIONS

- Inspect the air/hydraulic bench press before each use. Do not use if bent, broken, cracked, leaking or otherwise damaged. Ensure all bolts and nuts are firmly tightened.
- Do not exceed the products rated maximum load capacity. Never apply excessive force to a work piece.
- Steel and other materials can shatter, always wear approved impact goggles, heavy duty work gloves and appropriate clothing.
- If you detect anything that may indicate imminent structural failure, stop using the air/hydraulic bench press immediately and inspect thoroughly.
- Only use this air/hydraulic bench press on a surface that is stable, level, dry and non-slippery, and capable of sustaining the load. Keep the surface clean, tidy and free from unrelated materials and ensure that there is adequate lighting.
- Do not use this air/hydraulic bench press to compress springs or any other item that could disengage and cause a potential hazard.
- Keep hands and feet away from bed area at all times.
- Do not modify any component of this equipment.
- Only use this device for the purpose for which it has been designed.
- When servicing, use only Borum Industrial identical replacement parts. Use of any other parts will void the warranty.
- Use the right product for the job. There are certain applications for which the Air/hydraulic bench press was designed. Do not modify the Air/hydraulic bench press and do not use the Air/hydraulic bench press for a purpose for which it was not intended.

ASSEMBLY, OPERATION, PREVENTIVE MAINTENANCE

1. FEATURES

The Borum Industrial Air/hydraulic bench press is a heavy duty air/hydraulic press. It is ideal for a variety of workshop applications and in particular suited to agricultural or industrial use.

Jobs such as straightening, bending, folding, punching, removing bolts and bearings etc are some of tasks that may be accomplished by your press.

2. ASSEMBLY

Unpacking: after removing the packing material, make sure the product is in perfect condition and that there are no visible damaged parts. The packaging materials (Polyethylene bags, polystyrene etc.), must be disposed of in an appropriate refuse collection container. These materials must not be left within the reach of children as they are potential sources of danger.

1. Attach the two base support sections (22) and the cross member runner rails (28) to the frame (10) with bolt (17), washer (18), spring washer (19) and nuts (20).

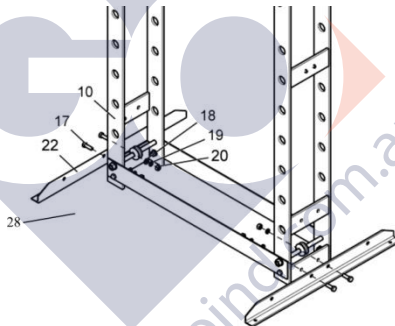

2. Attach side support rails (21) to base support sections (22) and frame (10) with bolt (17), washer (18), spring washer (19) and nuts (20).

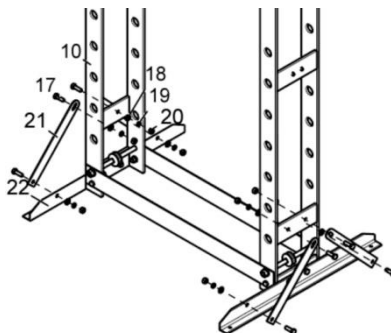

3. Attach the hydraulic air pump (40) to the right frame (10) with spring washer (14) and bolt (33). Ensure that the hydraulic air pump (40) is securely installed. **Note:** *Do Not drop hydraulic air pump during installation. Pump could be damaged if dropped or unsecured! Check that pump is secure before releasing your hold of the hydraulic air pump.*

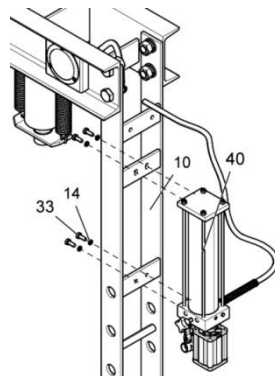

4. Locate the hydraulic hose connection points for the cylinder and hydraulic air pump. Connect the hydraulic hose to ram (23), then connect the hose fitting (40) to the hydraulic air pump.

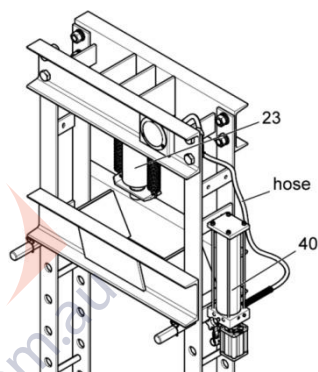

5. Attach the L-bracket (11) to the left frame (10) with spring washer (14), washer (13), bolt (12) and nut (15).

6. Then install winch (16) to the L-bracket (11) with spring washer (14), washer (13), bolt (12) and nut (15).

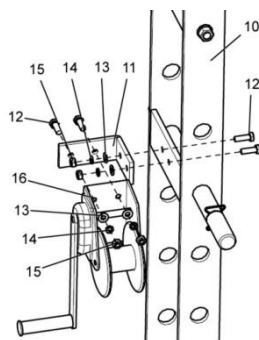

7. Rotating the winch handle into the down position.
8. Raise the joined press bed frame (25) to the desired height and insert the bed frame pins (26) into the holes on the frames (10). Secure the pins (26) with spring clips (27).

WARNING! Bed Press frame is heavy and could cause a potential hazard. Raise press bed frame with 2 or more people.

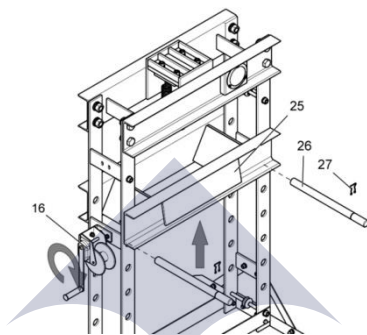

9. Place the bolster plates (24) on bed frame (25).

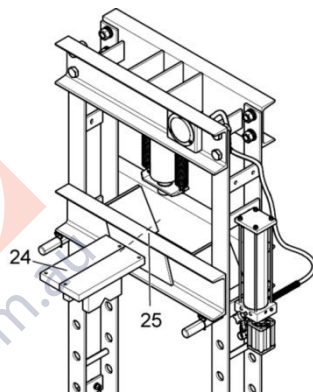

10. Insert the handle (41) into handle sleeve on the hydraulic pressure pump (40). check for proper pump action.

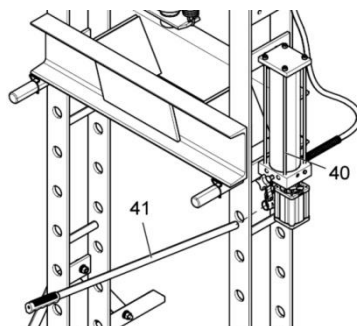

11. Ensure that all bolts and screws have been tightened.
12. The press is now ready for use.

3. BEFORE USE

Prior to each use conduct a visual inspection by checking for abnormal conditions, such as cracked and damaged, loose, or missing parts.

System Air Purge Procedure

Perform the following Air Purge Procedure to remove any air that may have been introduced into the hydraulic system as a result of product shipment and handling. This step is to be completed without any weight on the jack.

1. Firmly close the Release Valve by turning it clockwise.
2. Remove the hydraulic cylinder end of the hydraulic hose and press the tip of the Coupling against a hard surface and pump the pump handle.

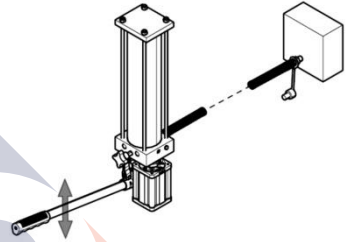
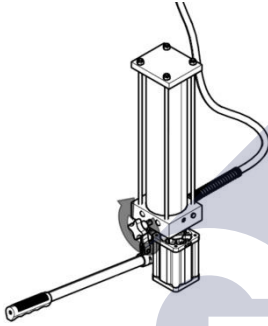

3. Continue pumping until the hydraulic fluid starts to come out from the end of the coupler tip and is free of air bubbles.
4. Check the oil level and add oil if necessary.

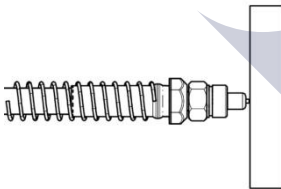

5. Turn the Release Valve counter-clockwise to release the pressure in the pump and hose.

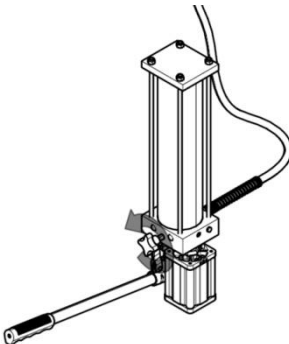

Installation

- Securely attach the press to a flat, firm, level surface taking into account clearance for working pieces.
- Before operating the press, purge the air/hydraulic system in order to eliminate any air that may have built up during transit. Open the release valve and pump the handle several times and close the release valve. Should the system malfunction at any time, repeating this process may resolve the problem.

DANGER!

Models are purpose designed to withstand greater loads than the air/hydraulic units can develop. For safety reasons, always ensure the workpiece and press tools are secured on the table and will not flex or suddenly “give way” causing danger to operator or the component. Also ensure you have read and understood safety instructions.

4. OPERATION

1. Insert the bed frame pins (26) to desired height, then lower the bed frame (25). Ensure bed frame is fully rested on the bed frame pins.

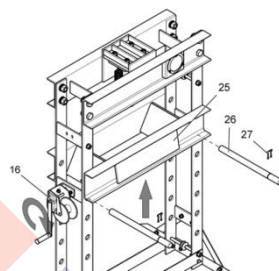
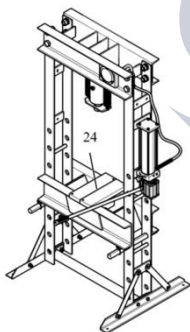

2. Place bolster plates on press bed frame (24).

3. Place work piece on the bed frame or pressing block, use every precaution necessary to ensure safety and to prevent accidents. Position work piece in a manner which will not allow it to inadvertently fall from the bed frame or pressing block.

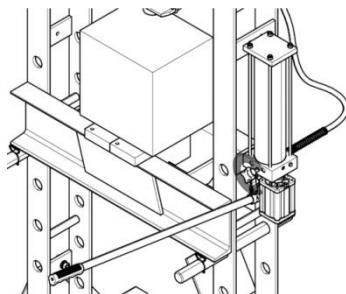

4. Close the release valve by turning it clockwise until it is firmly closed.

5. Connect the air hose inlet fitting onto the shop air supply hose lock fitting, pump air into the system until the ram nears the work piece. Then release the trigger when pumping needs to stop **OR** when an air source is unavailable, pump the handle until the ram nears the work piece.

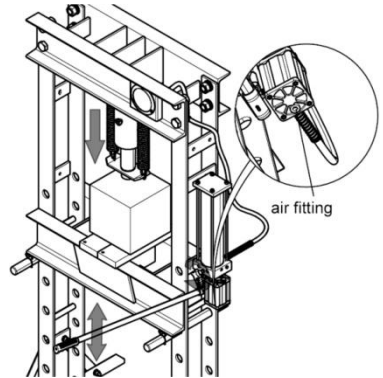

6. Align the ram and work piece to ensure centre-loading. Do not overload work piece.

7. When work is completed, stop pumping the handle (or release the trigger). Slowly turn the release valve counter-clockwise in small increments until ram is free from work piece.

8. Once ram has fully retracted, remove workplace from bed frame. **Cautiously remove work piece from press.**

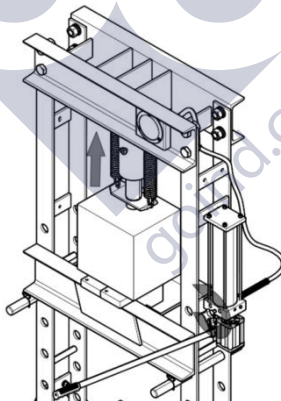

5. STORAGE

This Air/hydraulic bench press should always be stored in a dry location with the ram and piston fully retracted on a level surface.

6. MAINTENANCE

If you use and maintain your equipment properly, it will give you many years of service. Follow the maintenance instructions carefully to keep your equipment in good working condition. Never perform any maintenance on the equipment while it is under a load.

Inspection: Inspect the product for damage, wear, broken or missing parts (e.g: pins) and that all components function before each use. Follow lubrication and storage instructions for optimum product performance.

Binging: If the product binds while under a load, use equipment with equal or larger load capacity to lower the load safely to the ground. After un-binding clean, lubricate and test that equipment is working properly. Rusty components, dirt, or worn parts can be causes of binding. Clean and lubricate the equipment as indicated in the lubrication section. Test the equipment by lifting without a load.

Cleaning: If the moving parts of the equipment are obstructed, use cleaning solvent or another good degreaser to clean the equipment. Remove any existing rust, with a penetrating lubricant.

Lubrication: This equipment will not operate safely without proper lubrication. Using the equipment without proper lubrication will result in poor performance and damage to the equipment. Some parts in this equipment are not self-lubricating, inspect the equipment before use and lubricate when necessary. After cleaning, lubricate the equipment using a high grade light penetrating oil or lubricating spray.

- For light duty use lubricate once a month
- For heavy and constant use lubrication is recommended every week.
- NEVER use sandpaper or abrasive material on these surfaces.

Rust Prevention: Check rams and pump plungers on the power unit assemblies daily for any signs of rust or corrosion. Without a load on the equipment extend hydraulic rams to check if signs of rust are visible, clean as needed.

How the Ram Operates: With release valve closed, an upward stroke of the handle draws oil from the reservoir tank into the plunger cavity. Hydraulic pressure holds the valve closed, which keeps the oil in the plunger cavity. A downward stroke of the handle releases oil into the cylinder, which forces the ram out. This extends the ram. When the ram reaches maximum extension, oil is bypassed back into the reservoir to prevent an over extended ram stroke and possible damage to the ram. Opening the release valve allows oil to flow back into the reservoir. This releases hydraulic pressure on the ram, which results in lowering the ram.

Storing the Ram:

- Fully retract ram after use;
- place the handle in the upright position
- store in a dry location indoors.

To Add Oil:

The hydraulic cylinder assembly contains hydraulic fluid that must be kept at approximately 80% full at all times for proper operation. To check the oil level and to fill remove oil filler plug.

1. Fully retract the hydraulic ram.
2. Remove the oil plug.
3. Fill the oil case until oil level is just beneath the lower rim. **Keep dirt and other material clear when pouring**
4. Replace the oil plug.
5. Perform the Air Purge Procedure.

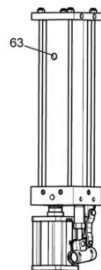
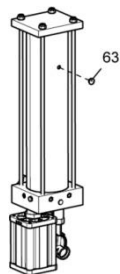
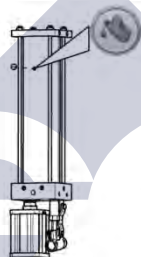

Lubrication: A periodic coating of light lubrication oil to pivot points will help to ensure that pump piston linkage move freely. **Note:** Never apply oil to the saddle. If saddle extension threads require lubrication; clean thread surfaces with a clean, dry cloth, then apply a drip of bearing grease to the threads. Distribute as evenly as possible along the thread post.

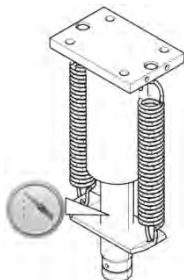

To Replace Oil:

1. Position the pump in the vertical position and fully retract the hydraulic ram.
2. Open release valve by turning handle counter-clockwise (4 full times)
3. Remove the oil plug.
4. Turn the pump on its side so that old oil will drain from the oil fill hole.
5. Fill the oil case until oil level is just beneath the lower rim. **Keep dirt and other material clear when pouring.**
6. Replace the oil plug
7. Perform the Air Purge Procedure

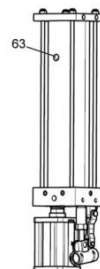
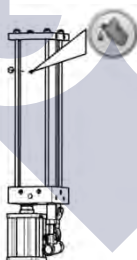
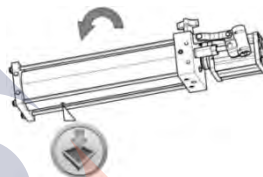
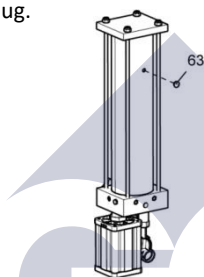
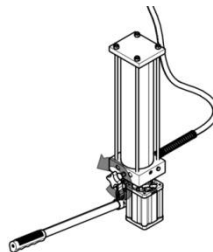

7. SERVICE & REPAIR

Any Air/hydraulic bench press found damaged in any way, or found to be worn or operates abnormally should be removed from service until repaired by an authorised service agent. Owners and / or operators should be aware that repair of this product may require specialised equipment and knowledge. Only authorised parts, labels and decals shall be used on this equipment. Annual inspection of the Air/hydraulic bench press is recommended and can be made by an authorised repair facility to ensure that your equipment is in optimum condition and that the equipment has the correct decals and safety labels specified by the manufacturer.

TROUBLESHOOTING

RAM WILL NOT PRESS LOAD	RAM BLEEDS OFF AFTER PRESS OPERATION	RAM WILL NOT RETRACT AFTER UNLOADING	POOR LIFT PERFORMANCE	RAM WILL NOT EXTEND TO FULL EXTENSION	CAUSES & SOLUTIONS
X	X		X		Release valve not tightly closed. Ensure release valve tightly closed
X					Overload condition. Remedy overload condition
X	X		X		Power unit malfunctioning. Replace the power unit
		X	X		Reservoir overfilled. Remove pump, then drain fluid to proper level.
		X			Linkage binding. Clean and lubricate moving parts.
X				X	Fluid level low. Ensure proper fluid level
X			X	X	Air trapped in system. Purge air from system

PARTS LIST ASSEMBLY DIAGRAM

Index #	Description	Qty.
1	Upper Crossbeam	1
2	Bolt M16X60	4
3	Washer 16	4
4	Lock Washer 16	4
5	Nut M16	4
6	Bolt M24X50	8
7	Washer 24	8
8	Lock Washer 24	8
9	Nut M24	8
10	Frame	2
11	L-Bracket	1
12	Bolt M10X30	8
13	Washer 10	8
14	Lock Washer 10	8
15	Nut M10	8
16	Take-Up	1
17	Bolt M12X35	16
18	Washer 12	16
19	Lock Washer 12	16
20	Nut M12	16
21	Side Support Rails	4
22	Base Section	2
23	Press Cylinder Part	1
24	Bolster Plates	2
25	Joined Press Bed Frame	1
26	Bed Frame Pin	2
27	Fastener	2
28	Cross Member Runner Rails	2
29	Pressure Gauge Joint Pipe	1
30	Rectangle-Ring	1
31	Bolt M5x10	3
32	Pressure Gauge	1
33	Bolt M10x20	4
34	Upper Idler Wheel Axle	2
35	Wheel	4
36	Stretch Circle	8
37	Washer 16	8
38	Nut M16	8
39	Down Idler Wheel Axle	2
40	Press Pump Part	1
41	Handle	1

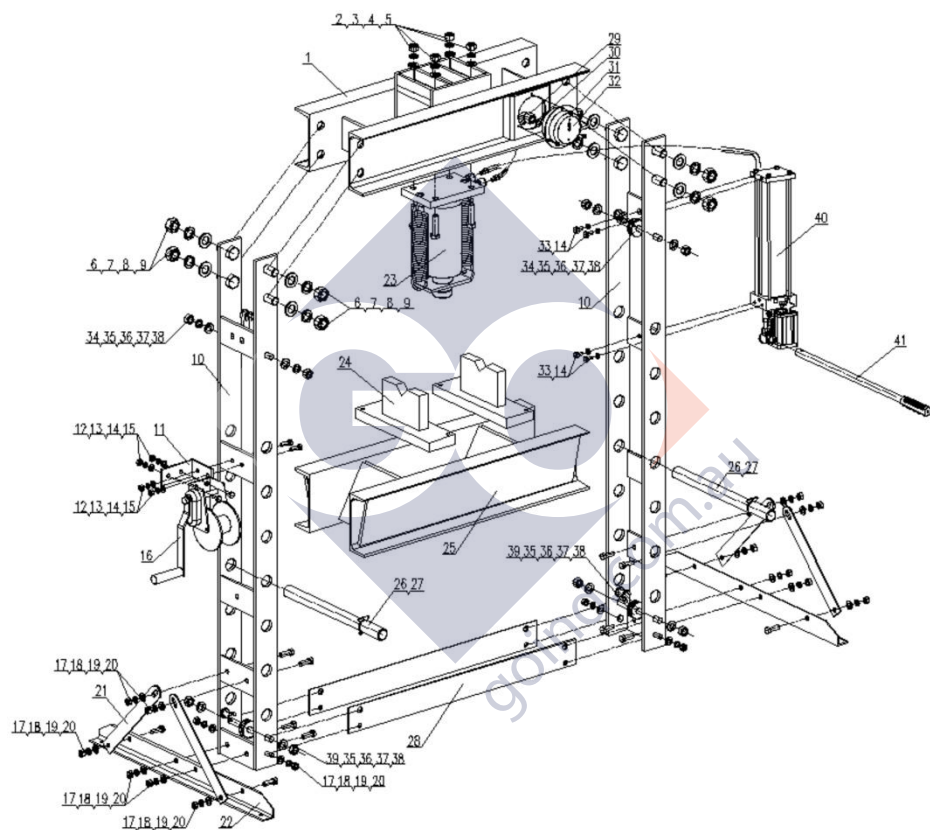

PARTS LIST PUMP ASSEMBLY DIAGRAM

Index #	Description	Qty.
42	Nut M8	4
43	Cover	1
44	Reservoir	1
45	O-Ring	2
46	Ball 6	5
47	Spring	2
48	Ball 9	2
49	Bolt M12X1,25X10	4
50	Spring	2
51	Ring	2
52	Pump Housing	1
53	O-Ring	1
54	Ring	1
55	Piston	1
56	Handle Bracket	1
57	Torsion Spring Pin	2
58	Pin	1
59	Air Pump	1
60	J-Ring	1
61	Soleplate	1
62	Ball 3	2
63	Ball Seat	2
64	Spring Safety Valve	2
65	Screw Safety	2
66	Dust Cup	2
67	Release Valve	1
68	Knob	1
69	Filter Net	1
70	Stay Bar	4
71	Oil Gasket	1

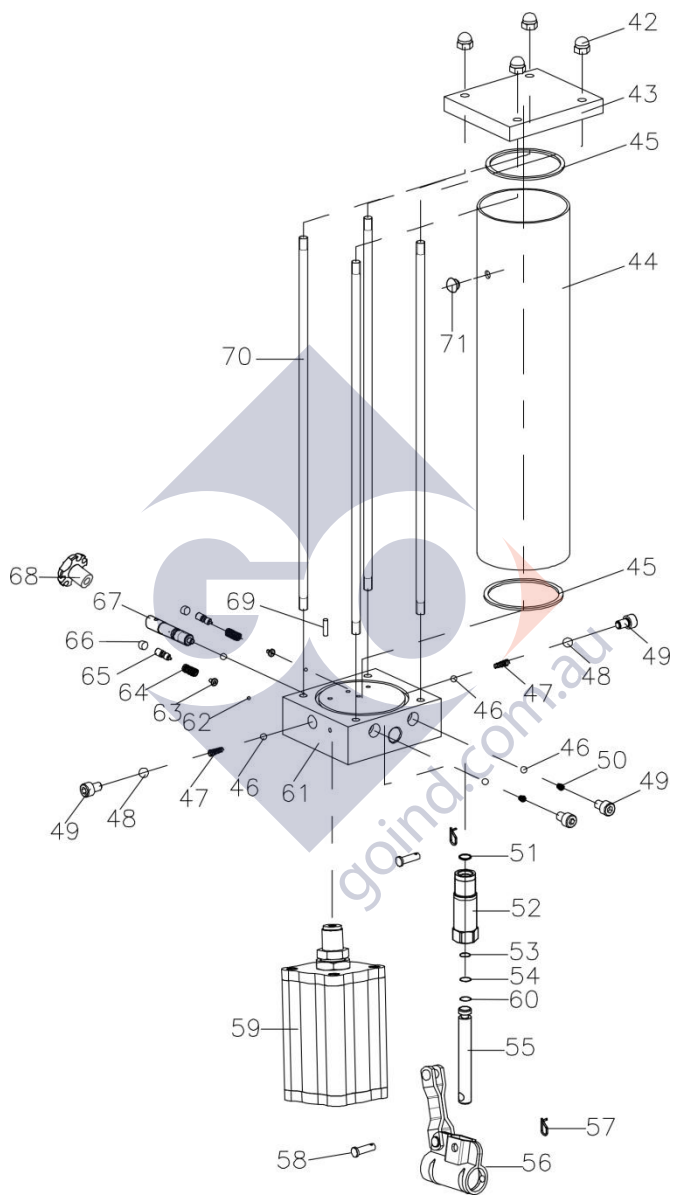

PARTS LIST RAM ASSEMBLY DIAGRAM

Index #	Description	Qty.
72	Coping	1
73	Spring Hunger	1
74	Bushing	1
75	Piston Rod	1
76	Bolt M8X12	1
77	O Ring	1
78	Nylon Ring	1
79	Piston Head	1
80	O Ring 35,5*3,55	1
81	Ring	1
82	Y Ring	1
83	Cylinder Assembly	1
84	Soleplate	1
85	Extension Spring Bolt	2
86	Nut M42X1,5	1
87	Spring	2

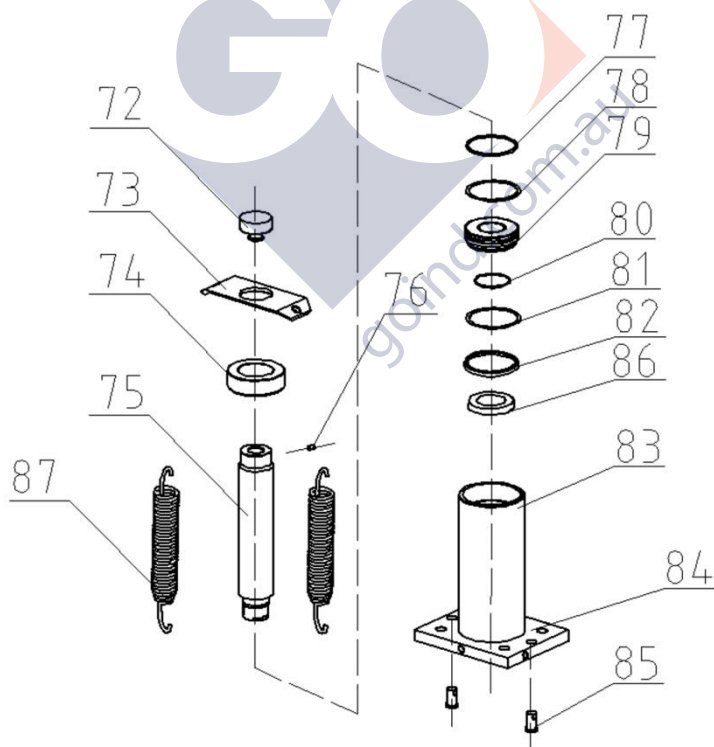

WARRANTY

Borum Industrial products have been carefully tested and inspected before shipment and are guaranteed to be free from defective materials and workmanship for a period of 12 months from the date of purchase except where tools are hired out when the guarantee period is ninety days from the date of purchase.

Should this piece of equipment develop any fault, please return the complete tool to your nearest authorised warranty repair agent or contact TQB Brands Pty Ltd Warranty team – warranty@tqbbrands.com.au.

If upon inspection it is found that the fault occurring is due to defective materials or workmanship, repairs will be carried out free of charge. This guarantee does not apply to normal wear and tear, nor does it cover any damage caused by misuse, careless or unsafe handling, alterations, accident, or repairs attempted or made by any personnel other than the authorised TQB Brands Pty Ltd repair agent.

This guarantee applies in lieu of any other guarantee expressed or implied and variations of its terms are not authorised.

Your TQB Brands Pty Ltd guarantee is not effective unless you can produce upon request a dated receipt or invoice to verify your proof of purchase within the 12 month period.

Consumer Guarantee

Our goods come with a guarantee that cannot be excluded under the Australian Consumer Law. You are entitled to a replacement or refund for a major failure and compensation for any other reasonably foreseeable loss or damage. You are also entitled to have the goods repaired or replaced if the goods fail to be of acceptable quality and the failure does not amount to a major failure.