

V5NANO  
Technology



**ENGLISH MANUAL**  
V5 NANO



## Introduction

Introducing the Flowermate V5 Nano. Evolving from the Flowermate V5 Pro Mini, the V5 Nano is the latest in portable aromatherapy technology. Featuring a removable 18650 battery, the Nano puts the user in direct control of the longevity of the device. As before, this unit is perfect for on-the-go use with heat up time for the Nano as rapid as 30 seconds. The size of the unit makes it ultra-discreet and easy to conceal. Other key features include those found throughout the V5 series. Features include a borosilicate mouthpiece that can be disassembled and tucked into the actual device for easy storage and less smell, large chamber for single or group sessions, and fully isolated air path to ensure a clean and pure taste of the material being consumed. The new Flowermate V5 Nano gives you the option to accurately control the temperature using the OLED display ranging from 40°C to 230°C (104°F-446°F) for an experience that puts the user in full control.

## What's in the Box

- 1 V5 Nano Dry Herb Vaporizer
- 1 Borosilicate Glass Mouthpiece
- 1 Liquid/Waxy Chamber (Made with Organic Cotton)
- 1 Flowermate Lithium-ion 18650 2500mAh Battery
- 1 Loading Cap
- 1 Medium Stainless Steel Pod
- 5 Stainless Steel Screens
- 1 Packing Tool and Dabber
- 1 Cleaning Brush
- 1 Micro USB Cable
- 1 Pouch
- 1 Warranty Information Card
- 1 User Manual

## V5 NANO Technology

Borosilicate Glass  
Mouthpiece

Slider

Main Button

OLED Display

Temperature  
Control Buttons

USB Charging  
Port

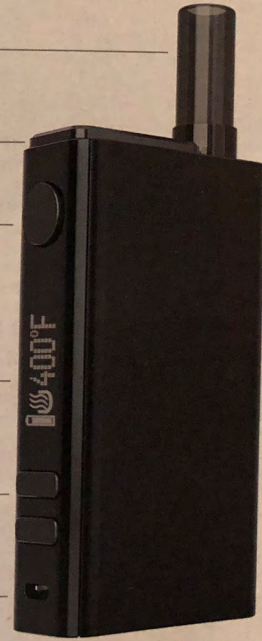

### How to remove and store the glass mouthpiece

On the very bottom of the device slide the bottom button to automatically reveal the glass mouthpiece. To put the glass mouthpiece back, place the glass mouthpiece back into the bottom storage compartment and close the slider of the bottom of V5 Nano.



### How to change the battery

To Change the battery, take the battery plate cover off and put in a Flowermate 18650 2500mAh battery. Place take note of the negative and positive charges inside the unit so they correspond to the battery. Make sure to put the plate cover back on after replacing the appropriate battery. Once the battery is correctly placed into the unit, the device will automatically detect the battery and turn on; a corresponding vibration will accompany the detection of the battery that will last 0.5 sec.



### How to use Loading Cap



Move the slider at the top of the V5 Nano starting from the left moving to right to open and expose the heating chamber. Place the loading cap above the opening of the heating chamber, it should fit snugly. The loading cap allows you to fill your desired blends quickly and efficiently, mess free. Make sure to remove loading cap before placing the glass mouthpiece back on.

### How to use the Water Pipe Adapter

Align the water pipe adapter to the opening of the heating chamber. The water pipe adapter should automatically align and fit into place.

Water Pipe Adapter Sold Separately





## How to Use V5 Nano with Dry Herbs



### To Load

Open the slider on the top of the V5 Nano and remove glass mouthpiece from the storage compartment.

Insert screen into the ceramic heating chamber.

Note: Screens (5 included) in the housing unit and heating chamber can be changed periodically to ensure clean vaping. Additional screens sold separately.

### How to load chamber

Using your loading cap, load your desired herb choice blend into the heating chamber. (see how to use loading cap) You may want to tamp down your herb with the supplied dabber tool. Make sure to not overfill the chamber. Also, make sure the device is off while loading herb into the chamber.

### To Vape with Medium Stainless-Steel Pods:

Remove the lid from the stainless-steel pod and loosely fill your choice blend of herb into the pod. (Recommended to use our patented Load'X Grinder & Loader for mess free grinding and loading.) Tamp down with the dabber tool and make sure to not overfill. Place lid back when finished loading and insert into the ceramic heating chamber.

Note: Do not turn on the device while loading pod.

## How to Use V5 Nano with Oil/Concentrates

### Loading Oil

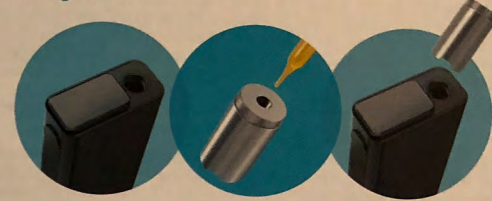

Fill oil/concentrate pod with at least 5 drops of (0.2 - 0.3ml) of oil. Insert oil/concentrate pod into ceramic heating chamber (Note: Do not turn on device while loading oil/concentrate pod into chamber).

### Loading Concentrate

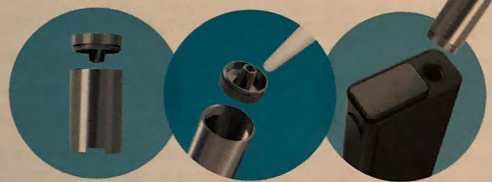

Place concentrate on the inside of the screw on lid, above the organic cotton. Make sure to screw the lid back onto the oil/concentrate pod before using. Insert oil/concentrate pod with lid facing up towards inside the ceramic chamber.

### Fully Isolated Air Path for a Clean Vaping Experience

Air is fully directed to the heating chamber which has a completely isolated path from the rest of the electronics. Our technology ensures a clean and pure vaping experience each time.

Note: Do not turn on device while loading oil/concentrate pod.

## TO ACTIVATE V5 Nano

Rapidly press the power button five times within 1.5 secs to power 'ON' the V5 Nano; a startup vibration and illumination of the screen will indicate that the unit is on. The display will indicate 350°F without heating up. The heating temperature will automatically set to the last used temperature due to its memory function.

After turning the V5 Nano on, press the power button for 2 secs continuously to start or stop the heating function. When the unit is in sleep mode press any button to illuminate the screen.

Adjust to desired temperature manually using the "+" or "-" buttons. The temperature will increase/decrease in 1° increments. (Tip: Press and hold the "+" button 1 sec to automatically increase temperature and press "-" to stop. Do the same with the "-" to automatically decrease the temperature).

Press and hold "+" and "-" buttons simultaneously to change from Fahrenheit to Celsius degrees or from Celsius to Fahrenheit degrees

After setting the unit to the desired temperature, press the power button for 2 secs to start heating. The unit will vibrate when it reaches your desired set temperature and will display 🔥 to indicate it is ready to go. To stop heating press the power button for 2 secs, unit will vibrate to indicate the unit has stopped heating.

To power off V5 Nano, rapidly press power button 5 times within 2 sec. A vibration will indicate the unit has powered off.

### Savor the flavor:

To vape: Inhale slowly through mouthpiece and enjoy your blend. Enjoy 5 minutes of uninterrupted vaping. To continue session after the 5-min period, hold the power button for 2 secs to resume vaping.

## PROTECTION SYSTEM

Short circuit protection: when output short circuit occurs the screen will display "SHORT" and the device will not function when trying to use the power button. Restarting the device can reset this issue.

Open circuit protection: After using for 6 secs, if the load (heating chamber) circuit is open, output will be stopped, and OLED will display "NO LOAD". Pressing the power button will not work. Restarting the device can reset this issue.

NTC abnormality protection: After working for 6 secs, if the NTC has short circuit/open circuit, output will be stopped, and OLED will display "NO NTC". Pressing the power button, it will not work. Restart the device can reset this issue.

Heating protection: If the heating time is over 300 sec the output will be stopped.

## Battery and Charging

### CHARGING

Initially charge the V5 Nano for 3.5 to 4.0 hours. When the battery has finished charging a full battery icon will be displayed. When the battery level is low please charge unit with included Micro 5 Pin USB charging cable to either your computer USB port or compatible UL, CE, TUV, PSE, SAA certified wall charger or phone USB charger. Low battery level will be indicated with "BAT LOW" on the main interface and the battery icon will flash continuously.



If charging the V5 Nano when powered on, the battery icon grid(bar) on the OLED display will circulate and roll to indicate it is charging. If there is no action within 30 sec the full screen will display a large battery icon. Concurrently the grid(bar) of the battery icon will circulate and roll to indicate a full charged battery icon. This will be displayed once the charging is full.

Press any button to return to the main interface.

When charging the V5 Nano it should be powered off. Once plugged in the screen will display a large battery icon; concurrently the grid (bar) of the battery icon will circulate and roll to indicate it is charging.

When charging is complete, a full battery icon will be displayed on the screen.

Do not use V5 Nano while charging. This will cause damage to the device. To prevent the device from overheating do not leave the charger plugged in overnight. Do not leave charger plugged in or unattended without the device. Do not charge unit on bare carpet or rug.

#### **BATTERY**

The device contains a lithium-ion battery. Take caution and dispose in the correct receptacle. Do not discard in trash. Do not overcharge. Do not short circuit the battery.

## **Energy saving and ready mode**

When it is powered on, if there is no action within 30 sec the screen will shut off and go into sleep mode. You may exit sleep mode by charging or pressing any button, this will reanimate the screen.

After a period of 300 sec (5 min) the heater will turn off and it will conversely enter sleep mode. Charging or pressing any button will exit sleep mode and re-illuminate the screen.

## **Cleaning and Maintenance**

The V5 Nano may become clogged when used for an extended amount of time which may result in a difficult draw, more resistance when inhaling, or less overall vapor being released. Please use the following guidelines to clean and properly maintain your device.

To clean the ceramic heating chamber, use the included tool brush to gently clean the wall of the heating chamber. The bristles from the brush tool should help remove any leftover residue.

To clean the ceramic filter, you may use a very fine paper clip or pin to gently insert between the small holes of the used filter screen. Clear the residue with the clean lint free cloth. It is recommended to change the screen every 5-10 uses to clear any residue that may have accumulated. Cleaning more frequently will increase the longevity of the screen.

To clean the mouthpiece carefully remove glass mouthpiece from device. Wash gently with warm water, rinse, and air dry. For more stubborn residue you may use a damp cotton swab.

#### **Tips:**

For best results do not over-pack the ceramic heating chamber with your product. Over-packing will cause constricted air flow and uneven vaping. After filling, use the packing tool to gently stir and aerate the product to ensure vapor can be released. Always properly prepare the device before use to reduce any blockage that may occur within the mouthpiece. Try our Load'X Grinder and Loader for an easier customizable experience. Take the mess out of grinding while making it easier to load your favorite herbs. \*Piece sold separately.

## **Safety**

#### **WARNING**

Failure to follow these safety instructions could result in personal injury or damage. Users of this device do so at their own risk. Neither Flowermate Technology, LLC nor its retailers assume any responsibility or liability associated with the use/misuse of the device. Flowermate Technology branded products are intended for adult use and consumption only. Keep this booklet in a safe place for future reference.

#### **DISCLAIMER**

This device is designed as a mobile solution for the practitioners of aromatherapy and should be used for dry herbal blends as indicated. This device is not intended for use with illegal substances.

#### **CHOKING HAZARD**

The V5 Nano contains small parts which may be a choking hazard to small children. Keep device away from children.

#### **HANDLING**

Do not drop, deform, bend, crush, puncture, incinerate, microwave, shred, paint or insert foreign objects into a Flowermate Technology, LLC V5 Nano.

Do not clean V5 Nano other than instructed by Flowermate Technology, LLC.

Do not attempt to repair or modify V5 Nano yourself.

Do not use a damaged V5 Nano charger or non Flowermate Technology charger. Incompatible chargers may carry different voltage, which may be a fire hazard. Use only the charger provided. Failure to do so will void the limited warranty offered on Flowermate Technology products.

Be caution when handling the V5 Nano, the heating chamber area is hot when the device is powered on. Refrain from direct contact with the main heating chamber when hot.

Do not leave the device unattended when it is powered on or while the device is still hot.

#### **SLEEP PROTECTION**

The device is equipped with a safety sleep mode. When the device is powered on and after 5 minutes vaping, it will go into sleep mode to avoid overuse. Press and hold the power button for 2 secs to resume vaping.

#### **MEMORY FUNCTION**

The device features a smart memory function. It will memorize the data of current use before powering off. When powered on for next use the last setting will be displayed.

#### **SMART TEMPERATURE LEVELS**

The V5 Nano is equipped with a smart OLED display to manually configure any desired temperature setting within the modular range.

## **1 YEAR LIMITED WARRANTY**

Flowermate Technology, LLC warrants this Flowermate Technology, LLC branded device against defects in materials and workmanship under normal use for a period of one (1) year from the date of retail purchase by the original end-user. The original bill of sale is required to redeem warranty. The limited warranty covers one (1) year for electronics, ceramic heating chamber, structural integrity and attachments. The lithium-ion battery is warranted for a period of ninety (90) days. If a physical defect arises and a claim is made within the Warranty Period, at its option and to the extent permitted by law, Flowermate Technology will either:

- Repair the product defect.
- Exchange the product with a product warranty that is new or functionally equivalent device.
- Refund the purchase price of the device \*Please note this refund is only applicable for products purchased from the Flowermate USA online store directly.

## **EXCLUSIONS & LIMITATIONS**

The Limited Warranty applies only to products manufactured by Flowermate Technology, LLC, which can be identified by the "Flowermate Technology, LLC" trademark, tradename or logo affixed to the device. The Limited Warranty does not apply to any non-Flowermate Technology, LLC products. This warranty does not apply to (i) damage caused by accident, abuse, misuse, flood, fire, earthquake, acts of piracy or other external causes; (ii) damage caused by operating the product outside the permitted or intended use as described by Flowermate Technology, LLC; (iii) a device or part that has been modified to alter the functionality or capability without the written permission of Flowermate Technology; (iv) cosmetic damage, including but not limited to dents, scratches and/or broken plastic. This warranty applies to the original end-user and is non-transferrable. Flowermate Technology, LLC warranties only apply to devices that are purchased from authorized retailers serviced by an authorized Flowermate Technology, LLC distributor.

For questions regarding authorized retailers, additional warranty details, please visit: [www.flowermate.com](http://www.flowermate.com)